

### STEP 1

**TAGLIARE A MISURA IL PROFILO IN ALLUMINIO**  
CUT THE ALUMINIUM PROFILE TO SIZE

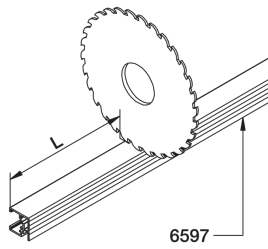

COUPER LA TRAVERSE EN ALUMINIUM À LA DIMENSION

### STEP 2

**INSERIRE IL TAPPO A FILO DEL PROFILO**  
INSERT THE END CAP FLUSH WITH THE PROFILE

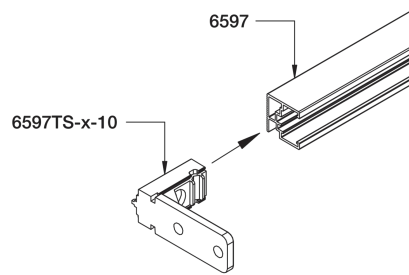

INSÉRER L'EQUERRE DE FIXATION AU MÊME NIVEAU QUE LA TRAVERSE

### STEP 3

**BLOCCARE IL TAPPO SPINA SUL PROFILO CON L'APPOSITA VITE**  
USE THE SCREW PROVIDED TO SECURELY FASTEN THE END DOWEL TO THE PROFILE

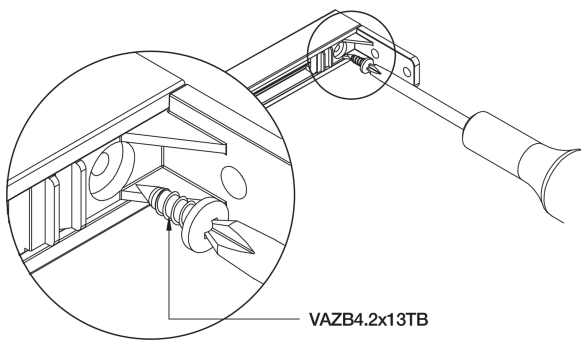

UTILISEZ LA VIS FOURNIE POUR FIXER SOLIDEMENT L'EMBOUT A LA TRAVERSE

### STEP 4

**FISSARE LA CATENARIA AL TOP MEDIANTE L'APPOSITA SQUADRETTA**  
FIX THE CATENARIA PROFILE TO THE TOP USING THE SPECIAL CONNECTING PLATE

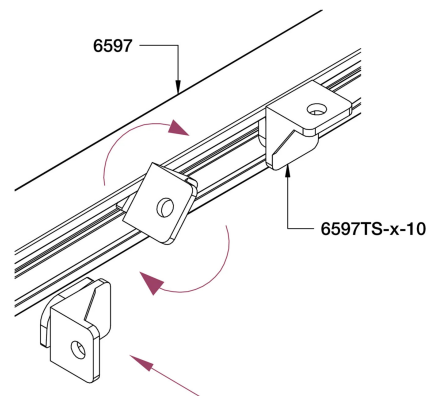

FIXEZ LA TRAVERSE AU PLAN DE TRAVAIL EN UTILISANT LE COIN D'ASSEMBLAGE

---

## ESEMPIO DI APPLICAZIONE

EXAMPLE OF APPLICATION

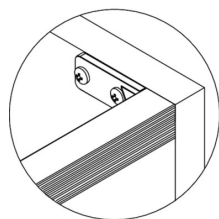

**DETTAGLIO A**  
DETAIL

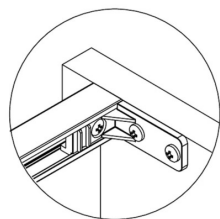

**DETTAGLIO B**  
DETAIL

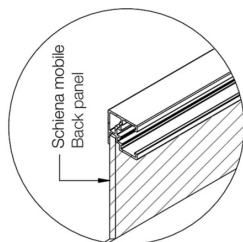

**DETTAGLIO C**  
DETAIL

