

CYCLOS

D - Istruzioni di montaggio del mobile
D - Cabinet assembly instructions

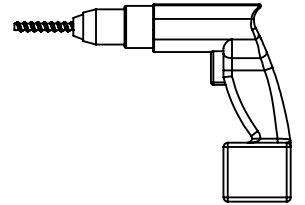

avvitatore
screwdriver

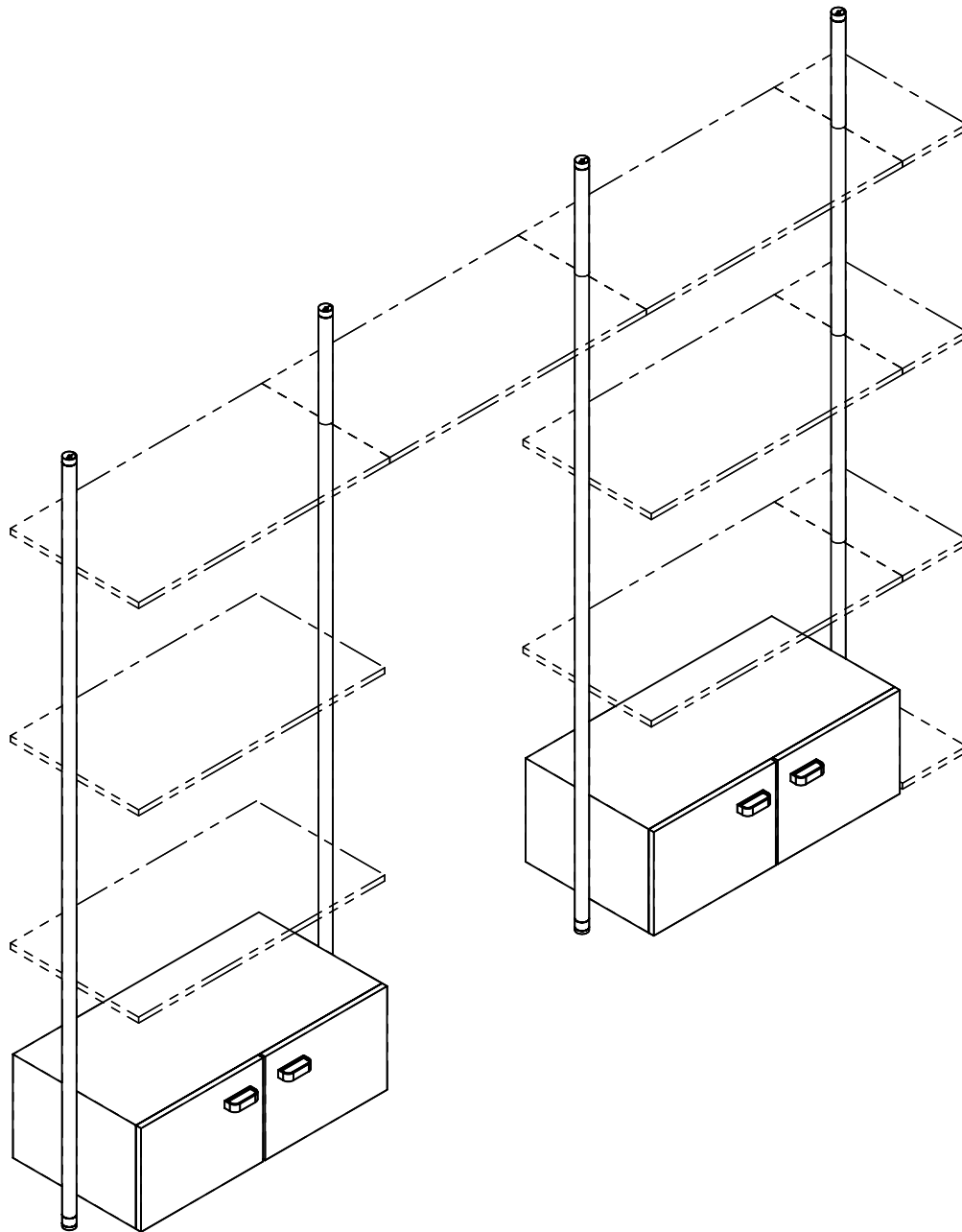
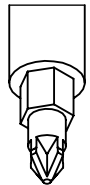

inserto a stella
Star shape insert

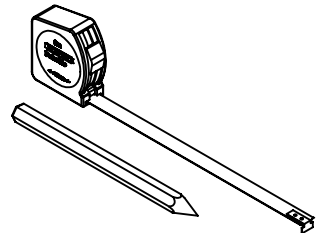

incisore e metro
engraver and meter

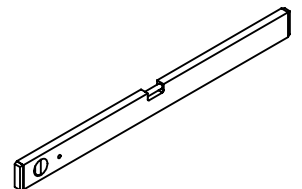

livella
level

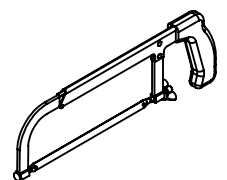

sega
saw

CYCLOS

D - Istruzioni di montaggio del mobile
D - Cabinet assembly instructions

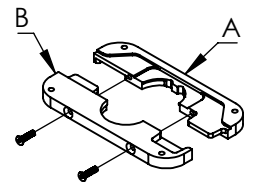
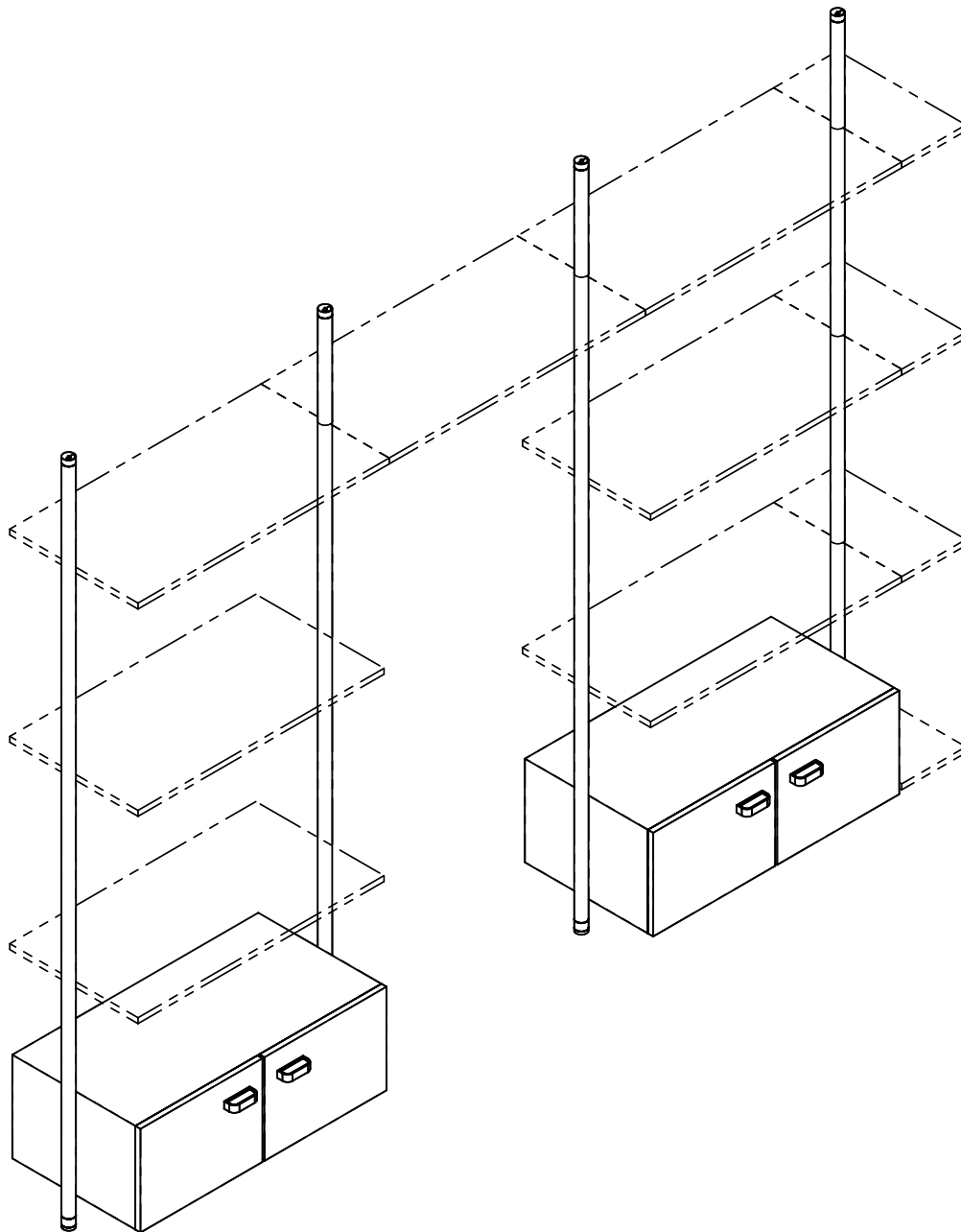

Morsetto centrale
Central clamp

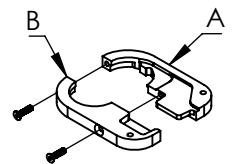

Morsetto terminale destro
Right end clamp

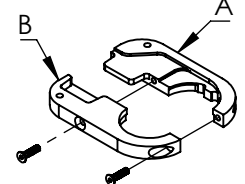

Morsetto terminale sinistro
Left end clamp

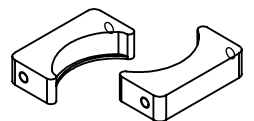

Distanziale per mobile
centrale
*Spacer for central
cabinet*

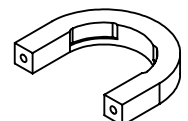

Morsetto esterno
per mobile
External clamp

F E R R A M E N T A

CYCLOS

D - Istruzioni di montaggio del mobile *D - Cabinet assembly instructions*

D1 MOBILE A SINISTRA *LEFT CABINET*

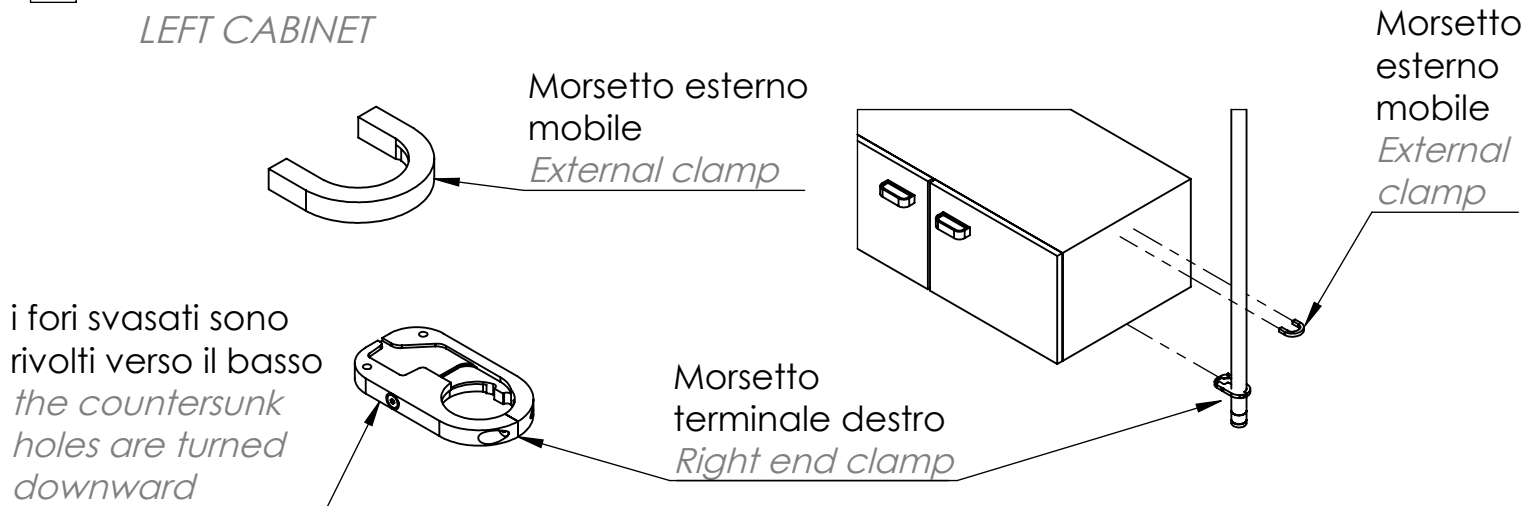

MOBILE A DESTRA *RIGHT CABINET*

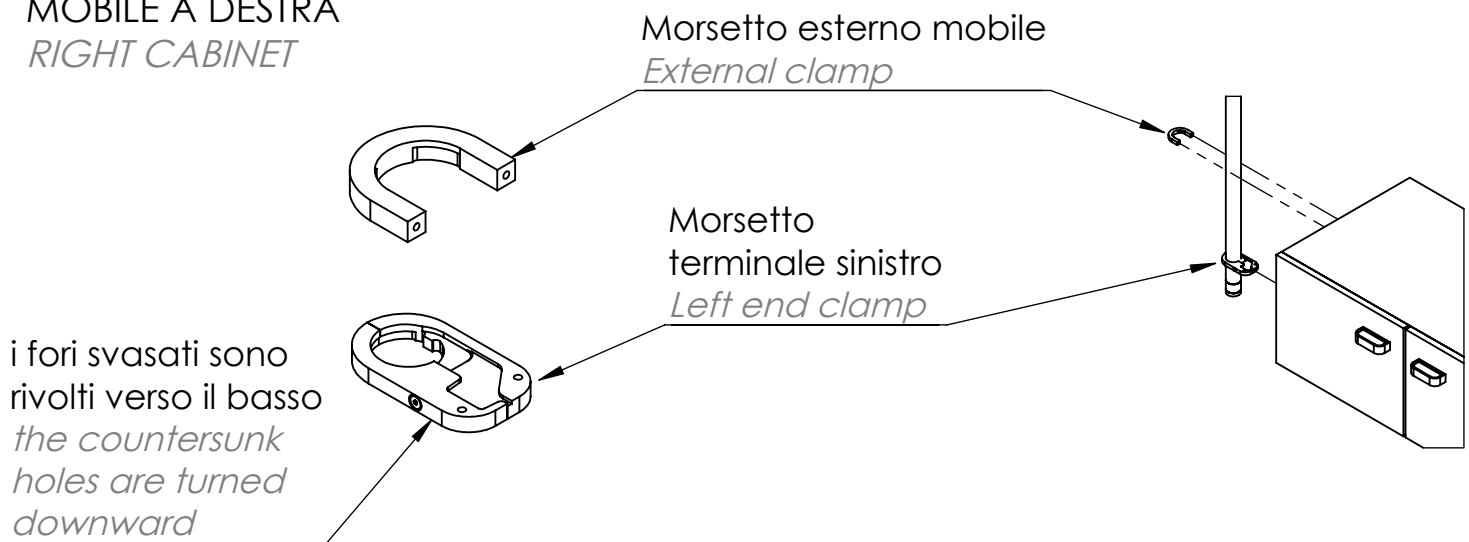

MOBILE CENTRALE *CENTRAL CABINET*

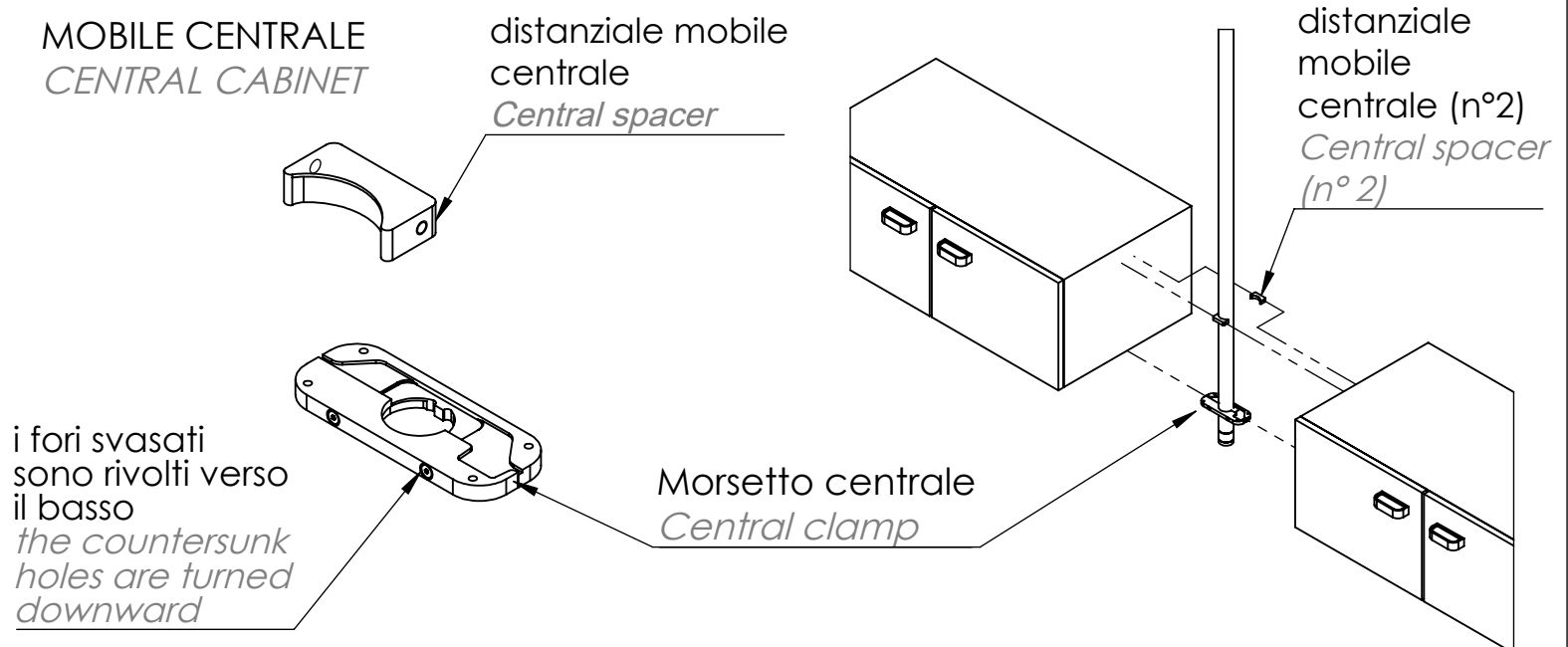

CYCLOS

D - Istruzioni di montaggio del mobile
D - Cabinet assembly instructions

D2

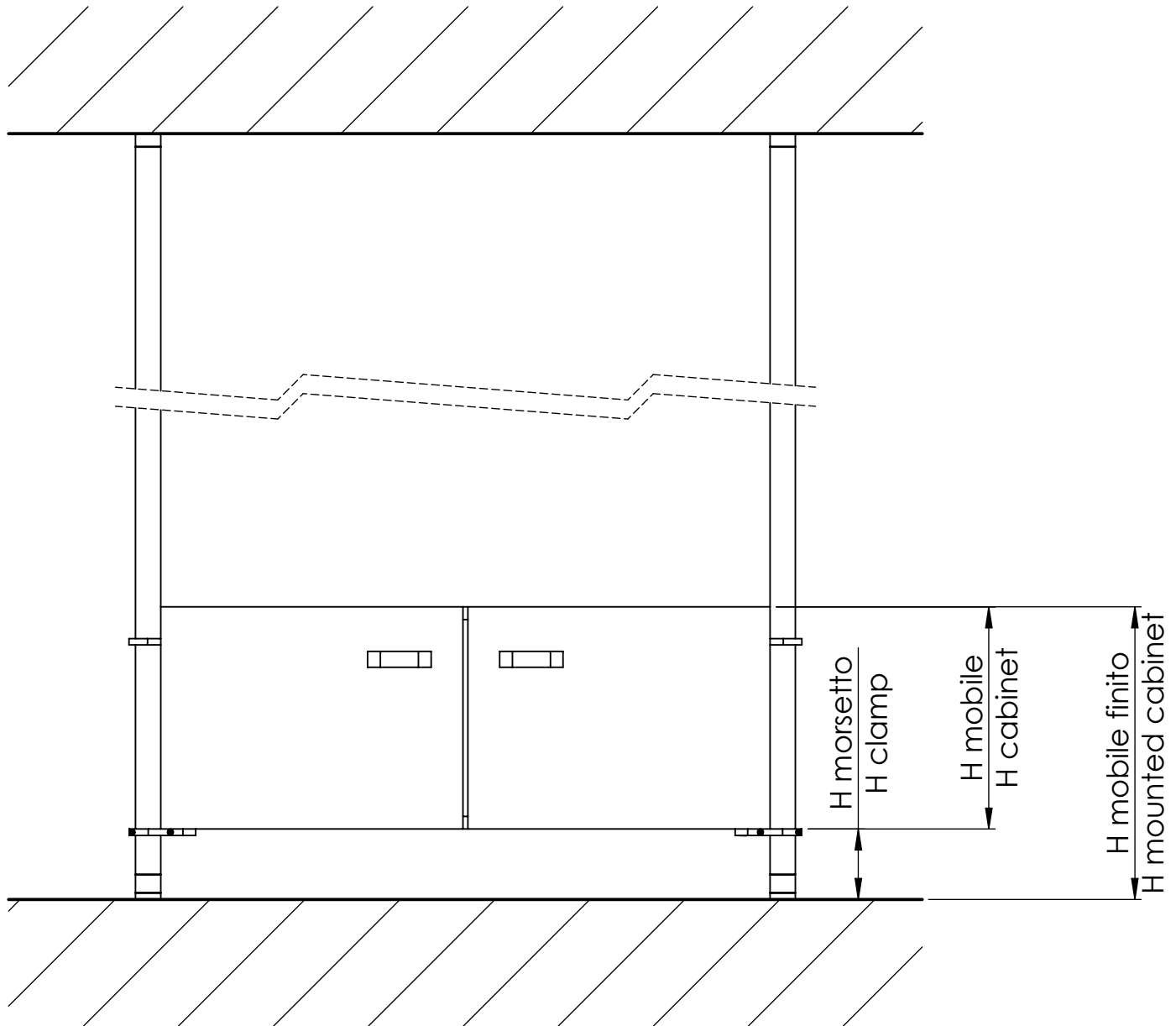

$H \text{ morsetto} = H \text{ mobile finito} - H \text{ mobile}$
 $H \text{ clamp} = H \text{ mounted cabinet} - H \text{ cabinet}$

CYCLOS

D - Istruzioni di montaggio del mobile
D - Cabinet assembly instructions

D3

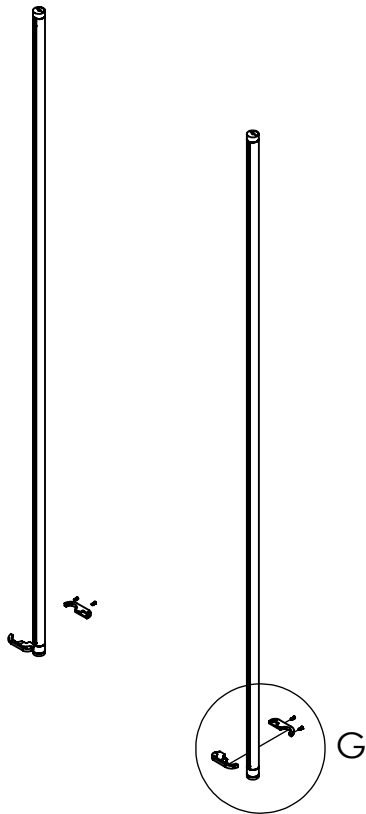

Cava del
montante
Upright Slot

Dente del
morsetto
Clamp prog

DETTAGLIO G

Posizionare i morsetti alla corretta altezza
precedentemente calcolata, con un
fissaggio morbido delle viti
*Position the clamps at the previously
calculated correct height, by a soft fixing
of the screws*

D4

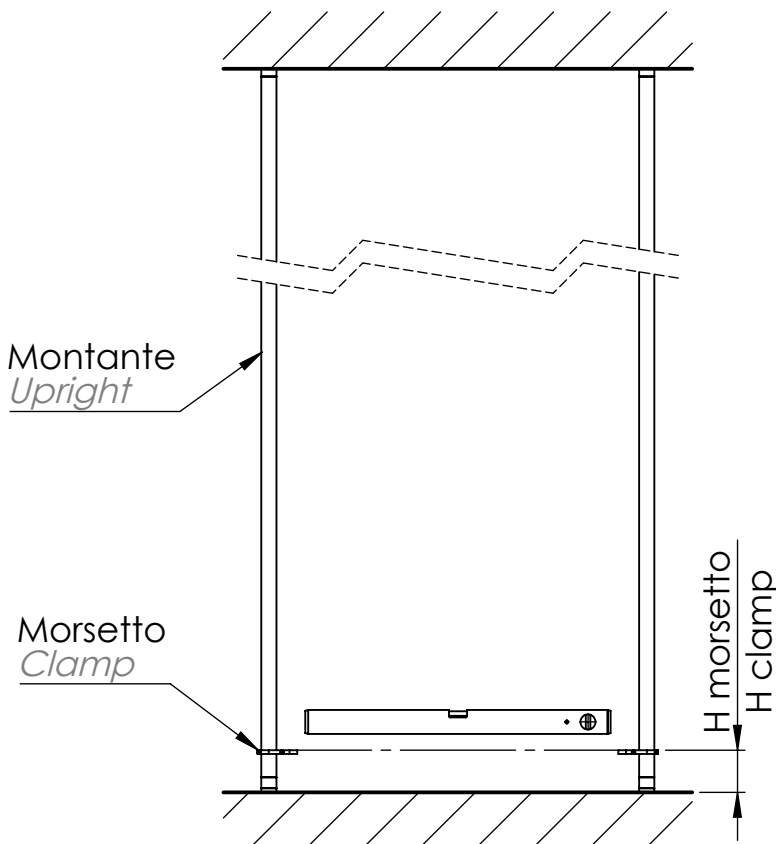

Controllare la planarità dei morsetti dello
stesso mobile
*Check the flatness of the clamps of the
same piece of furniture*

Avvitare le viti che fermano le due parti (A e
B) del morsetto ancorandolo stabilmente al
montante
*Tighten the screws that secure the two
parts (A and B) of the clamp anchoring it
stably to the upright*

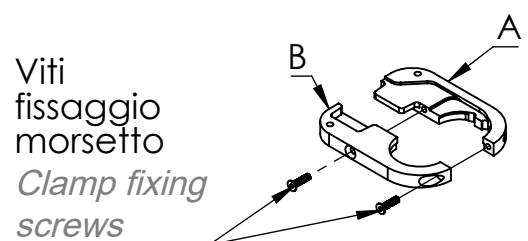

CYCLOS

D - Istruzioni di montaggio del mobile
D - Cabinet assembly instructions

D5

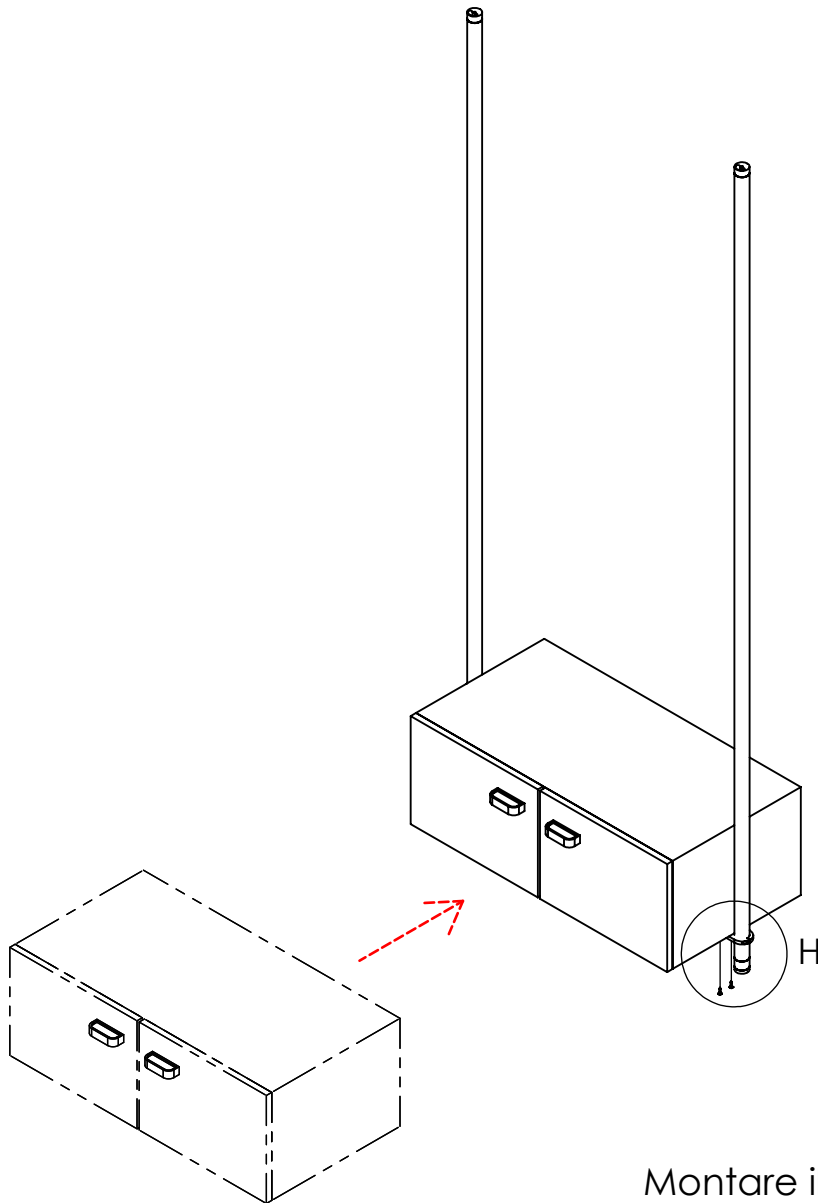

Montare il mobile appoggiando il fondo al morsetto e fissarlo con 2 viti al morsetto stesso

Assemble the cabinet, place it on the clamps and secure the bottom by screwing it at the clamps themselves

DETTAGLIO H

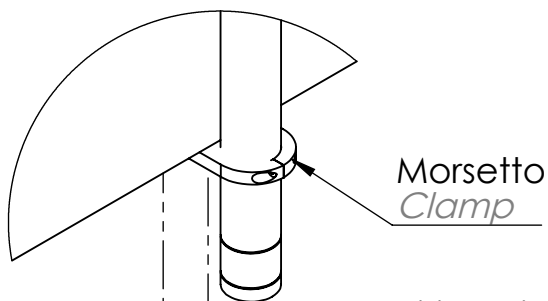

Viti per il fissaggio del fondo del mobile con il morsetto

Screws for fixing the bottom of the cabinet to the clamp

CYCLOS

D - Istruzioni di montaggio del mobile
D - Cabinet assembly instructions

D6

Per fianco terminale mobile
For cabinet end side

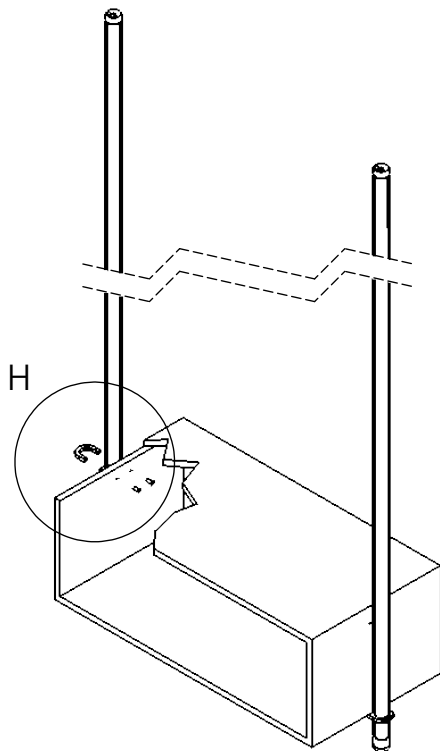

DETTAGLIO H

Morsetto esterno mobile
External clamp

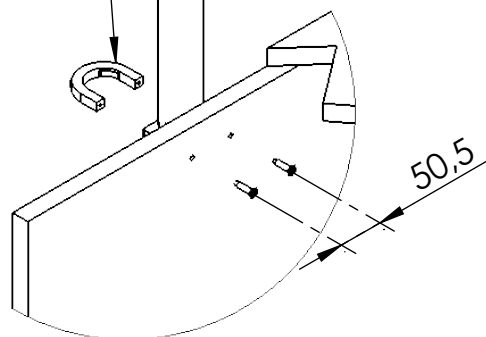

Forare il fianco del mobile con asse 50,5mm, all'altezza voluta del morsetto esterno mobile e fissare il fianco al morsetto con le viti

Drill the cabinet side, at the desired height of the clamp, with an interaxis of 50,5 mm, and secure the side to the clamp with screws

Per fianco centrale mobile
For cabinet central side

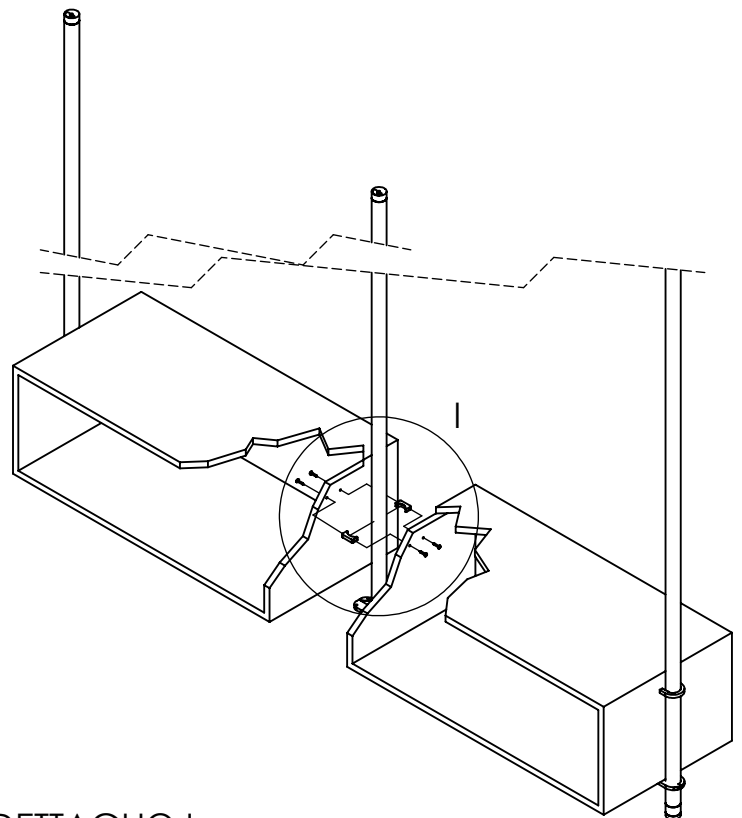

DETTAGLIO I

Distanziale mobile centrale
Central cabinet spacer

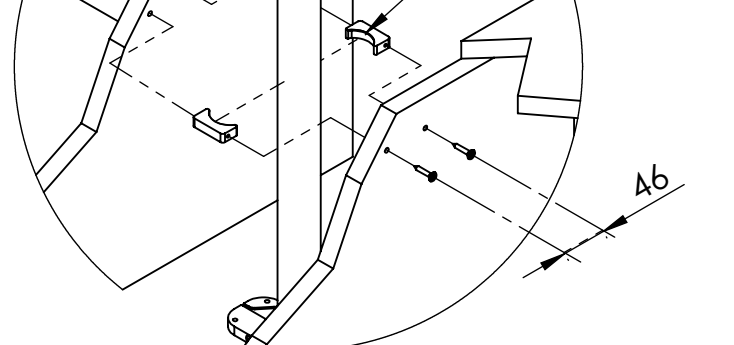

Forare i fianchi intermedi con asse 46mm, all'altezza voluta del distanziale mobile centrale e fissare i fianchi ai distanziali con le viti

Drill the intermediate sides, at the desired height of the intermediate spacer, with a 46mm interaxis, and secure the sides to the spacers with the screws