

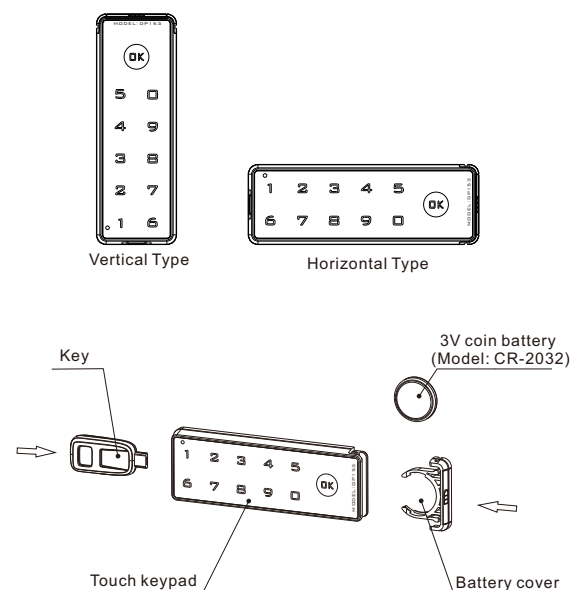

Schematic diagram of panel structure



-1-

1. Battery Installation

If the battery has been installed for initial use, please pull out the insulating sheet. If not, please pull out the battery cover, put in a standard button coin battery CR2032, the battery works well if there is a long beep .

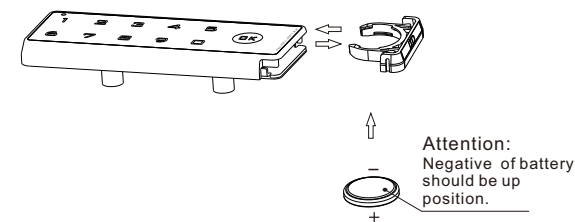

2.Unlock

Enter the code then press OK, the lock will indicate one long beep if the code is correct, Please open the drawer/door in 3 seconds.If the code is wrong, the lock will indicate two short beep.

Initial use:

Enter the factory default code 1234 →OK Key

-2-

3.Code Resetting

The user code is made up of 1-8 digits, it can be saved automatically even power off. (Factory default code is 1234)

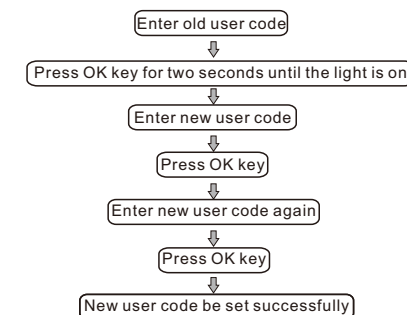

◆Example: Change factory default code 1234 to new code 12345678
Enter factory default code 1234 → Press OK key two seconds until the light is on→ Enter new user code 12345678→ Press OK key → Enter new user code 12345678 again→ Press OK key, the new user code is set successfully after a long beep.

4. Lock

Close the drawer/door to lock it.

-3-

5.Alarm

The lock will alarm 60 seconds if pressing wrong code four times continuously. Entering correct code + OK will end the alarm.

6. Battery Replacement

The lock will indicate three short beep after entering correct user code when power off. Please replace the battery as soon as possible.
When a continuous or intermittent beep is heard, it means that the battery is not enough to work properly. The battery must be replaced immediately.

7. Emergency Decoding

If user forgets the code or needs emergency unlock, please connect the unique master key with the lock and press OK. Decoding succeeds when a short beep is heard and then the lock is open. The user code is reset to factory default code "1234".

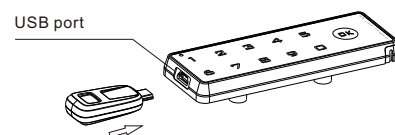

(Attention: Master key is decoding for emergency. Do not put it inside cabinet.)

-4-

8.Common Breakdown And Solutions

Breakdown	Possible reasons	Solutions
No reaction after replacing battery	1.Battery position is wrong 2.Battery power off	1.Reload battery 2.Replacing new battery
A continuous or intermittent "DEE" is heard	1.The battery in wrong position 2.There is eyewinker on the surface of battery	1.Pull out the battery and put in right position 2.Clean the eyewinker of battery
There is a long "DEE" or no reaction after entering code	3.The battery power off	3.Replacing new battery
There is continuous voice "DEE DEE..." after entering right password	1.The password is too short 2.The battery is low power	1.Resetting the password to 6 or 8 digits. 2.Replacing a new battery
In the time of decoding, the lock "DEE DEE" for few seconds before unlocking.	Normal prompt	

-5-

9.Technical Data

Battery	3V(CR2032 Button-coin battery), the battery can be used for one year based on unlocking 20 times per day
Static Current	< 6uA
Dynamic current	Idle operating current <0.8mA Unlock average current <8mA
Working Temperature	-5℃~50℃
Working humidity	20%~80%
Material	Zinc alloy panel + ABS
Service life	Lock and unlock at least 100 thousand times

10. Beeps and Lights Indication

No.	Function	Beep	Lights	Indication
1	Press Code	One Short Beep	One Short Flash	Press code confirmation
2	Unlock	One Long Beep	One Long Flash	Correct code and accepted by the lock
3	Change Code	One Long Beep	One Long Flash	Operation success.
4	Error	Two Short Beep	Two short Flash	Operation failed.
5	Alarm	Continuous Beep	Continuous Flash	Four times incorrect code
6	Low Battery	Three Short Beep	Three short Flash	Low battery, please replace new battery.

-6-

DP153 Installation Manual

Packing List

S/N	Description	Quantity	Remark
1	Keypad	1	
2	Cylinder	1	
3	Striking plate	1	
4	DP-KEY	1	
5	Round mechanical screws	2	M4 x 25 (Assemble cylinder) For thin plate cabinet
6	Round mechanical screws	2	M4 x 40 (Assemble cylinder) For thick plate cabinet
7	Countersunk screws	3	M3.5 x 16 (Assemble Striking plate)
8	User Installation Manual	1	

-1-

Product Structure

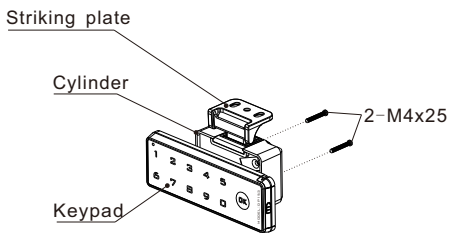

Dimension

1.Dimension of the keypad

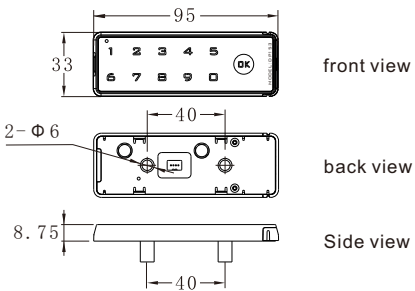

-2-

2.Dimension of the cylinder

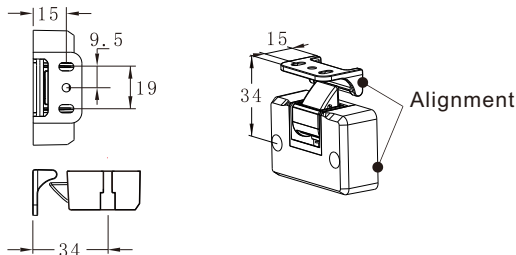

Installation Guideline For Drawer

1.Installation Guideline

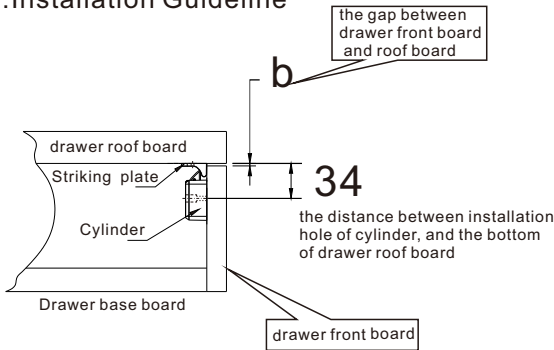

-3-

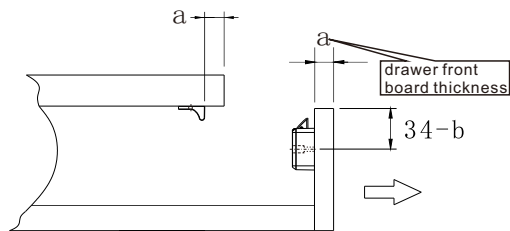

Position dimension between striking plate and Cylinder

2. Installation holes of drawer front board

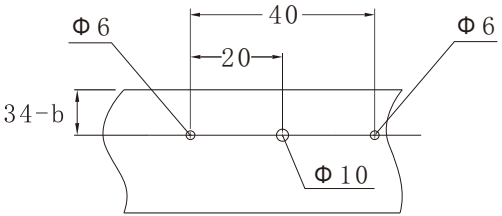

3. Install lock

- ① The connecting wire pass through the 10mm hole
- ② Put the connecting wire connect with the lock body, then press extra wire into the hole. Be noted that the keypad and lock body should not be dragged by the connecting wire.
- ③ Use 2pcs of M4 x 25 screws to fix the keypad and lock body.

-4-

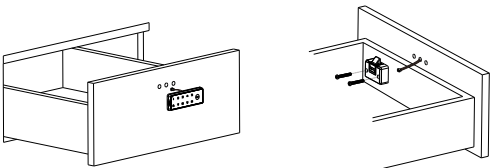

(1)

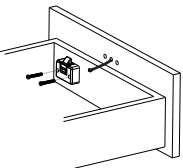

(2)

4. Install striking plate

- ① Related to the center of the cylinder to the top of the drawer roof need to be done a positioning guide wire, center of striking plate need to coincide with the positioning wire on the horizontal of drawer roof, torn double-side tape, then fix the striking plate in the portrait position in the distance of roof.
- ② Use 2pcs of M3.5 x 16mm Countersunk screws to fix the striking plate through two holes at the ends, after adjusting, use M3.5 x 16mm countersunk screw to fix intermediate locating hole.

Striking plate positioning line

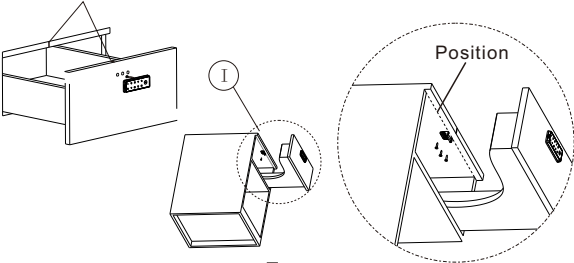

-5-

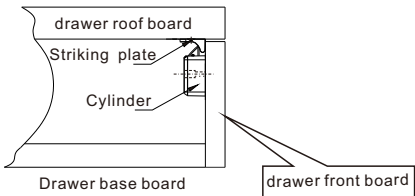

Installation Guideline For Cabinet

1. Positioning drawing of installation

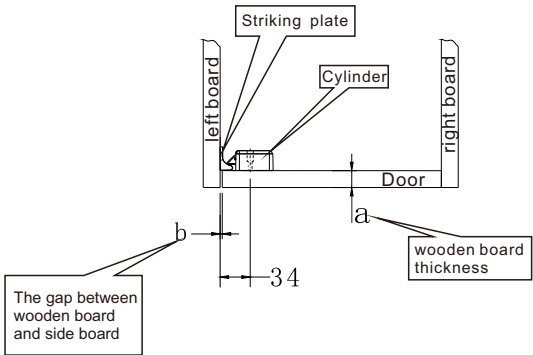

-6-

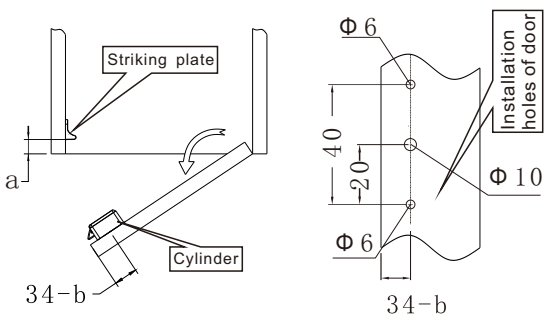

2.Install Lock

- ① The connecting wire pass through the 10mm hole
- ② Put the connecting wire connect with the lock body, then press into the hole. Be noted that the keypad and lock body should not be dragged by the connecting wire
- ③ Use 2pcs of M4x 25 screws to fix the lock body and keypad.

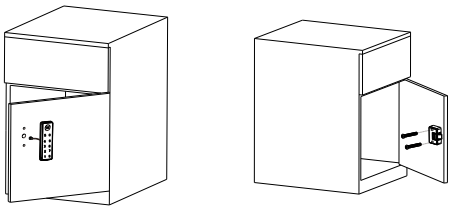

(1)

(2)

-7-

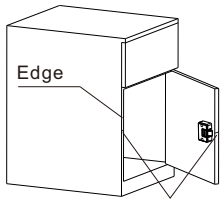

Striking plate positioning line

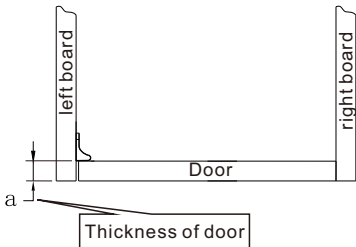

-8-