

# OPEN BOX

## KENMERKEN VAN HET PRODUCT

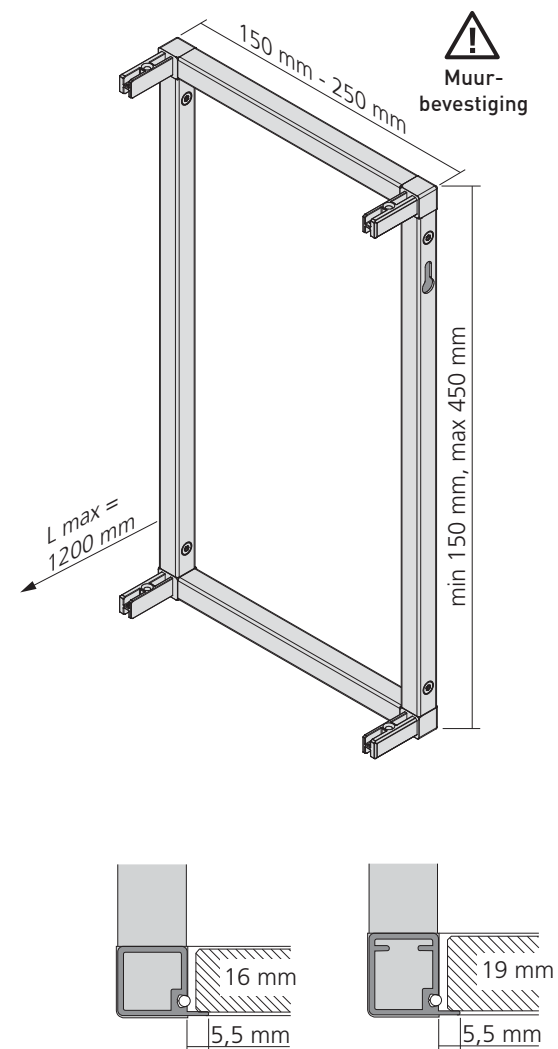
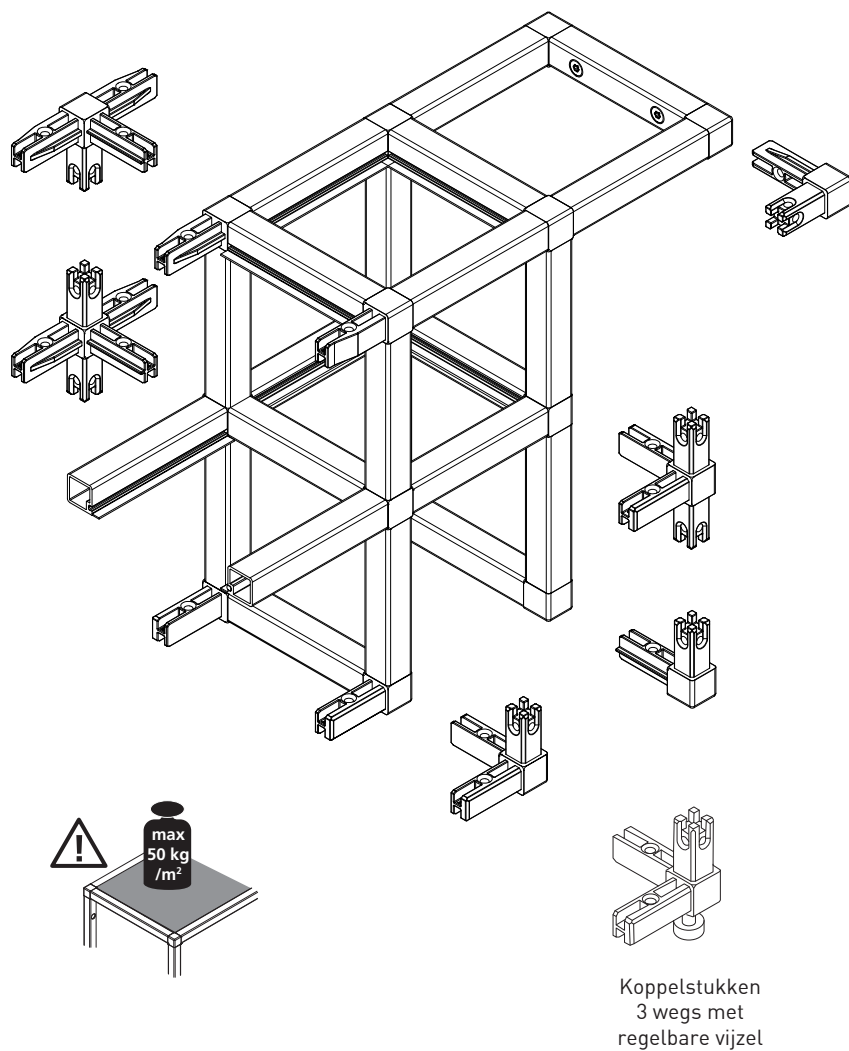

# OPEN BOX

## AFMETINGEN EN VULLINGEN

### Afmetingen panelen

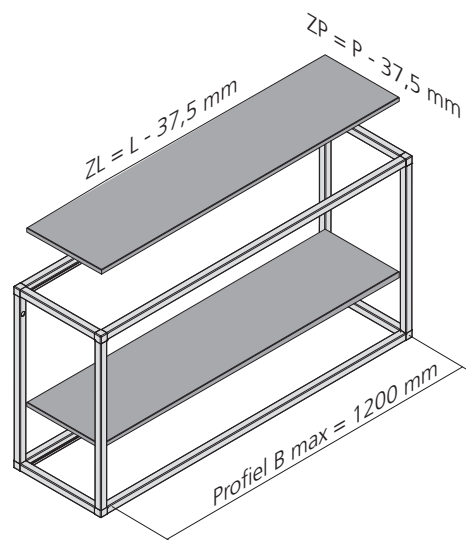
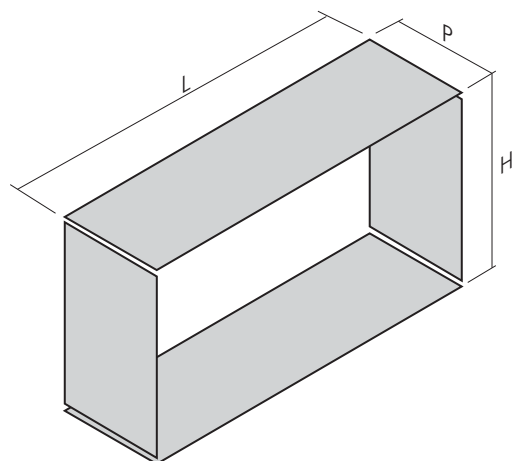

### Type profielen

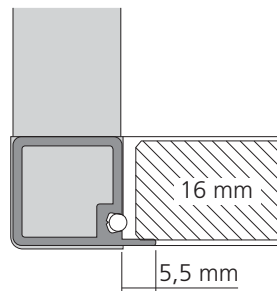

Profiel type 16

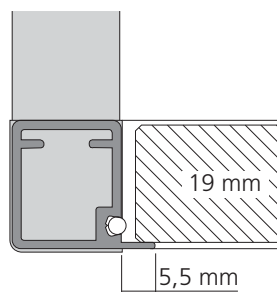

Profiel type 19

### Boring muurbevestiging

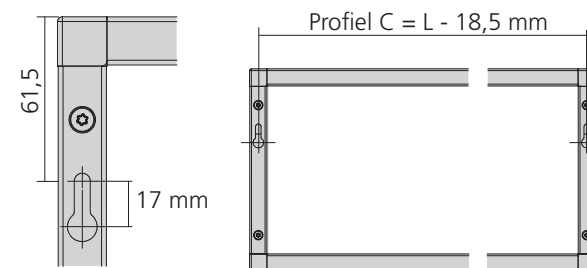

Opmeten van de montagegaten

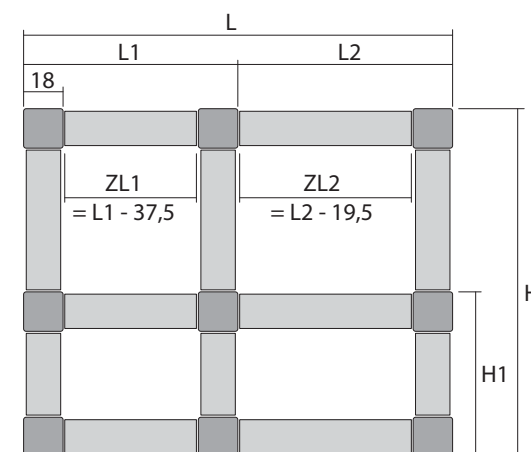

## OPEN BOX

## ASSEMBLAGE EN MUURBEVESTIGING

## Variatie in profielen

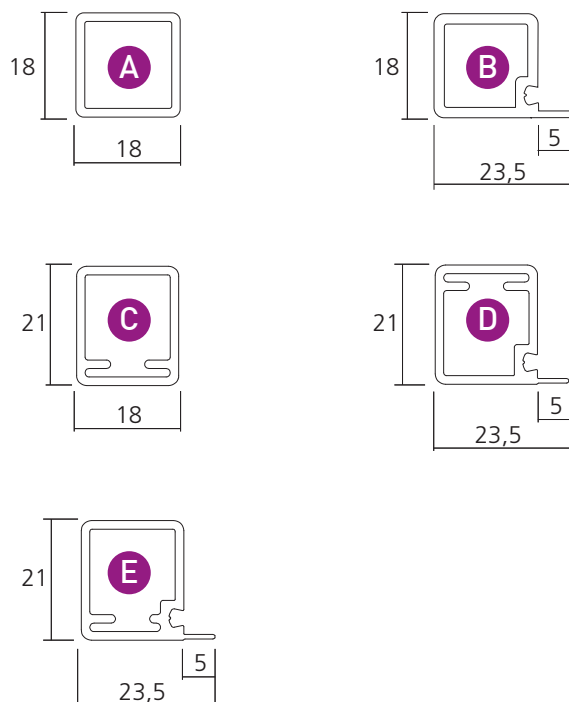

## Montage

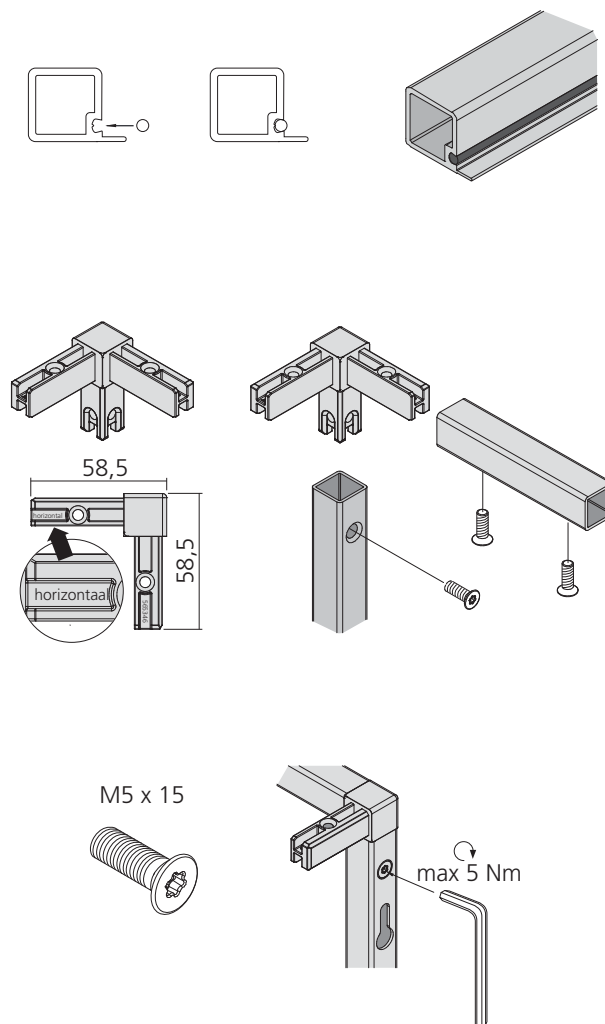

## Muurbevestiging

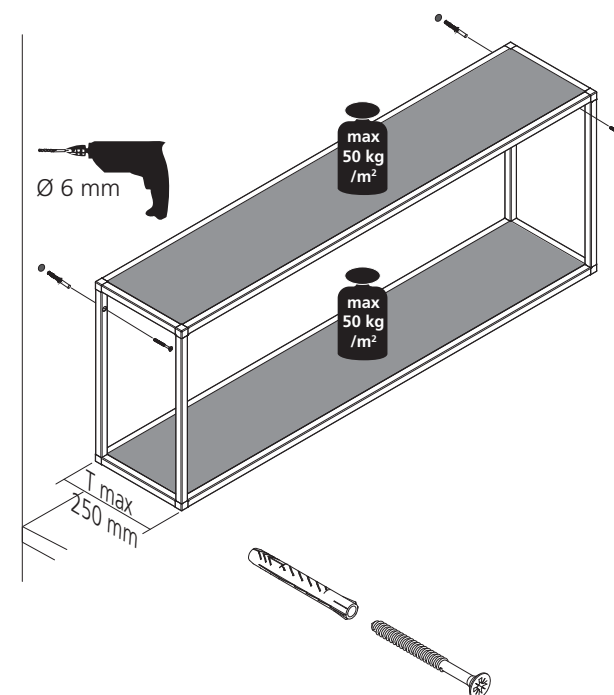

**Belangrijk :**  
Muurbevestigingen zijn alleen geschikt voor betonmuren of ander bestendig materiaal zoals baksteen. Pluggen en schroeven worden niet meegeleverd. De plaatser zorgt zelf voor aangepast bevestigingsmateriaal.

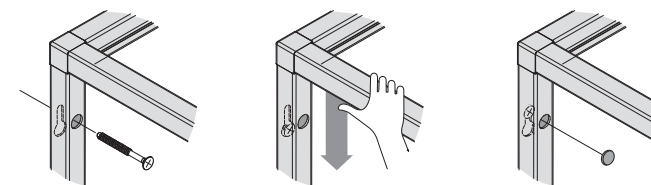

# OPEN BOX

## ASSEMBLAGE VOOR PANEEL VAN 19 MM

Open Box voor paneel van 19 mm : verbindingen veranderen niet

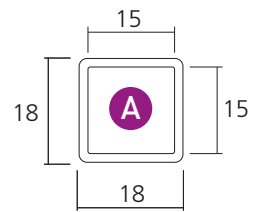

Verticaal  
kaderprofiel

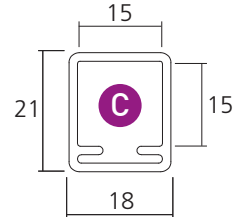

Horizontaal  
diepte-profiel

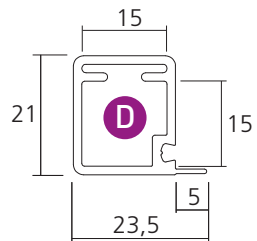

Horizontaal  
dwarsprofiel

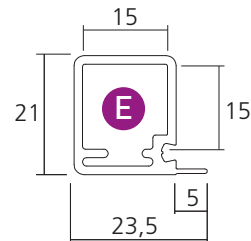

Horizontaal  
diepte-profiel

