

PICTURE 1

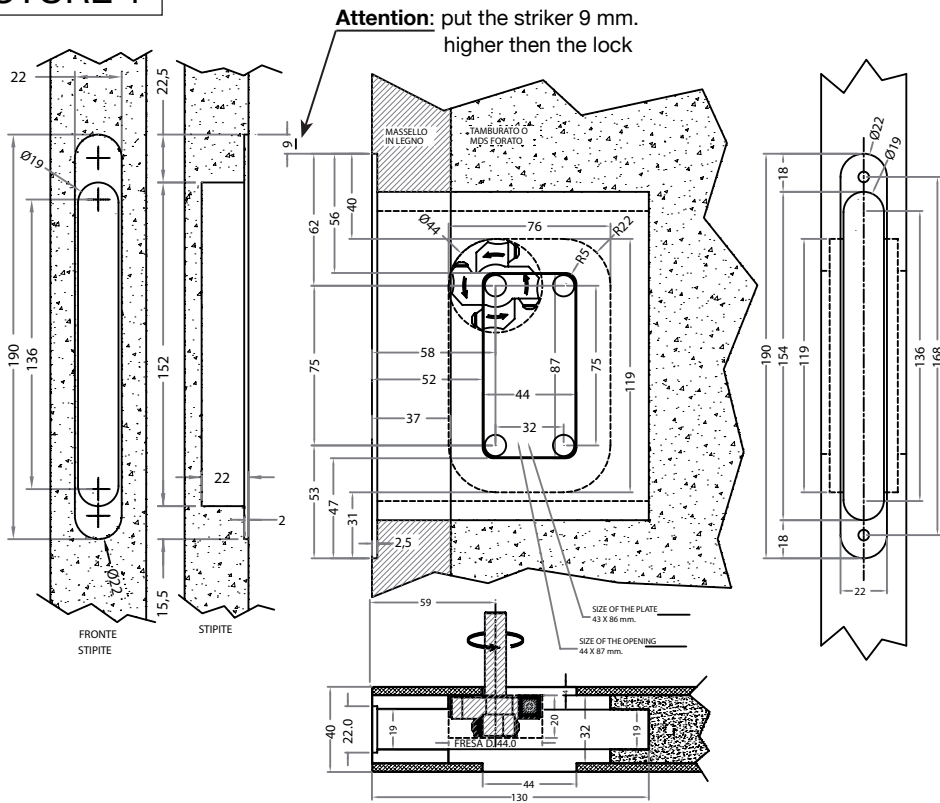

PICTURE 2

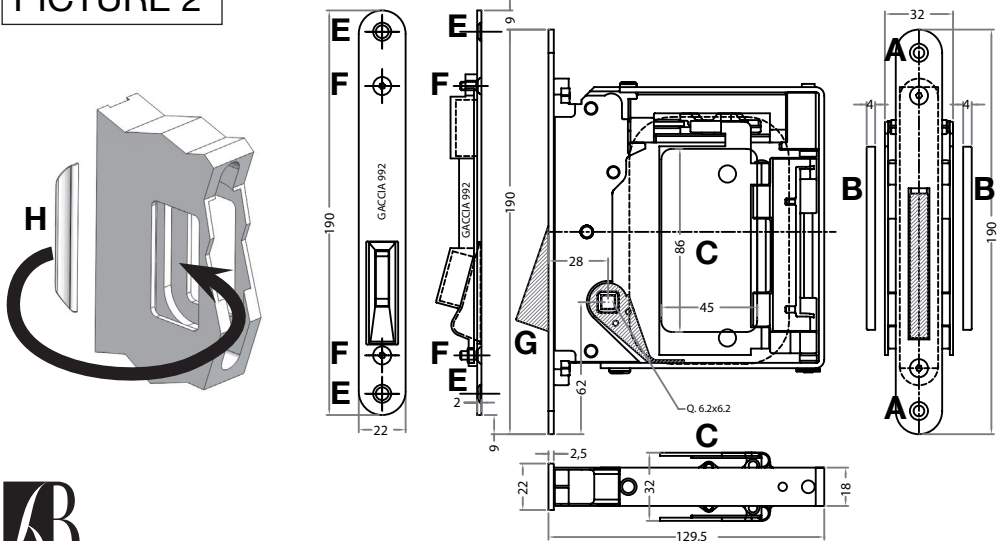

B-no ha *Collection*
B-no ha *mini* lock
 ASSEMBLING INSTRUCTIONS

ATTENTION THE B-NO.HA *MINI* LOCK CAN BE FITTED ON A TRADITIONAL DOOR, IT NEEDS A PARTICULAR MILLING IN ORDER TO CREATE THE SPACE FOR THE DEVICE MECHANISM (picture n.1).

Assembling procedure (picture n. 2)

- 1** Apply two fingerslots **H** in seat (use bi-adhesive tape included in the kit).
- 2** Remove the band which blocks the 2 sides.
- 3** Insert the lock holding the 2 sides tight.
Fix it with the 2 screws **A** on the frontal.
- 4** Put bi-adhesive tape on the back of plate-covers **B**.
- 5** Stick the first plate-cover on board **C** of plate keeping pressed the other plate on opposite side. Repeat operation for the second plate-cover.
- 6** Verify the correct lock working as follows:
 - a) Take the oscillating latch **G** out of frontal by pressing its upper side
 - b) Engage the plate-cover **B**. The latch **G** must return
 - c) Put the striker 992 opposite the frontal. The oscillating latch **G** must come out.
- 7** Fix the striker with the suitable screws **E**.
- 8** Check the door closing and eventually do the necessary regulations on striker acting on screws **F**.