

# OnE

- OnE is the new half hidden shelf support by PERMO, the only one that guarantees a double locking, first due to the joint between the support and the dowel, and second due to the cover plugs.

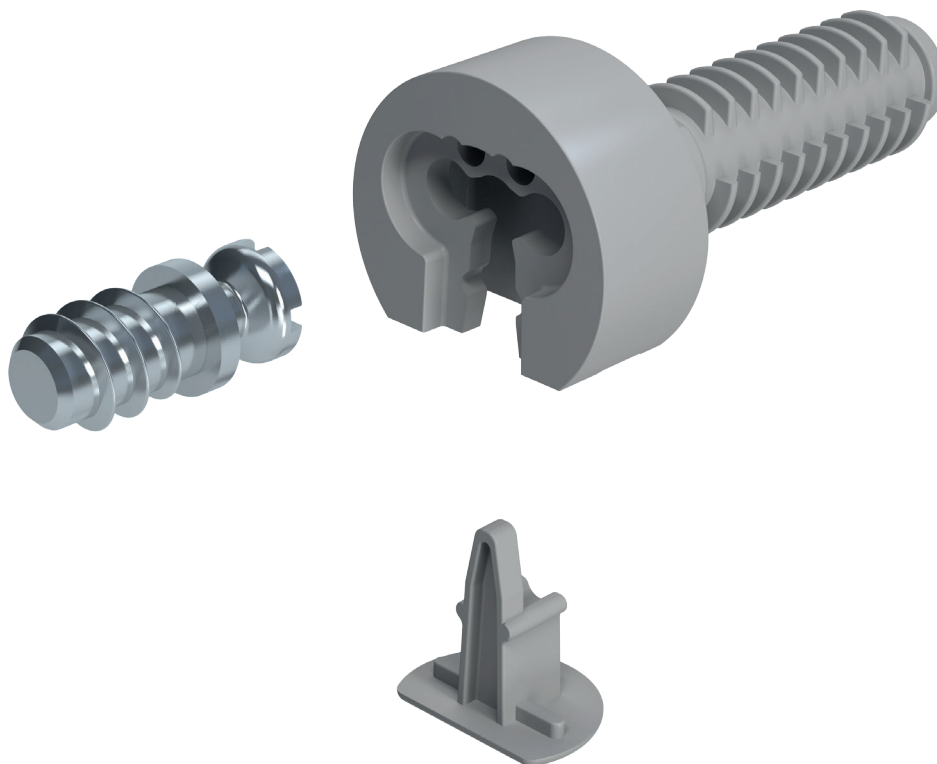

## MATERIAL Thermoplastic

Art.	Ø	L	L1	Ø1		Kg
ON01	16	8,2	30	8	5.000	12,3

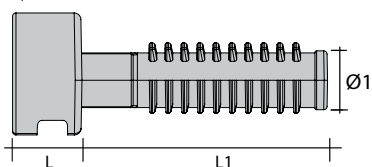

## FINISH Gray

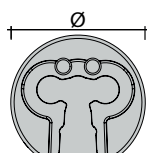

## MATERIAL Steel

Art.	L	M		Kg
TZ02	8,7	6 euro	5.000	10
TZ04	8,7	4 euro	5.000	6,3

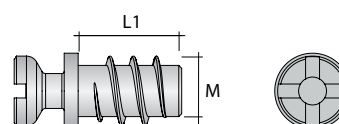

## FINISH Zinc Platted

## MATERIAL Thermoplastic

Art.	L	L1	S		Kg
CN01	9,7	14	18	5.000	1,2
CN02	9,7	14	22	5.000	1,2
CN03	9,7	14	25	5.000	1,2

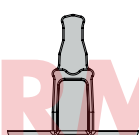
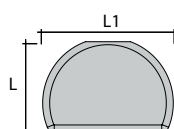

## FINISH White-Gray-Brown-Nichel Platted

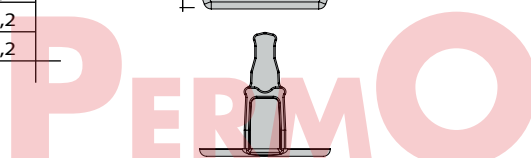

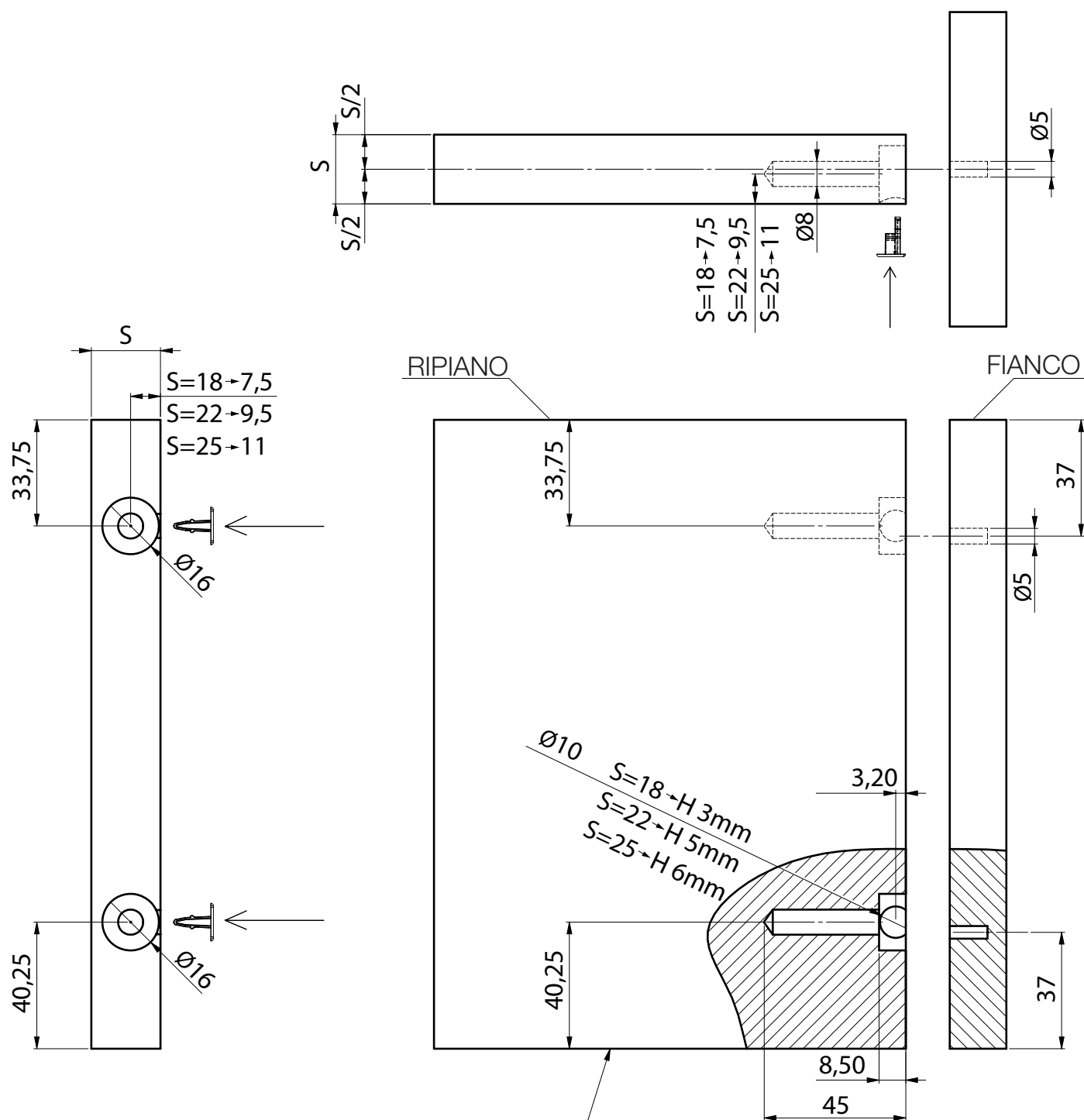

NOTE: forature calcolate con ripiano con parte frontale a filo fianco.

1

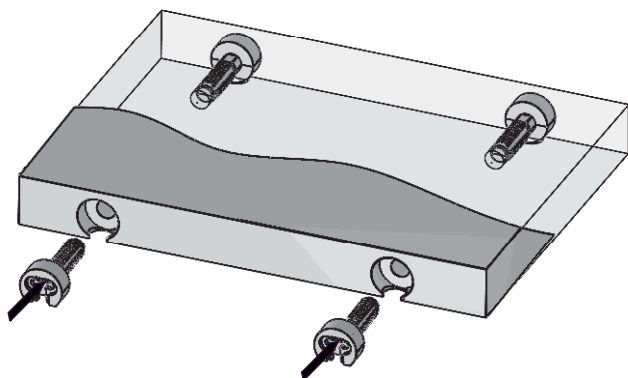

2



Insert and screw the dowels  
the appropriate holes  
on the sides of cabinet

3

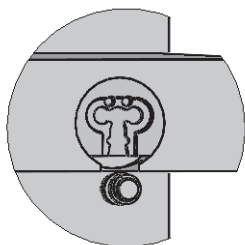
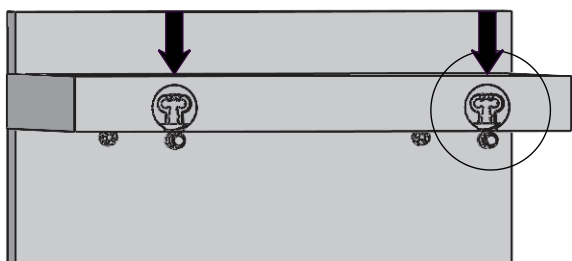

Align the slots  
with the pins  
and push down  
the shelf until  
it stops

4

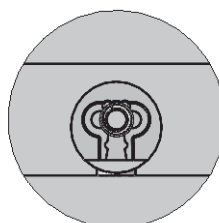
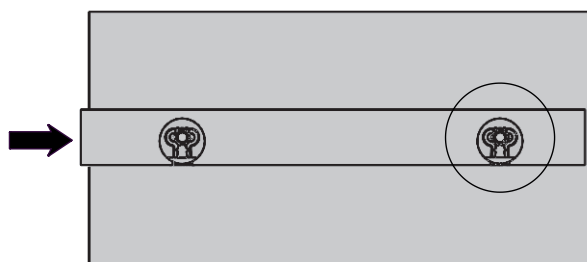

Push the front  
of the shelf  
until it stops

5

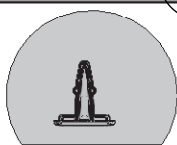
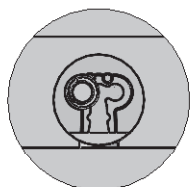
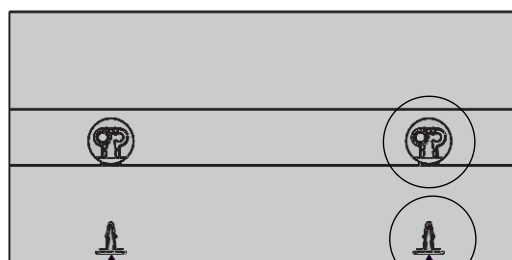

Insert the cover plugs

6

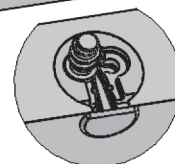
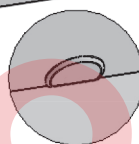
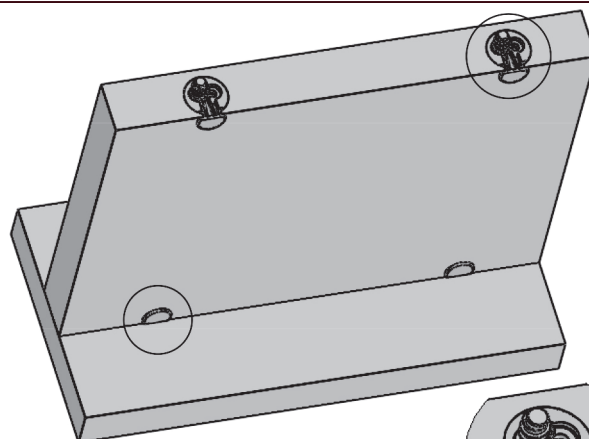

# ONE

## Deassembly sequence

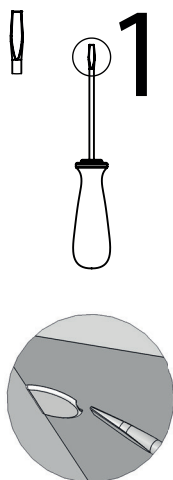
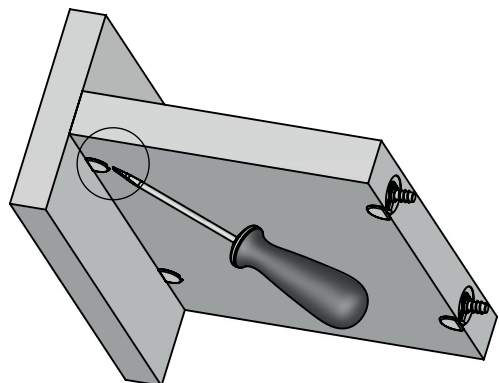

1

Insert a flathead screwdriver in the front slot of cover

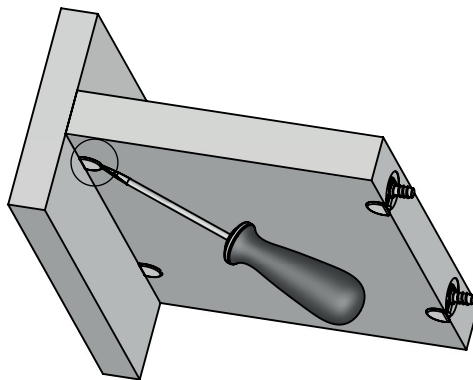

2

Push the screwdriver up front to full introduction

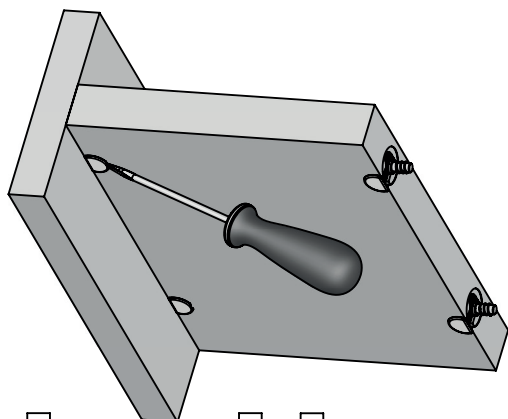

3

Push down the screwdriver

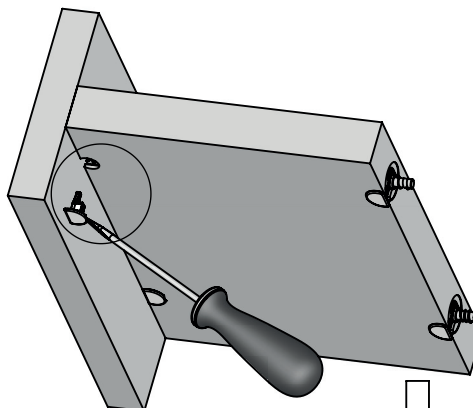

4

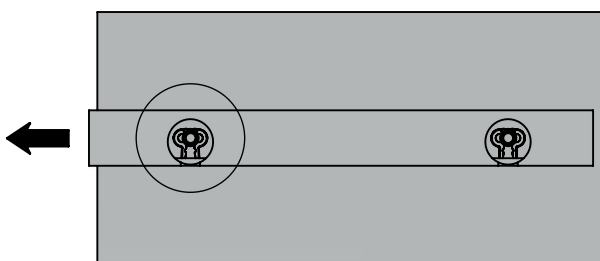
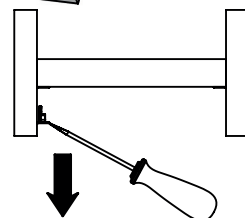
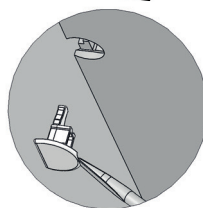

5

Pull out the shelf until it click once

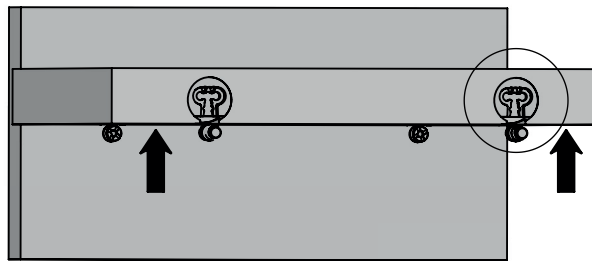
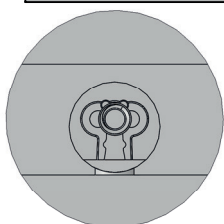

6

Raise the shelf until it exit from the support

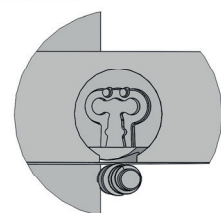

# PERMO

FURNITURE FITTINGS