

PORTE COULISSANTE BOIS
INSTRUCTIONS D'INSTALLATION

KIT DE CONSTRUCTION: BOX 1/2
BOX 2/2

KIT DE FINITION:
BOX 3



SYSTÈME DE DISTRIBUTION FACILE
3 BOX SYSTÈME





X5 BOIS - INSTRUCTIONS D'INSTALLATION

INFORMATION TECHNIQUE

| Épaisseur porte | Système Xinnix | Profilé de construction | Fw: épaisseur de mur fini | Dimension maximale de porte |
|-----------------|----------------|-------------------------|---------------------------|-----------------------------|
| 25 - 40 mm | X5 | Ω 75 | 100 mm | 2100 x 1000 mm |
| 25 - 40 mm | X5D | Ω 75 | 125 mm | 2300 x 1000 mm |
| 25 - 40 mm | X5D32 | Ω 75 | 139 mm | 3000 x 1000 mm |
| 40 - 60 mm | X5 | Ω 100 | 125 mm | 2100 x 1000 mm |
| 40 - 60 mm | X5D | Ω 100 | 150 mm | 3000 x 3000 mm |
| 40 - 60 mm | X5D32 | Ω 100 | 164 mm | 3500 x 3000 mm |

SIMPLE - DOUBLE PLACAGE

X5

X5D

X5D32

| Profilé de construction | l: espace libre interne |
|-------------------------|-------------------------|
| Ω 75 | 52 mm |
| Ω 100 | 77 mm |

Autres types de profil (Ω 70 - Ω 90) sur demande

→ épaisseur de plaque 18 - 12,5 mm
ou
15 - 15 mm

OUVERTURE DE LA CONSTRUCTION

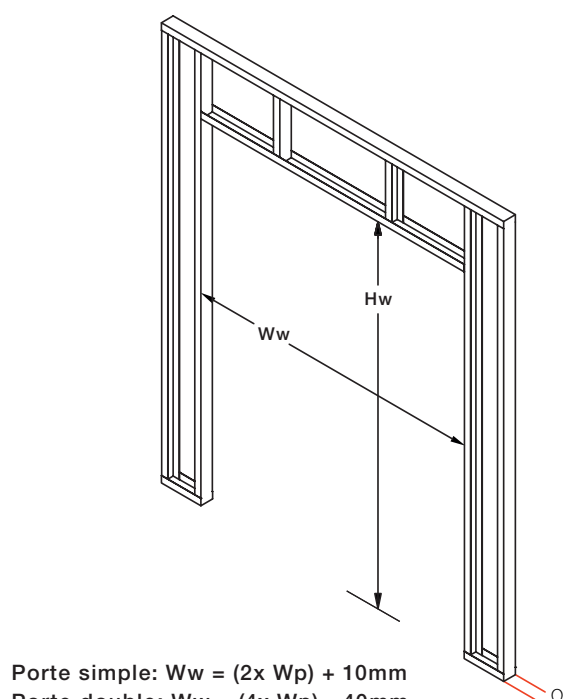

Porte simple: $Ww = (2 \times Wp) + 10mm$
 Porte double: $Ww = (4 \times Wp) - 40mm$

Ww : Largeur de la construction
 Hw : Hauteur de la construction
 Wp : Largeur panneau de porte
 Hp : Hauteur panneau de porte

FINITION

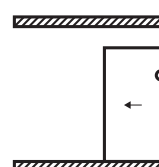

XINNIX

$Hw = Hp + 90mm$

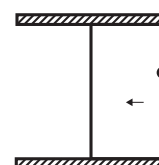

PURE

$Hw = Hp + 70mm$

RAIL + GARNITURE

- Xinnix Selection
- S-Line : HAWA-Junior 80

X5 BOIS - INSTRUCTIONS D'INSTALLATION: PORTE SIMPLE

1 TRAVERSE [C] + RAIL [R] + PLAQUE DE BASE [BP] + STOP DANS RAIL [ST]

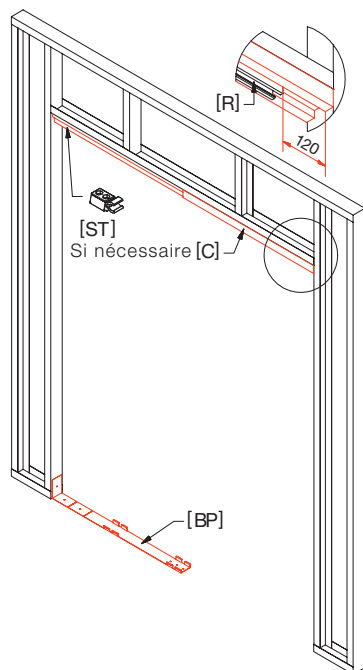

2 MONTANTS [U] + SUPPORTS DE BROSSES [BH]

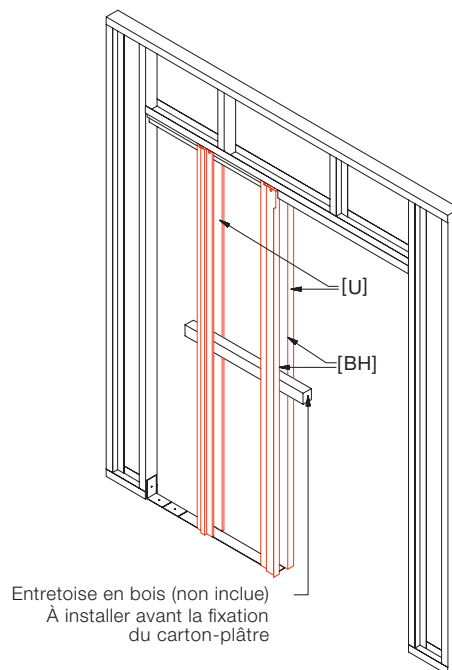

3 FINITION [B] + JOINTS D'ÉTANCHÉITÉÉ [G]

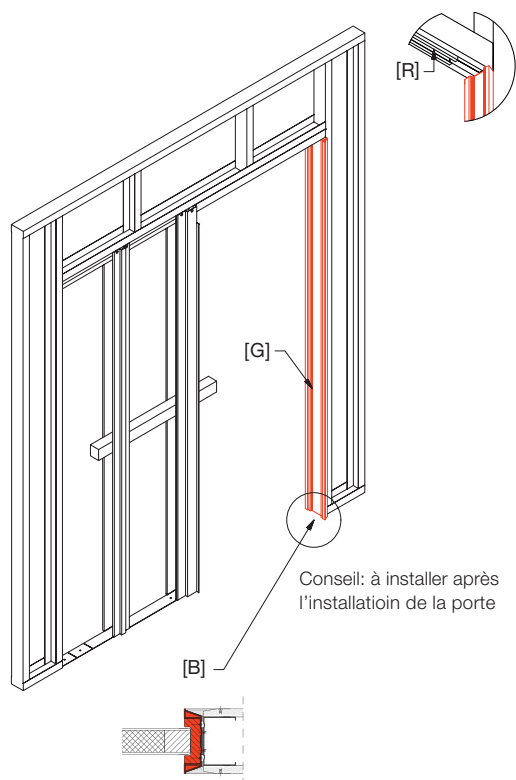

4 SIMPLE - DOUBLE PLACAGE

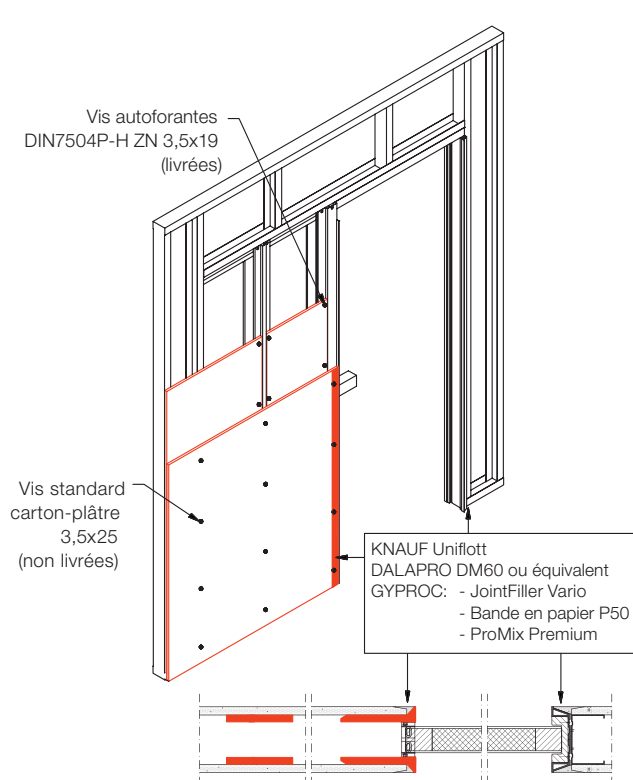

PANNEAU DE PORTE

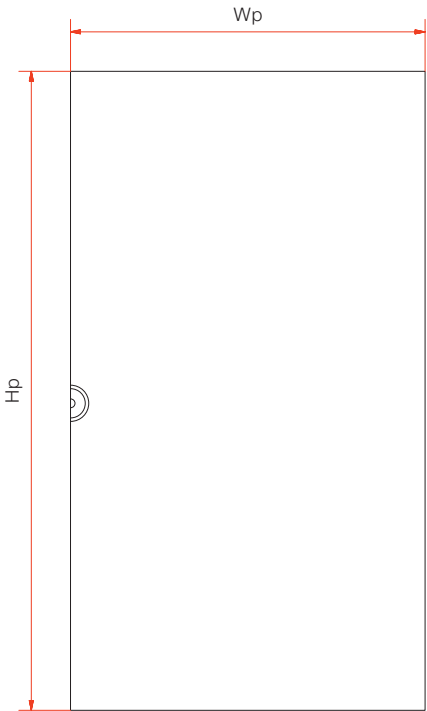

1 ADAPTER TRAVERSE [C] + RAIL [R]

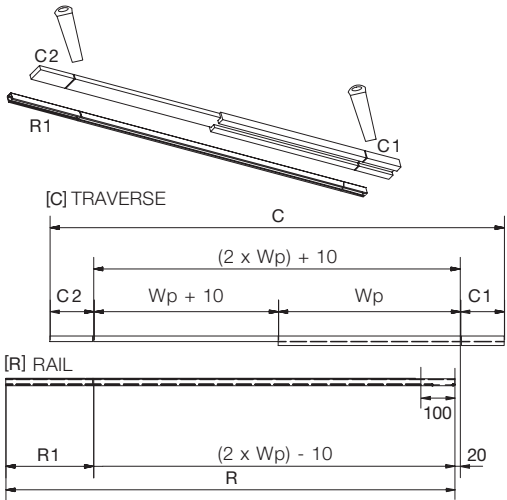

| Art. code | C | Wp | C1 | C2 | R | R1 | Largeur Passage |
|------------------|------|------|-----|-----|------|-----|-----------------|
| X5-1030 | 2070 | 630 | 400 | 400 | 2050 | 800 | 600 |
| | | 730 | 300 | 300 | | 600 | 700 |
| | | 830 | 200 | 200 | | 400 | 800 |
| | | 930 | 100 | 100 | | 200 | 900 |
| | | 1030 | - | - | | - | 1000 |
| X5-1230 | 2470 | 1130 | 100 | 100 | 2450 | 200 | 1100 |
| | | 1230 | - | - | | - | 1200 |
| X5-1530 | 3070 | 1330 | 200 | 200 | 3050 | 400 | 1300 |
| | | 1430 | 100 | 100 | | 200 | 1400 |
| | | 1530 | - | - | | - | 1500 |
| Dimensions fixes | | | | | | | |
| X5-0830 | 1670 | 830 | - | - | 1650 | - | 800 |
| X5-0930 | 1870 | 930 | - | - | 1850 | - | 900 |

2 MONTANTS X5 - X5D [U]

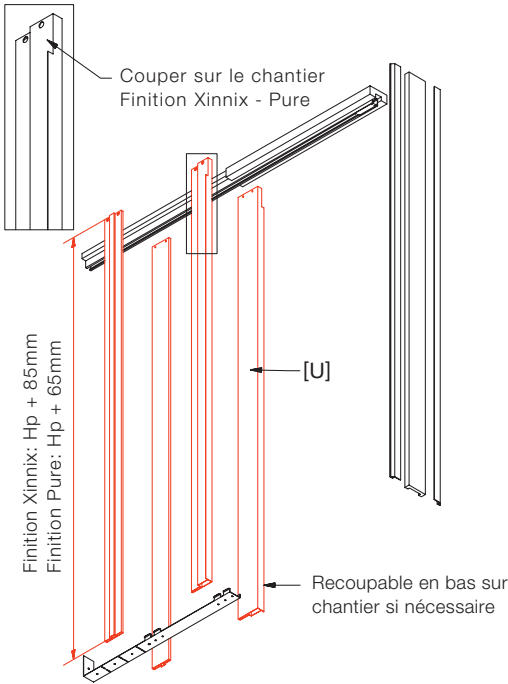

3 FINITION [B]

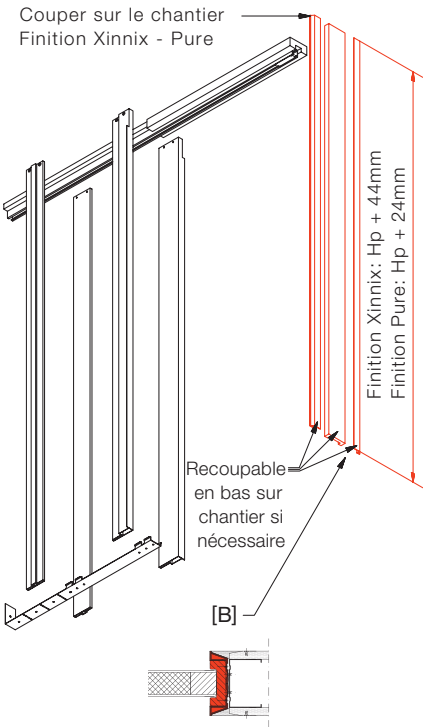

X5 BOIS - INSTRUCTIONS D'INSTALLATION: PORTE DOUBLE

1 TRAVERSES [C] + RAILS [R] + PLAQUES DE BASE [BP] + STOPS DANS RAIL [ST]

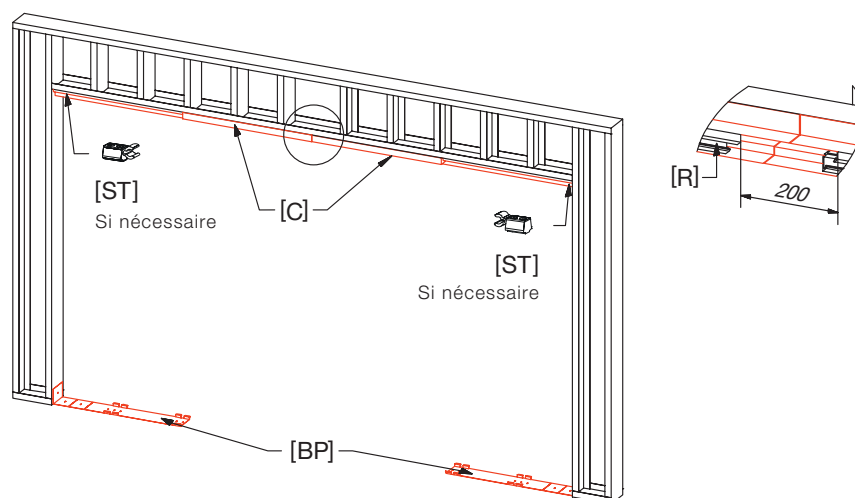

2 MONTANTS [U] + SUPPORTS DE BROSSES [B]

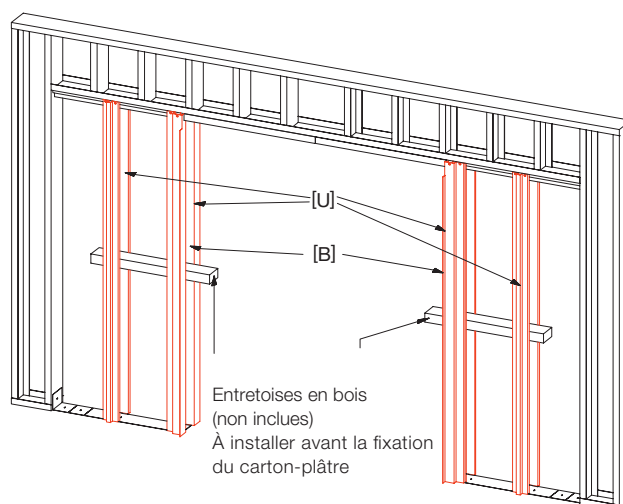

3 SIMPLE-DOUBLE PLACAGE

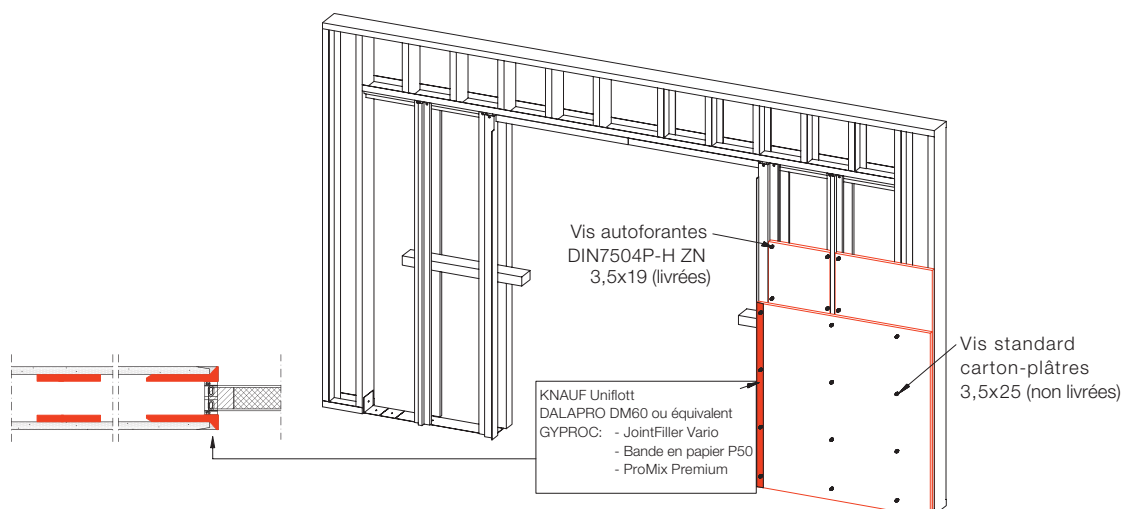

X5 BOIS - INSTRUCTION D'INSTALLATION: PORTE DOUBLE FORMULES

2 x PANNEAU DE PORTE IDENTIQUE

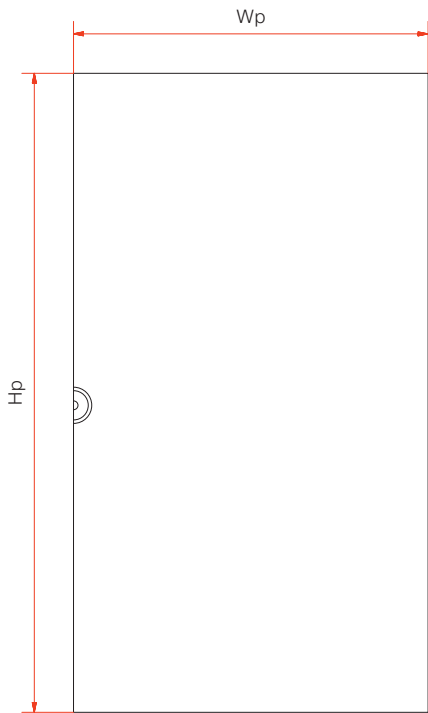

1 ADAPTER TRAVERSES [C] + RAILS [R]

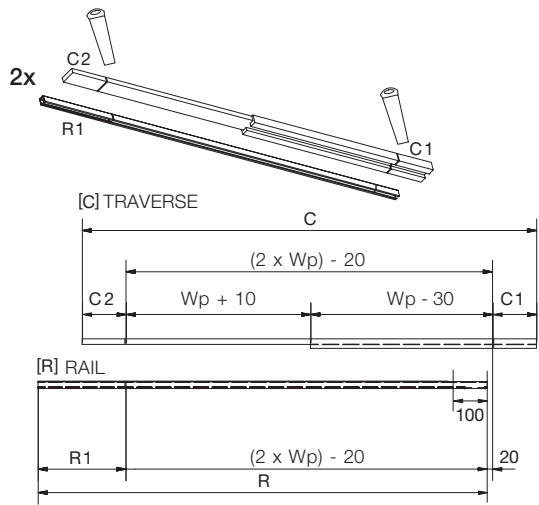

| Art. code | C | Wp | C1 | C2 | R | R1 | Largeur Passage |
|------------------|------|------|-----|-----|------|-----|-----------------|
| X5-1030 | 2070 | 630 | 430 | 400 | 2050 | 810 | 1200 |
| | | 730 | 330 | 300 | | 610 | 1400 |
| | | 830 | 230 | 200 | | 410 | 1600 |
| | | 930 | 130 | 100 | | 210 | 1800 |
| | | 1030 | 30 | - | | 10 | 2000 |
| X5-1230 | 2470 | 1130 | 130 | 100 | 2450 | 210 | 2200 |
| | | 1230 | 30 | - | | 10 | 2400 |
| X5-1530 | 3070 | 1330 | 230 | 200 | 3050 | 410 | 2600 |
| | | 1430 | 130 | 100 | | 210 | 2800 |
| | | 1530 | 30 | - | | 10 | 3000 |
| Dimensions fixes | | | | | | | |
| X5-0830 | 1670 | 830 | - | - | 1660 | - | 800 |
| X5-0930 | 1870 | 930 | - | - | 1860 | - | 900 |

2 MONTANTS X5 - X5D [U]

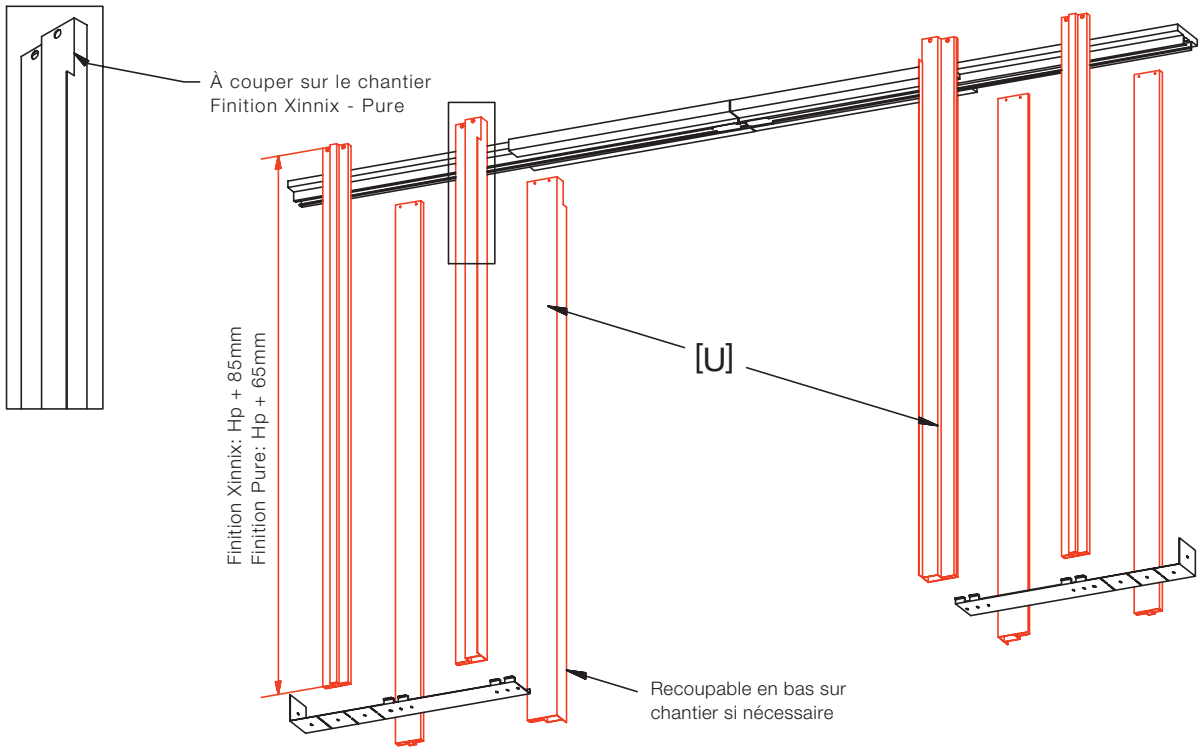

X5 BOIS - INSTRUCTIONS D'INSTALLATION: FINITION

PORTE SIMPLE

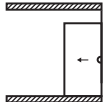
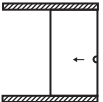
| | | | |
|---|--------------------------------|--|--|
| | À INDiquer LORS DE LA COMMANDE |  XINNIX |  PURE |
| | PLACAGE | X5 - X5D - X5D32 | - |
| | HAUTEUR PASSAGE | 2300 - 2700 - 3000 mm | 2300 - 2700 - 3000 mm |
| | EPAISSEUR MUR | 100 - 125 - 139 - 150 - 164 mm | 100 - 125 - 139 - 150 - 164 mm |
| | LARGEUR PASSAGE | < 1230 mm (1) * 1230 - 2000 mm (2) * 2000 - 3000 mm (3) * | - |
| TYPE | | - | Xinnix selection / S-line Hawa |
| * nombres de profilé de finition A | | | |

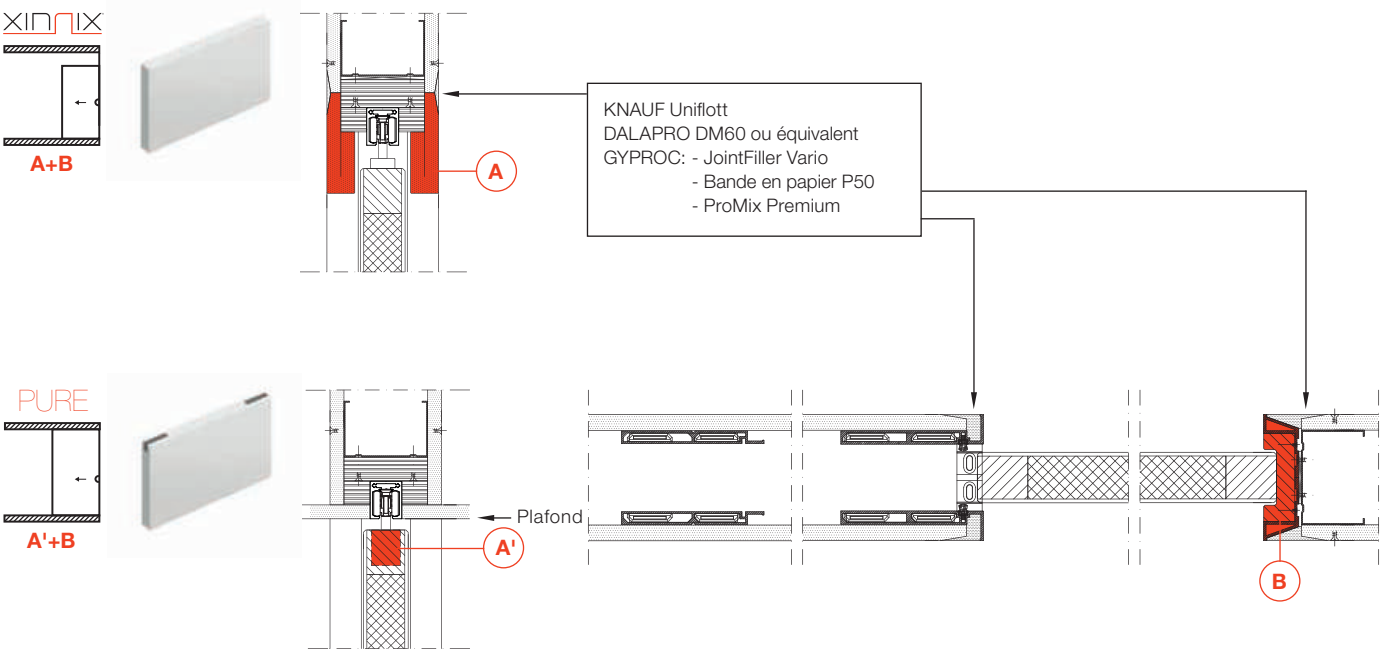

PORTE DOUBLE

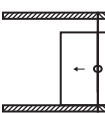
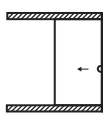
| | | | |
|--|--------------------------------|--|--|
| | À INDiquer LORS DE LA COMMANDE |  XINNIX |  PURE |
| | | SEULEMENT 2x Part A | SEULEMENT 2x Set A' |
| | PLACAGE | X5 - X5D - X5D32 | - |
| | LARGEUR PASSAGE | < 2000 mm (2) * 2000 - 4000 mm (4) * 4000 - 6000 mm (6) * | - |
| | TYPE | - | Xinnix selection / S-line Hawa |
| * nombres de profilés de finition A | | | |

X5 BOIS - INSTRUCTION D'INSTALLATION: PORTE XINNIX SELECTION

PORTE POUR XINNIX SELECTION + FINITION XINNIX

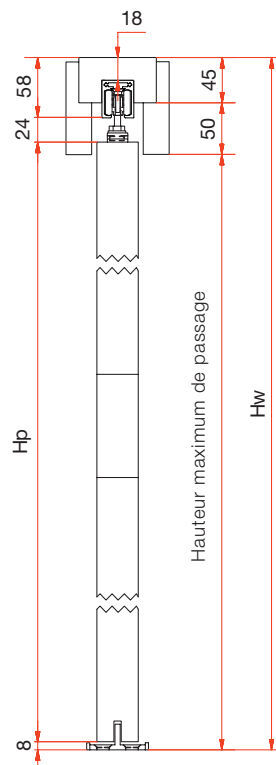
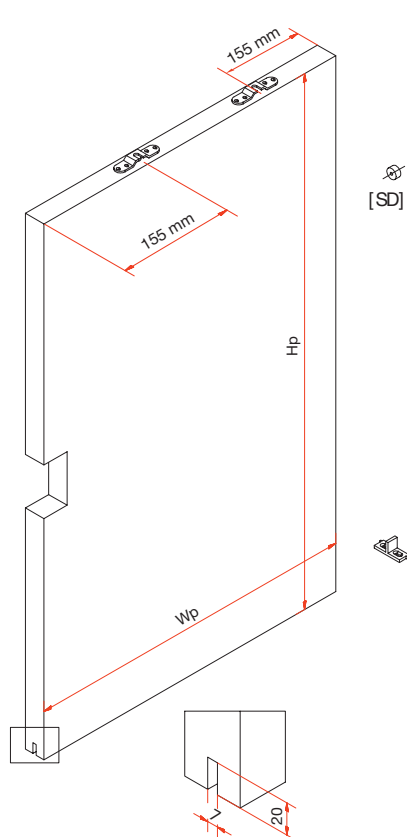

Garniture:
Xinnix selection

Finition: Xinnix

Guide inférieure: Xinnix
 $H_w = H_p + 90\text{mm}$

Hauteur maximum de passage
 $= H_p - 4\text{mm}$

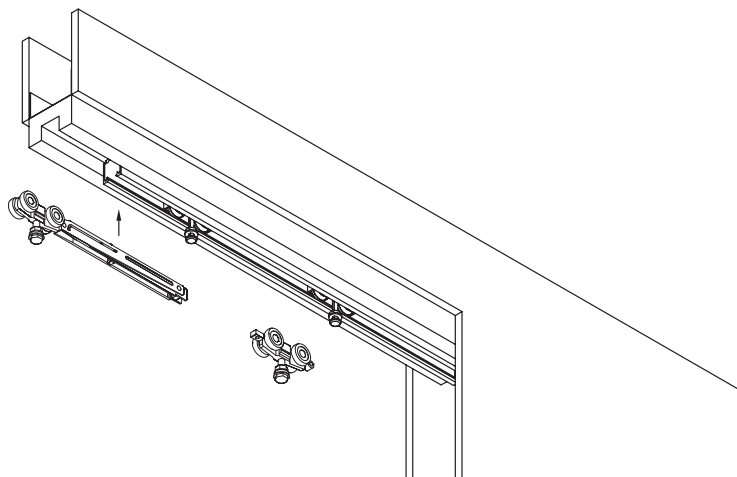
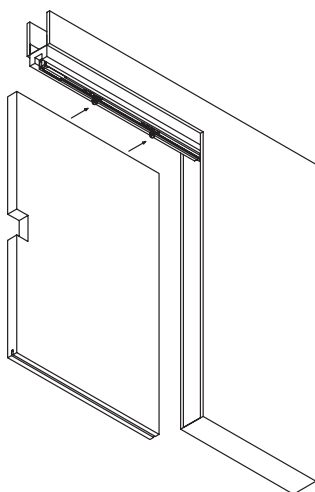

[ST]

Si nécessaire

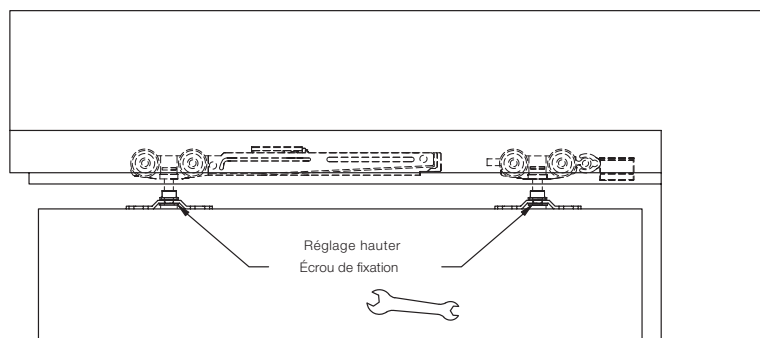
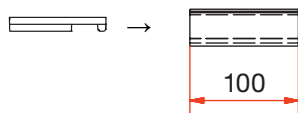

X5 BOIS - INSTRUCTIONS D'INSTALLATION: PORTE XINNIX SELECTION

PORTE POUR XINNIX SELECTION + FINITION PURE

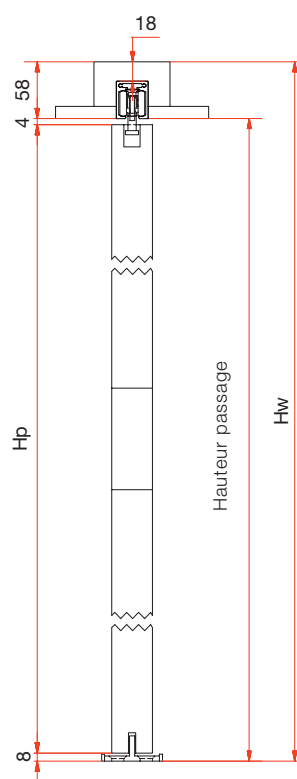
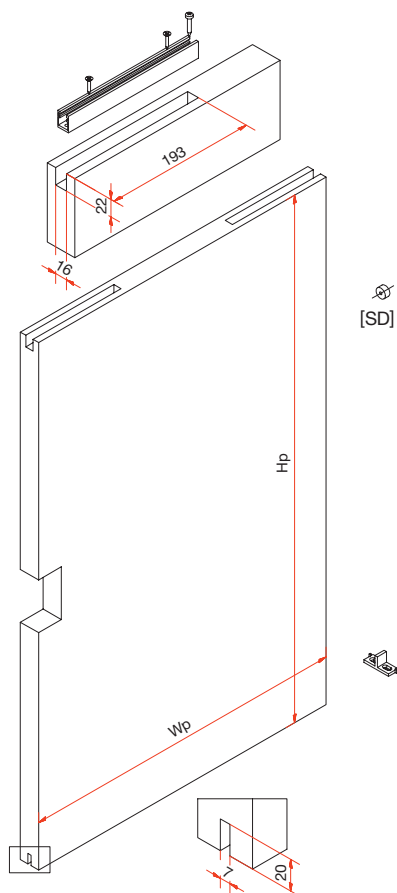

Garniture:
Xinnix Selection Pure

Finition: Pure

Guide inférieure: Xinnix
 $H_w = H_p + 70\text{mm}$

Hauteur passage
 $= H_p + 14\text{mm}$

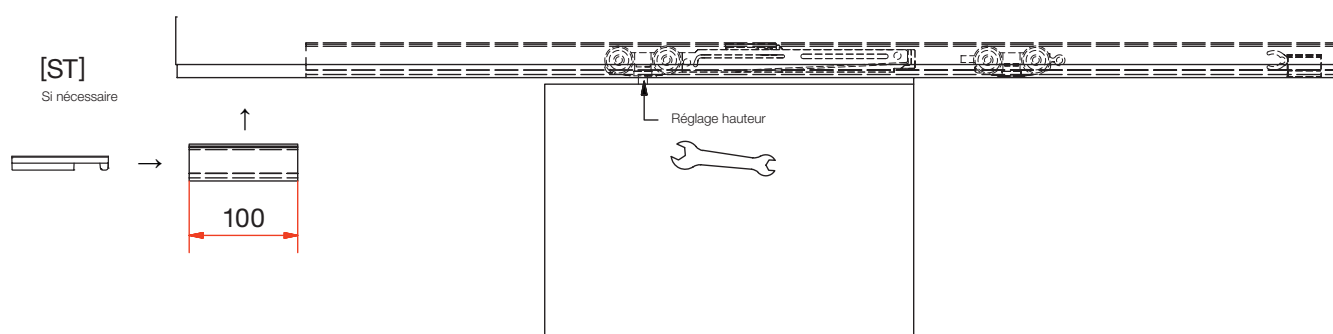
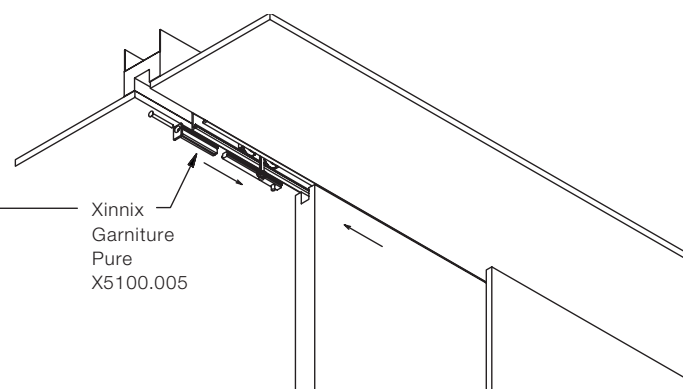
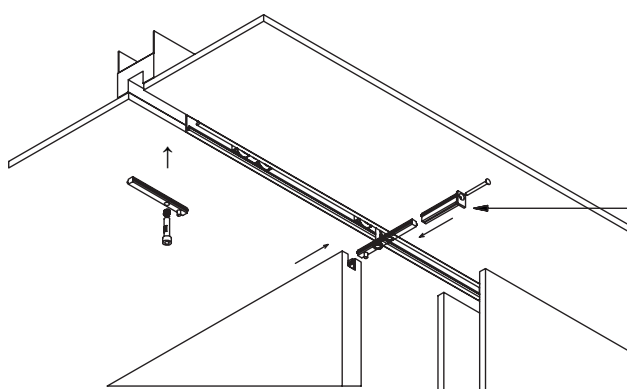

DIMENSIONS - MAX CAPACITÉ 80 KG

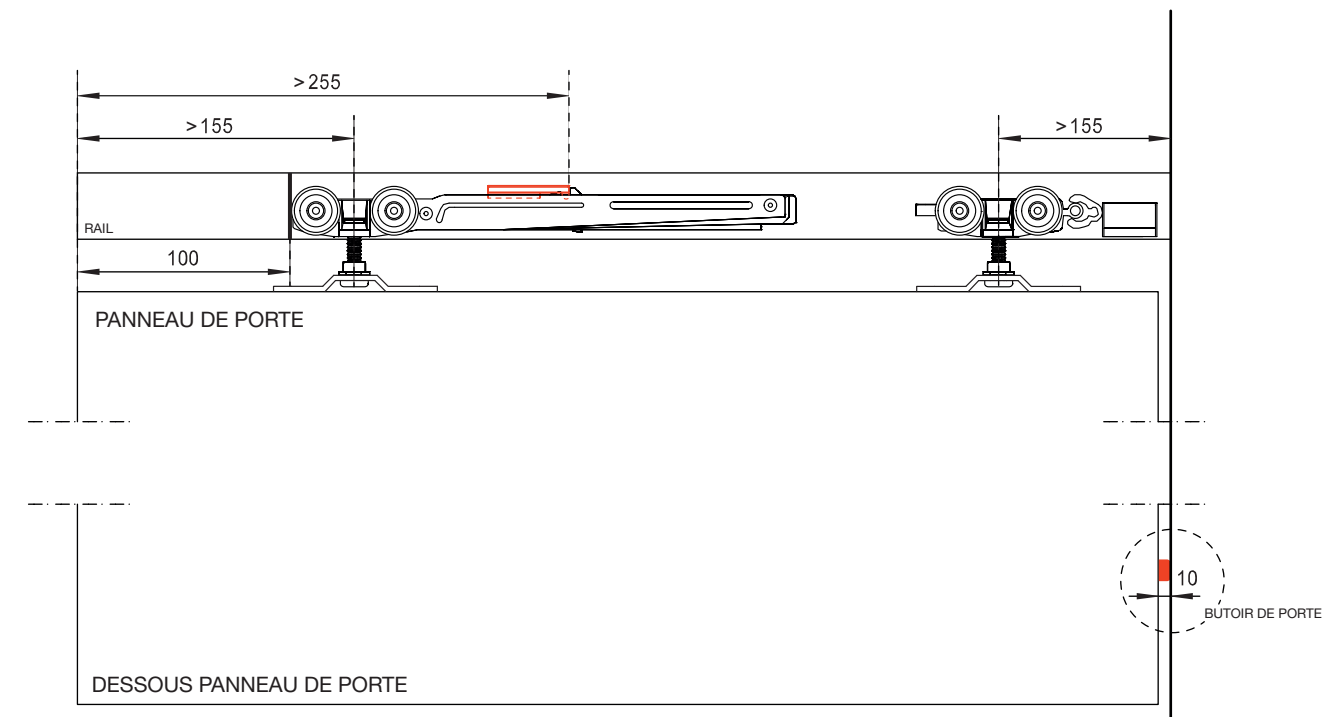

PRINCIPE D'INSTALLATION (DÉTAILS SUPPLÉMENTAIRES VOIR BOX X5100.080)

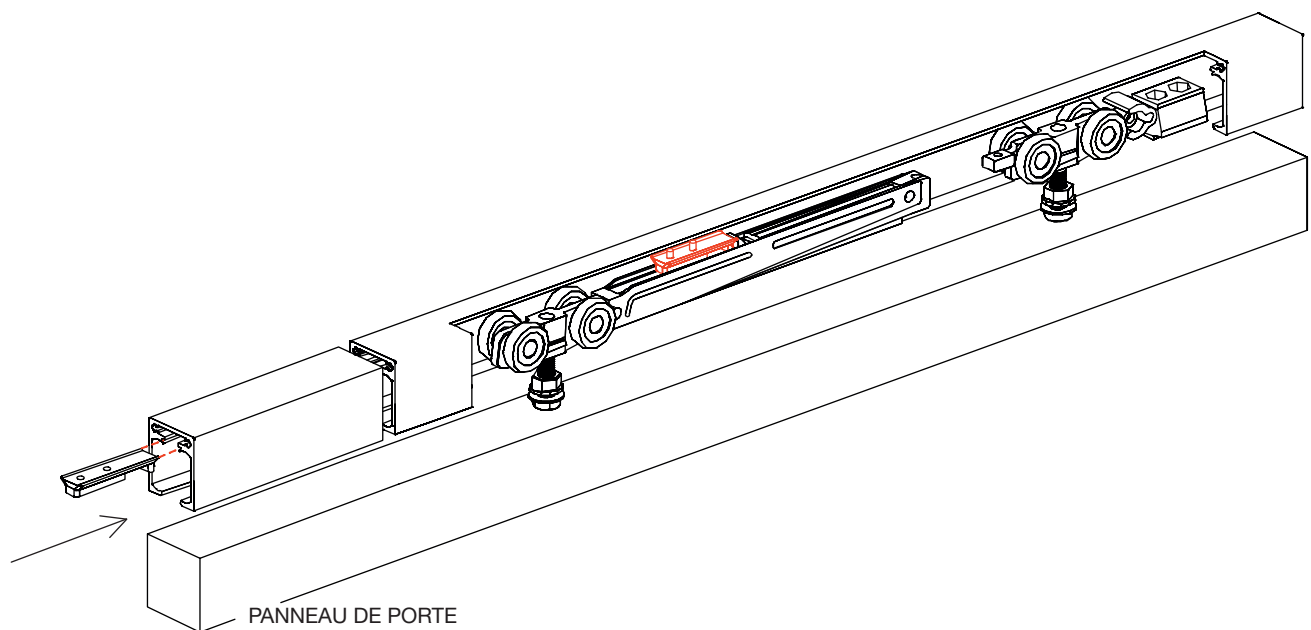

X5 BOIS - INSTRUCTIONS D'INSTALLATION: PORTE S-LINE HAWA

PORTE POUR HAWA-JUNIOR 80/Z + FINITION XINNIX

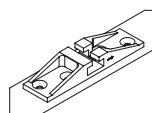
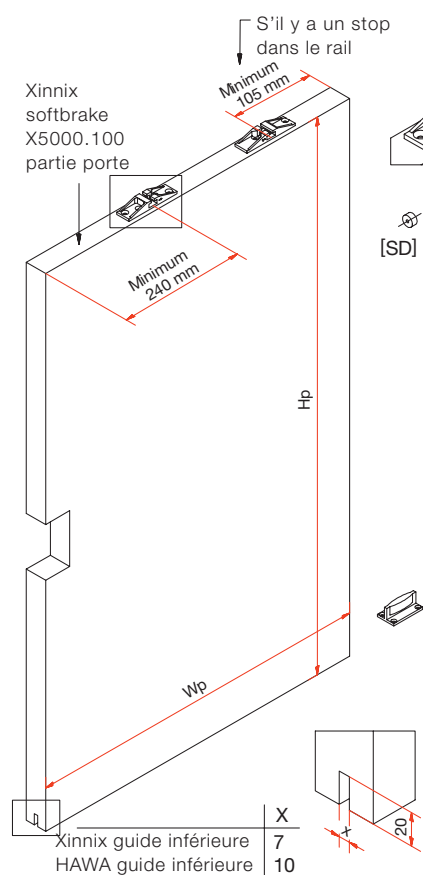

[SD]

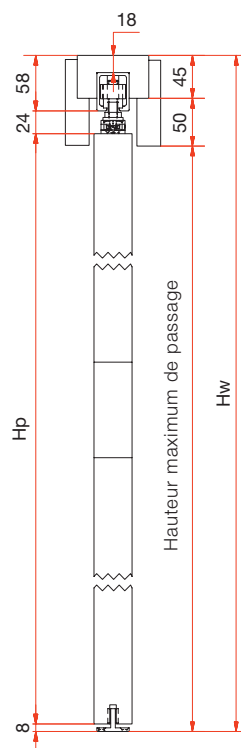

Garniture:
HAWA-Junior 80/Z

Finition: Xinnix

Guide inférieure: Xinnix / HAWA
 $Hw = Hp + 90mm$

Hauteur passage
 $= Hp - 5mm$

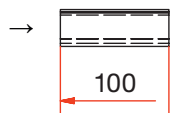
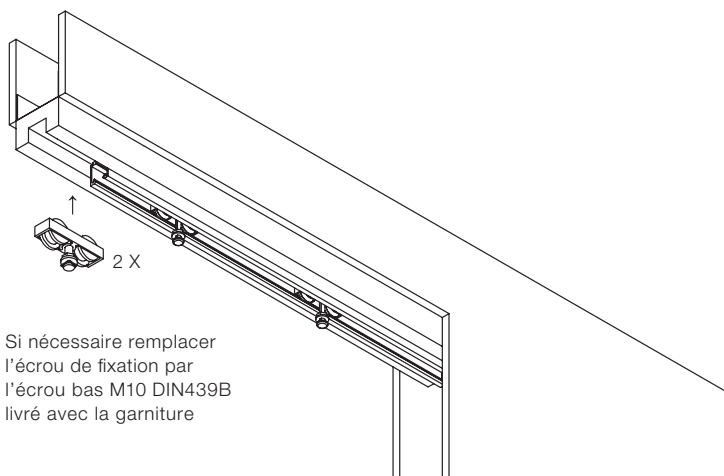
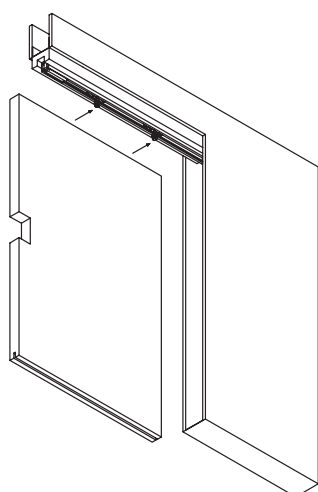

Xinnix softclose X5000.100 partie rail

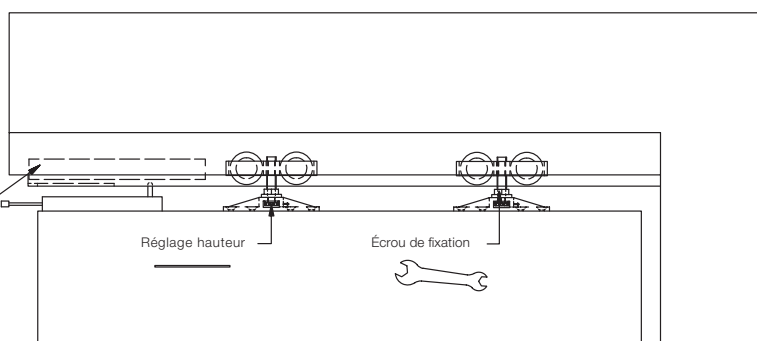

X5 BOIS - INSTRUCTION D'INSTALLATION: PORTE S-LINE HAWA

PORTE POUR HAWA-JUNIOR 80/B + FINITION PURE

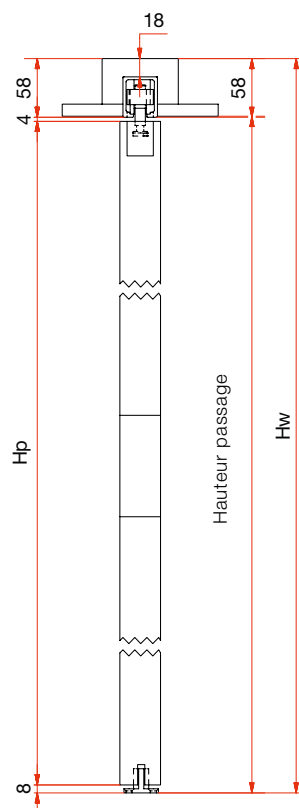
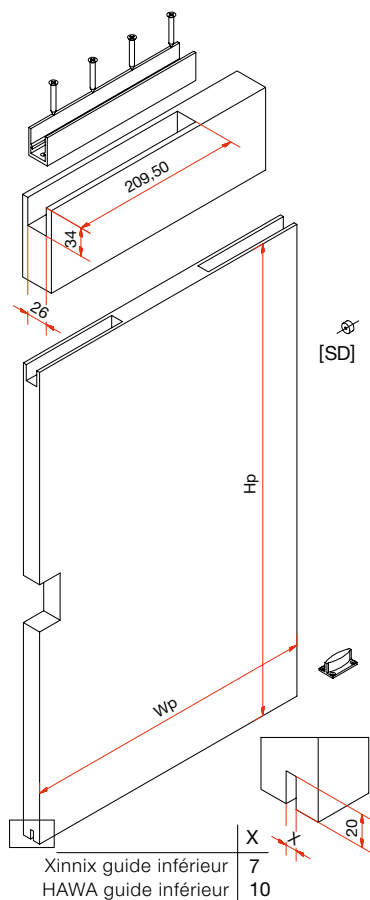

Garniture:
HAWA-Junior 80/B

Finition: Pure

Guide inférieure: Xinnix / HAWA
 $H_w = H_p + 70\text{mm}$

Hauteur passage
 $= H_p + 12\text{mm}$

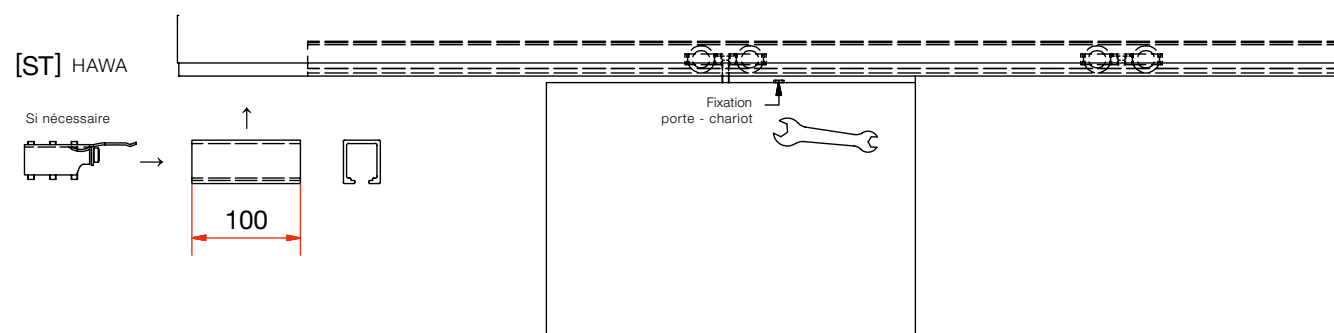
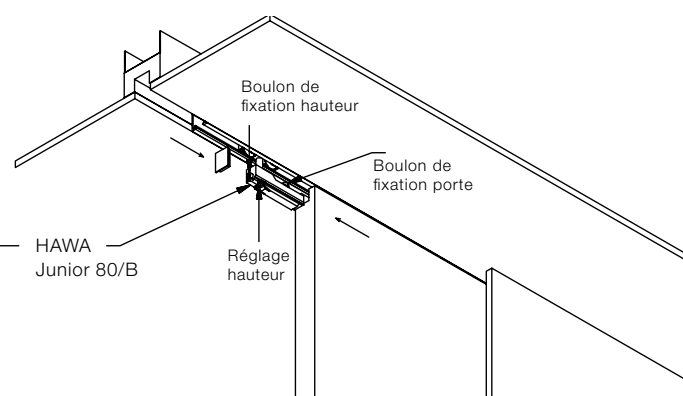
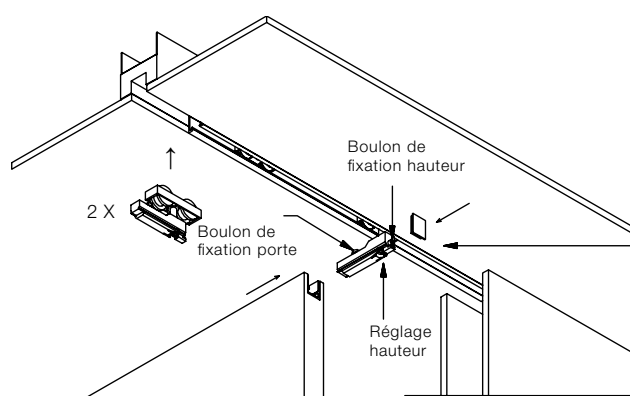

DIMENSIONS - MAX CAPACITÉ 25/60 KG

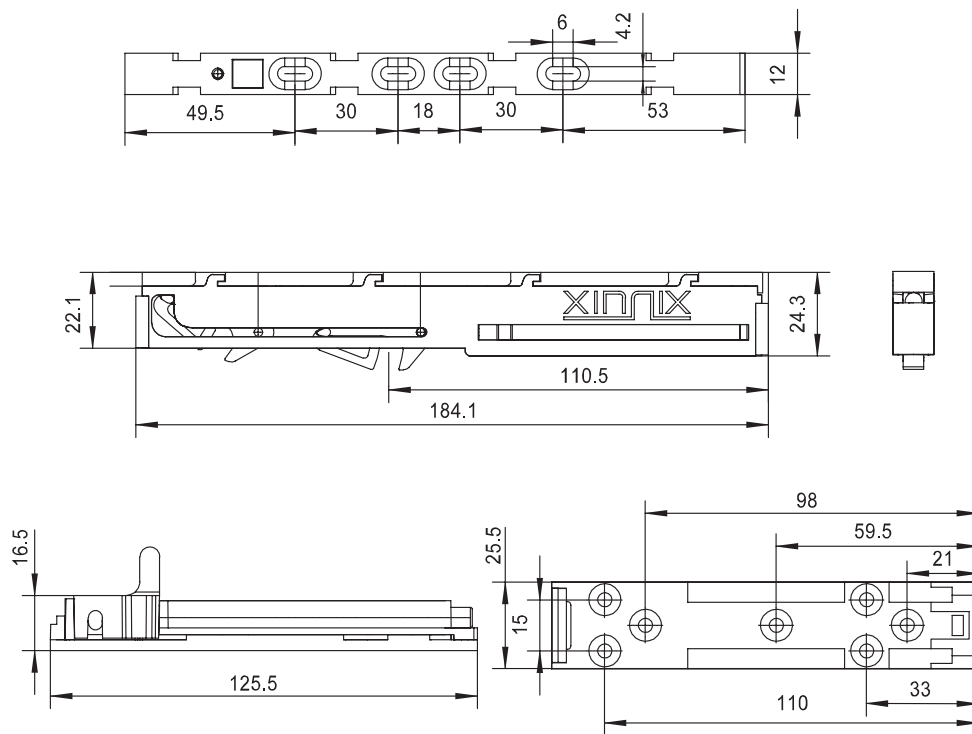



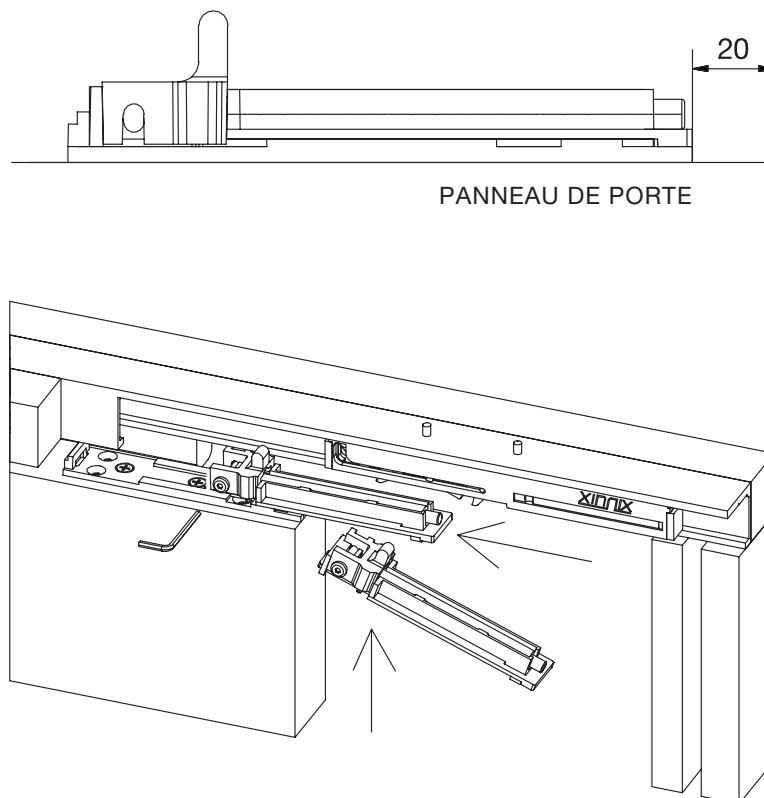







PRINCIPE D'INSTALLATION (PLUS DE DÉTAILS VOIR BOX X5000.100)

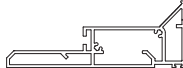

X5 BOIS - INSTRUCTIONS D'INSTALLATION: LISTE DES ÉLÉMENTS

BOX 1: KIT DE CONSTRUCTION

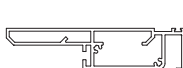
| | | | |
|-------|---|---|--|
| X5 |  |  | Montants X5 [U] et supports de brosses [B] |
| |  |  | |
| ou | | | |
| X5D |  |  | Montants X5D [U] |
| |  |  | |
| ou | | | |
| X5D32 |  |  | Montants X5D32 [U] |
| |  |  | |

BOX 2: KIT DE CONSTRUCTION

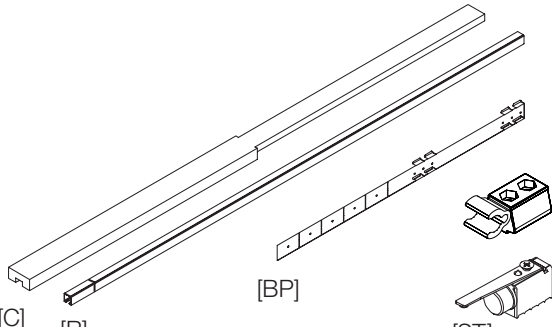
| | |
|--|--|
|  | [C]: Traverse pour rail Xinnix ou HAWA |
| | [R]: Rail Xinnix ou HAWA |
| | [BP]: Plaque de base |
| | [ST]: Stop Xinnix ou HAWA |
| | [B]: Brosses standard profilé de construction $\Omega 75$: 5 mm (sur demande 9-15 mm) |
| | [B]: Brosses standard profilé de construction $\Omega 100$: 19 mm (sur demande 5-9-15 mm) |
| | Vis DIN 7981 3,5x20 mm pour fixer les montants |
| | Vis DIN 7504 3,5x19 mm pour fixer le carton-plâtre |
| | Garniture porte coulissante, pare-choc, clé d'installation et fermeture softbrake: |
| | Xinnix Selection ou S-Line: HAWA Junior-80 |



BOX 3: KIT FINITION

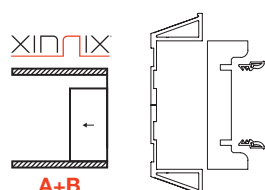

[B] profilés de finition et joints d'étanchéité pour profilés de construction Ω75 ou Ω100

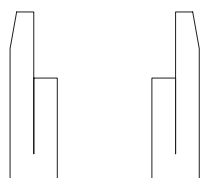

[A] profilés de finition pour montants X5 ou X5D

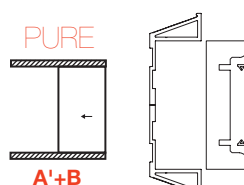

[B] profilés de finition et joints d'étanchéité pour profilés de construction Ω75 ou Ω100

[A'] Xinnix Selection

ou

[A'] S-Line:
HAWA Junior-80/B

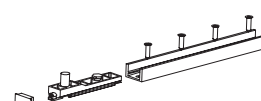
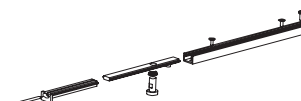



Gen. Deprezstraat 2
8530 Harelbeke Belgium

Tel.: +32 (0)56 735 000
Fax: +32 (0)56 720 270

info@xinnix.eu
www.xinnix.eu

Toutes les marques sont des marques déposées. L'amélioration et le développement des produits peuvent être la cause d'adaptations techniques. Ce document a pour but de vous informer de la meilleure façon de procéder mais ne vous donne aucune garantie de résultat, des erreurs de traduction ou des adaptations techniques étant toujours possibles. Cette information est établie selon les caractéristiques du produit de l'année 2017. Toute réimpression, reproduction partielle ou complète, toute traduction sont interdites sans l'autorisation écrite de Xinnix Door Systems bvba.