

PSO3

SISTEMA PER MOBILI CON ANTE SCORREVOLI IN LUCE O A RIDOSSO

- sistema scorrevole regolabile per ante fino a 40 kg.;
- sia per ante in legno che per ante in alluminio;
- possibilità di usare ante con solo vetro grazie ad appositi pattini.

SYSTEM FOR FURNITURES FOR FRONT OR INSIDE SLIDING DOORS

- adjustable sliding system for doors up to 40 kg.;
- possibility to apply aluminium frame or wooden door;
- special slides for glass allow to apply glass doors.



AZIENDA CON SISTEMA DI GESTIONE
PER LA QUALITÀ CERTIFICATO DA DNV
= **UNI EN ISO 9001:2000** =

CINETTO
FERRAMENTA PER MOBILI
FITTINGS FOR FURNITURES

ISTRUZIONI DI MONTAGGIO MOUNTING INSTRUCTIONS

Sistema con pattino regolabile

1 Inserire i fermi PS03FE9002 o PS03FE8B02 nei binari (superiore ed inferiore).

2 Inserire i binari nel fondo e nel cappello del mobile.

3 - 4 Inserire i pattini inferiori PS03PI9001/2 e superiori PS03PS9001 nelle apposite sedi fresate: sia dell'anta in legno, sia dell'anta in alluminio. Fissarli con le viti VL60100609.

5 Inserire la pinna sporgente del pattino inferiore nel binario, posizionare verticalmente l'anta e far entrare la pinna del pattino superiore nel binario superiore ruotando manualmente la leva.

System with adjustable slide

1 Insert the locks PS03FE9002 or PS03FE8B02 into the rails (upper and lower).

2 Insert the rail into the grooved top and bottom of the furniture.

3 - 4 Insert the upper slide PS03PS9001 and the lower slides PS03PI9001/2 into the proper seats ready grooved on the wooden door or on the aluminium frame profile and screw them with the screw VL60100609.

5 Insert the fin of the lower slide into the rail, position vertically the door and let the fin of the upper slide into the rail rounding manually the lever.

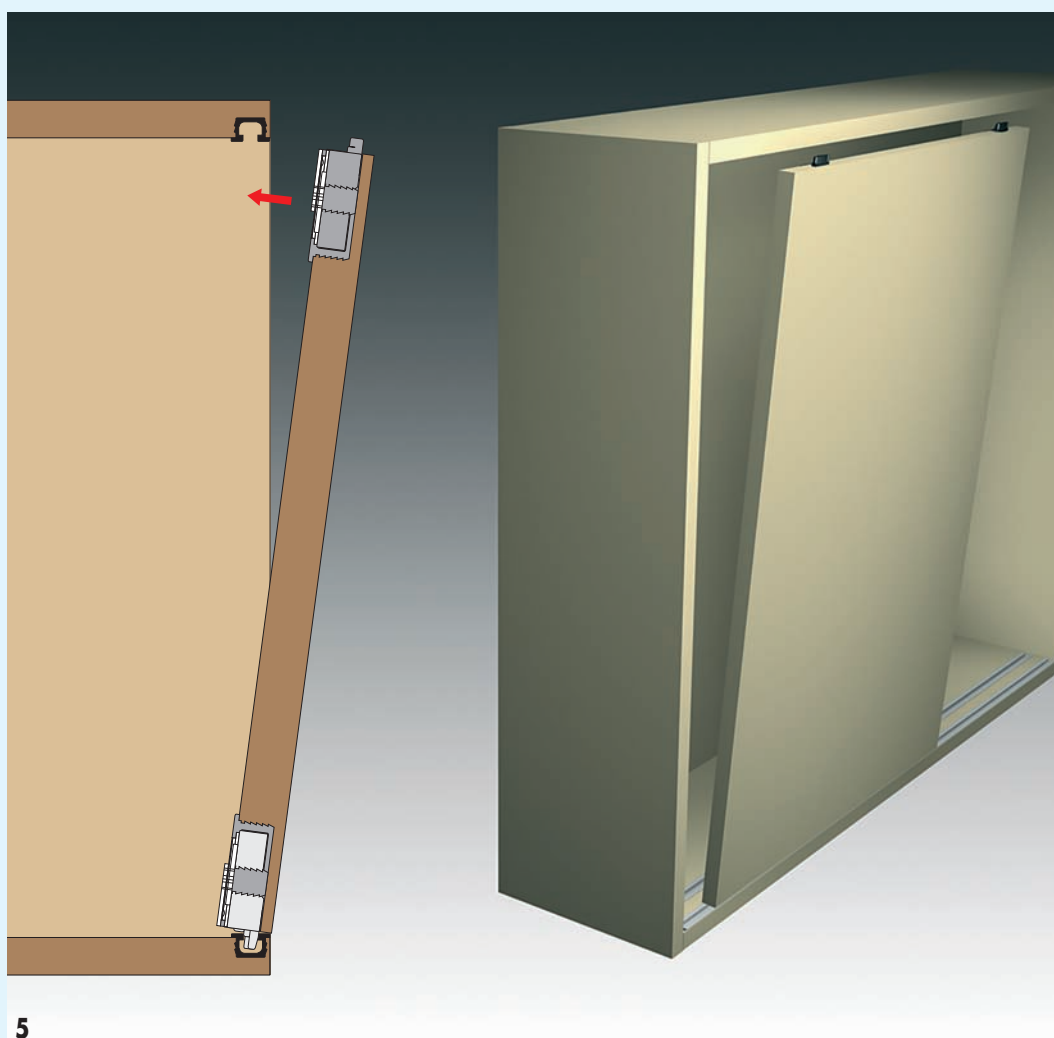
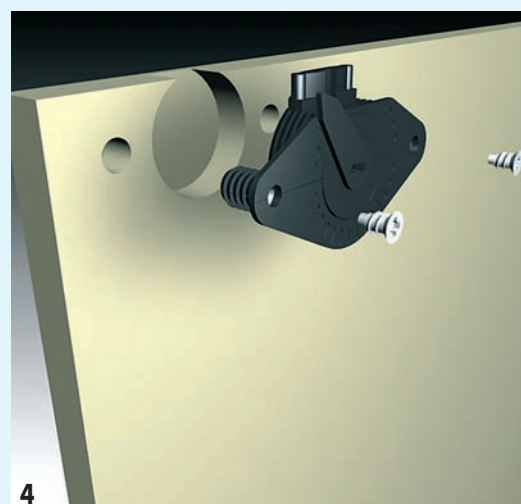
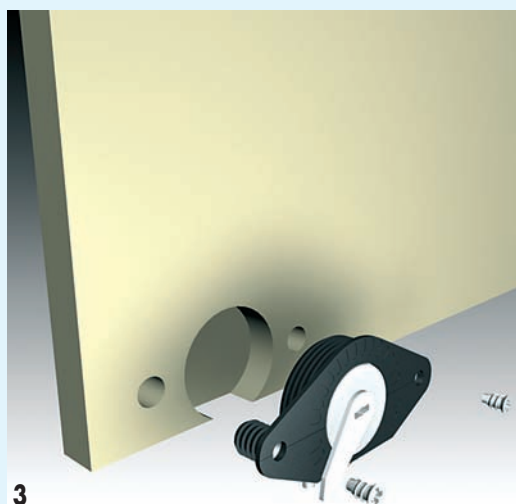
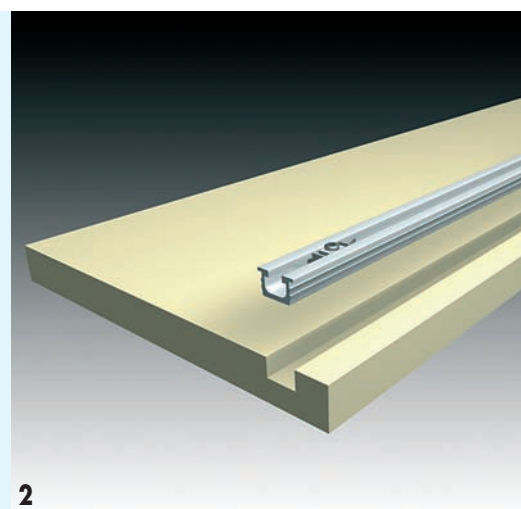
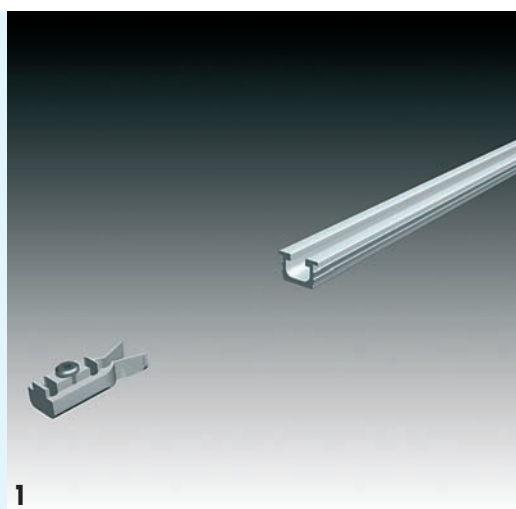

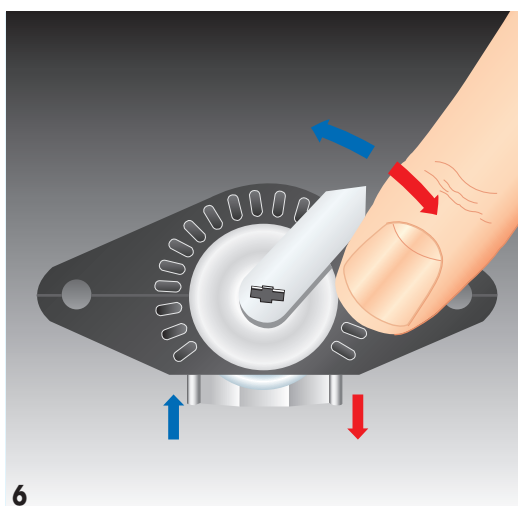

6

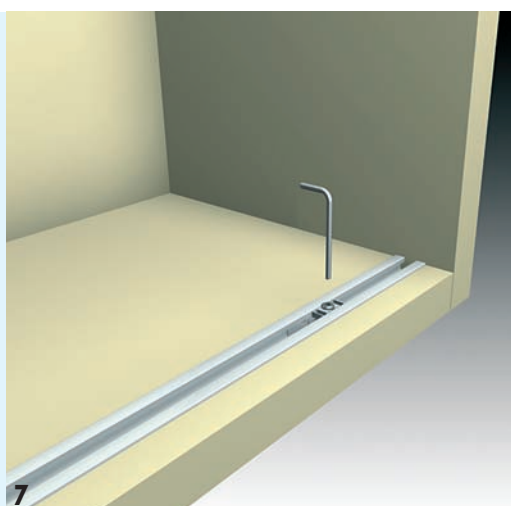

7

6 Per regolare l'anta in altezza, ruotare manualmente la leva dei pattini inferiori.
7 Posizionare i fermi PS03FE9002 o PS03FE8B02 e bloccarli tramite l'apposito grano premontato.

6 To adjust the door on height, rotate manually the lever of the lower slides.
7 Position the locks PS03FE9002 or PS03FE8B02 along the rails and fix them with the proper nut ready assembled.

RAPPRESENTATI: BINARIO SUPERIORE - INFERIORE PR0370003A, PATTINO SUPERIORE PS03PS9001 E PATTINO INFERIORE REGOLABILE PS03PI9001
PICTURE SHOWING: UPPER - LOWER RAIL PR0370003A, UPPER SLIDE PS03PS9001 AND LOWER ADJUSTABLE SLIDE PS03PI9001

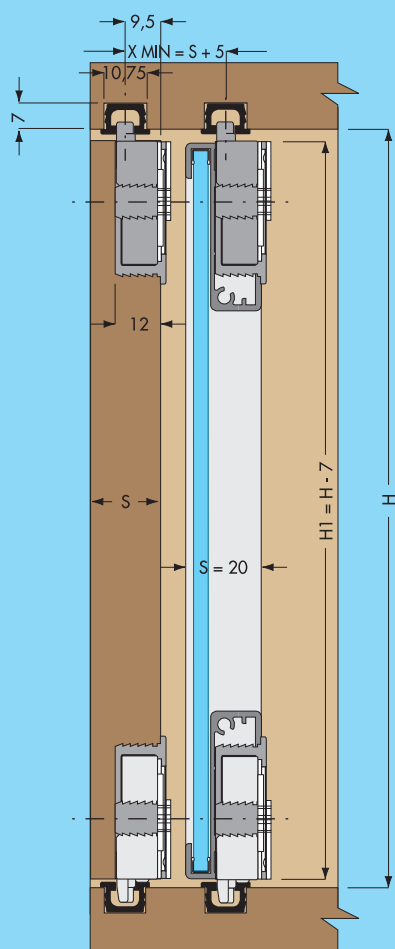

1

RAPPRESENTATI: BINARIO SUPERIORE PR0370003A, BINARIO INFERIORE PR0370004A, PATTINO SUPERIORE PS03PS9001 E PATTINO INFERIORE REGOLABILE PS03PI9002
PICTURE SHOWING: UPPER RAIL PR0370003A, LOWER RAIL PR0370004A, UPPER SLIDE PS03PS9001 AND LOWER ADJUSTABLE SLIDE PS03PI9002

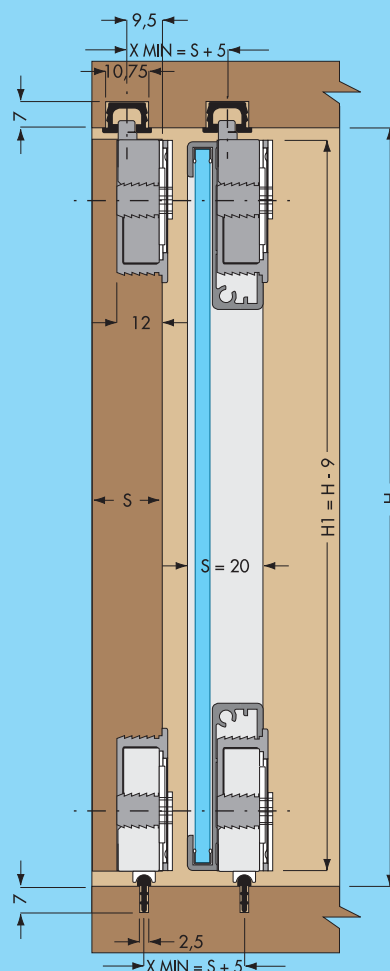

2