

OPENING SYSTEMS FOR LIFT UP AND DROP DOWN DOORS



KIARO



PAT. PENDING

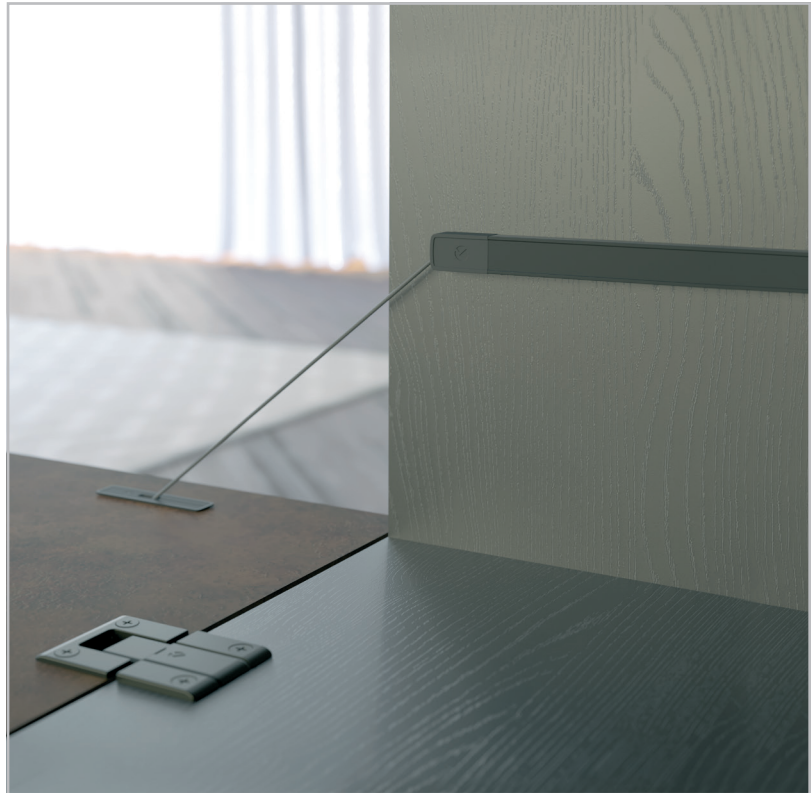

ADJUSTMENT OF STRENGTH SETTINGS

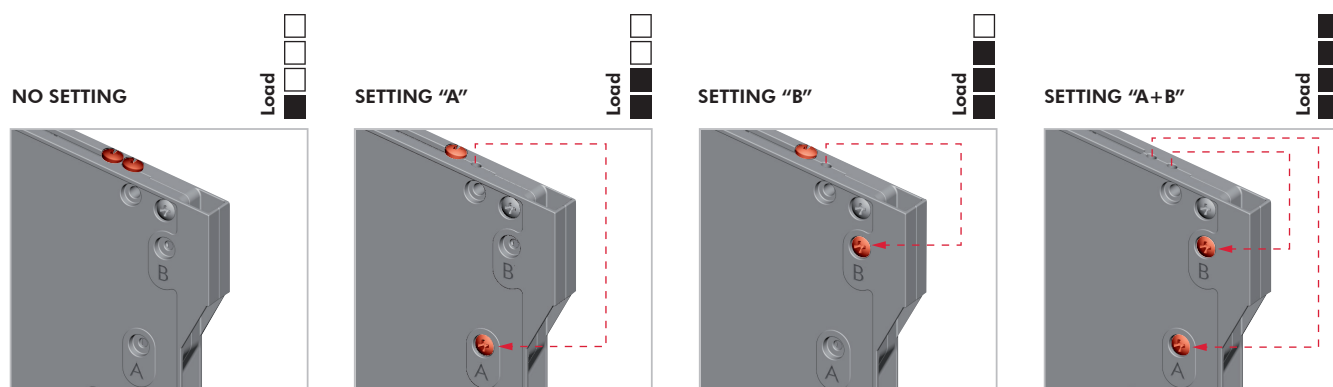
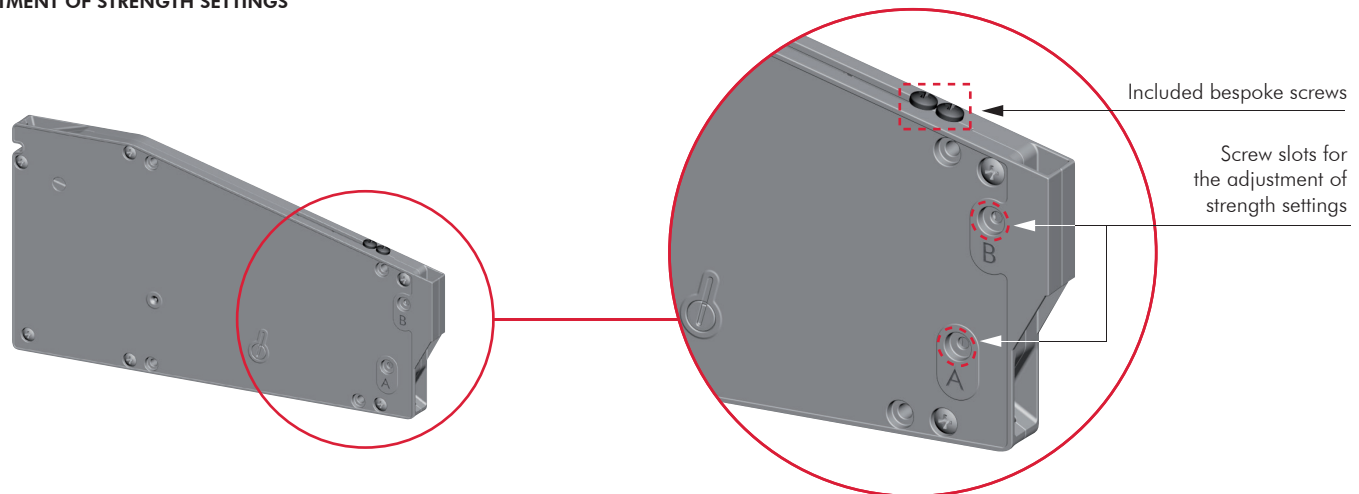



OPENING SYSTEMS FOR LIFT UP AND DROP DOWN DOORS

MECHANISM INSTALLATION

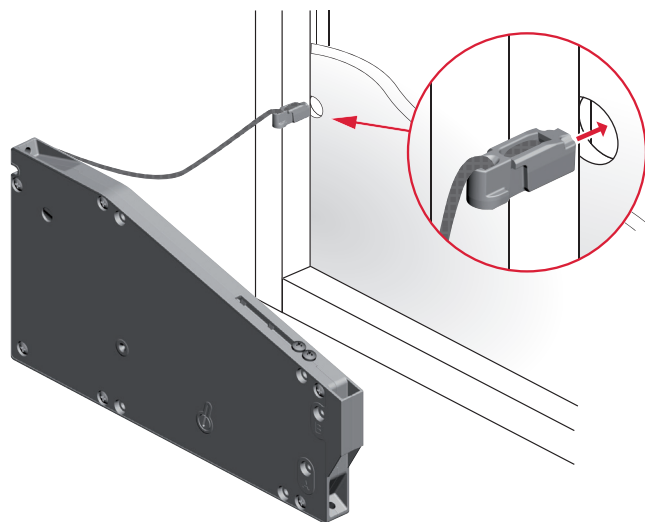

UNHANDED MECHANISM

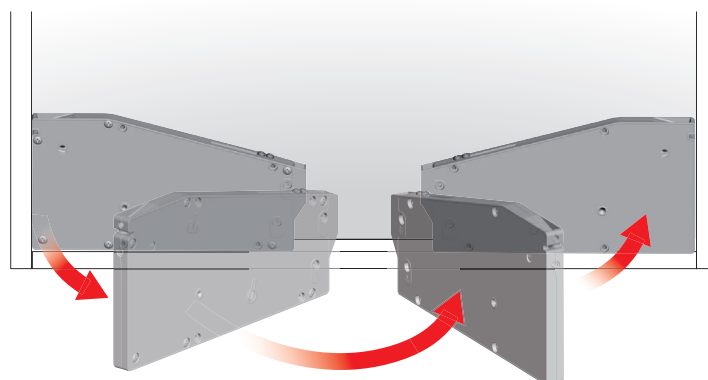

MECHANISM FIXING

On the bottom and on the side panel with screws

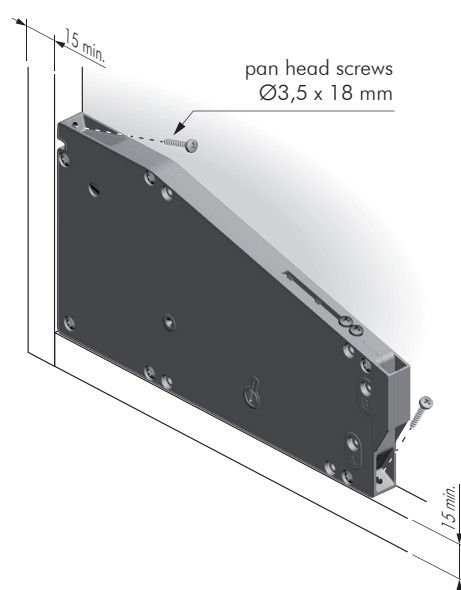

On the back panel with screws

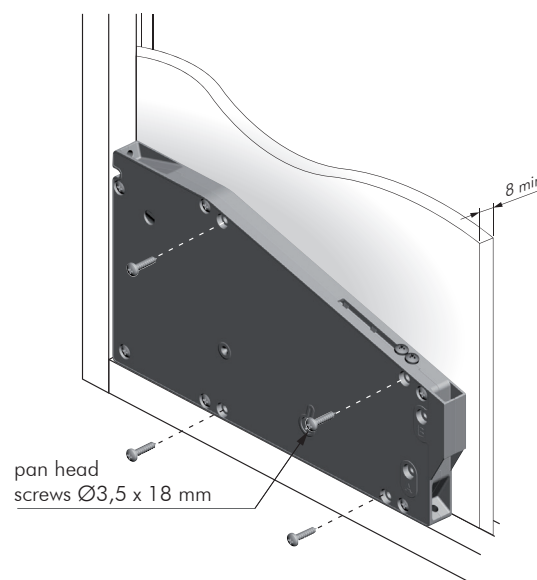

On the bottom and on the side panel with pin and screws

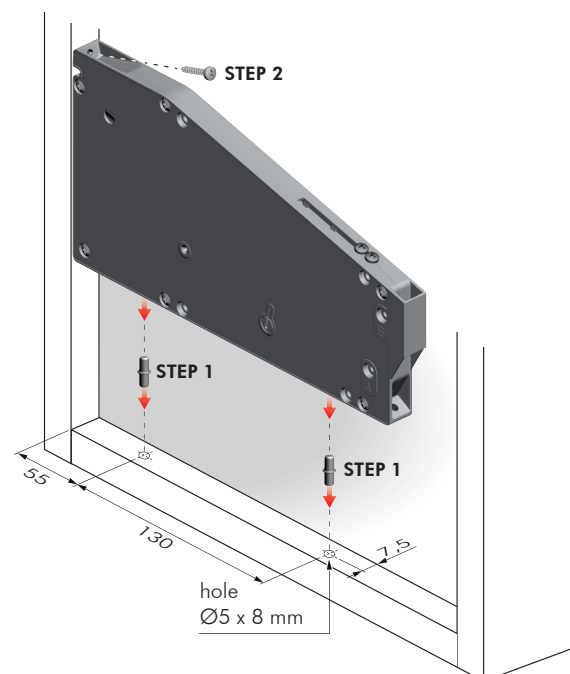
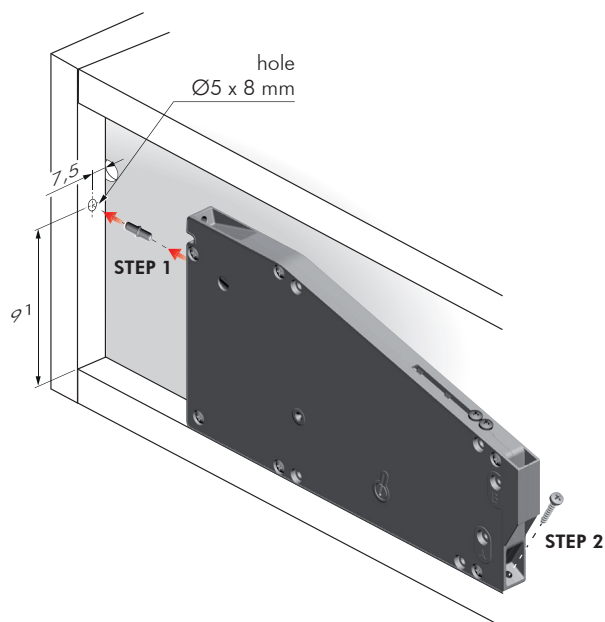

OPENING SYSTEMS FOR LIFT UP AND DROP DOWN DOORS



BRACKETS INSTALLATION

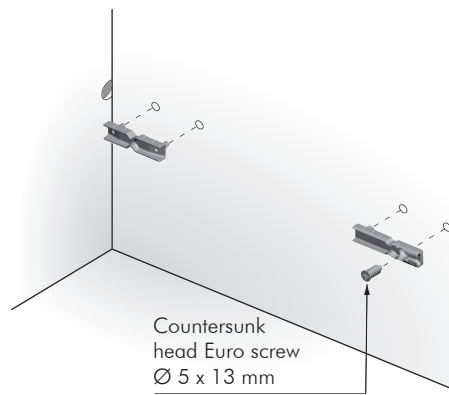

WIRE INSTALLATION

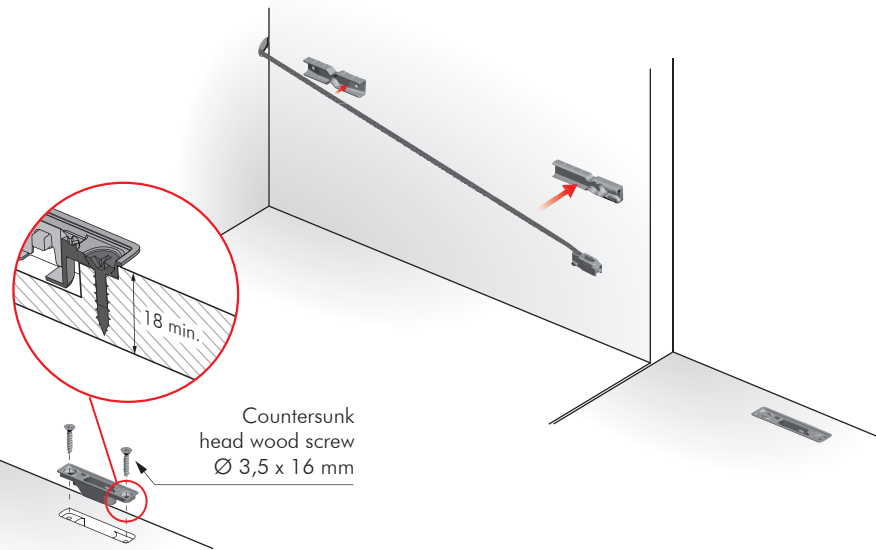

WIRE INSERTION ONTO THE DOOR BRACKET

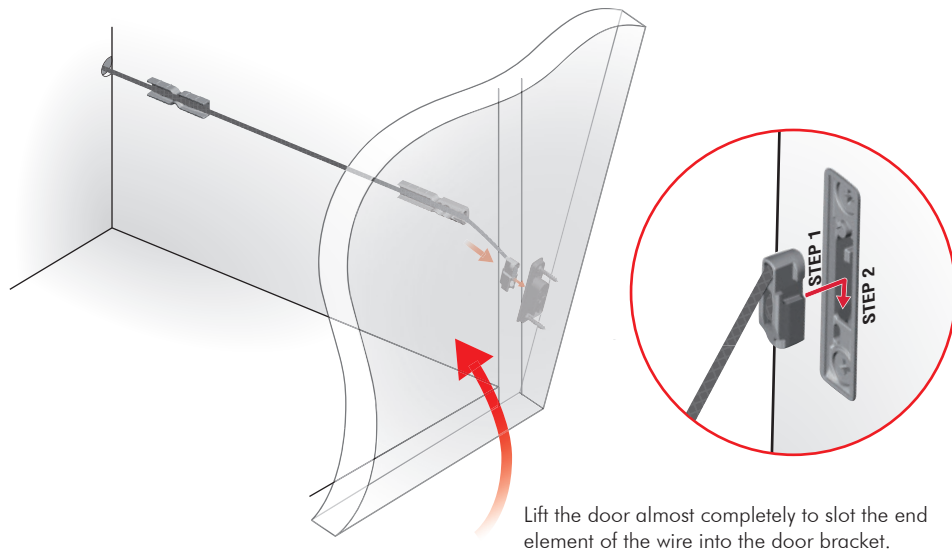

STEP 1

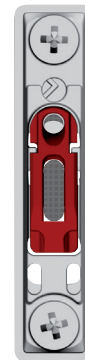

STEP 2



8

COVER CAP AND ALUMINIUM LATERAL PROFILE INSERTION

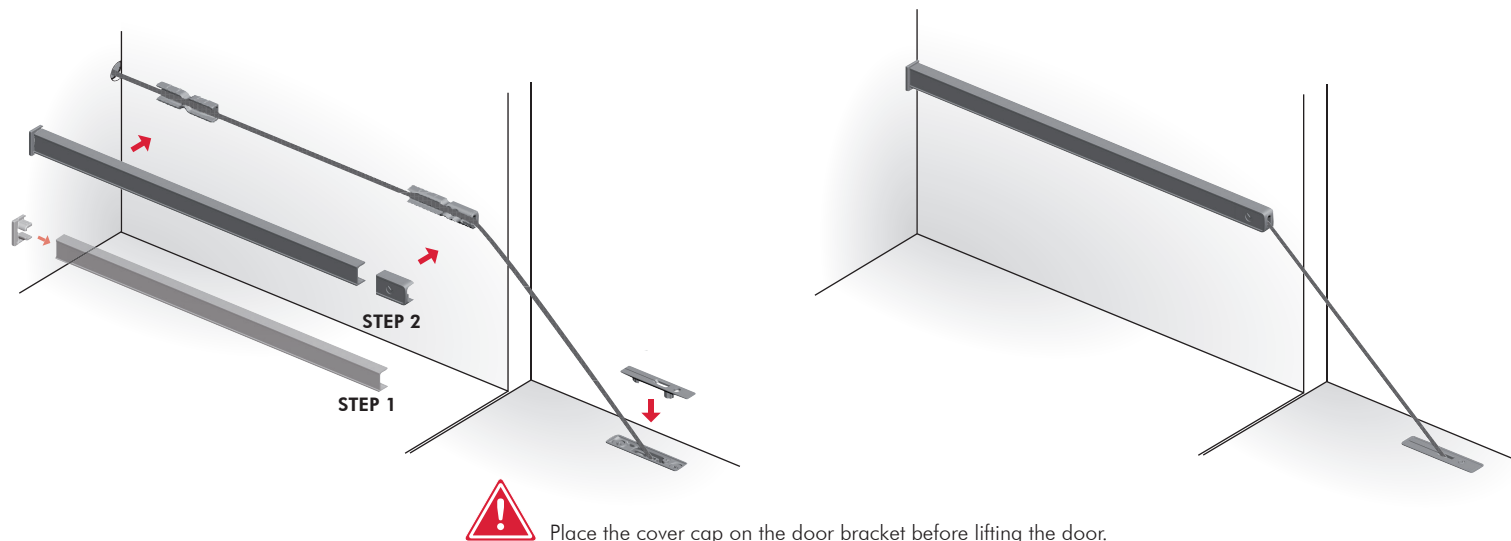



OPENING SYSTEMS FOR LIFT UP AND DROP DOWN DOORS

DOOR OPENING ANGLE ADJUSTMENT

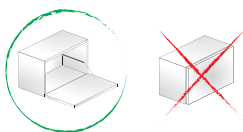
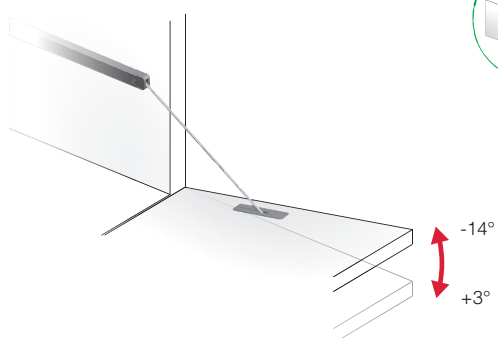

VERY IMPORTANT:
The opening angle adjustment can be carried out only with open door.

FROM THE INSIDE OF THE CABINET

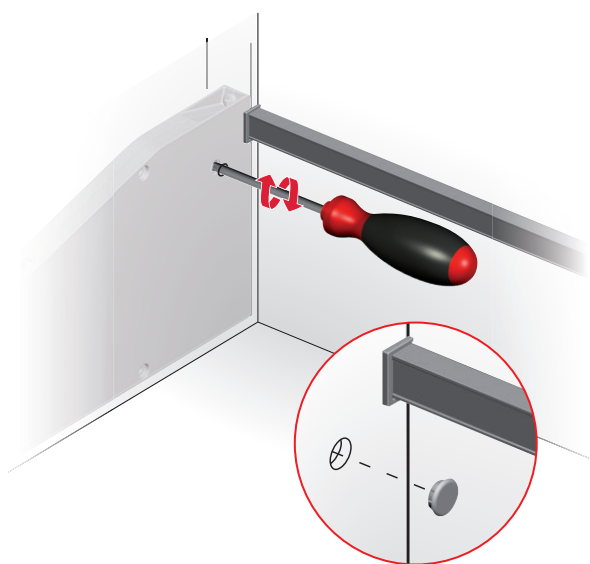

FROM THE BACKSIDE OF THE CABINET

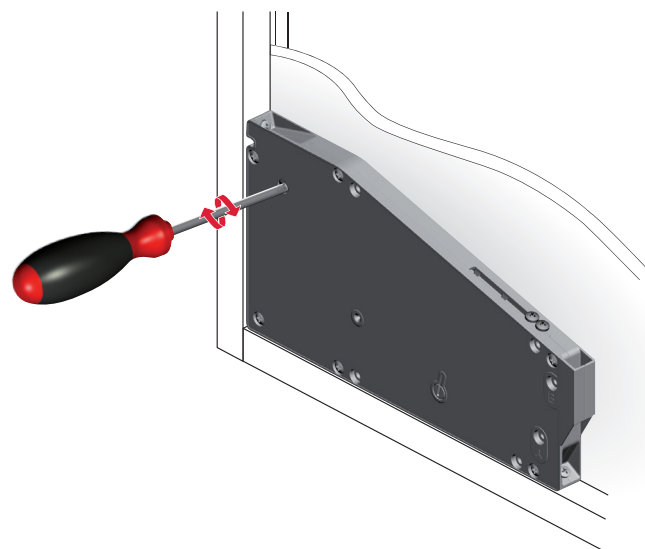

8

ADJUSTMENT OF STRENGTH SETTINGS

Possibility to adjust the settings of the mechanism also upon completed assembly.
For details refer to the related section.

VERY IMPORTANT:
Before proceeding, make sure:

- 1) The door is completely closed.

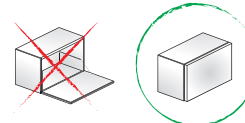

- 2) The mechanism is completely in position.

OK

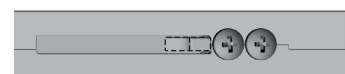

NO

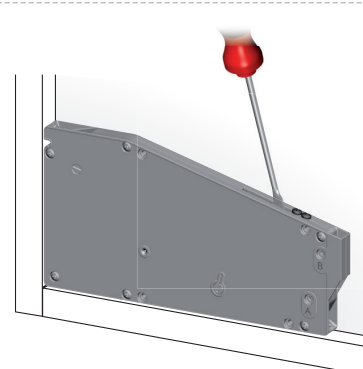

In this case put the small flap in position with a screwdriver.

OPENING SYSTEMS FOR LIFT UP AND DROP DOWN DOORS



INSTRUCTIONS FOR WIRE CUTTING

INSERTION OF THE WIRE INTO THE END PART AND LOCKING WITH M3 GRUBSCREW

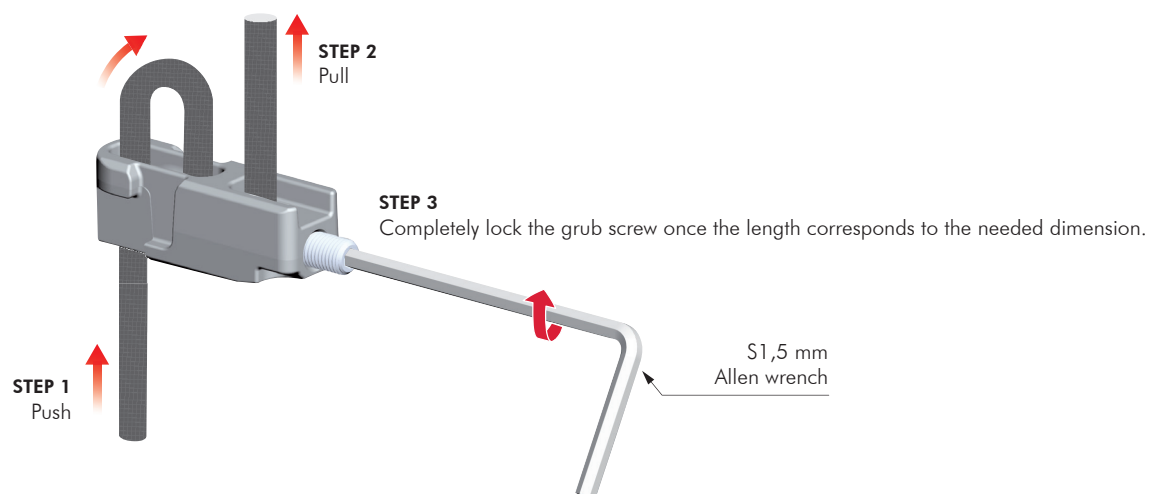

WIRE CUTTING WITH UNMOUNTED MECHANISM

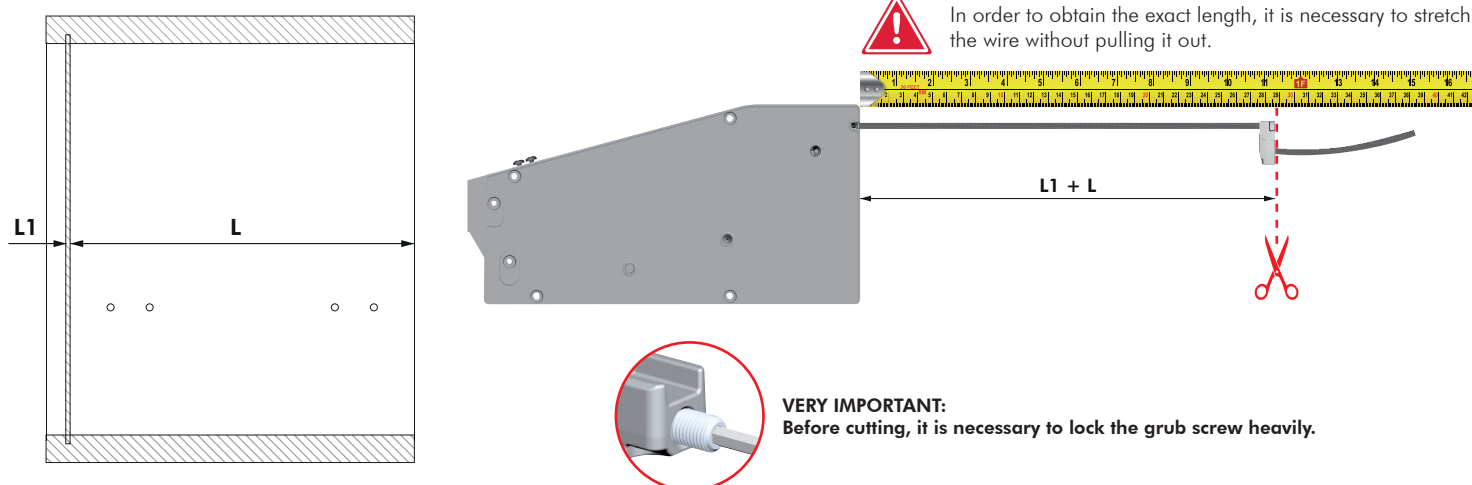

8

WIRE CUTTING WITH MOUNTED MECHANISM

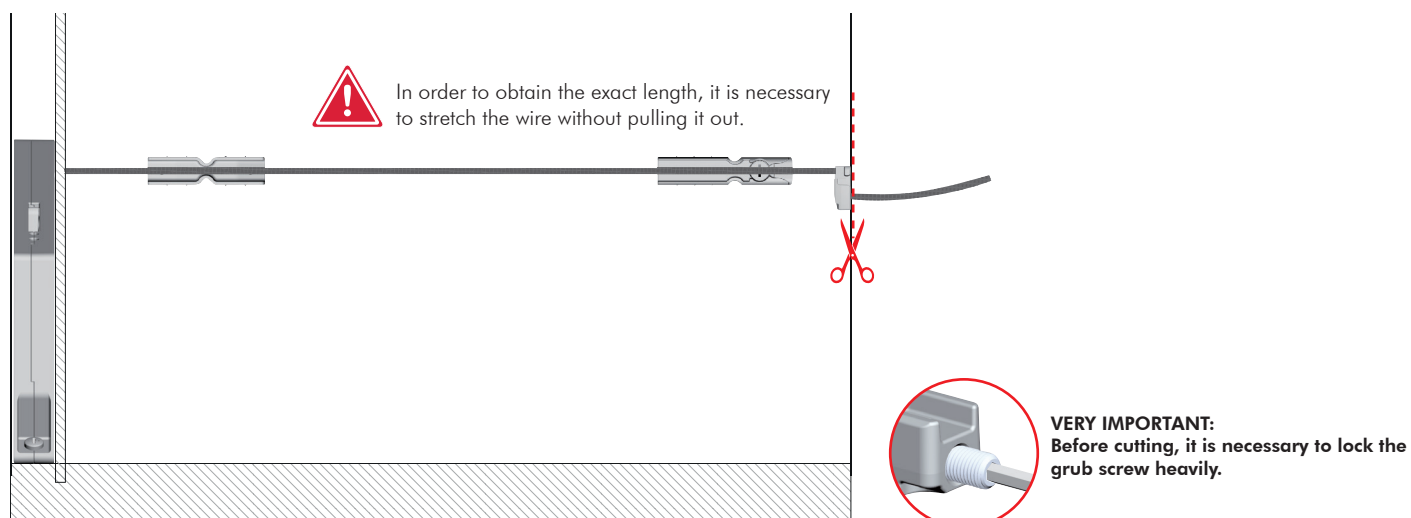

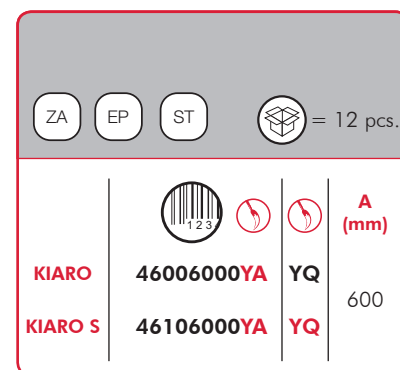

NOTE: Possibility to supply the wire with customized length (A).

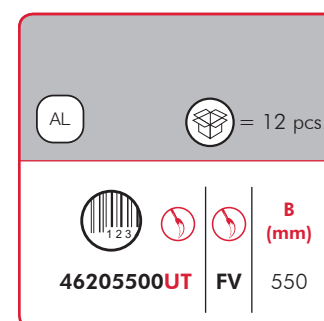

NOTE: Possibility to supply the aluminium profile with customized length (**B**).

Finishes matching between cover caps and alu. profiles:

YA → UT
YQ → FV



SIDE-PANEL DRILLING OPERATIONS



In case of door without handles it is recommended to use **K Push Tech with buffer**.

In case other hinges than KIMANA are used, it is necessary to contact an authorized dealer for a correct drilling scheme. For this purpose, use the form on the Italiana Ferramenta website (product KIARO) to provide the required specifications.



ALTERNATIVE DOOR BRACKETS

Door bracket for screw fixing without milling on the door

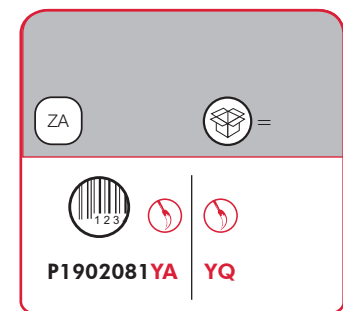
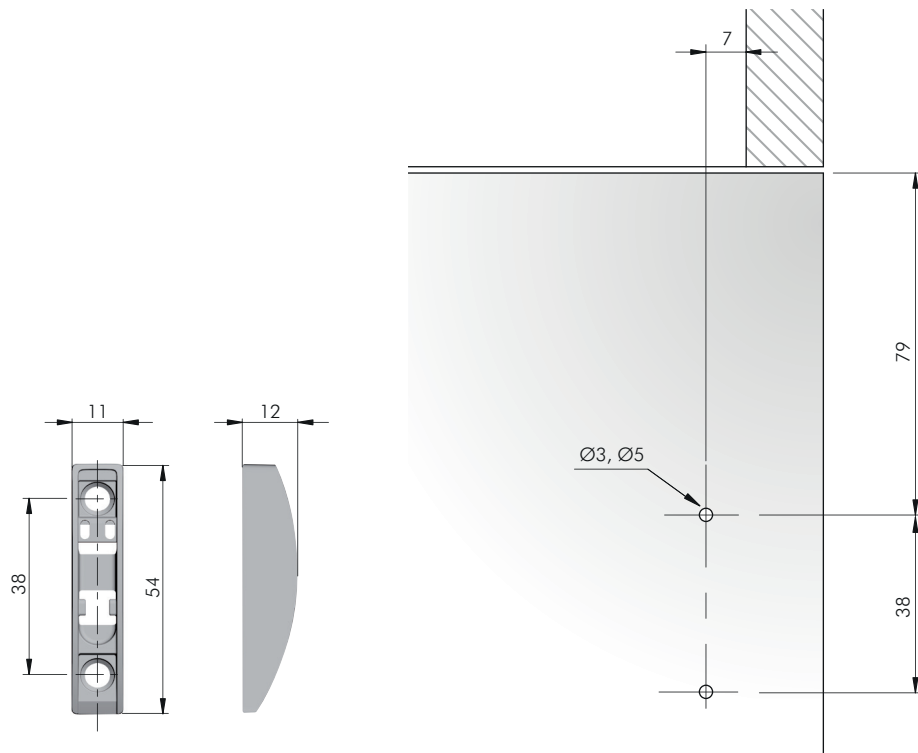
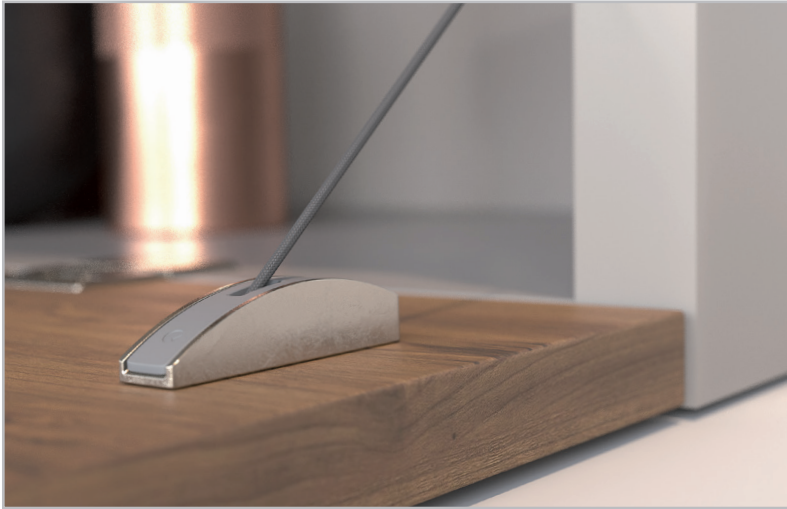

8

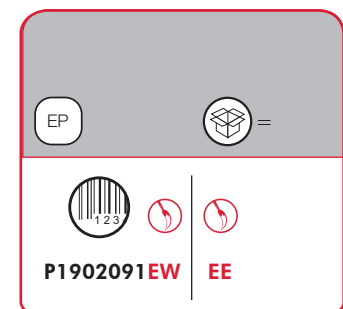
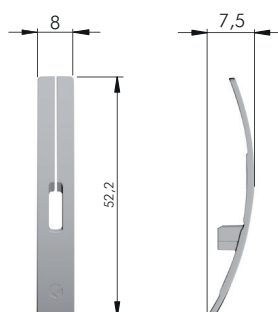

NOTE: Finishes matching between cover caps and door bracket:

EW → YA
EE → YQ

OPENING SYSTEMS FOR LIFT UP AND DROP DOWN DOORS



DOOR BRACKETS COVER CAP INSERTION

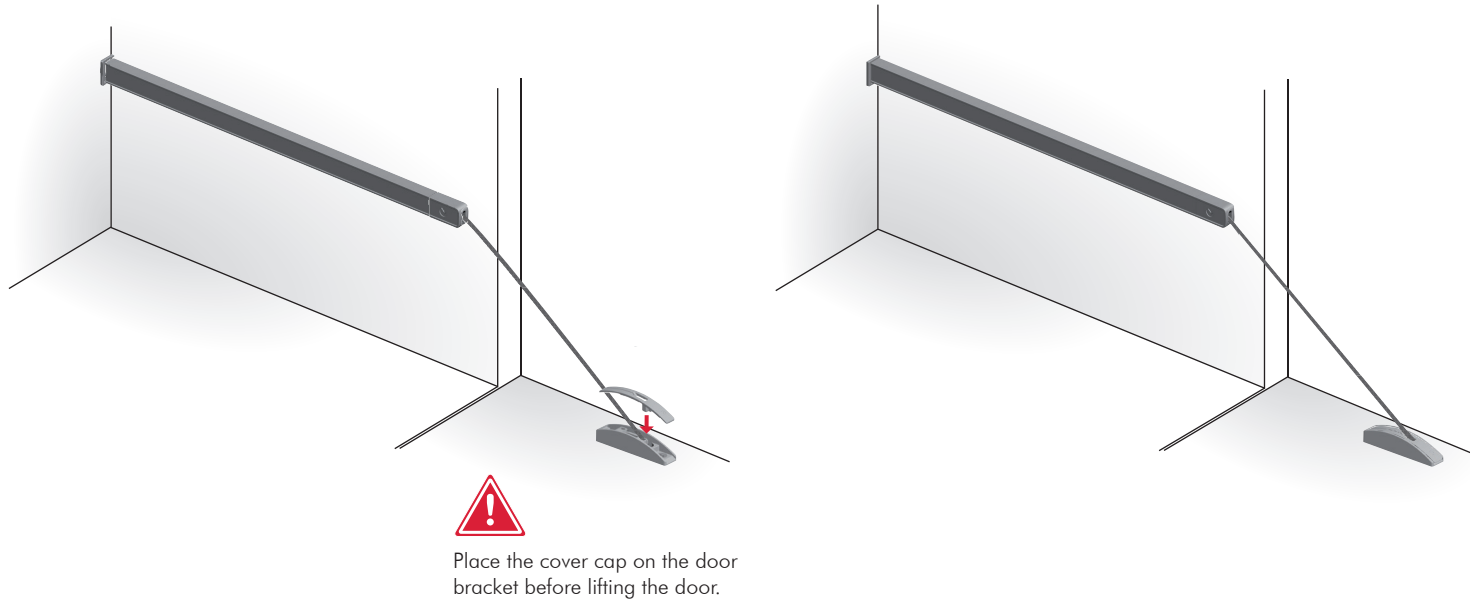

INSTRUCTIONS FOR WIRE CUTTING

WIRE CUTTING WITH UNMOUNTED MECHANISM

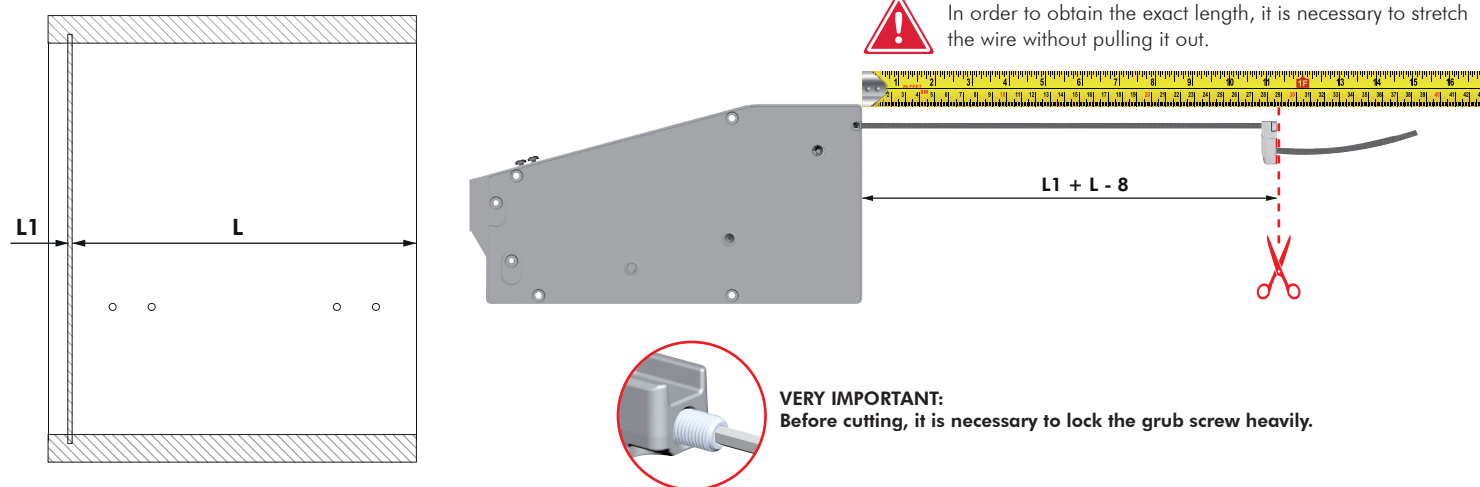

WIRE CUTTING WITH MOUNTED MECHANISM

