

Montageanleitung Mounting instructions Instructions de montage

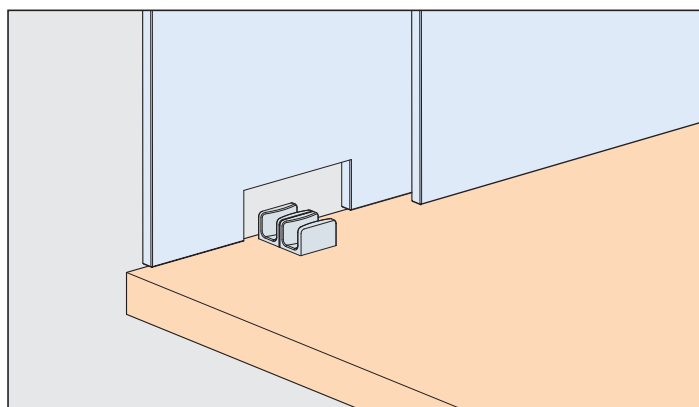

EKU CLIP® 16 GK (IS)

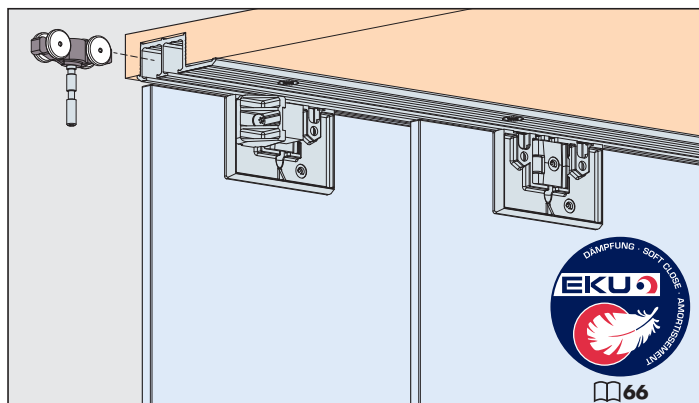

Garnituren / Sets / Garnitures

2 Türen Doors Portes		No. 053.3313.071	
	4x		2x
	4x		2x
	1x		

Zubehör / Accessories / Accessoires

E	Doppellaufschiene Alu eloxiert, gelocht, zum Aufschrauben	2500 mm	053.3247.250
		3500 mm	053.3247.350
F	Doppellaufschiene Alu, gelocht, zum Schrauben	2500 mm	053.3248.250
		3500 mm	053.3248.350
		6000 mm	053.3247.600
		6000 mm	053.3248.600

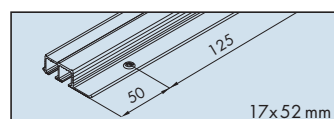
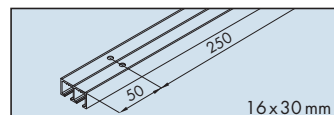

Penloc GTI, Kleber

Penloc GTI, adhesive
Penloc GTI, colle

098.0026.000

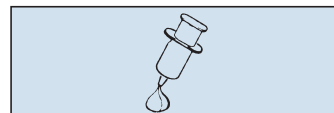

EKU AG Schiebelösungen, Wilerstrasse 90, 8370 Sirnach, Switzerland, Tel. +41 (0)71 96 96 100
Fax +41 (0)71 96 96 110, office@eku.ch, www.eku.ch Certified ISO 9001 - Member of the HAWA Group

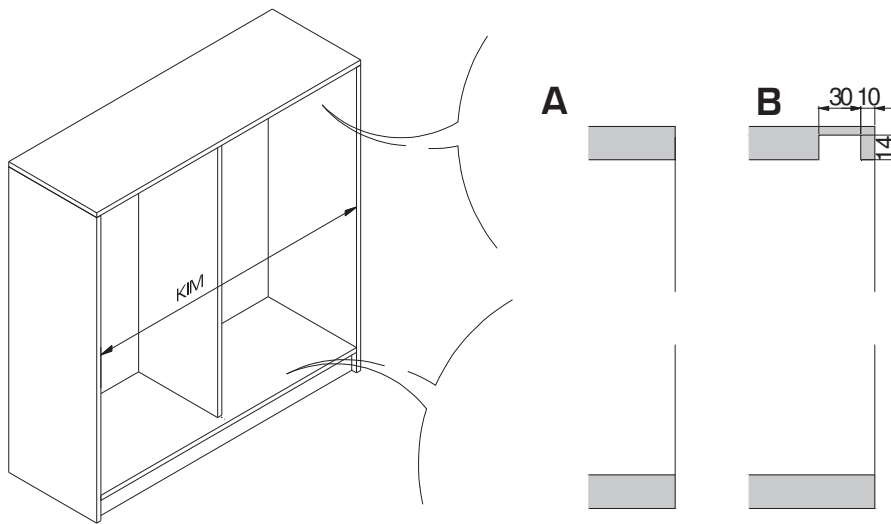

A

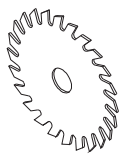

A Art.No. 053.3247

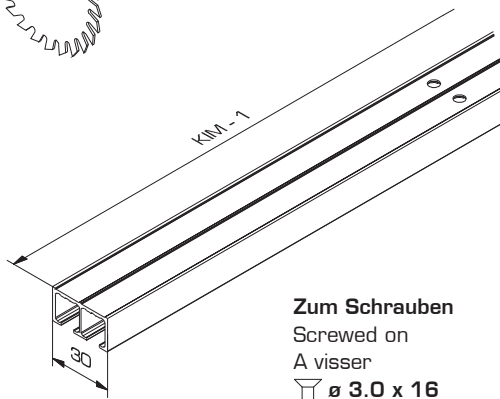

B Art.No. 053.3248

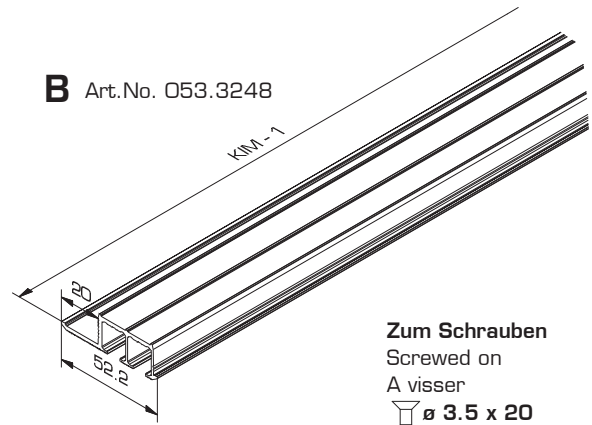

B 1



! 3 → **B 2** !

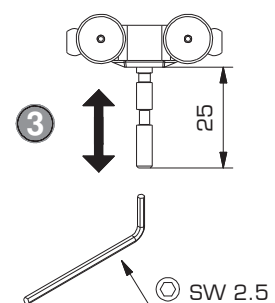
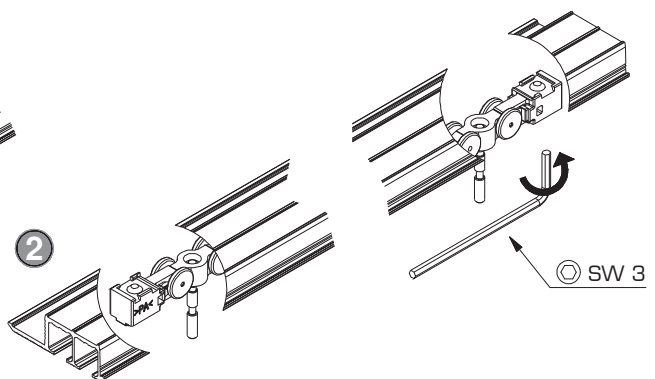
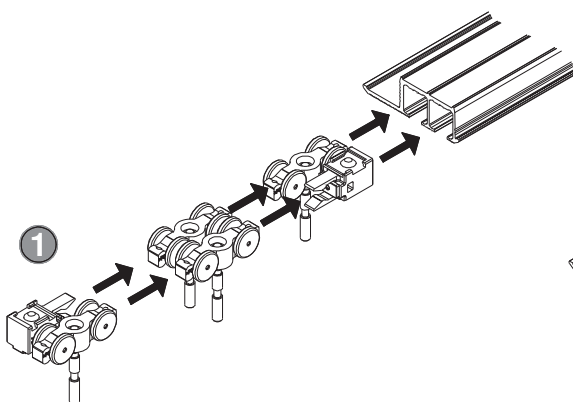

B 2

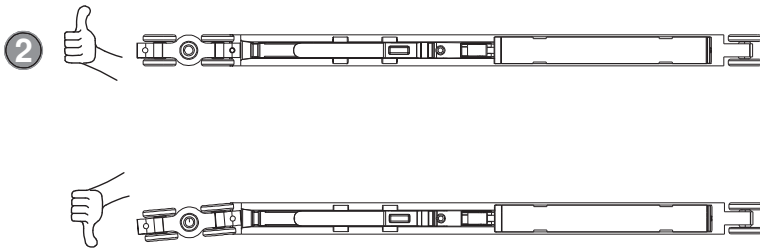
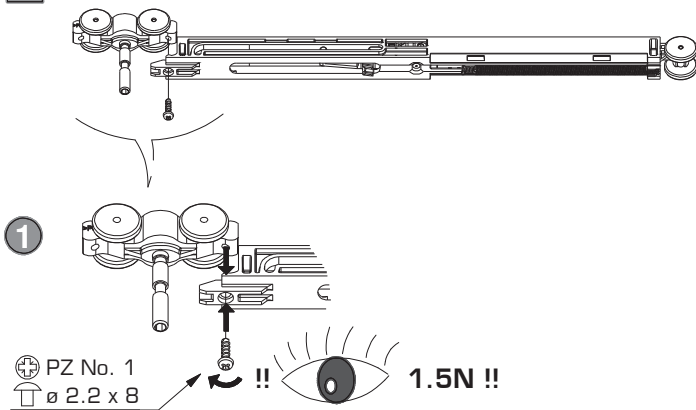

C

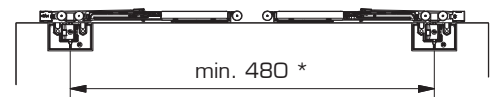
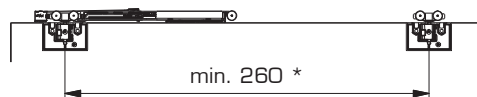
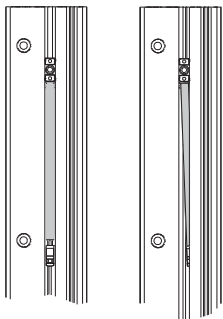
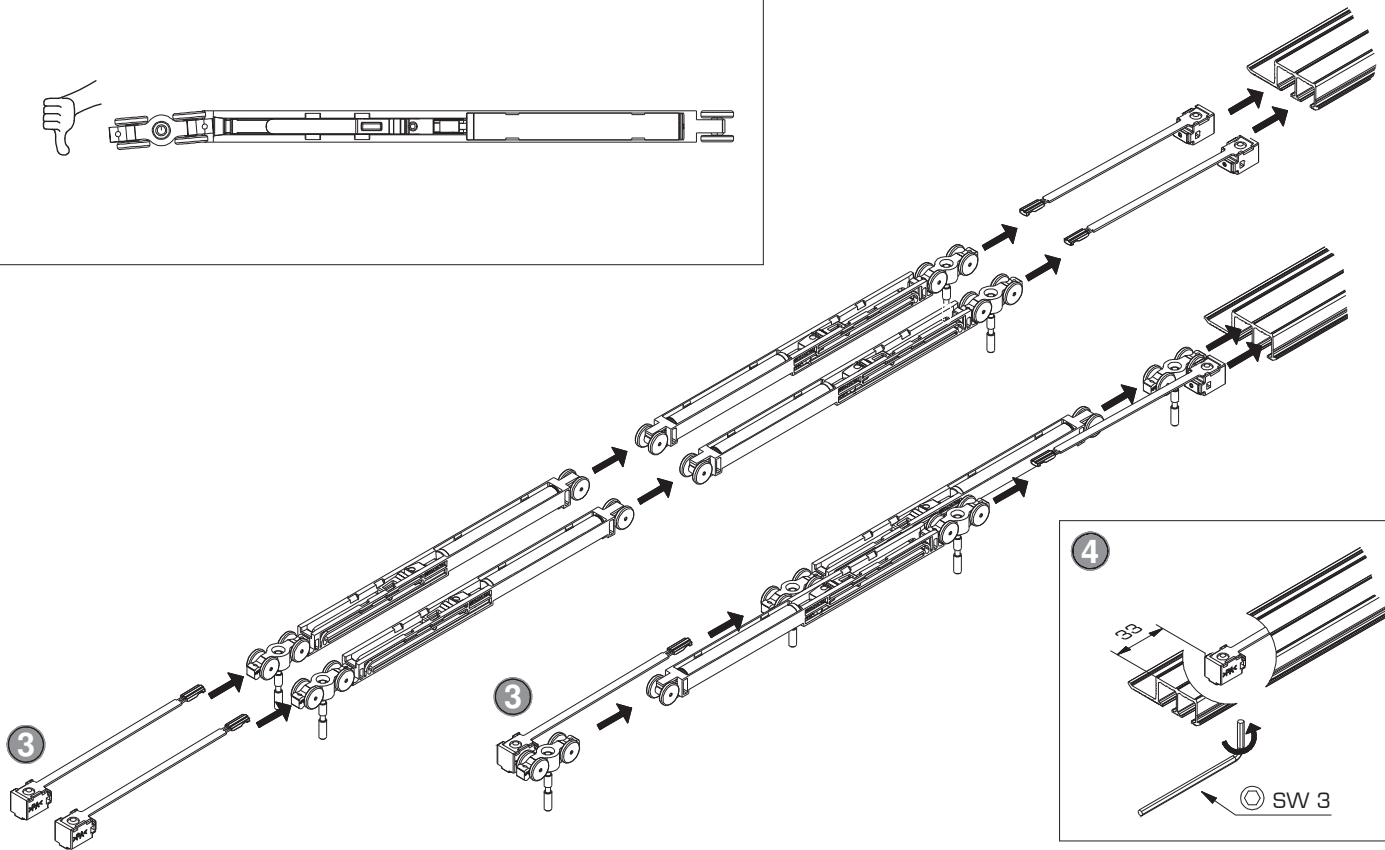

Empfehlung: Der Zugang zu den Dämpfungskomponenten sollte jederzeit möglich sein. Demontierbare Laufschienen oder Möbelkonstruktion entsprechend planen.

Recommendation: The access to soft-closing components should be possible at any time. Plan removable running tracks or furniture designs accordingly.

Recommandation: L'accès aux composants de l'amortisseur doit être possible à tout moment. Prévoir en conséquence des rails de roulement ou une constructions de meuble démontables

Garnituren / Sets / Garnitures

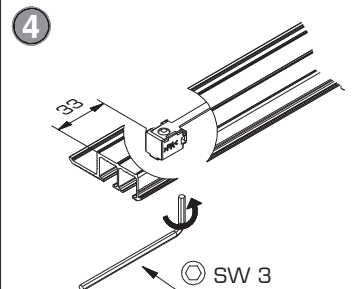
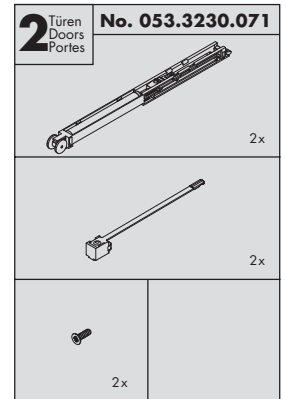

Bestellen / order
/ commander
- 16 kg

Dämpfen in Schliessrichtung Soft closing function in closing direction Amortissement dans le sens de fermeture	min. 260	1x 053.3230.071
Dämpfen in Schliess- und Öffnungsrichtung Soft closing function in opening and closing direction Amortissement dans le sens de fermeture et d'ouverture	min. 480	2x 053.3230.071

D

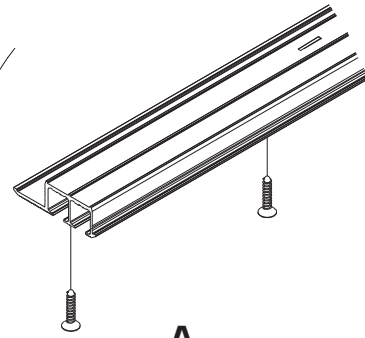
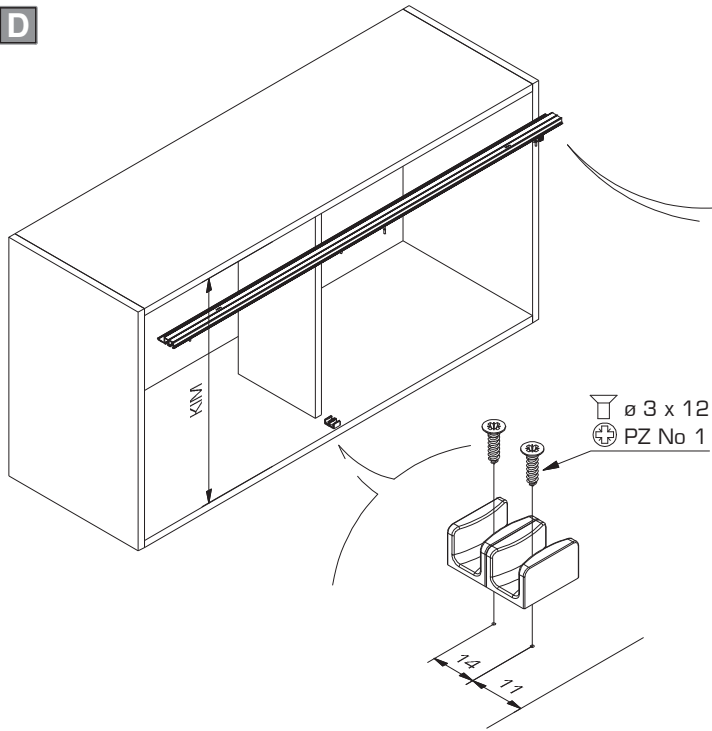

A
Zum Schrauben
Screwed on
A visser
ø 3 x 16

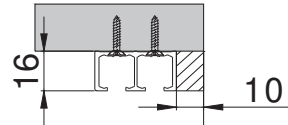

B
Zum Schrauben
Screwed on
A visser
ø 3.5 x 20

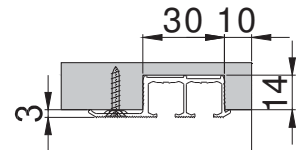

A: *TH = KIM - 22

B: *TH = KIM - 9

A+B: **TB = $\frac{KIM + 16}{2}$

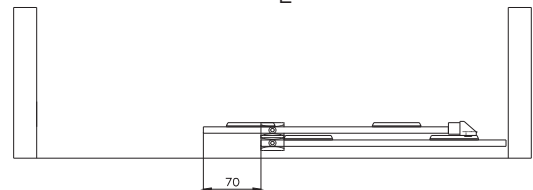
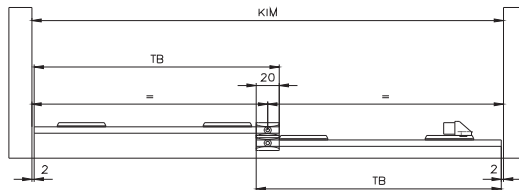

E Kleben | Glue | Coller



Klebstoff-Empfehlung:
Recommended adhesive:
Colle recommandée:
Penloc GTI
Art.No. 098.0026.000

1

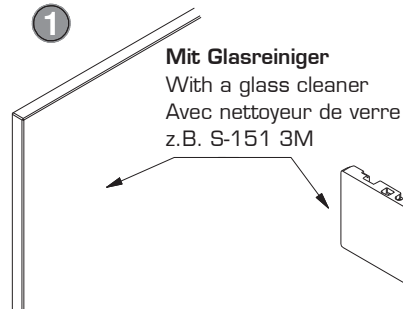

2

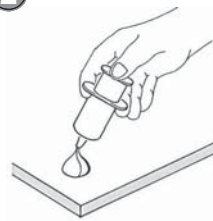

3



4



5

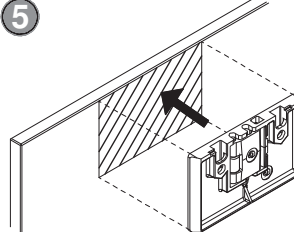

6

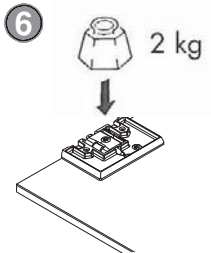

7

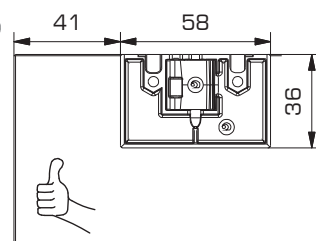

Bündig mit Glaskante
Flush with glass edge
Affleurant avec verre découpé



10 Min.

8

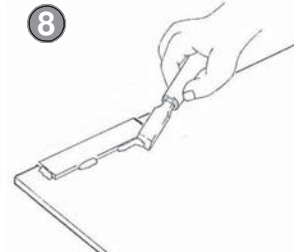

F

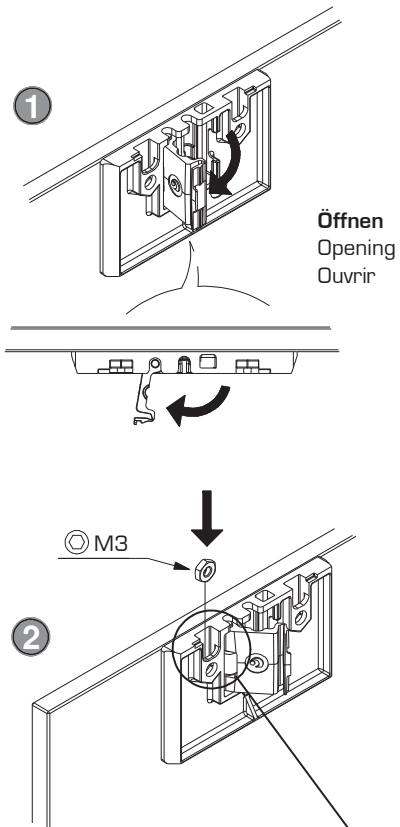

G

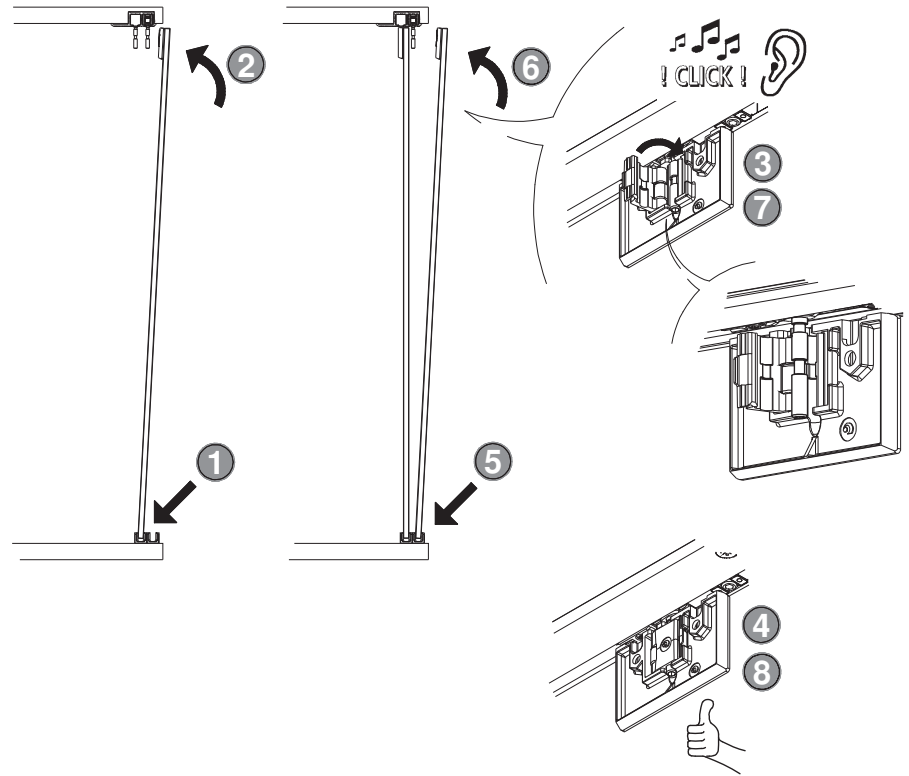

H

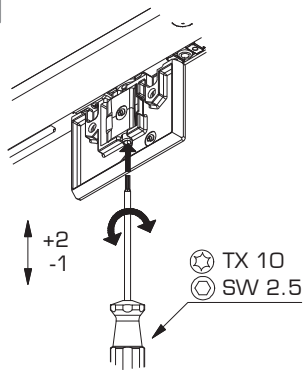

I

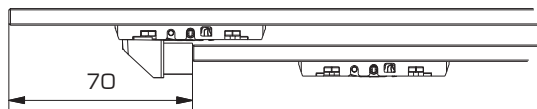
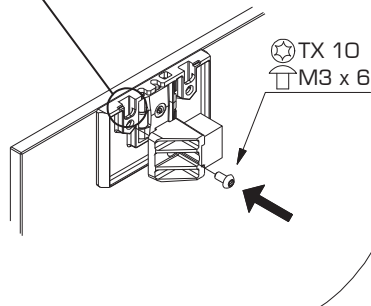

J

Türdemontage
Door dismounting
Démontage de la porte

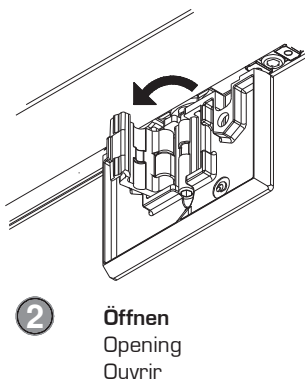
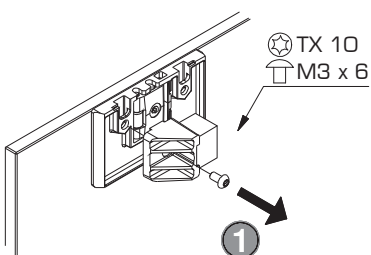

Einbaubeispiele | Mounting examples | Exemples de montage

