



reddot design award
winner 2019

interzum

Award

2019

FREEspace

BEAUTIFULLY SMALL - SIMPLY STRONG.
THE SMALL BUT MIGHTY FITTING FOR UNIT FRONTS.

 KESSEBÖHMER

FREEspace

EXTREMELY EASY INSTALLATION
INSIDE THE CARCASE:
JUST ONE SCREW.

Guaranteed to be perfectly positioned:
thanks to the positioning pins, the fitting is attached
accurately to the side panel and is self-retaining.

Just tighten the pre-installed euro screw - done!



EXTREMELY EASY ASSEMBLY OF THE FRONT PANEL
TOOL-FREE WITH CLICKFIXX.



Guide the front panel into the connecting piece ...



... and push it into the catch mechanism.

ADJUSTMENT – INTUITIVE AND CLEAR.



The only tool you will need for the entire adjustment process is a PZ2 screwdriver.

OPENING ANGLE LIMITER INCLUDED.

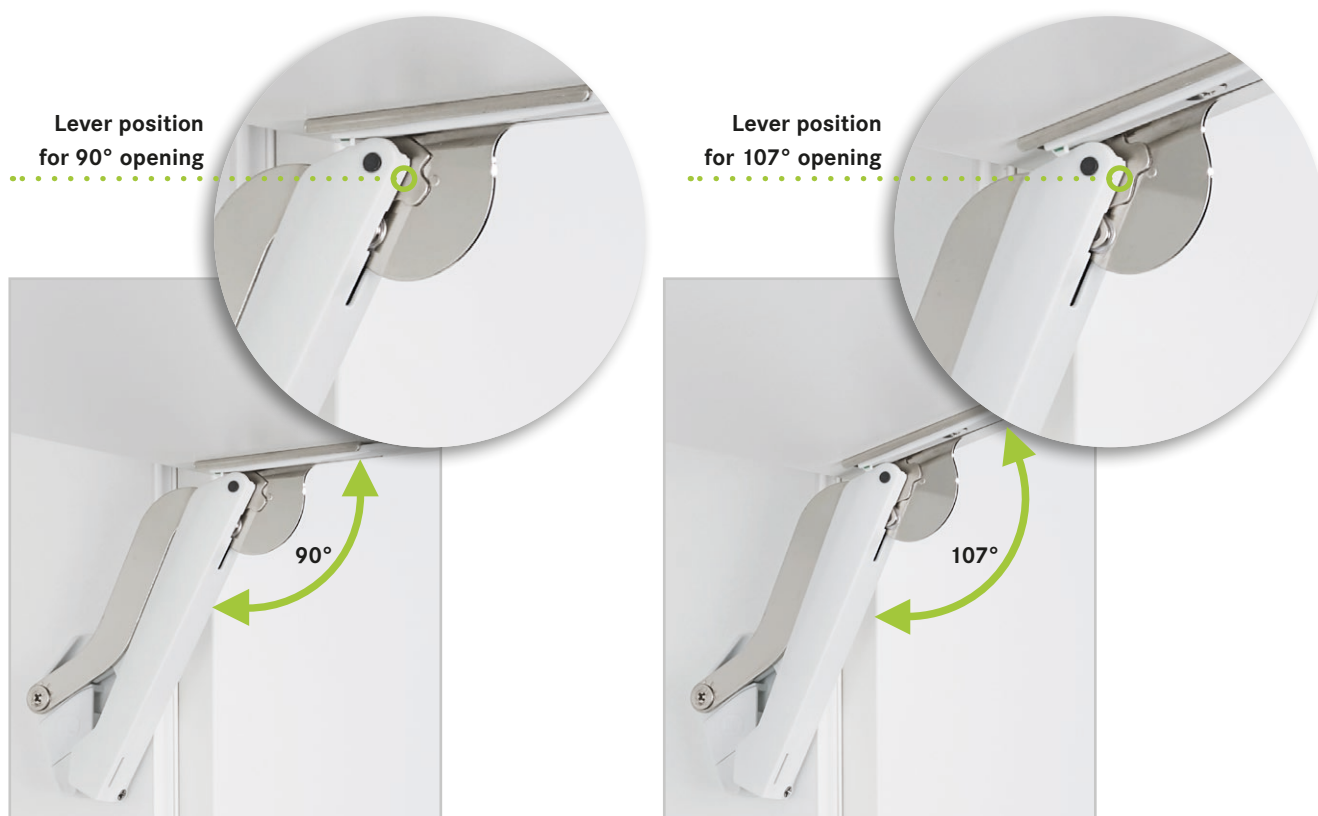



Product code

FREEspace set

1 fitting, left
1 fitting, right
2 front connectors with 2 screws each

272234

Type B

272235

Type C

272236

Type D

272237

Type E

272238

Type F

Colour code:

Ice white 9966

Grey 7035

Anthracite 7500



FREEspace set, black

1 fitting, left
1 fitting, right
2 front connectors with 2 screws each

272257

Type B

272258

Type C

272259

Type D

272260

Type E

272261

Type F

Colour code:

Black 9005



2-in-1 drilling template

for side and front panels on request

272251 0006

Front panel screws for aluminium frame

4 self-tapping screws

4 special washers