

**Unico**  
by ambigence

Meccanismo di apertura con cerniera integrata  
Opening mechanism with integrated hinge

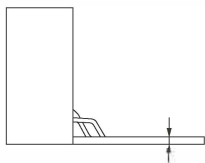

Montaggio a filo con cover  
Recessed flush mounting with cover



Spessore anta da 18 a 20 mm  
Door's thickness from 18 to 20 mm

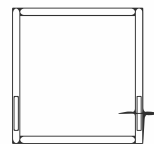

Spessore meccanismo ridotto  
Narrow mechanism's thickness

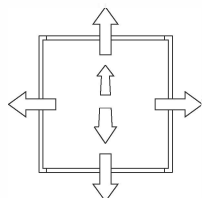

Regolazione 3D posizione anta  
Door's position 3D adjustment

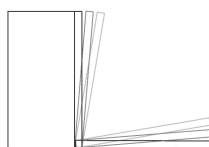

Damper in apertura e chiusura  
Soft opening and soft closing



Regolazione forza della molla  
Spring's force adjustment

## Tipologie meccanismo Mechanisms types

### Spessori standard Standard thickness

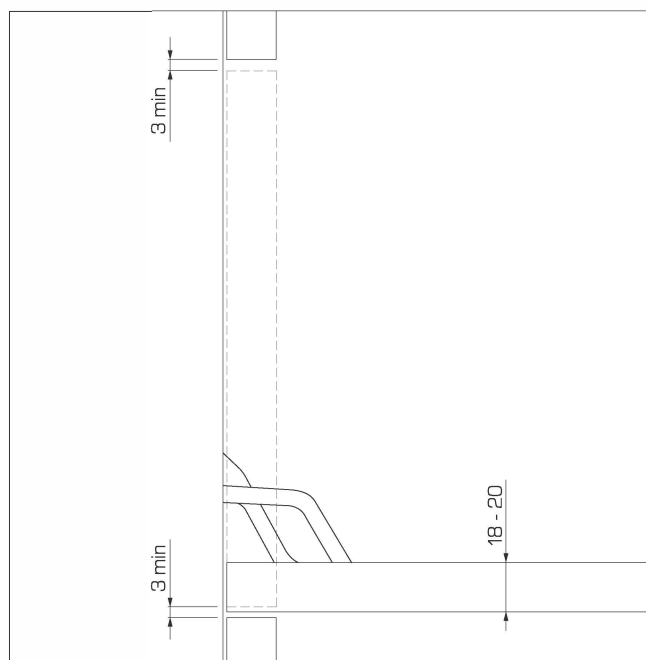

ATTENZIONE - WARNING

Lo spessore dell'anta e della base influiscono sulla scelta del meccanismo  
The thickness of the door and base panel influence the choice of the mechanism

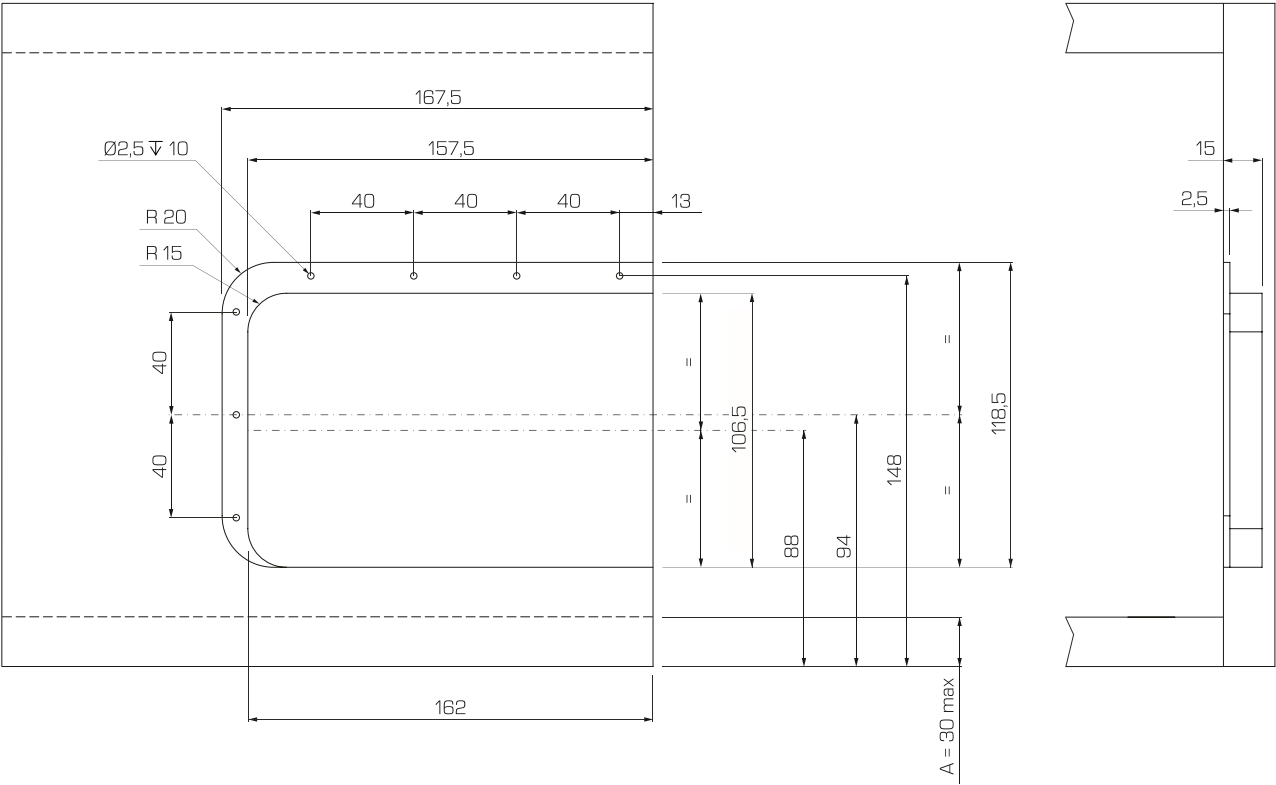

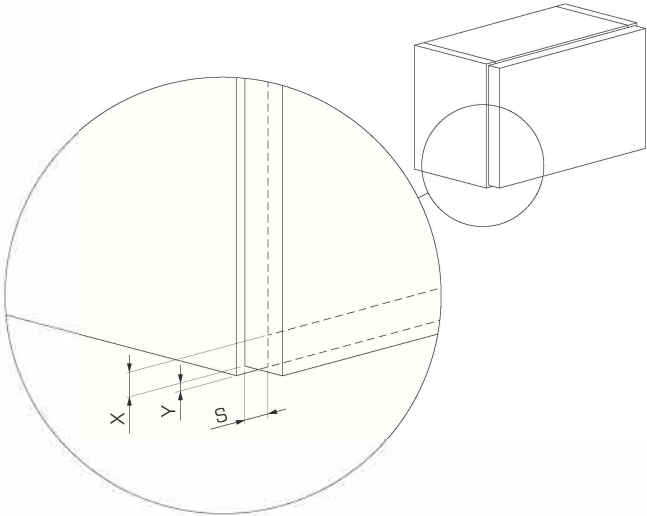
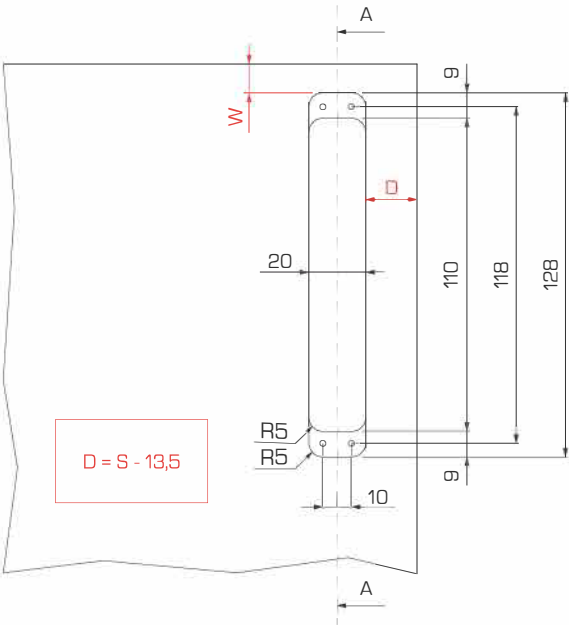

Spessori standard  
Standard thickness

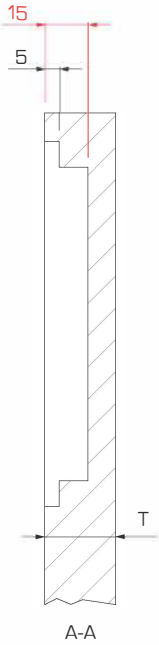

Y	W
1	11
1,5	10,5
2	10
2,5	9,5
3	9
4	8
5	7



Montaggio incassato in controspalla  
Recessed mounting in cover side panel

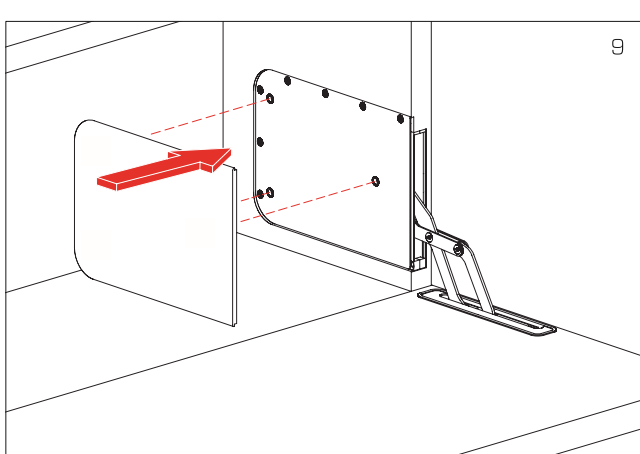
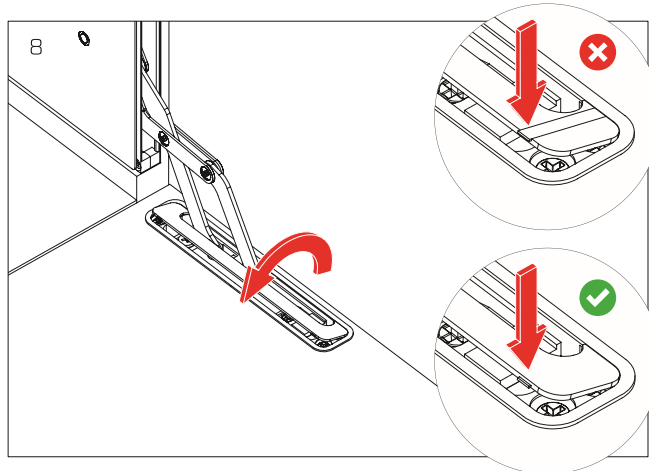
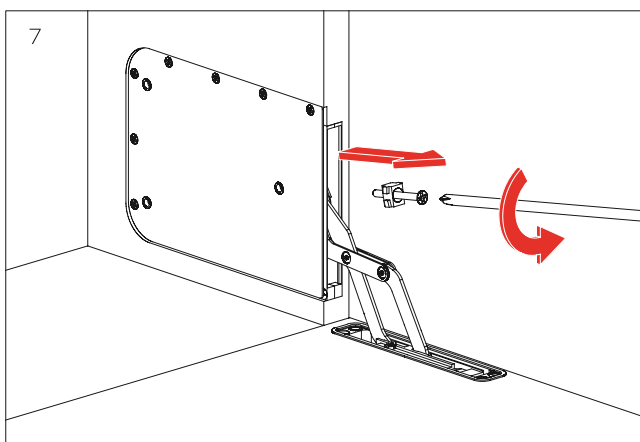
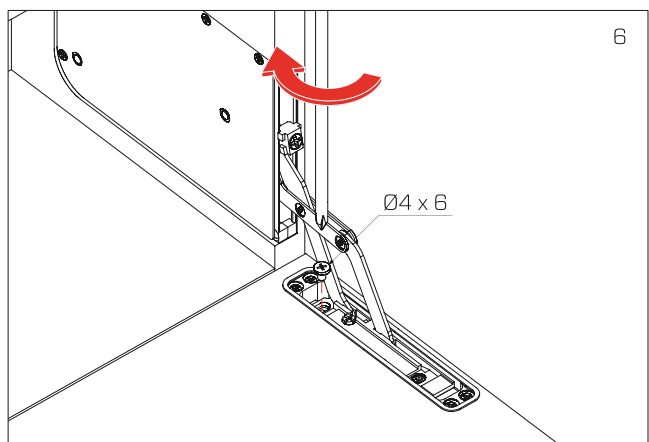
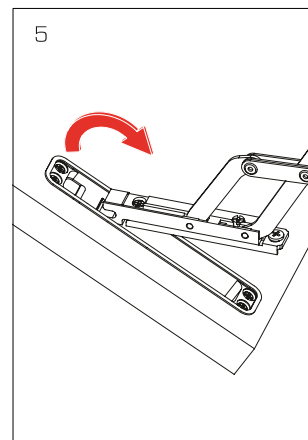
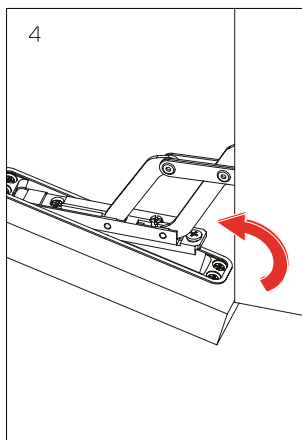
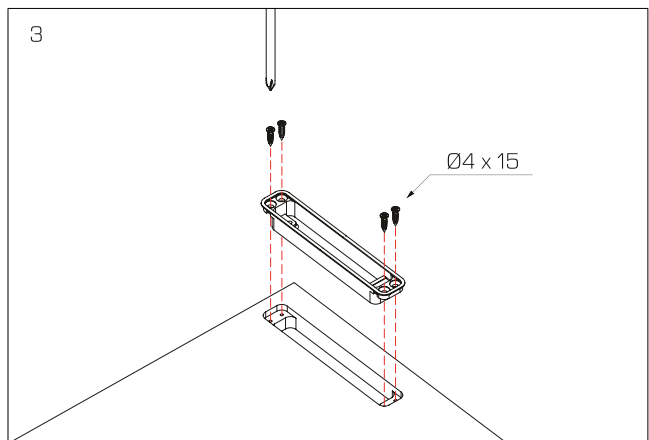
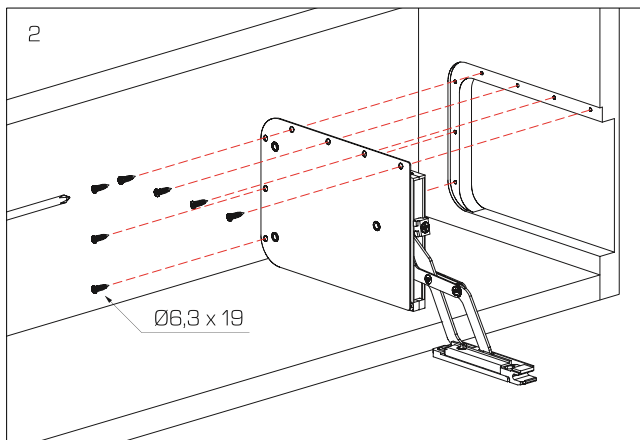
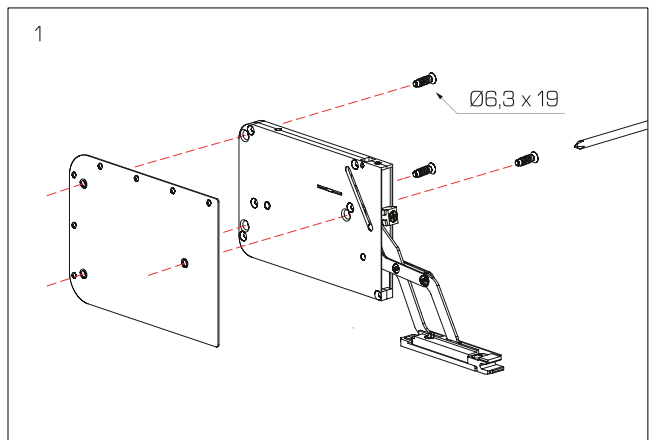



Tabelle pesi anta (kg)  
Door weight tables (kg)



Hp	Mod. S	Mod. M
180 - 230	4,8 - 6,3	7,0 - 8,5
230 - 270	3,8 - 5,5	5,5 - 7,5
270 - 330	3,4 - 4,5	5,2 - 6,4
330 - 380	2,9 - 4,2	4,3 - 5,5
380 - 430	2,5 - 3,6	3,7 - 4,7
430 - 480	2,0 - 2,9	3,0 - 4,0

**Finiture meccanismo**  
Mechanism's finishing

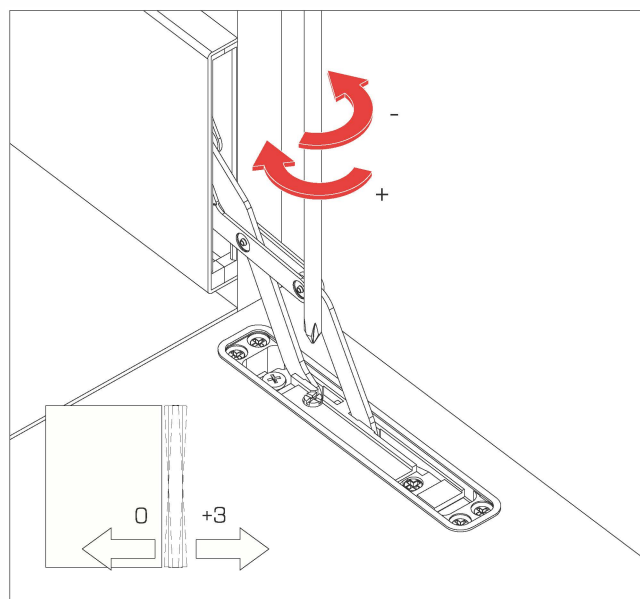
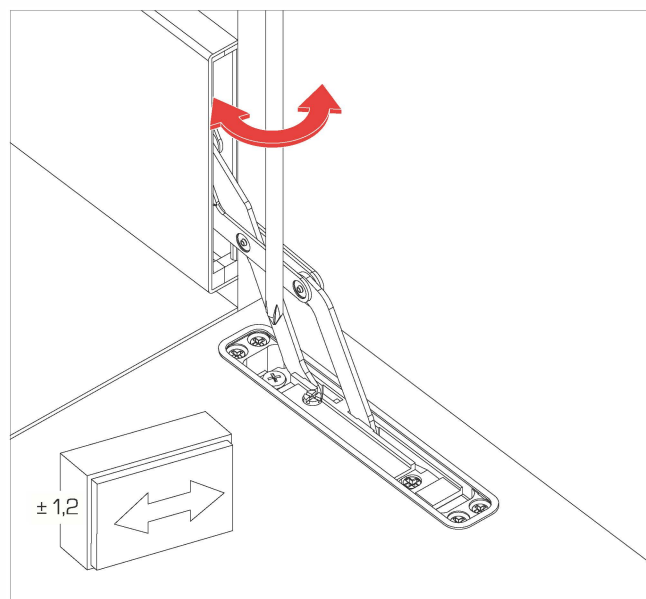
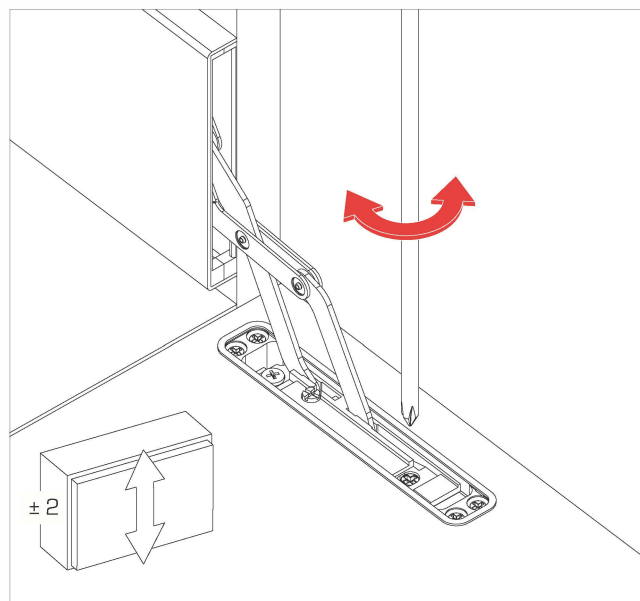
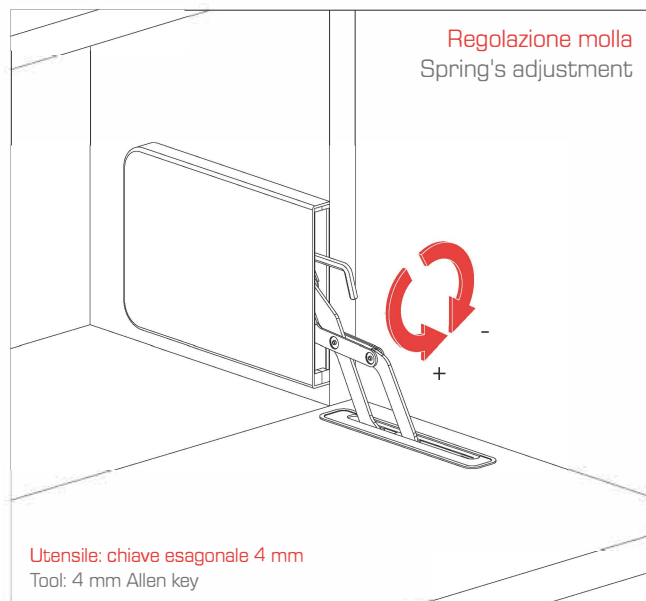
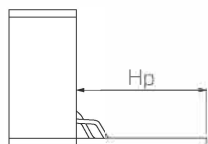
---



**Nichelata**  
Nickel plated

**Colori standard cover**  
Cover's standard colors

---



**Bianco**  
White



**Nero**  
Black

**Imballaggio**  
Packaging

---

**Contiene 1 SET di meccanismi (dx+sx)**  
Contains 1 SET of mechanisms (left+right)

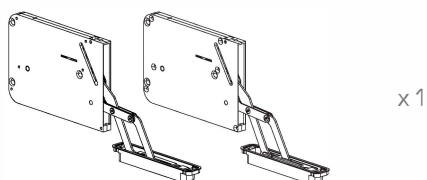

**Contiene 1 SET di cover (per meccanismi e attacchi anta, dx+sx)**  
Contain 1 SET of covers (for mechanisms and door connections, left+right)

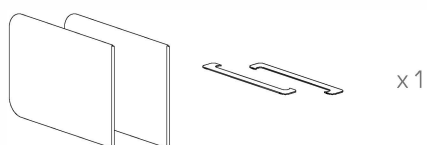

**Contiene 1 SET di piastre (dx+sx)**  
Contains 1 SET of plates (left+right)

