

Accessoire HAWA-Junior 80

Patente Brevets Patents



DE Planung: Set zur Montage/Demontage von Laufschienen in Wandtaschen

FR Planification: kit de montage / démontage de rails de roulement installés dans des poches murales

EN Planning: Set for assembling/disassembling top tracks in wall pockets

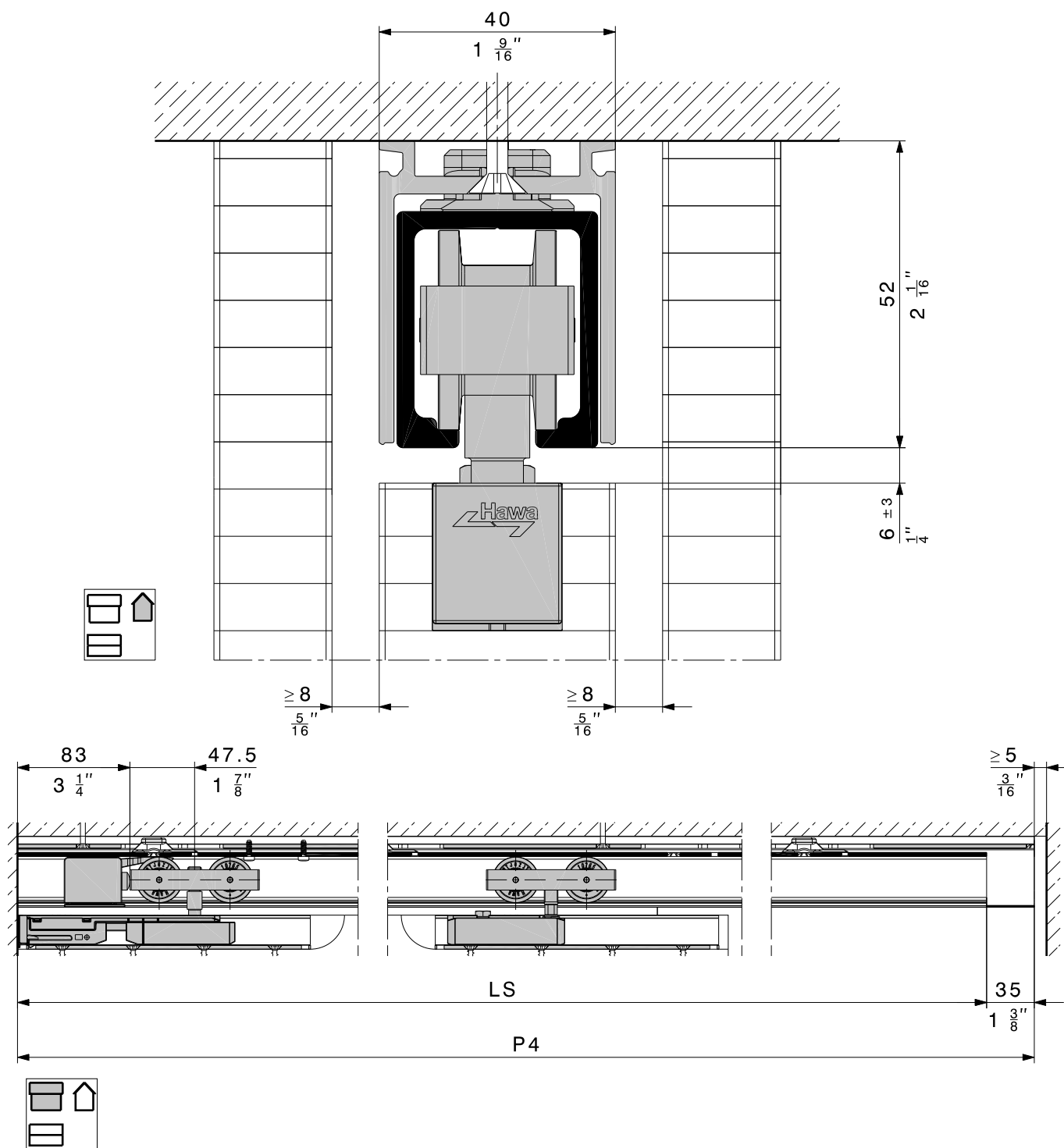

$$P4 = LS + 35$$

Accessoire HAWA-Junior 80

Patente Brevets Patents



DE	Montage: Aufnahmeprofil, Laufschiene
FR	Montage: profil de réception, rail de roulement
EN	Assembly: Retainer profile, top track

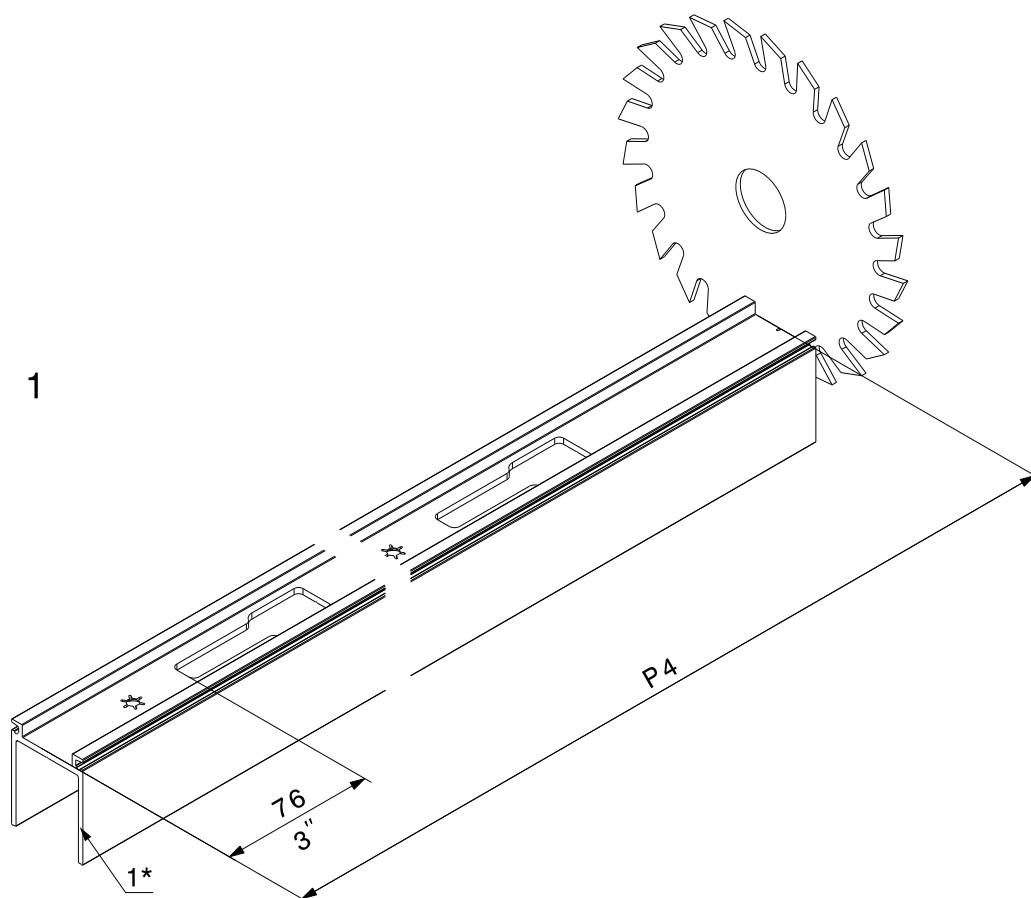

1* **DE** Mass 76 mm nicht kürzen / **FR** Ne pas raccourcir la dimension de 76 mm / **EN** Do not shorten the dimension 76 mm

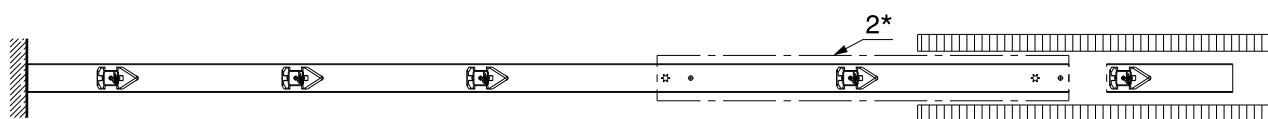
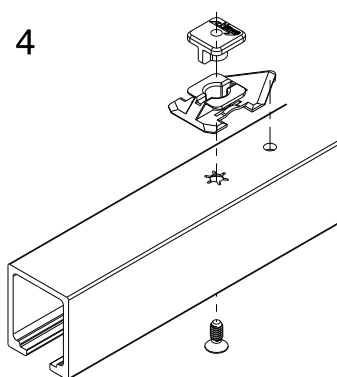
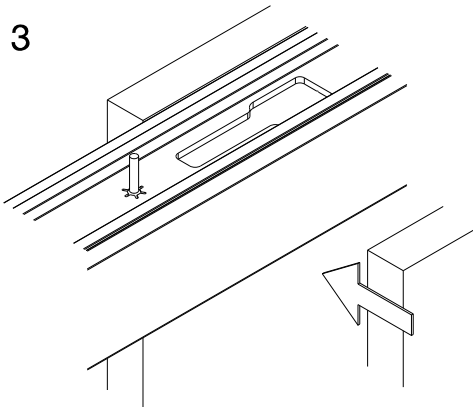
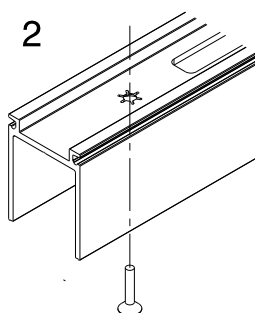

2* **DE** Mindestens jeden 2. Haltekopf setzen / **FR** Mettre en place au moins 1 tête de maintien sur 2 / **EN** Insert at least every 2nd holder

Accessoire HAWA-Junior 80

Patente Brevets Patents

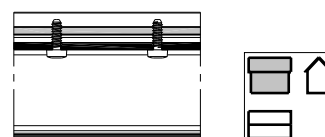
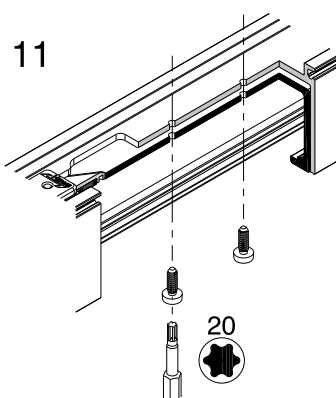
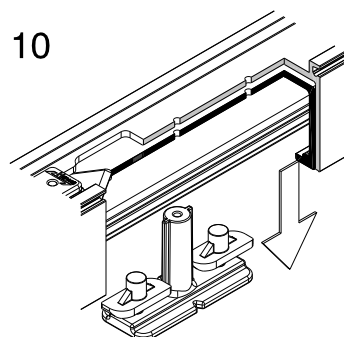
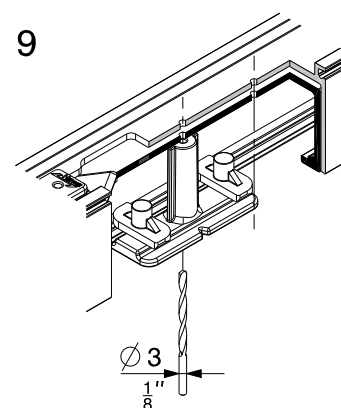
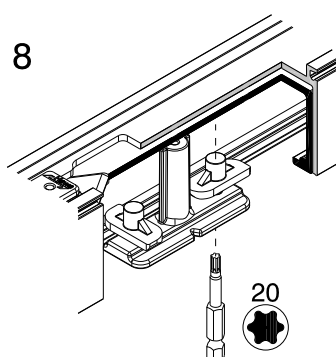
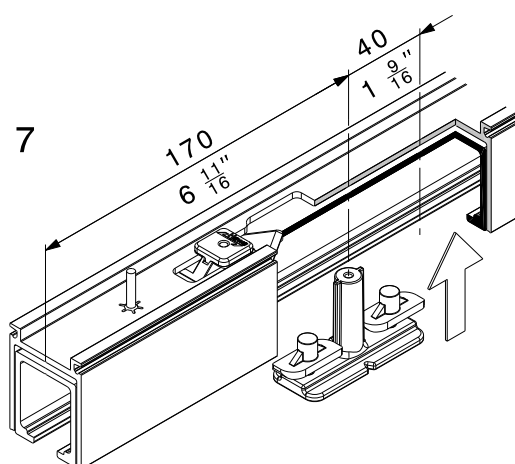
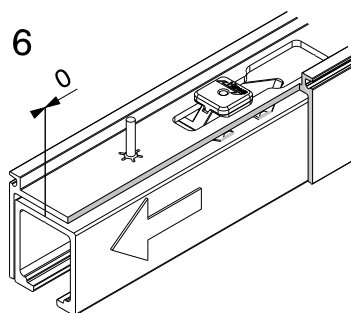
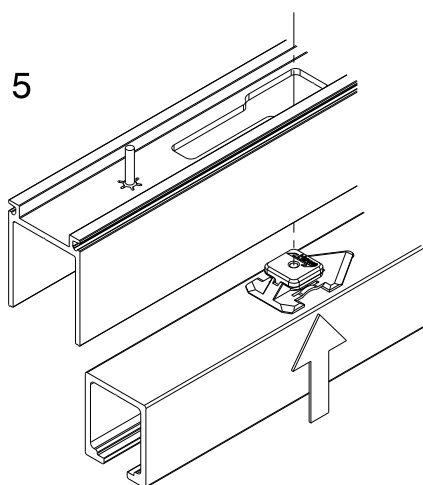

Accessoire HAWA-Junior 80

Patente Brevets Patents



DE Optional: Clipblende

FR En option: cache à clipser

EN Optional: clip-on cover

DE Dicke der Holzbeplankung / FR Epaisseur du revêtement en bois / EN Thickness of the wood panelling	DE Notwendiger Abstand der Holzbeplankung zur Decke / FR Ecart nécessaire entre le revêtement en bois et le plafond / EN Required distance between wood panelling and ceiling
M1	M2
16 mm ($\frac{5}{8}$ ") - 26 mm ($1\frac{1}{32}$ ")	5 mm ($\frac{3}{16}$ ")
27 mm ($1\frac{1}{16}$ ") - 40 mm ($1\frac{8}{16}$ ")	6 mm ($\frac{1}{4}$ ")

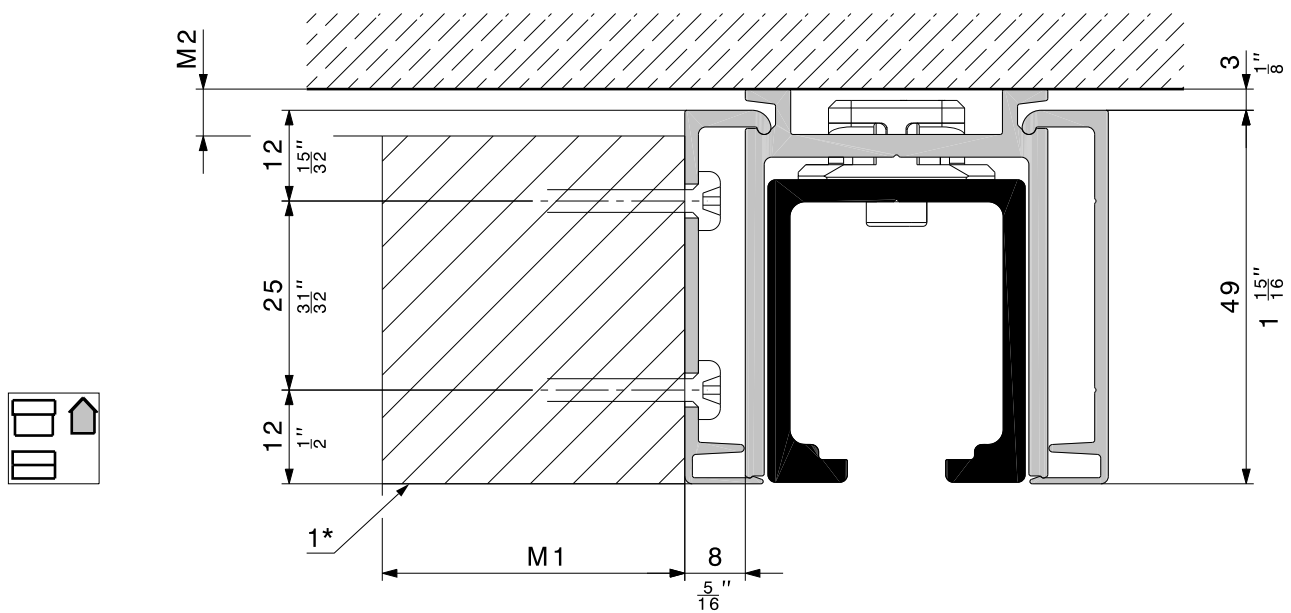

1* **DE** bauseits / **FR** incombant au client / **EN** provided by customer

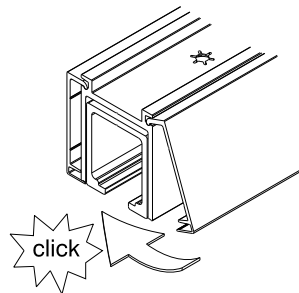

■ **DE** Hawa Teile / **FR** Éléments Hawa / **EN** Hawa Components

DE Es gelten metrische Abmessungen – Abmessungen in Zollangaben sind nur zur Information.
EN Metric Dimensions are valid - dimensions stated in inches are for information only.