

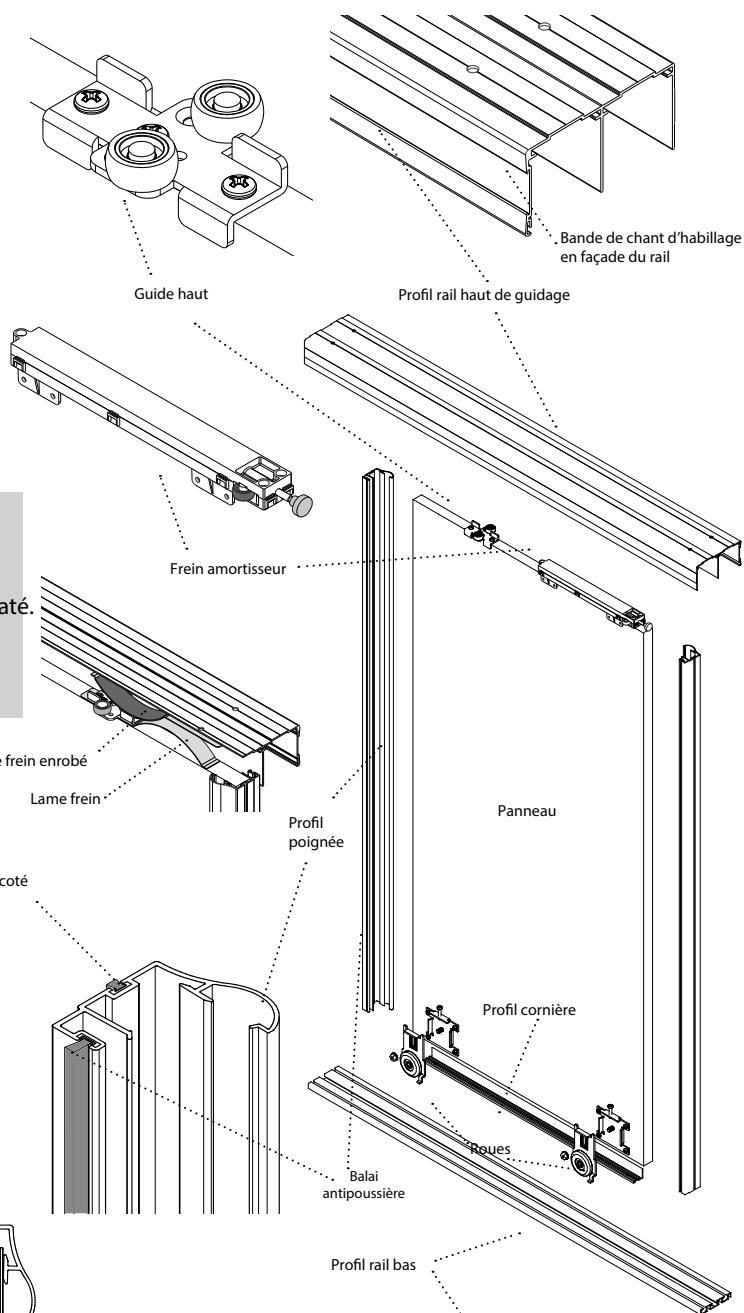

Hauteur maxi: 2600mm Largeur mini/maxi: 500-1100mm
 Remplissages: – Mèlaminé: 19mm
 – Mèlaminé + (miroir ou verre): 15+4mm
 Finitions profils : aluminium anodisés, laqués, polis et chromaté.
 Platine roue: roulement à billes de précision étanche à la poussière avec un bandage de $\varnothing 42$.
 Système antidéraillement.

Composants principaux



Coupe verticale d'une installation

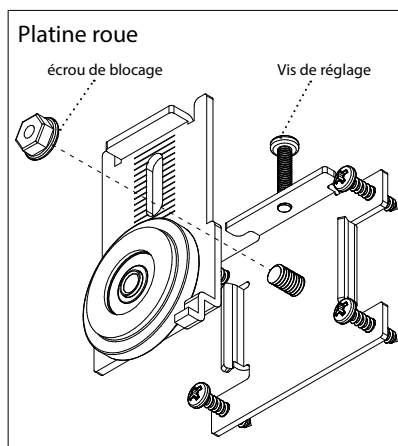
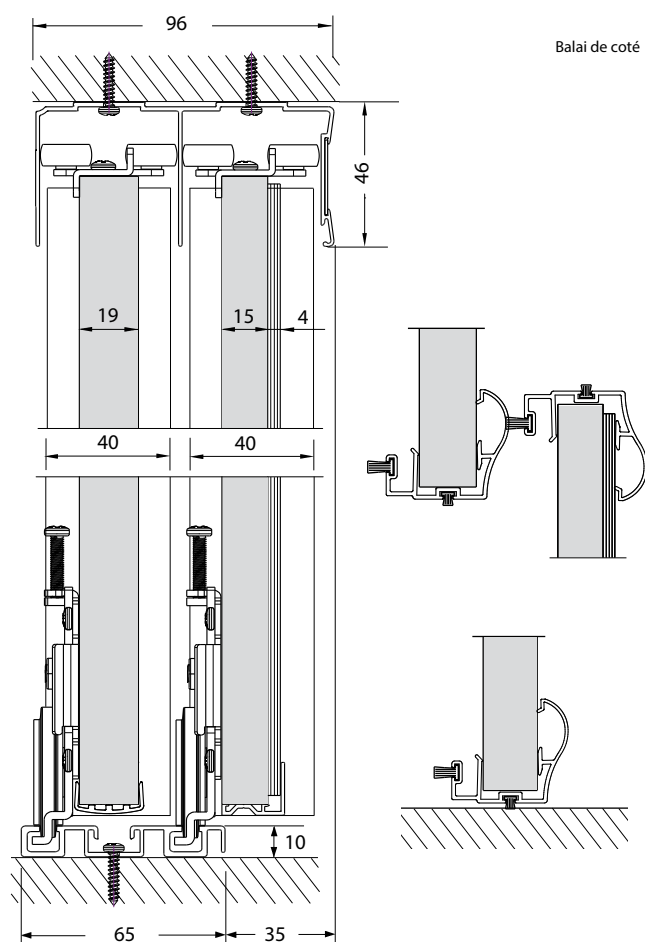

Esprit

Fiche de débits
(sans traverses)

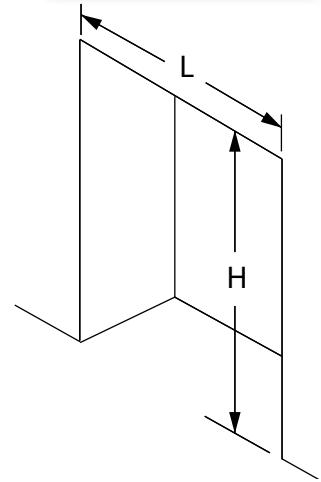
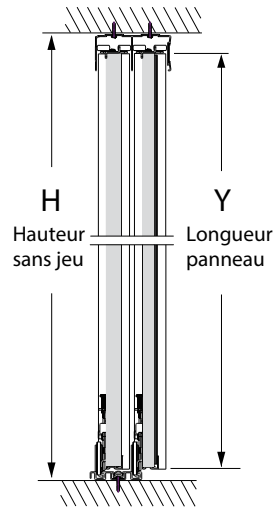

Hauteur H =	Largeur L =	RESULTAT	Quantité
A) Débit panneau (Ep = 15 ou 19mm) <ul style="list-style-type: none"> • Y (Longueur du panneau sans frein amortisseur) = H-50mm..... • Y (Longueur du panneau avec frein amortisseur) = H-50mm..... • X (Largeur du panneau) 			
①	$X = \frac{L+15}{2}$		
②	$X = \frac{L+38}{3}$		
③	$X = \frac{L+68}{4}$		
④	$X = \frac{L+30}{4}$		
⑤	$X = \frac{L+85}{5}$		
B) Débit Aluminium <ul style="list-style-type: none"> • Rail haut = L (Longueur façade)..... • Rail bas = L (Longueur façade)..... • Poignée = Y (Panneau)..... • Cornière = X-58 mm..... 			
C) Débit miroir <ul style="list-style-type: none"> • Longueur = Y-4 mm..... • Largeur = X-4 mm..... 			

Esprit

Fiche de débits
(avec traverses)

Façades japonaises

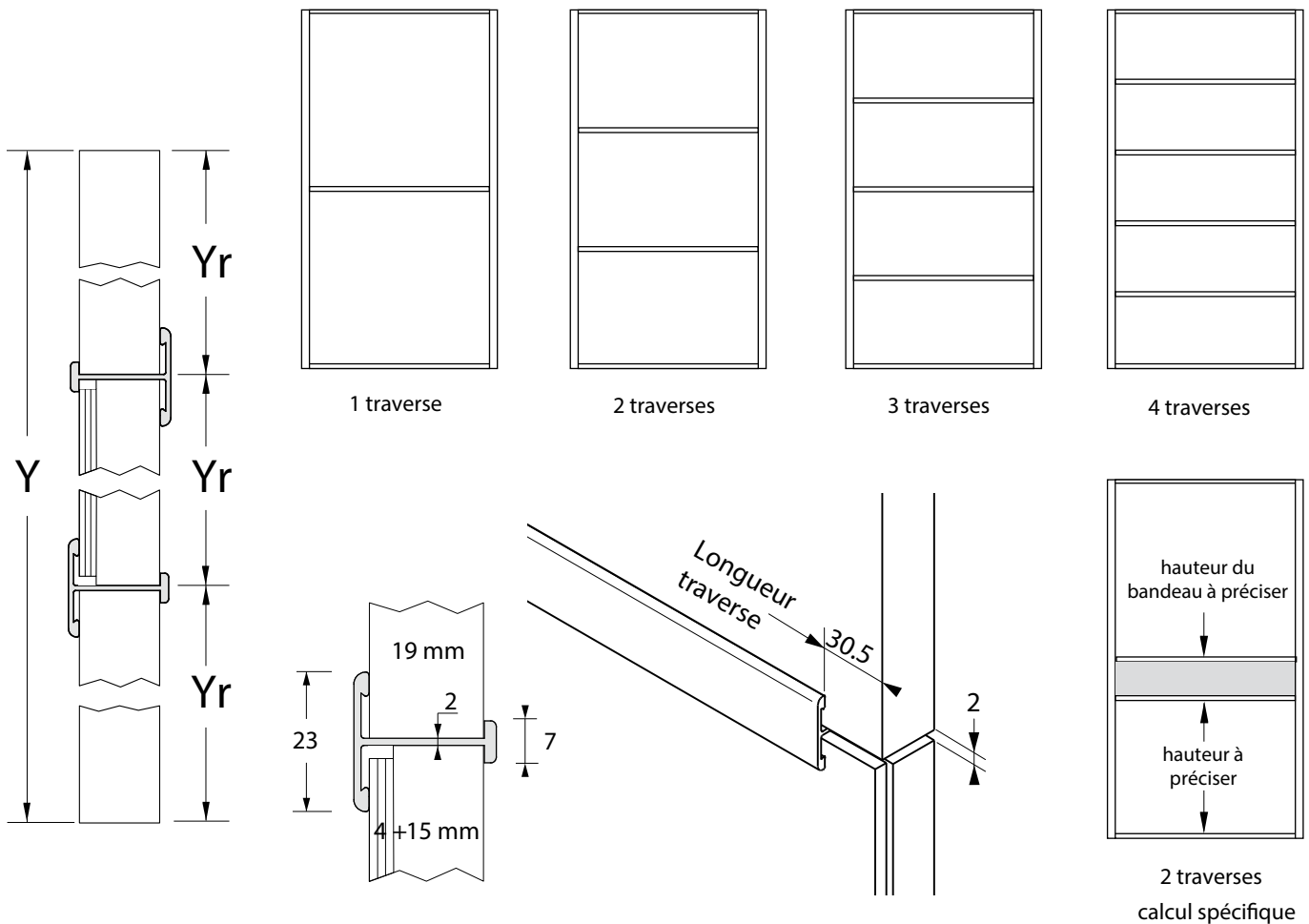

Y (Longueur panneau)= X (Largeur panneau)=

⚠ Calcul de Y et X page précédente

A) Débit remplissage (Ep = 15 ou 19mm)

• Yr (Longueur du remplissage) = $\frac{Y - (2 \text{ mm} \times \text{nombre de traverses})}{\text{Nombre de remplissages}}$

• Xr (Largeur du remplissage) = X (Largeur du panneau).....

B) Débit Aluminium

• Traverse intermédiaire 7 ou 23 mm = Xr- 61 mm.....

C) Débit miroir

• Longueur = Yr-4 mm.....

• Largeur = Xr-4 mm.....

RESULTAT

Quantité

Esprit

Adaptations spéciales

Façade en pan coupé avec guidage sous tablette

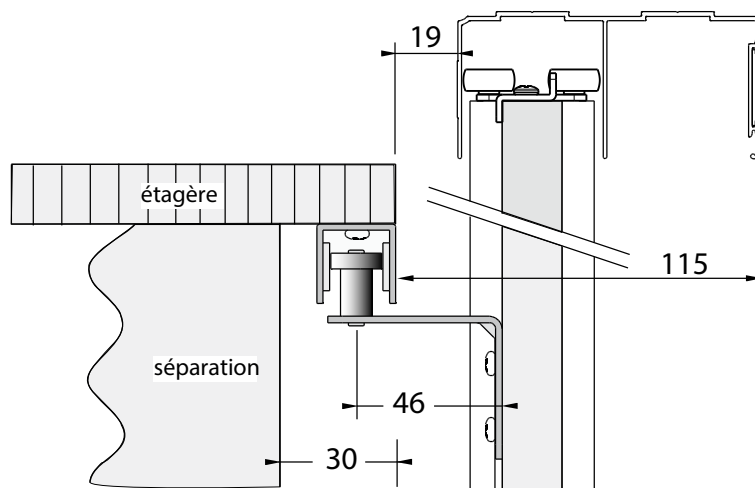
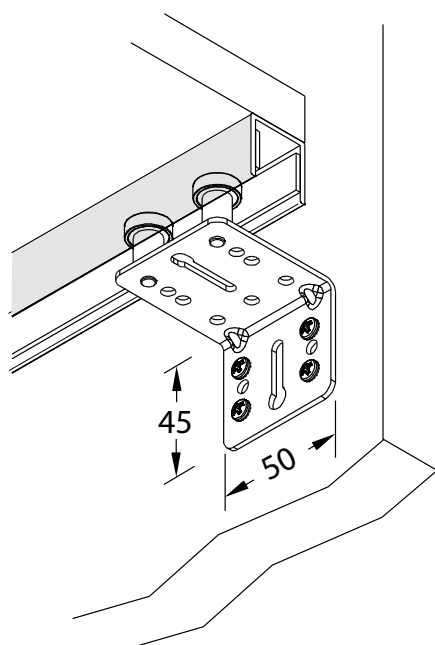

Solution1 : Porte sans guidage sous tablette

1/3 de largeur et minimum 200 mm

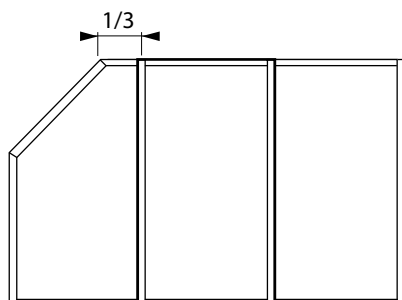

Solution2 : Porte avec guidage sous tablette

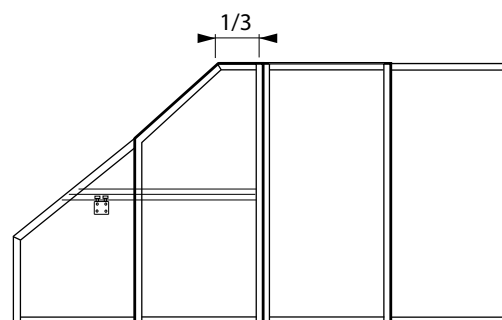

Façade avec serrure à bascule en applique

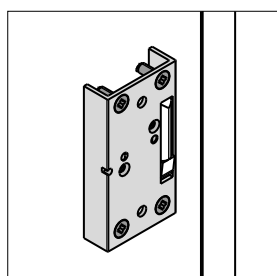

Ouvert

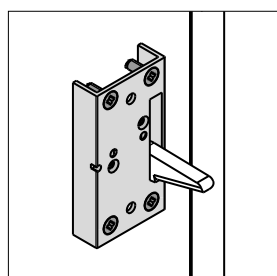

Fermé

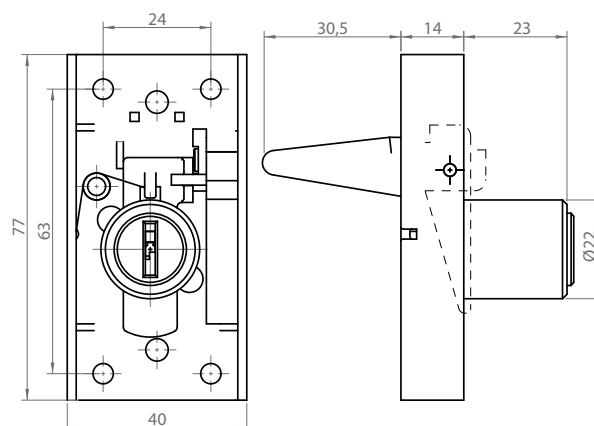

Perçage du panneau
(voir page 5)

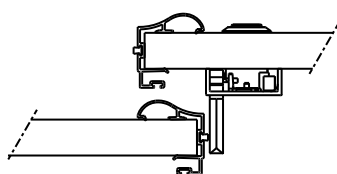

Façade à 2 portes

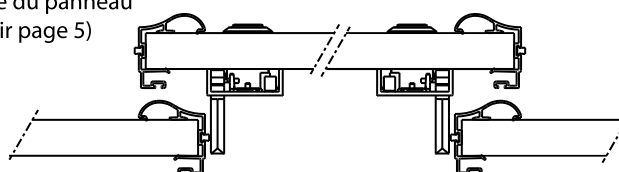

Façade à 3 portes

Esprit

Usinage et perçages

Fixation des platines p anneau

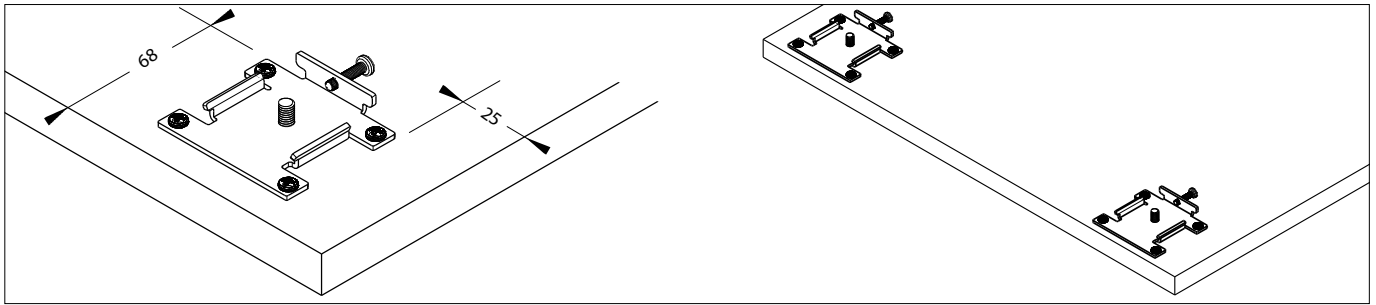

Perçage pour la serrure type OJMAR 2601 - code Y601.E06XX

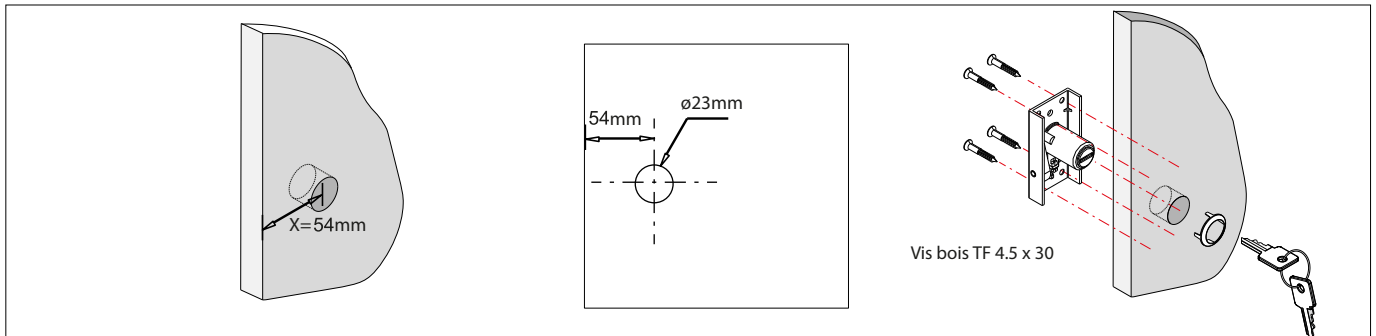

Perçage des rails et cornière

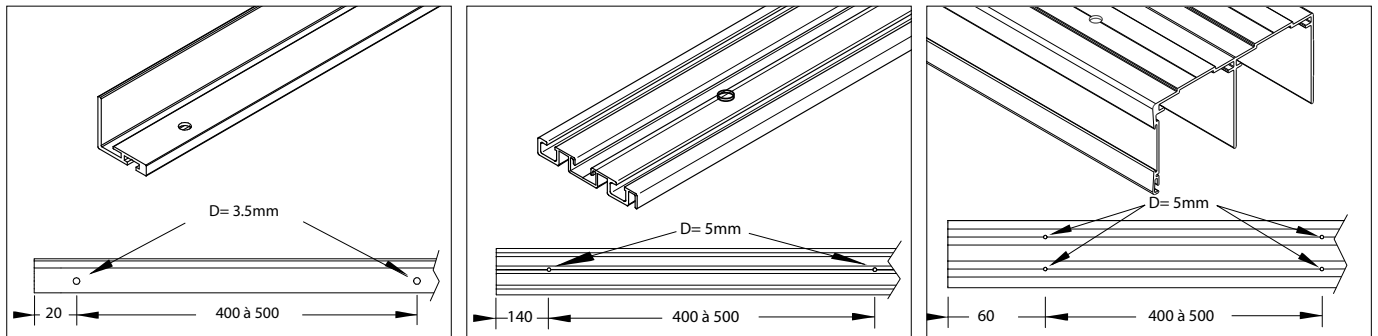

Détail de positionnement des profils

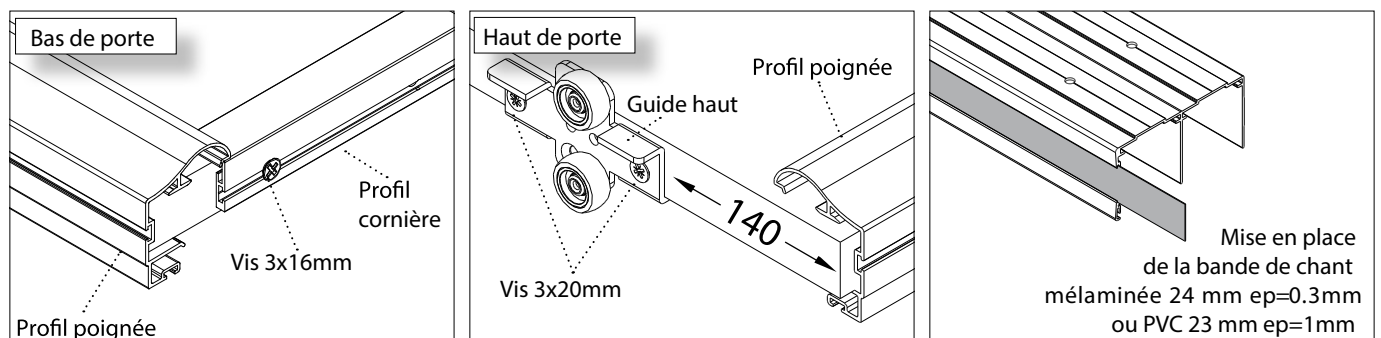

Détail de positionnement du frein amortisseur et/ou lames frein

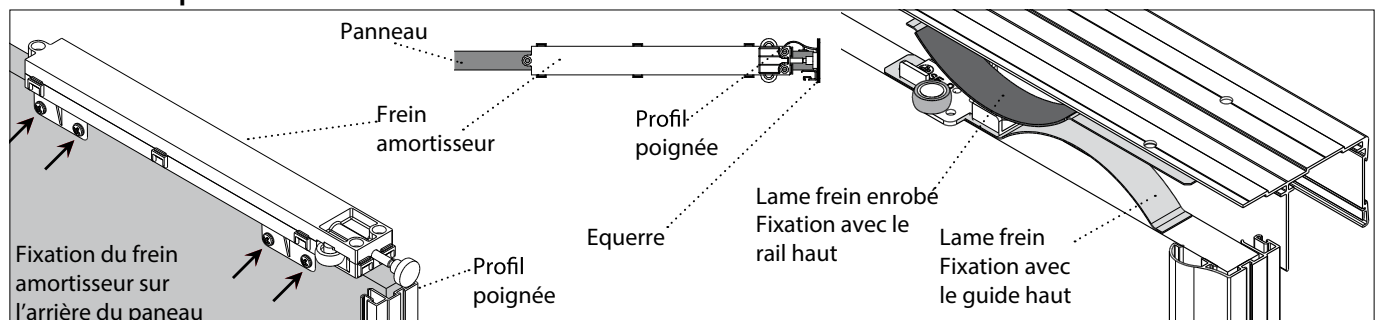

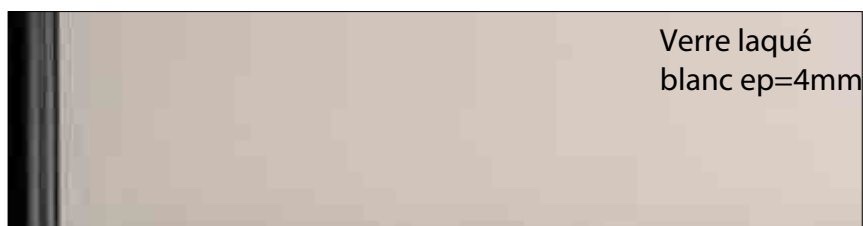



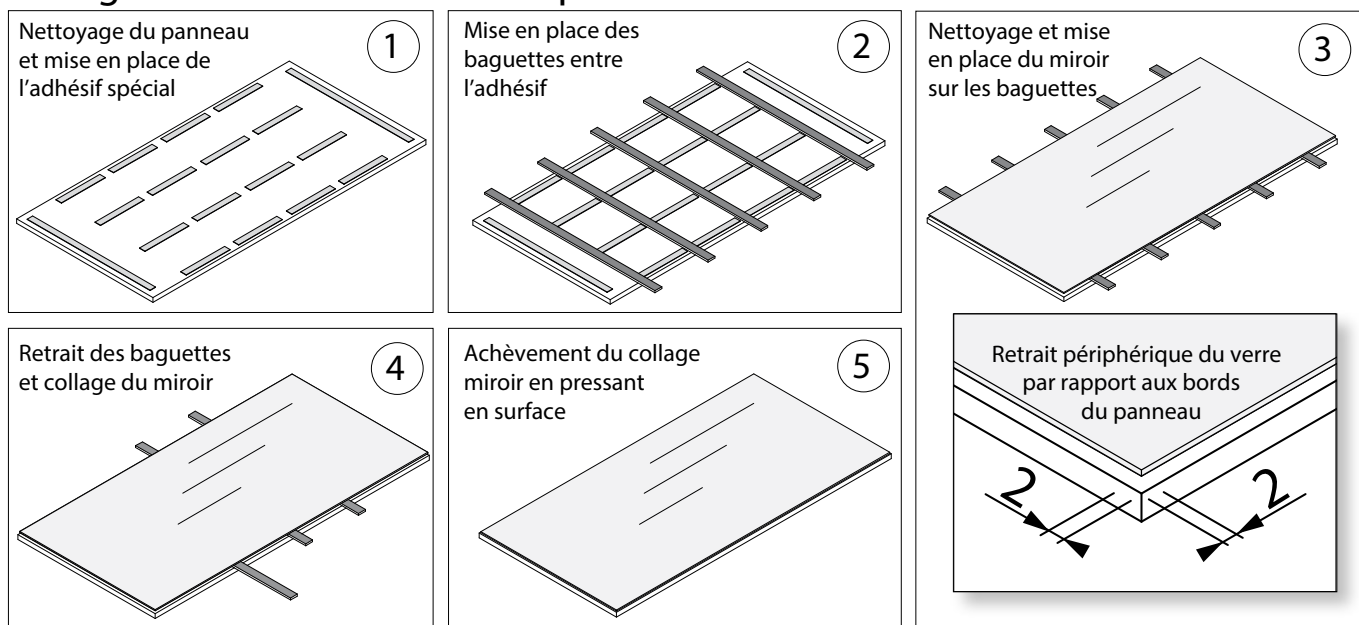

Collage d'un miroir ou verre laqué

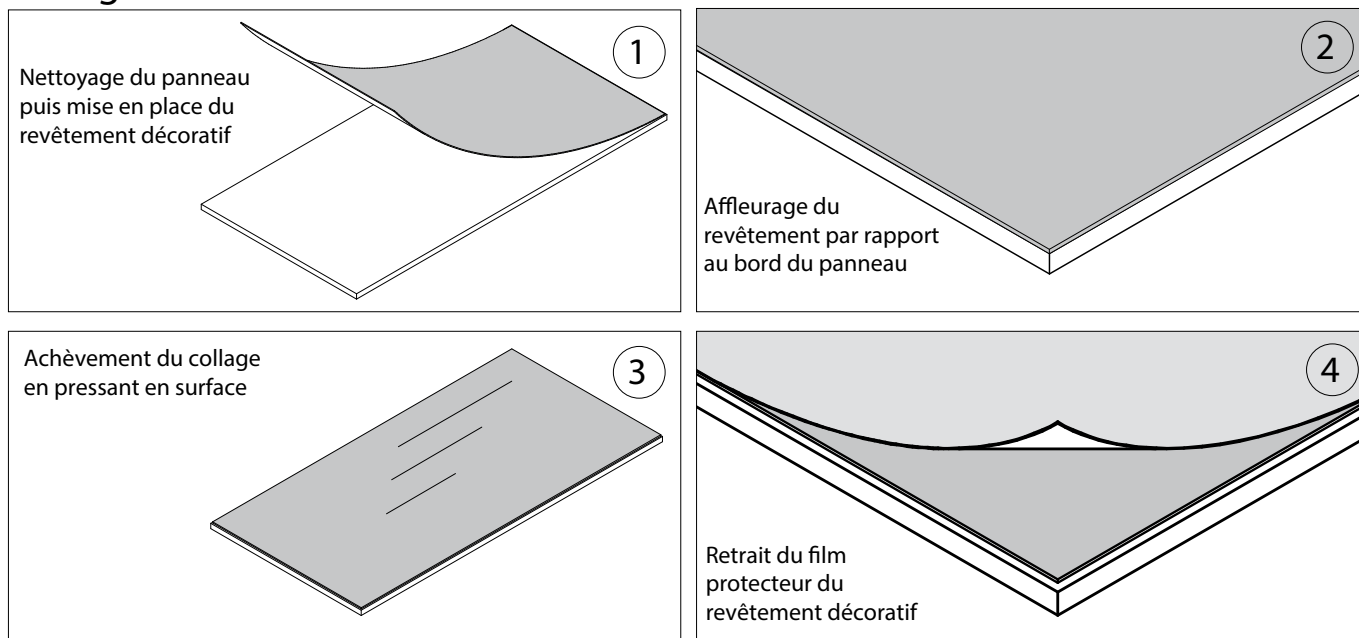

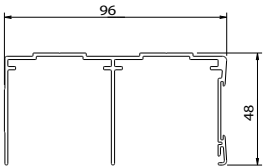
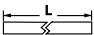
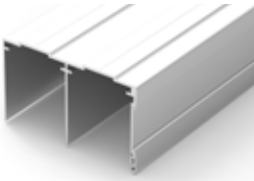
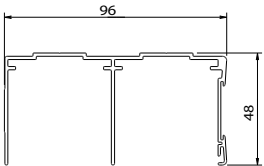
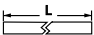
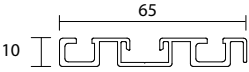
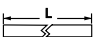
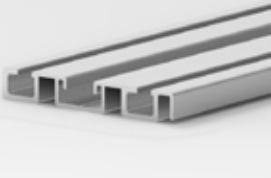
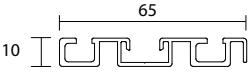
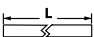
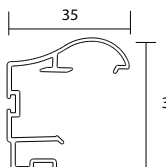
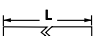

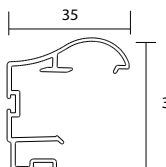
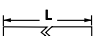
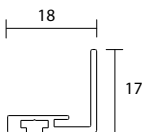
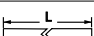

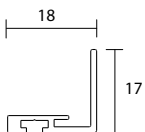
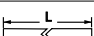
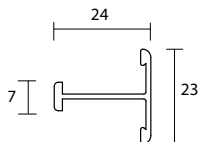
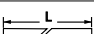
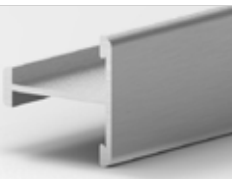
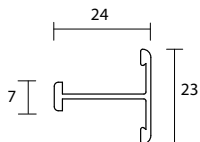
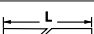

Collage d'un revêtement décoratif

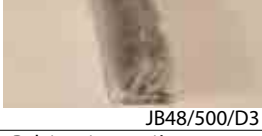

Rail haut				Code	Finitions	
				5.14 m	RH96	Anodisés: satiné argent, satiné or
						Laqués: blanc, beige, noir
						Polis: argent, bronze
Rail bas				Code	Finitions	
				5.14 m	RB65	Anodisés: satiné argent, satiné or
						Laqués: blanc, beige, noir
						Polis: argent, bronze
Poignée				Code	Finitions	
				5.14 m	P300-19	Anodisés: satiné argent, satiné or
						Laqués: blanc, beige, noir
						Polis: argent, bronze
						Enrobés : *
Cornière				Code	Finitions	
				5.14 m	CCLA	Anodisés: satiné argent, satiné or
						Laqués: blanc, beige, noir
						Polis: argent, bronze
						Enrobés : *
Traverse intermédiaire				Code	Finitions	
				5.14 m	TI19	Anodisé: satiné argent
						Laqués: blanc, beige, noir
						Polis: argent
						Enrobés : *

* Enrobé ton bois : Calvados sardoine, Chêne de Ferrare Chocolat, Chêne de Ferrare Clair

Roue complète avec écrou 	Lame ressort frein/enrobé 	Guide haut 	Balai de coté 	Vis de réglage 4x20 
Possibilité d'avoir un Kit 2 roues pour un vantail (KITROUPRO) ROUPROECO	FREIN / FREINENROB	Joint cache vis noir / gris 	Balai anti-poussière 	Vis platine 4x16 
		JTOP / JTOPGR	JB481050/D3	VIS4/16



FR96

