

PS23 Self opening

APPLICAZIONE CRICCHETTO MAGNETICO
MAGNETIC RELEASE DEVICES APPLICATION

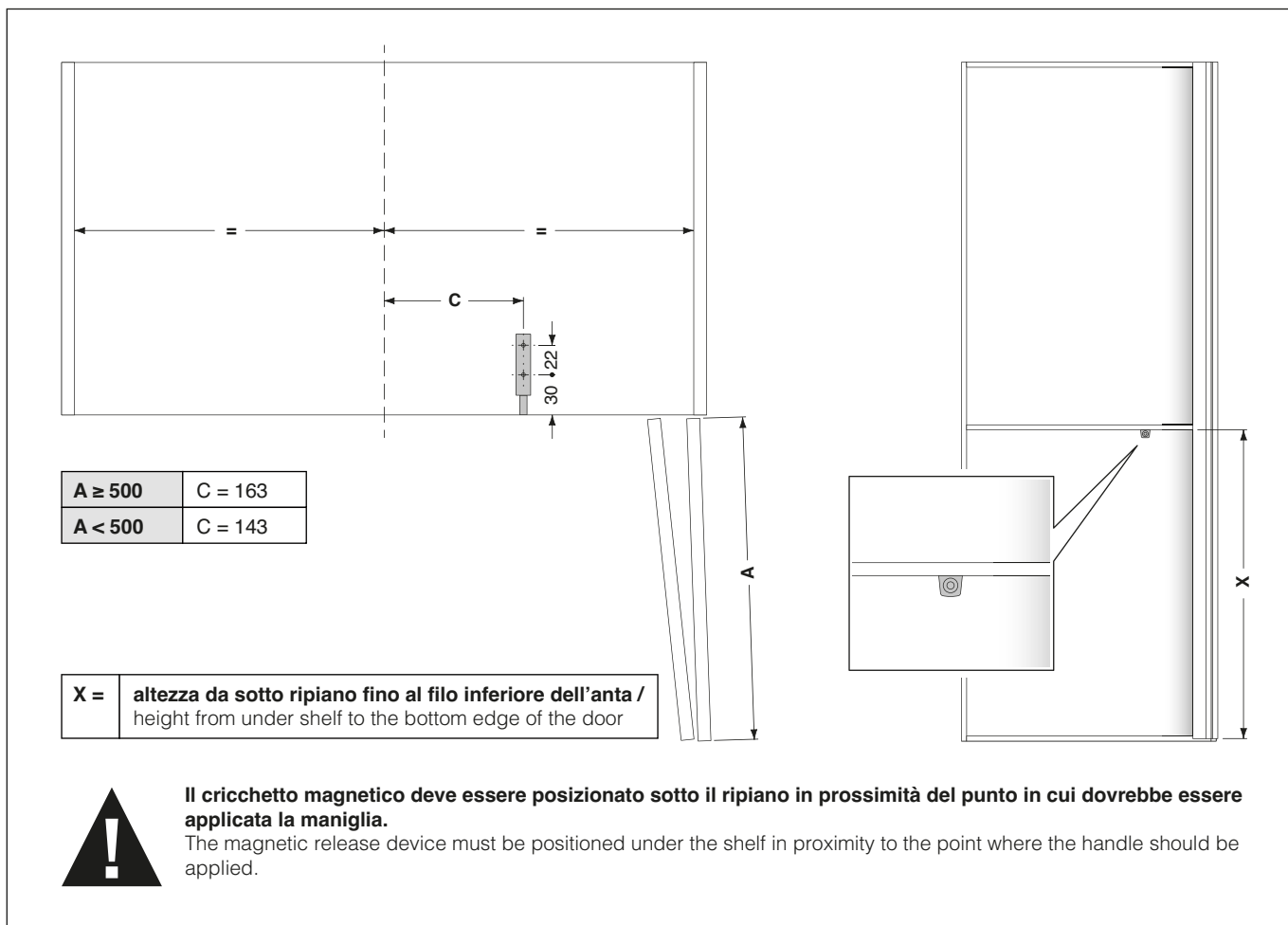

1

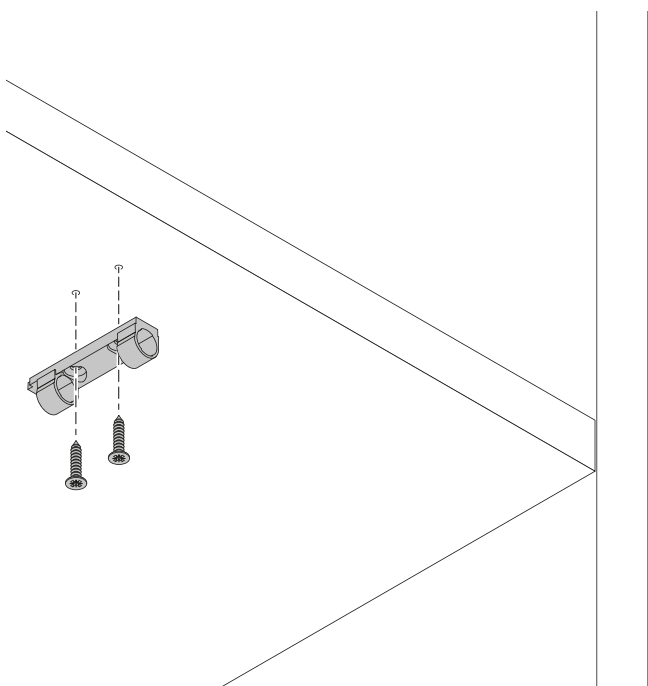

2

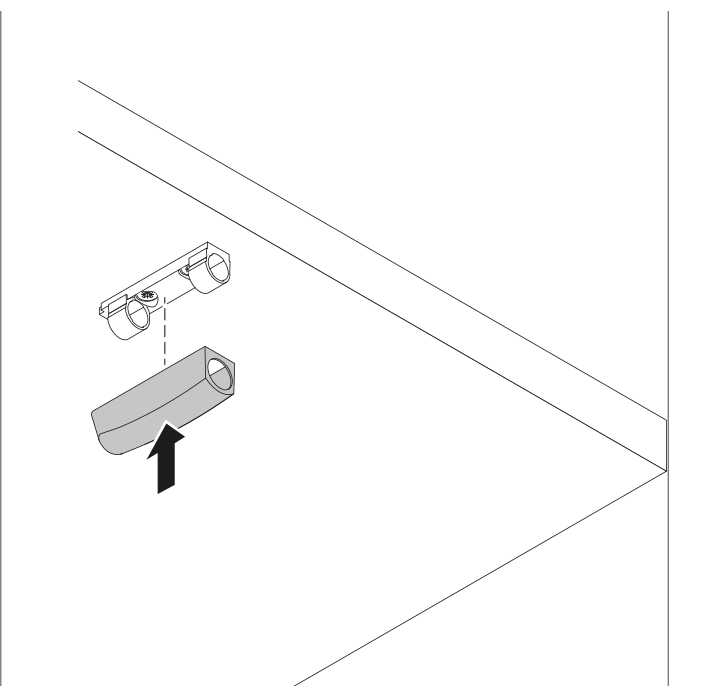

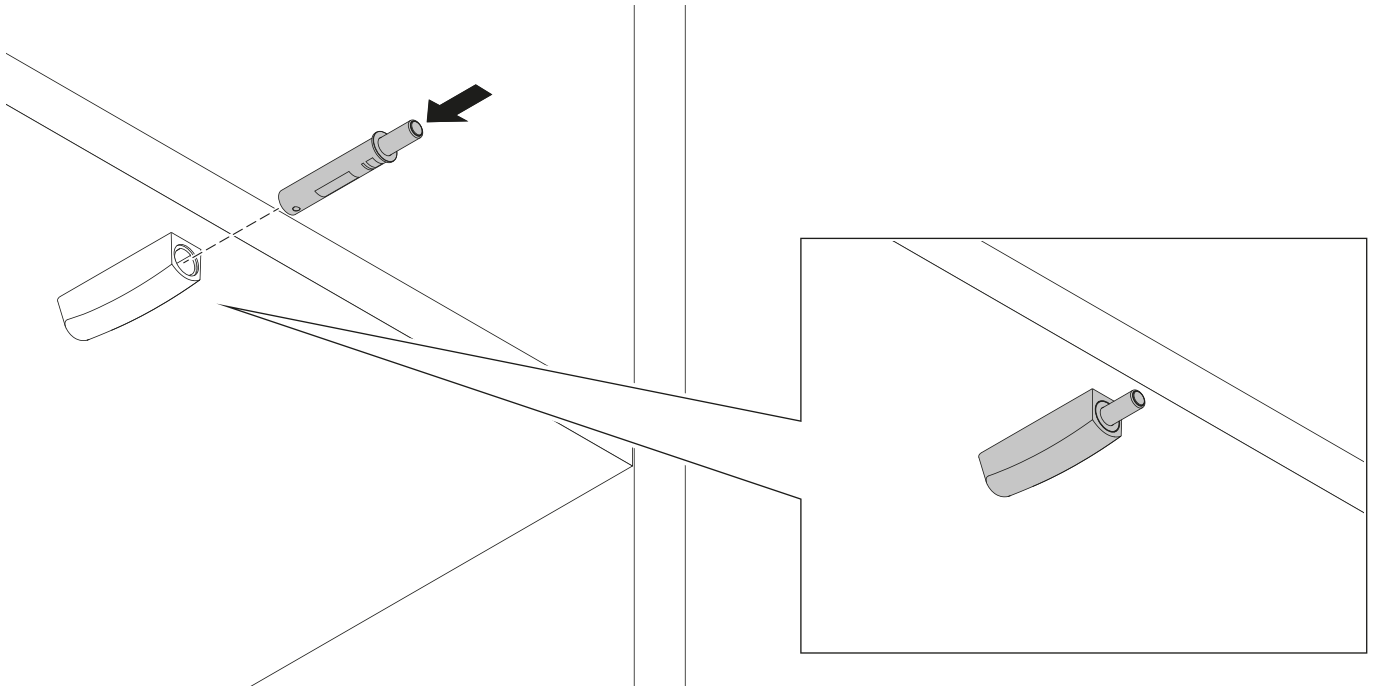

APPLICAZIONE SUPPORTO CON MAGNETE SULLA SEMIANTA
 APPLICATION OF THE SUPPORT WITH MAGNET ON THE HALF-DOOR

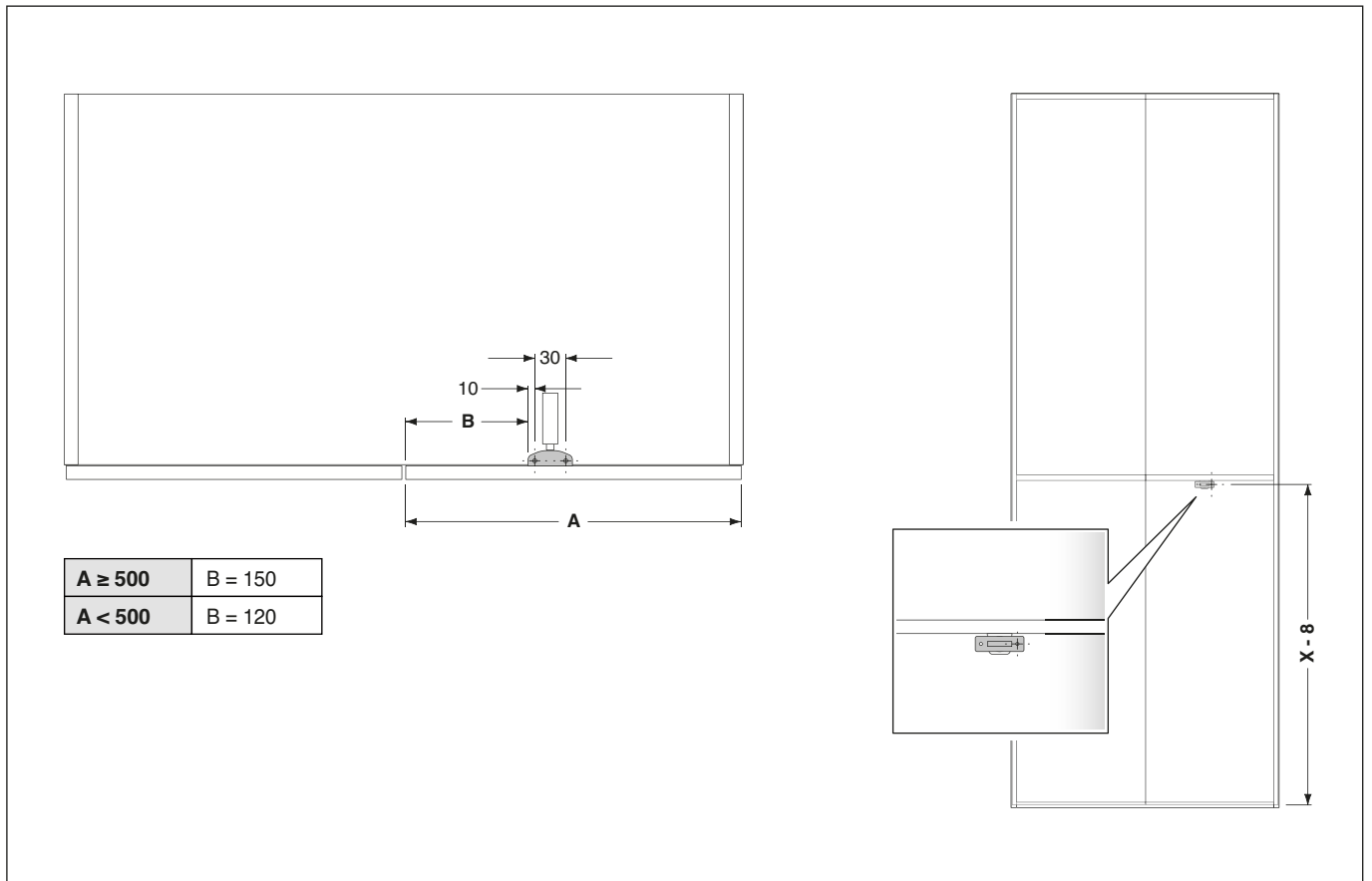

4

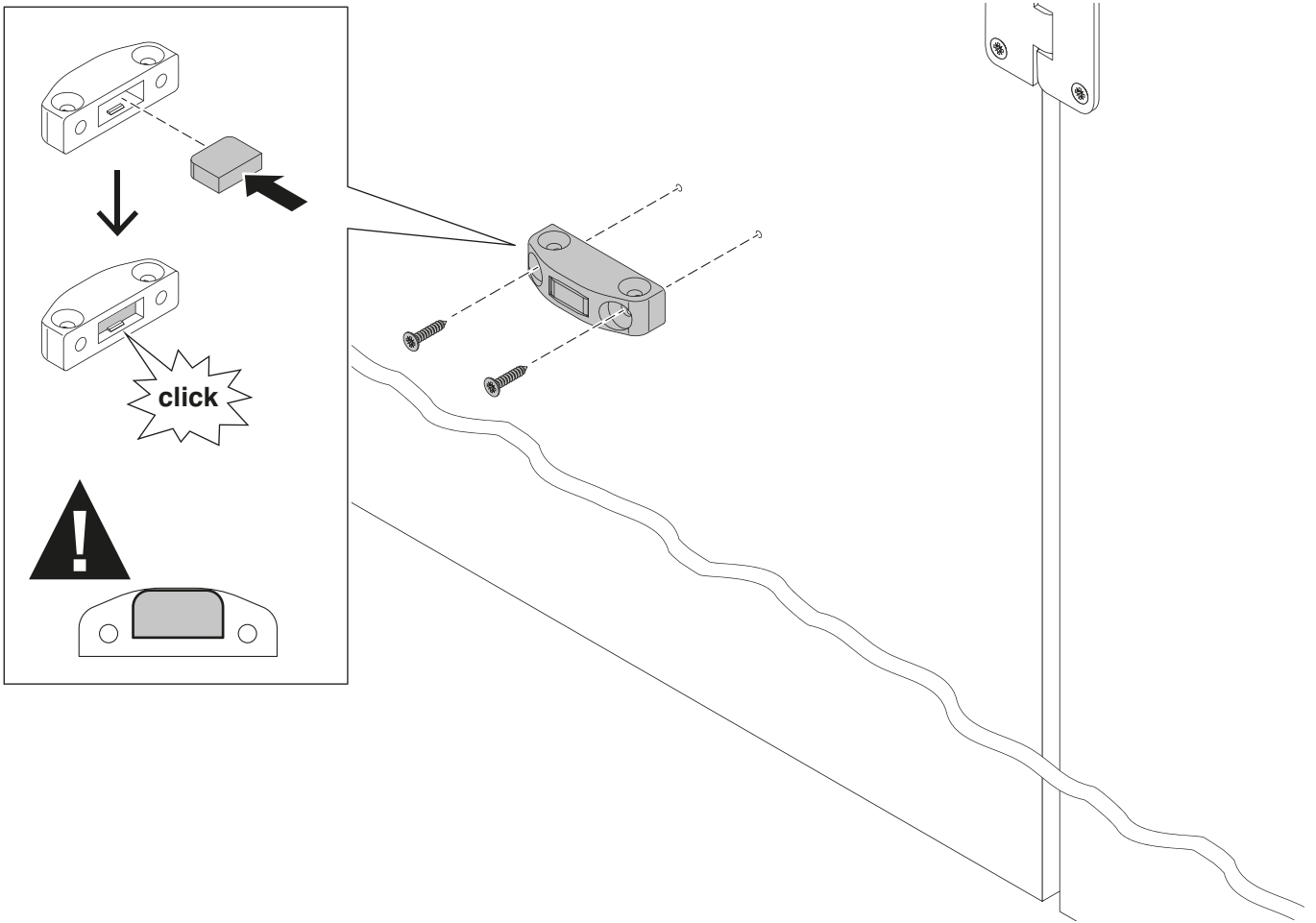

PREPARAZIONE PRELIMINARE DEL DISPOSITIVO DI APERTURA
 PRELIMINARY PREPARATION OF THE OPENING DEVICE

5

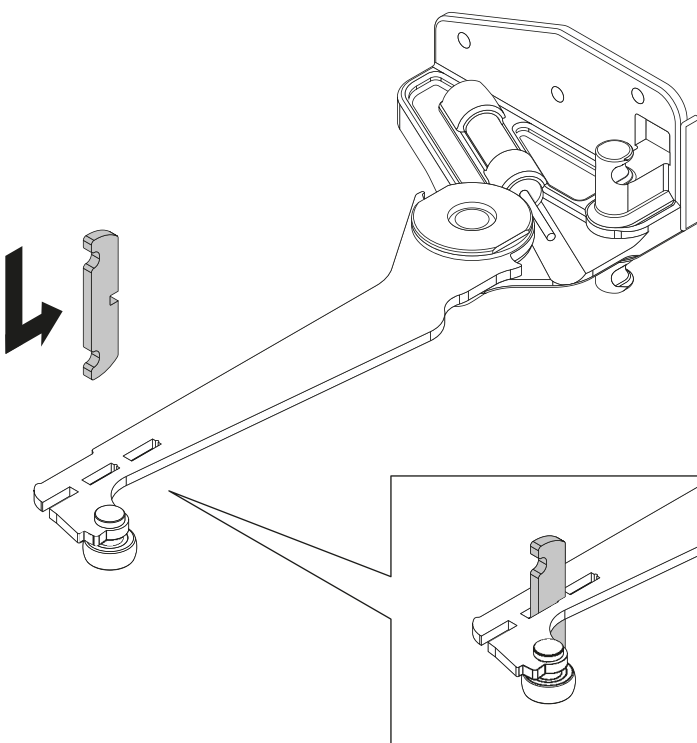

Coppia semiante Couple half-doors	*Configurazioni consigliate *Suggested configurations	
< 15 kg	SOFT	
15 ÷ 35 kg	MEDIUM	
> 35 kg	STRONG	

***La configurazione può essere modificata anche a fine montaggio.**

*The configuration can also be modified at the end of installation.

6

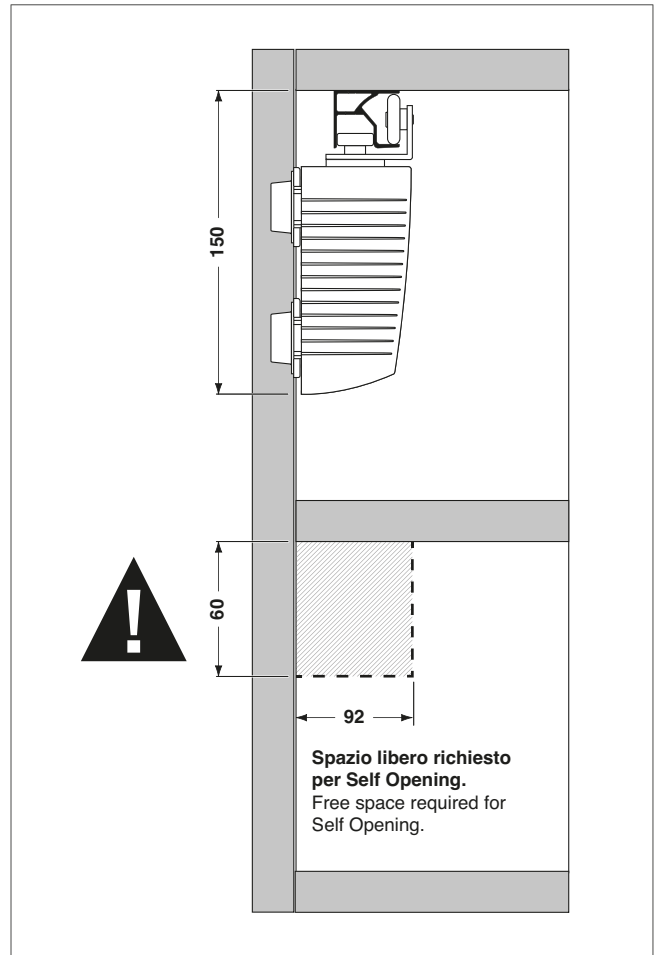
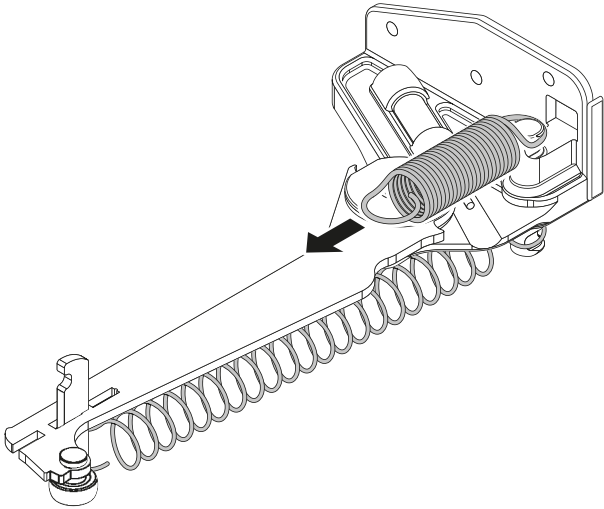

7

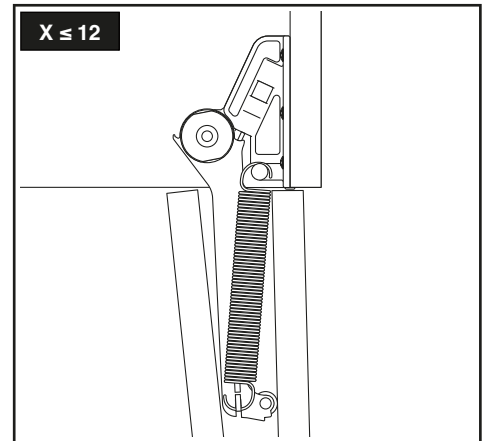
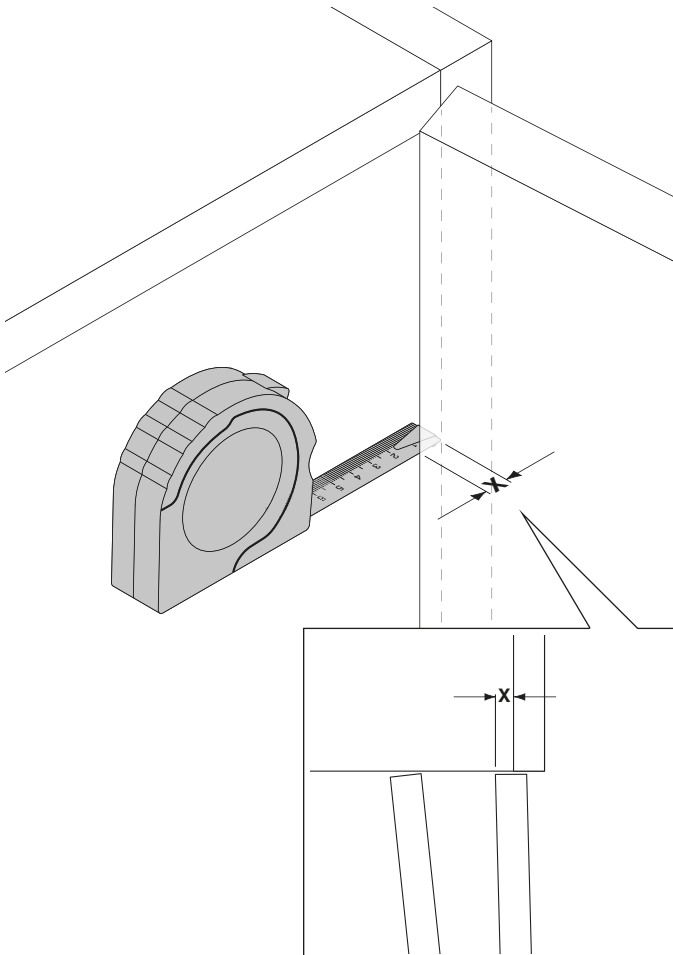

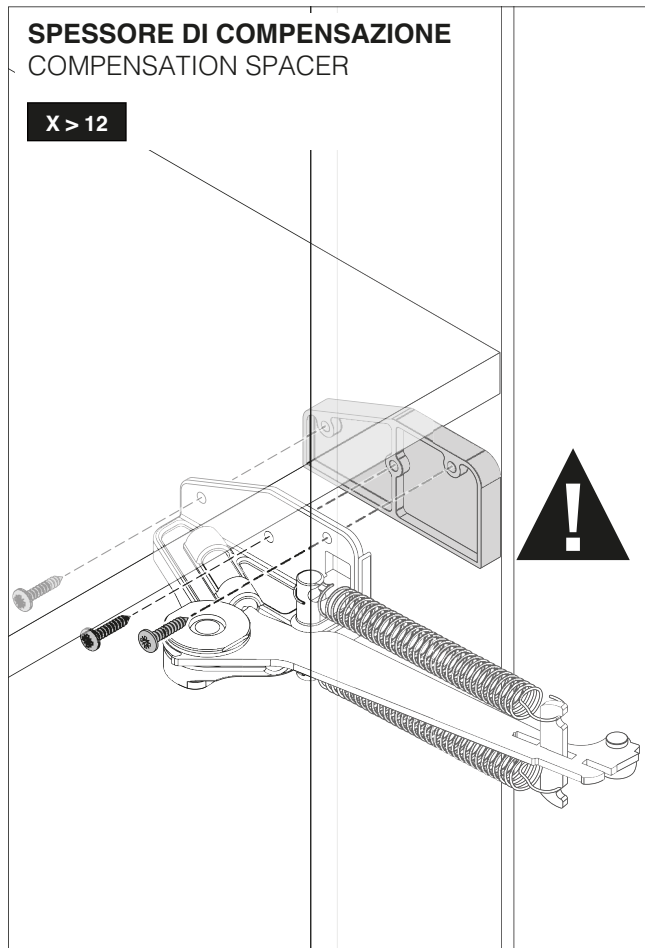
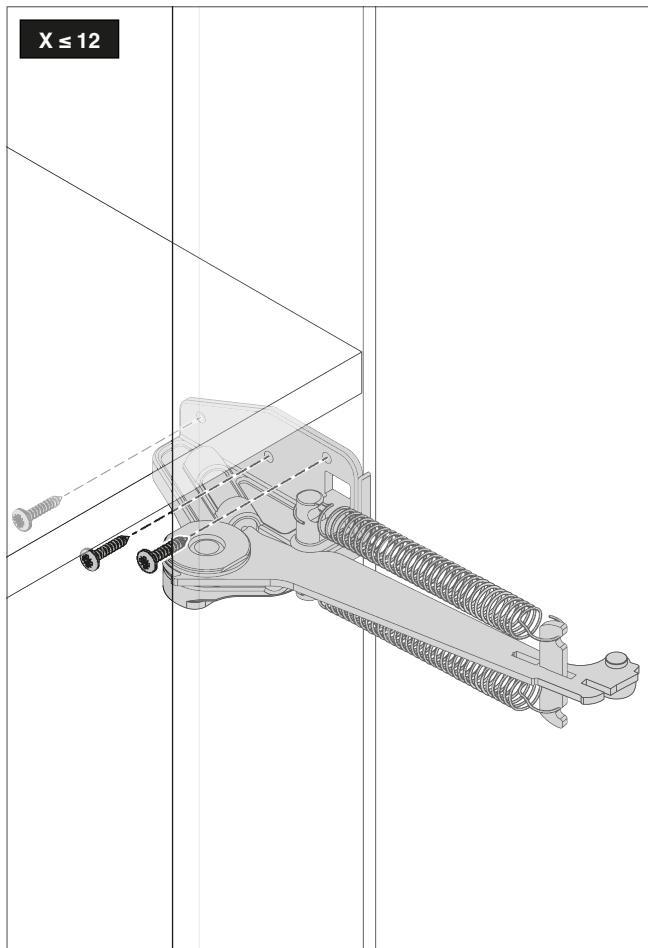

8

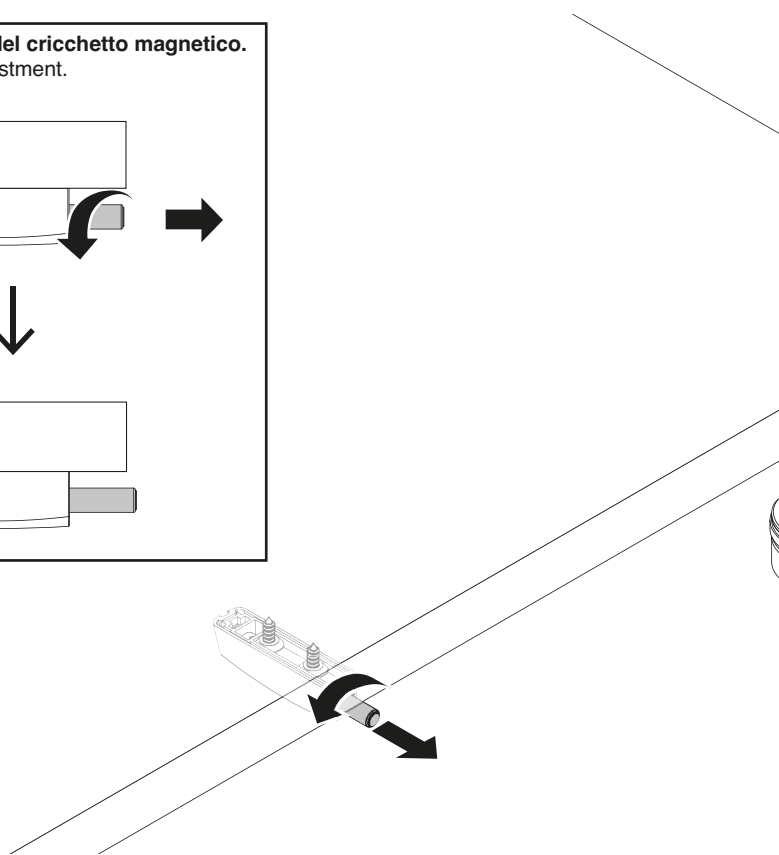
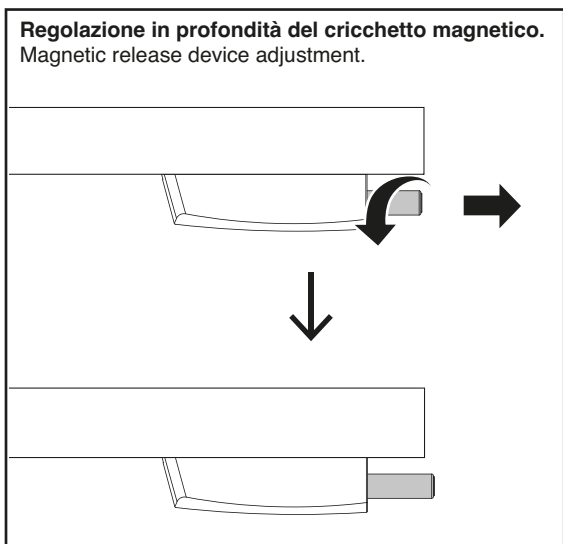

PROVARE IL FUNZIONAMENTO DEL SISTEMA PS23 SELF OPENING.
TEST THE OPERATION OF THE PS23 SELF-OPENING SYSTEM.

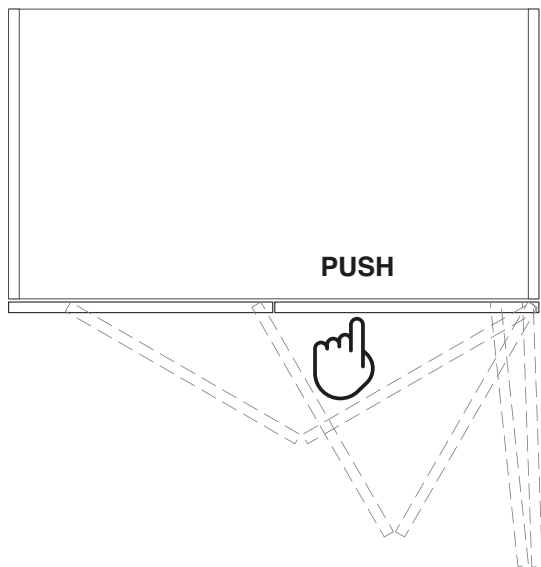

Regolazione della forza di apertura
 Opening force adjustment

SOFT

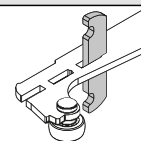

MEDIUM

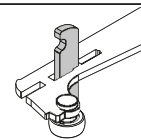

STRONG

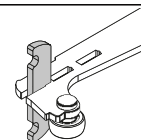

9

