

OPEN BOX

DEFINITION DU PRODUIT

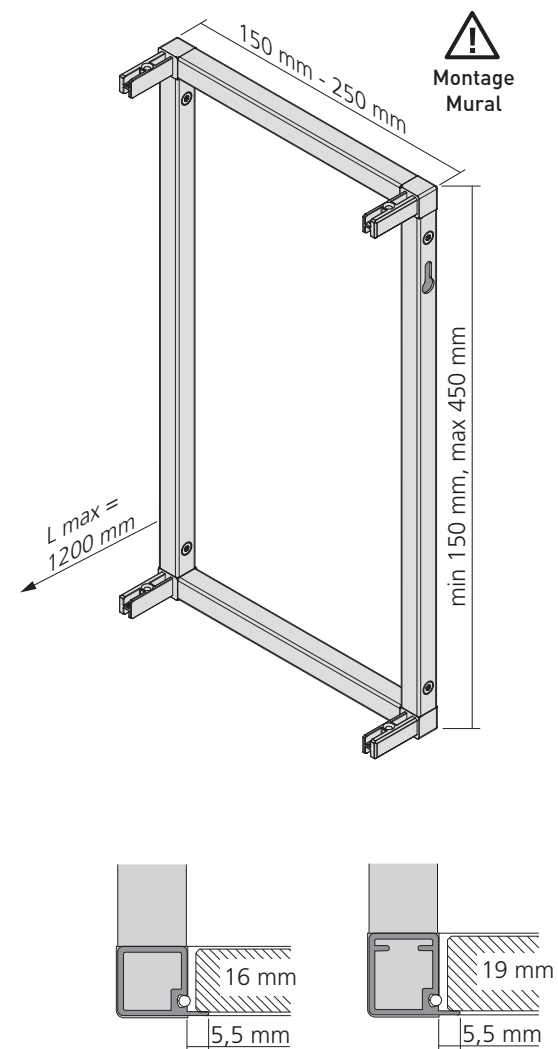
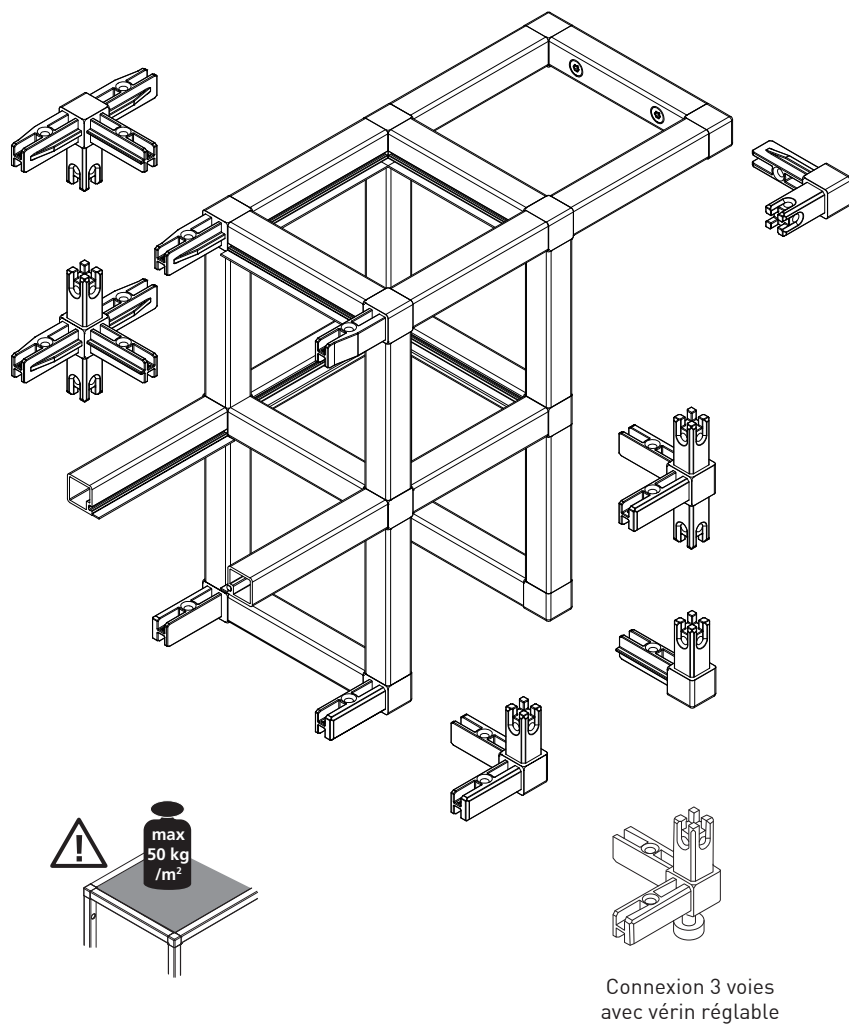

OPEN BOX

DIMENSIONS ET REMPLISSAGE

Dimensions des panneaux

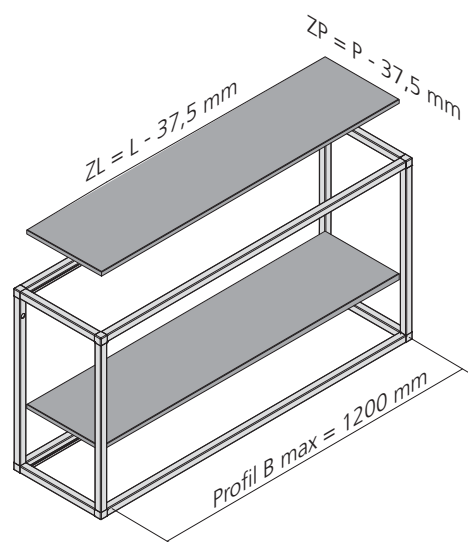
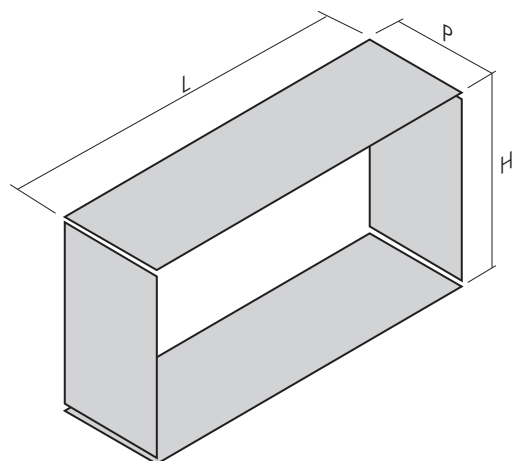

Type de profils

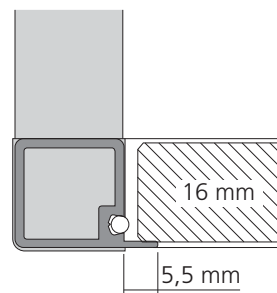

Profil type 16

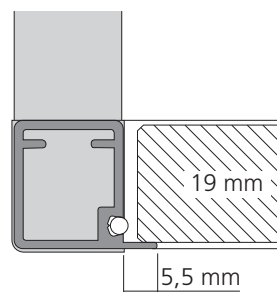

Profil type 19

Perçage mural

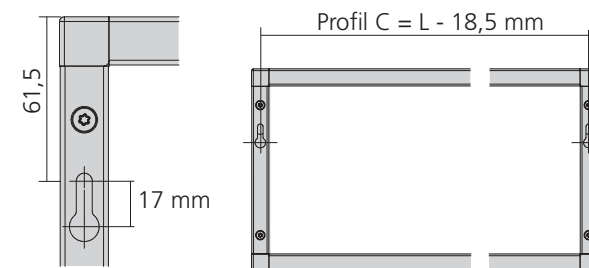

Mesurer pour les perçages intermédiaires

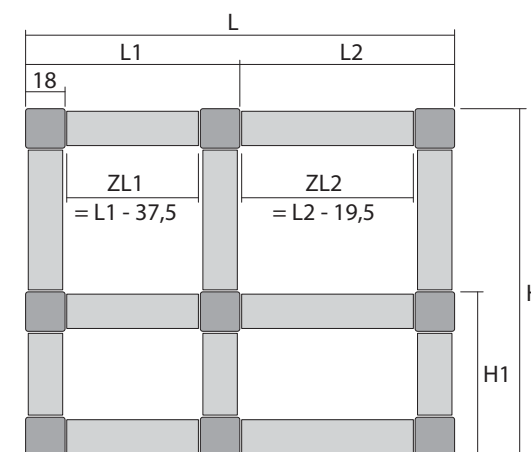

Identification des profils

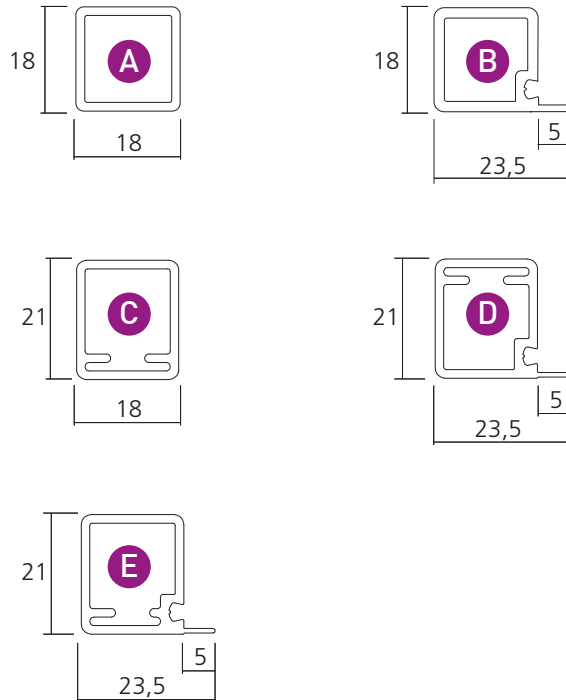

Montage

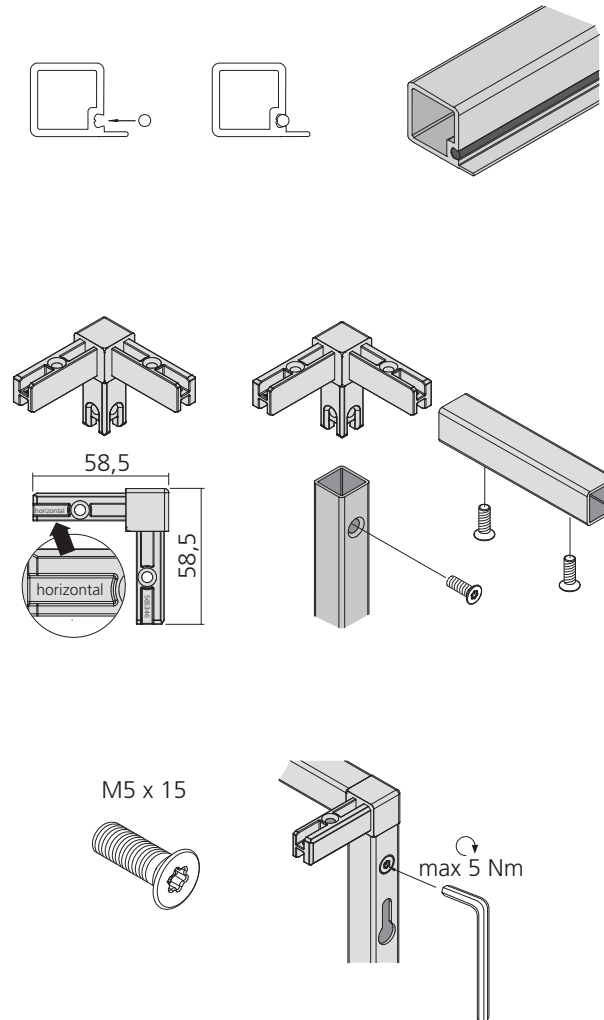

Montage mural

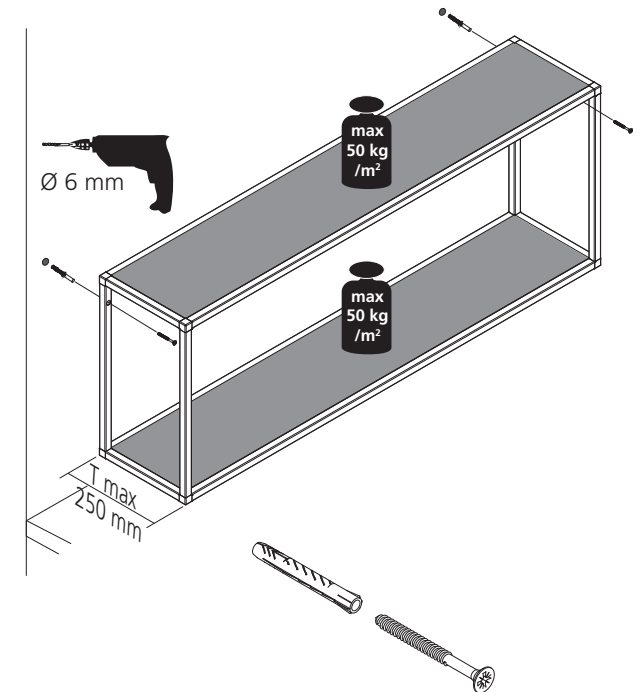

Important :
Les fixations murales ne conviennent que pour les murs en béton ou autre matériau résistant tel que la brique. L'installateur doit vérifier la solidité du matériau qui recevra l'équipement.

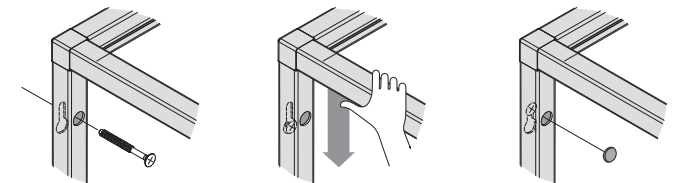

Open Box pour panneau de 19 mm : les connexions ne changent pas

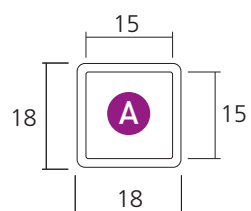

Profil pour cadre latéral vertical

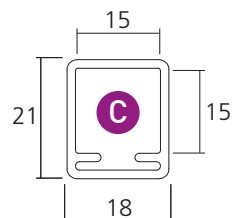

Profil pour cadre latéral horizontal

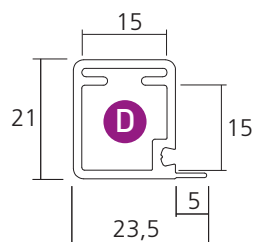

Profil pour traverse inférieure

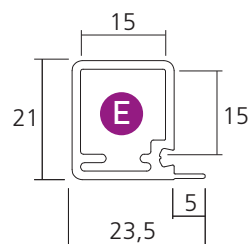

Profil pour traverse supérieure et intermédiaire

