

LAMP® GS-GH20 Glass Pivot Hinge,

Thank you for selecting our product. Before starting installation, please read this manual thoroughly to ensure correct installation. Please keep this manual at hand for future reference.

ABOUT THE PRODUCT

- Door can be mounted with assembled hinges.
- Horizontal door position is adjustable at mounted status.
- Vertical door position can be adjusted by adding a washer or a spacer.
- Hinges, brackets and locks with same design concept.

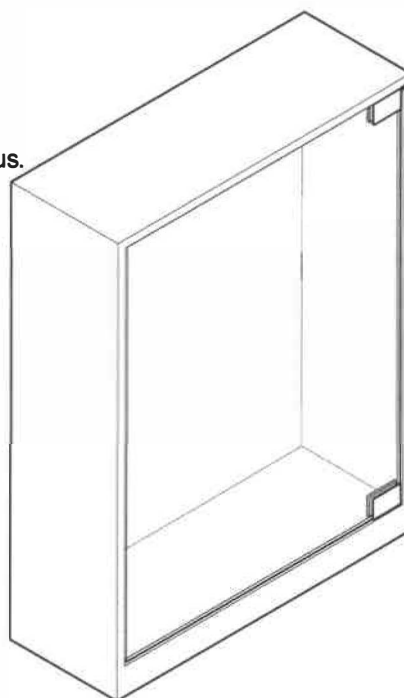

SPECIFICATIONS

Door size	W700 × H1600
Door weight	Max. 20 kg
Glass thickness	6、8 mm (Door)

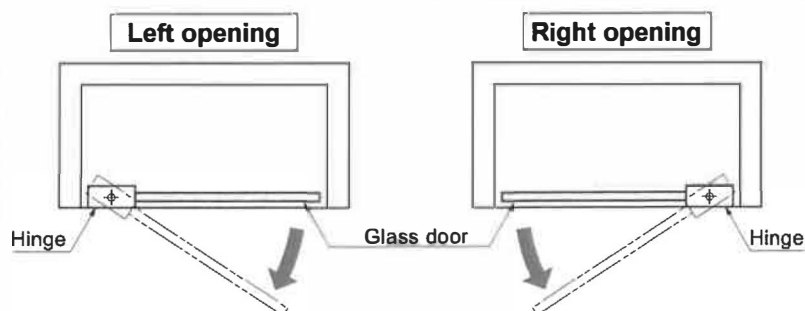

FOR YOUR SAFE WORK AND CORRECT INSTALLATION

Meaning of symbols



Warning
Caution



Prohibited



Required



Caution If these cautions are not followed, it may result in injury or damage.

- ❗ Apply door stoppers to protect the hinges and glass door when closing.
- ❗ Prepare a cabinet which endures the weight of the door.
- ❗ Use a tempered glass. It is recommended to use shatter-proof film on the glass. For areas where the glass brackets grip, make sure to remove the shatter-proof film before installing.

INSTALLATION DRAWING (EXAMPLE)

Right Opening Shown. A left opening door is the mirror opposite except with hinge A and B reversed on the left side.

[1] Wood Cabinet

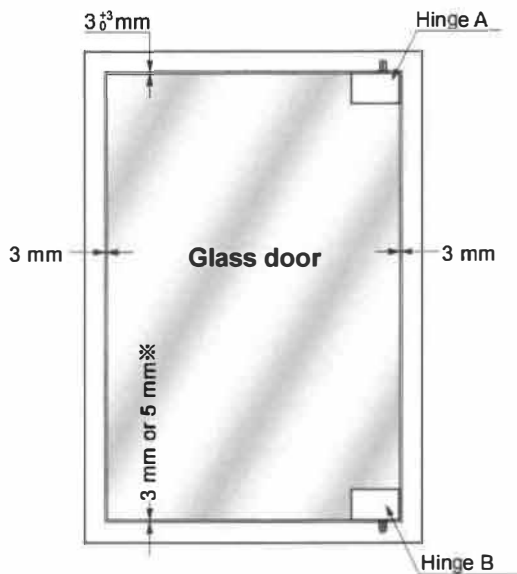

⚠ Apply door stopper to protect the glass door from damage.

※ Vertical door position can be adjusted by adding a washer or a spacer.

DOOR AND CABINET PROCESS DIMENSIONS

(Right opening Shown. The left opening is a mirror image.)

Wood top board and Wood bottom board

※ ¹ Use hardwood or reinforce this part with adhesive to prevent the insert nut from loosening.

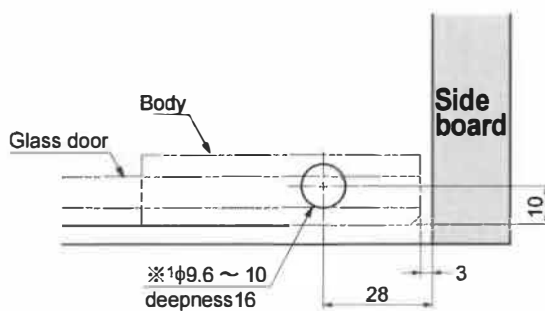

Glass door for wood top board

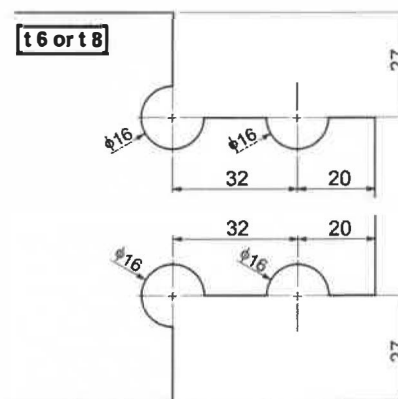

COMPONENT PARTS (PER BOX)

Hinge GS-GH20 Right opening shown. A left opening door is the mirror opposite except with hinge A and B reversed on the left side.

[1] Hinge A

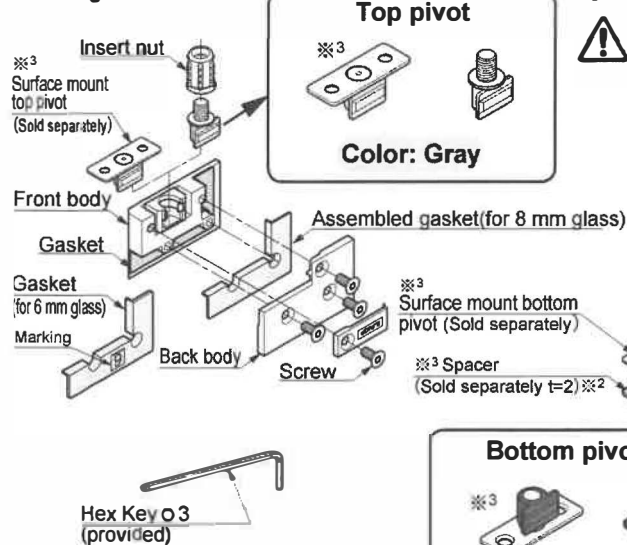

[2] Hinge B



※2 Door bottom gap can be increased by adding these parts.

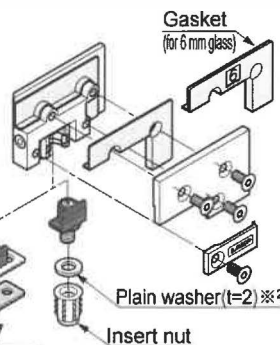

Do not disassemble this part.

INSTALLATION Hinge GS-GH20 (Right opening)

1 Installing pivot

Pivot with insert nut

Surface mount pivot

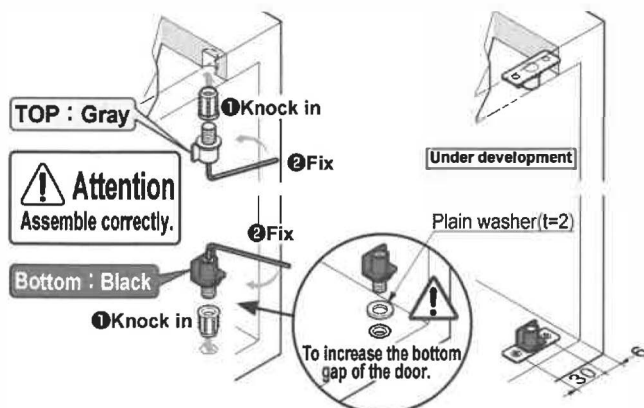

2 Assembling hinge parts

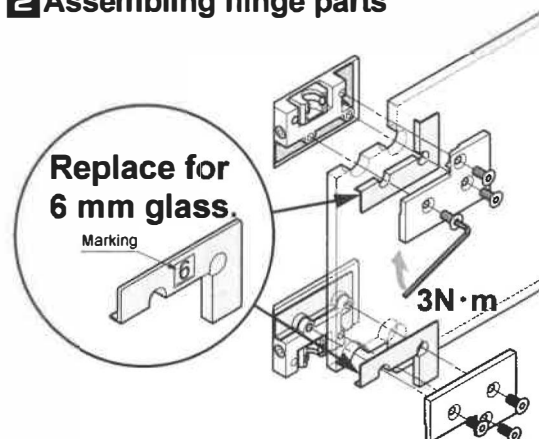

3 Door installation 1

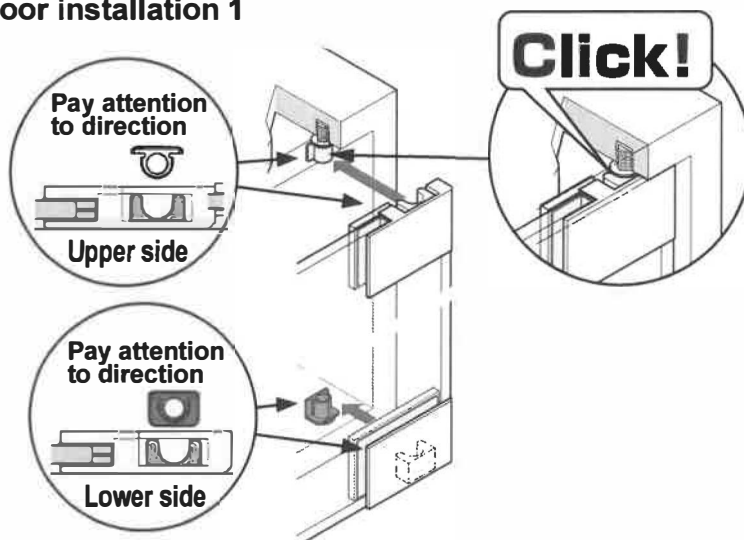

4 Door installation 2

Below figure shows opened status.

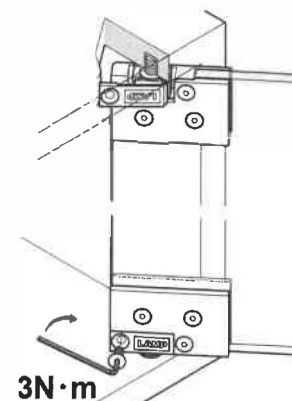

5 Door adjustment (± 3 mm)

CAUTION
Do not turn adjustment screw beyond adjustment range.

 **CAUTION**
Do not use motor screw driver.

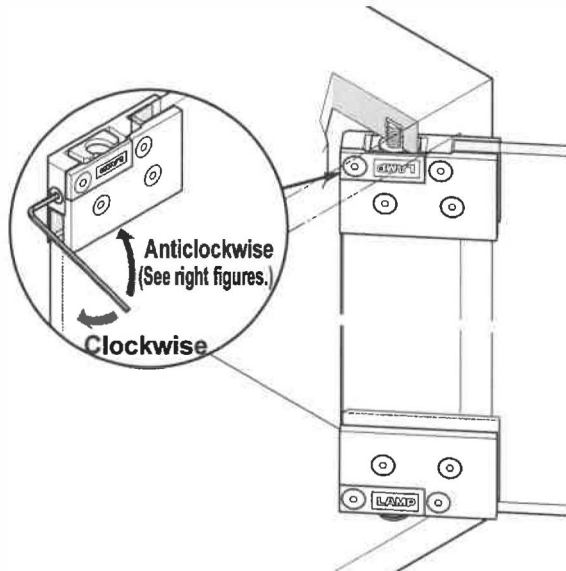

Clockwise

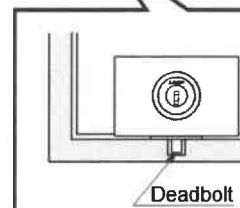
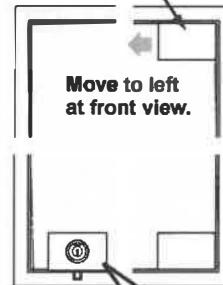
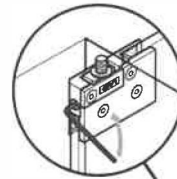

Anti-clockwise

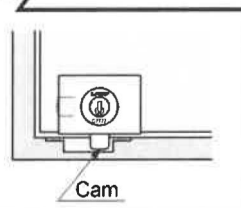
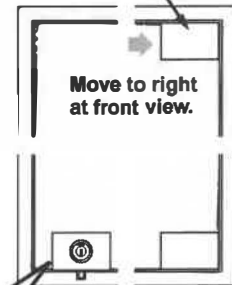
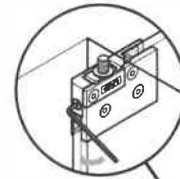

For doors with a cam lock,, check the movement of the deadbolt or cam when adjusting door position.