

INDEX

Introduction	1
Battery installation	1
Standard use- instructions	2-3
One time use- instructions	4-5
Change battery	5
Alarm function	6
Installation instructions	7-8
Trouble shooting	8
Dimensions	9

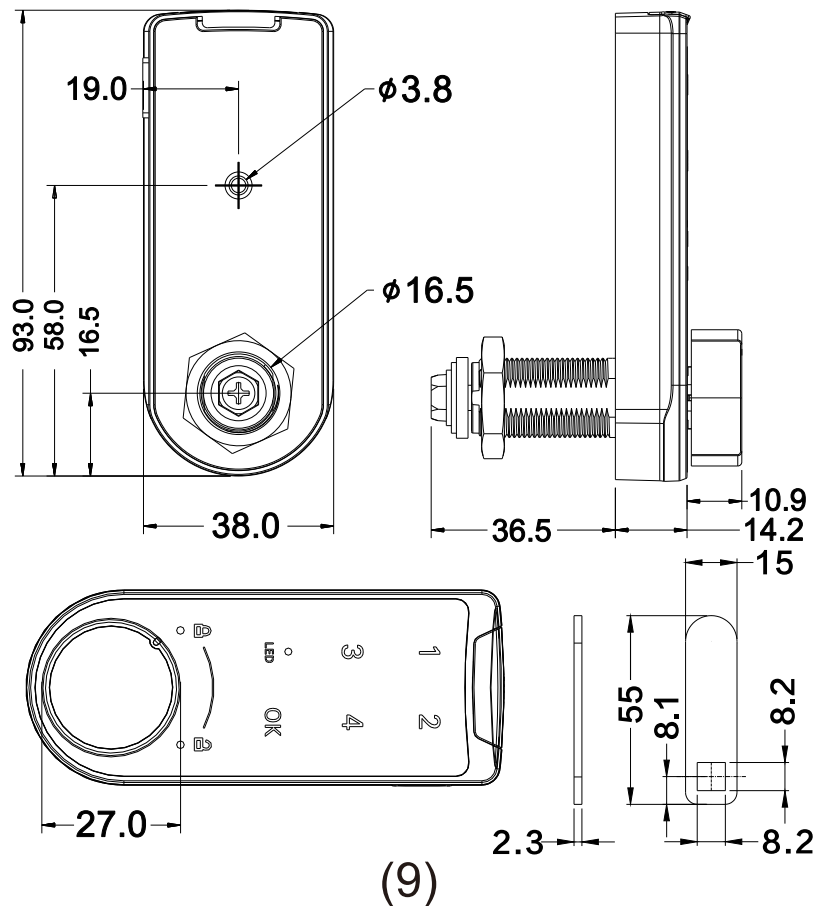

3. Install supplied CAM and screws

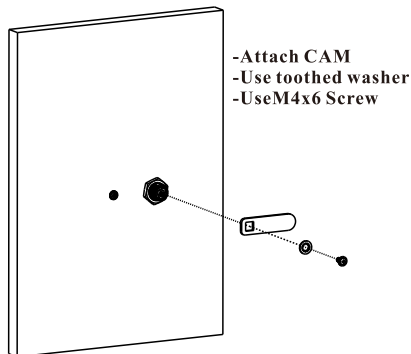

4. Install L-type strike plate using supplied screws

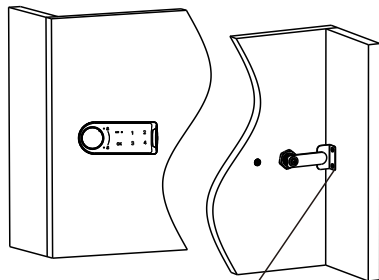

-Place L-Type strike plate in correct location
-Use 2 M3.5 x 10 self tapping screws

Trouble Shooting

ISSUE	CAUSE	FIX
Alarm continues to sound after code has been entered 4 times	Wrong code	Enter correct code
1. When pressing buttons -No alarm -No sound 2. Three beeps occur after correct code is entered 3. Lock cannot be open	Low power	Change battery

(8)

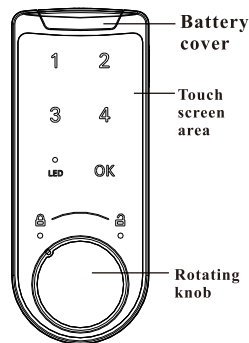

P152- Keyless locking system

Introduction

- 1-8 digit user code
- 87,380 possible codes
- User code is stored when battery power is lost or removed
- Short warning tone for low battery
- Tampering alarm

Application:

Wood and Metal materials from 0.6mm-22mm

Function:

- Standard use - Enter user code and it remains until reset.
- One time use - Enter user code to lock and unlock only once.

Battery Installation

1. Slide battery cover open and place battery in holder

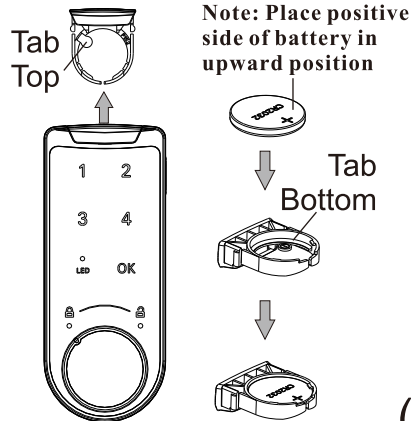

2. Confirm proper battery installation

- Press numbers on touch pad
- Listen for "BEEP" tone
- Look for LED indicator light

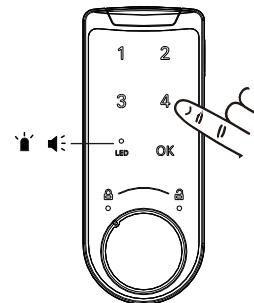

(1)

Instructions-Standard Use

Factory default code is 123123

1) Unlock

1.Key in 123123 then "OK"
listen for long "BEEP"

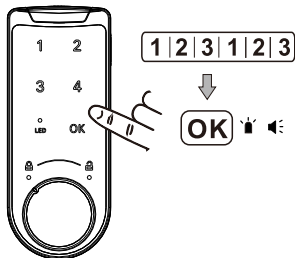

2.Turn knob clockwise to "🔓" position. Lock is now unlocked.

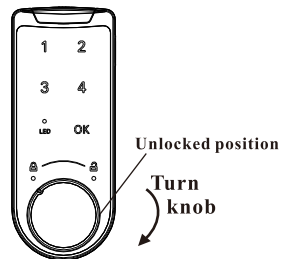

2) Lock

1.Turn knob counter clockwise to "🔒" locked position

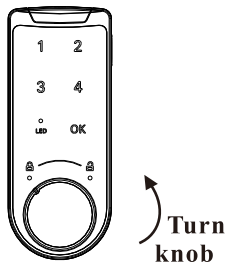

2.Knob is now in a fixed locked position

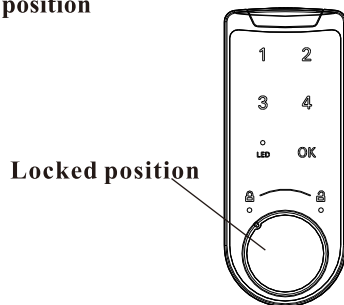

(2)

Installation Instructions

Horizontal-set up

1.Drill holes

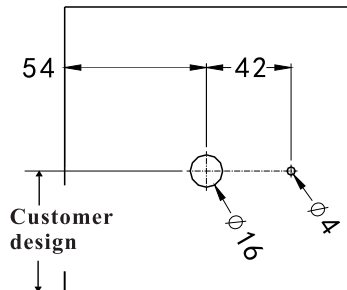

2.Install lock with supplied hardware

- M3.5 flanged screw
- 1 Large nut

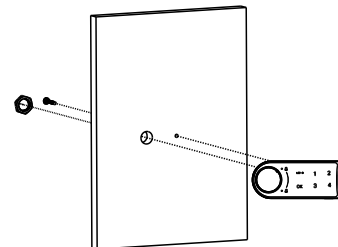

Vertical-set up

1.Drill holes

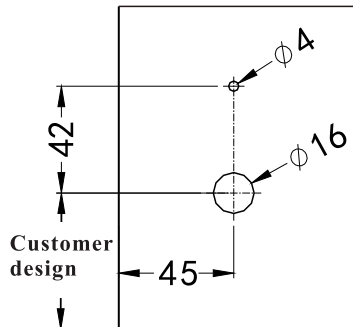

2.Install lock with supplied hardware

- M3.5 flanged screw
- 1 Large nut

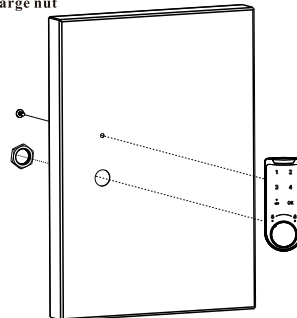

(7)

Alarm Function

1. Continuous alarm sounds for 60 seconds when code is incorrectly entered 4 times.

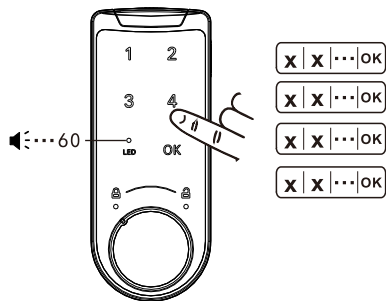

2. Enter correct code to silence the alarm.

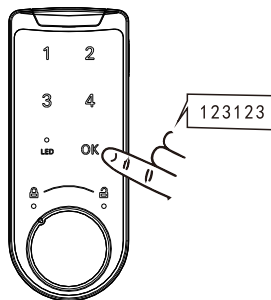

Note:

- The digital lock uses one button battery (model: Cr2032). When the battery is full, it can be used for one year.
- Three consecutive "BEEP, BEEP, BEEP" tones will indicate low battery life when correct code is entered.
- 200 operating cycles remain when "BEEP, BEEP, BEEP" tone begins.
- Replace battery to ensure proper operation of lock and before the lock becomes inoperable.
- The standard battery is the commissioning battery, this battery will have different performance in supplying power due to storage and transportation. Therefore, it is only used for the first time to test the product. If low battery, please replace it as soon as possible.

(6)

Code Setting (Can be set 1-8 digits long)

Example:

Change factory default code "123123" into new code "12341234"

1. Enter code 1-2-3-1-2-3
Press OK + OK (OK x 2)
Enter new code 1-2-3-4-1-2-3-4
Press OK (OK x 1),
Listen for longer "BEEP" tone

2. Code is now reset

1|2|3|4|1|2|3|4 = ✓

- 12341234
- Remember
 - Securely store new code

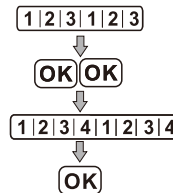
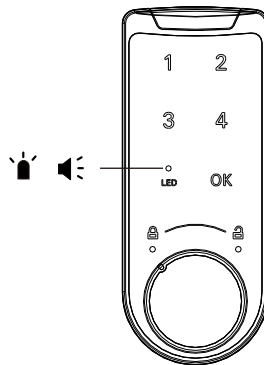

(3)

Instructions-One Time Use

Factory default code is 123123

1) Unlock

1.Key in 123123 listen for long "BEEP"

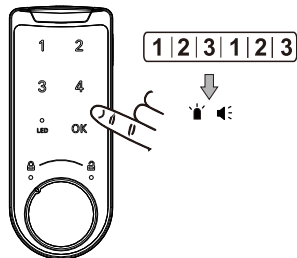

2.Turn knob clockwise to "🔒" position. Lock is now unlocked.

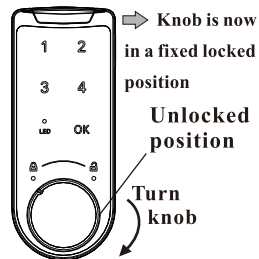

2) Lock - Set new code -CODE SETTING MUST BE 6 DIGITS LONG

1.Key in new code 321321

Listen for long "BEEP"

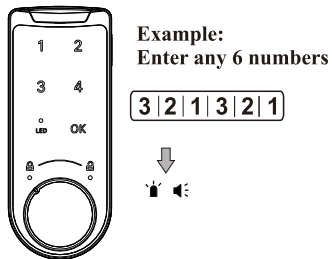

2.Turn knob counter clockwise to "🔒" locked position.

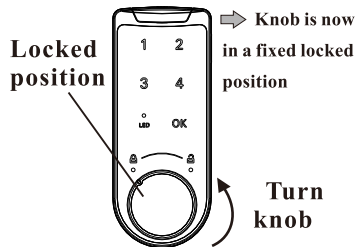

(4)

3) Unlock

1.Key in 321321 listen for long "BEEP"

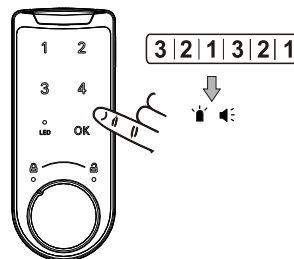

2.Turn knob clockwise to "🔒" position. Lock is now unlocked.

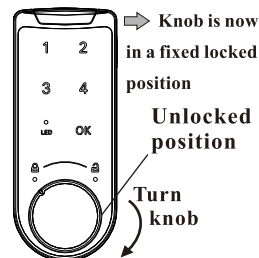

NOTE: Code is good for one use only. Repeat process for new code

Change Battery

1.Battery change required when "BEEP, BEEP, BEEP" sounds three times after unlocking

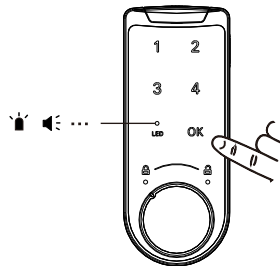

2.Follow below steps to change the battery

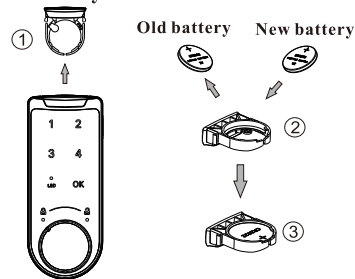

(5)