



# Cabineo

Pat. pend.



Cabineo 8



Cabineo 12



Cabineo 8 M6

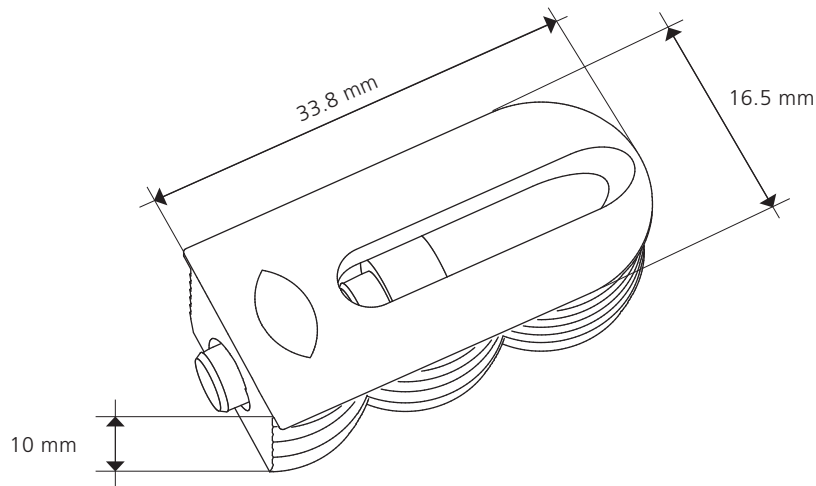

Cabineo 8 black



Cabineo 12 black



Cabineo 8 M6 black

## Bearbeitung mit allen CNC-Maschinen / Machining with all CNC machines:

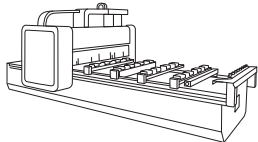

CNC-Bearbeitungszentren mit **Konsolen**

*CNC processing centres with **consoles***

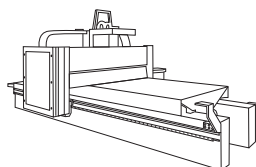

CNC-Bearbeitungszentren mit **Nesting-Technologie**

*CNC processing centres with **nesting technology***

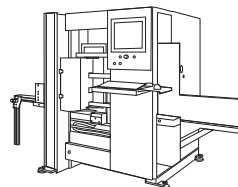

**Vertikale**  
CNC-Bearbeitungszentren

***Vertical** CNC  
processing centres*

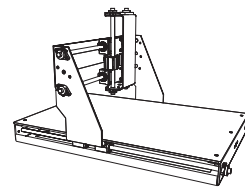

CNC **Oberfräse**

*CNC **router***

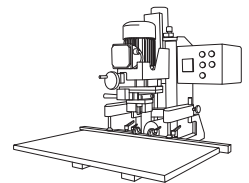

**Bohr- und Beschlag-**  
**setzmaschinen**

***Drilling and insertion  
machines***

## Montage / Assembly:

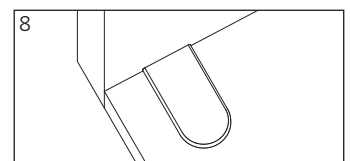
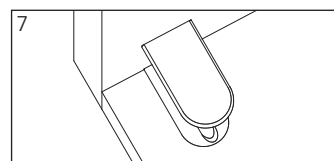
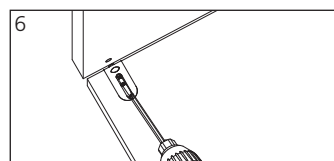
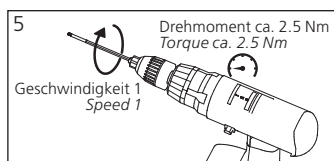
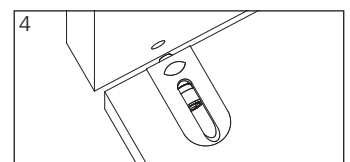
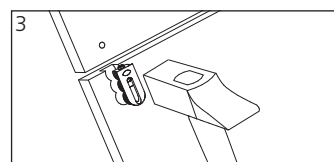
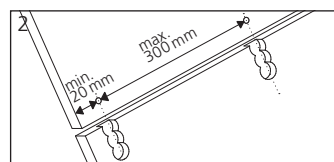
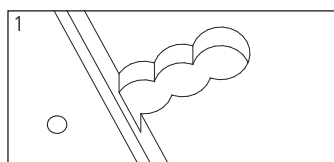

## Anwendungen / Applications:

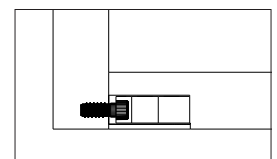
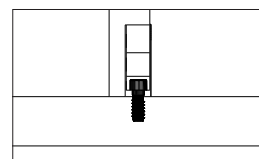
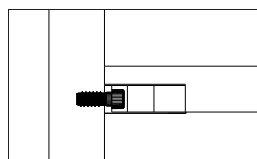
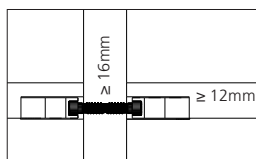
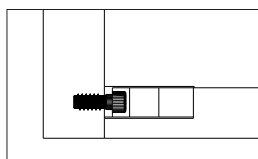

### Keine Holzdübel notwendig! / No dowel necessary!

keine Kantenbearbeitung / weniger Bohrungen / weniger Werkzeugwechsel / keine Dübelmontage  
*no edge drilling / less drill holes / less tool change / no pre-assembly of dowel*



Einbauvarianten / Installation options		Bund aufliegend / On the surface		Bund flächenbündig / Flush with the surface		Abdeckkappen flächenbündig / Flush cover cap		HPL Bund aufliegend / HPL on the surface	
Bearbeitungsvarianten / Machining options		<p><b>Cabineo 8: X = 8 mm</b>, schwarze Schraube / <i>black screw</i> <b>Cabineo 12: X = 12 mm</b>, vernickelte Schraube / <i>nickel-plated screw</i> <b>Cabineo 8 M6: X = 8 mm</b> Gelb verzinkte Schraube / <i>Yellow galvanised screw</i></p>		<p><b>Cabineo 8: X = 8 mm</b>, schwarze Schraube / <i>black screw</i> <b>Cabineo 12: X = 12 mm</b>, vernickelte Schraube / <i>nickel-plated screw</i> <b>Cabineo 8 M6: X = 8 mm</b> Gelb verzinkte Schraube / <i>Yellow galvanised screw</i></p>		<p><b>Cabineo 8: X = 8 mm</b>, schwarze Schraube / <i>black screw</i> <b>Cabineo 12: X = 12 mm</b>, vernickelte Schraube / <i>nickel-plated screw</i> <b>Cabineo 8 M6: X = 8 mm</b> Gelb verzinkte Schraube / <i>Yellow galvanised screw</i></p>		<p><b>Cabineo 8 M6: X = 8 mm</b> Gelb verzinkte Schraube / <i>Yellow galvanised screw</i></p>	
Variante / Option 1: Bohrer Ø 15 mm Drill Ø 15 mm						<p>Zentrum Abdeckkappe Center cover cap</p>			
Variante / Option 2: Fräser Ø 10 mm oder kleiner Cutter Ø 10 mm or smaller									
Variante / Option 3: Fräser Ø 12 mm Cutter Ø 12 mm						<p>Zentrum Abdeckkappe Center cover cap</p>			

## Technische Informationen / *Technical information:*

Technische Daten	
Grösse	33.8 × 16.5 × 10.8 mm
Fräser	Ø 12 mm oder kleiner
Bohrer	Ø 5 mm und Ø 15 mm
Material Gehäuse	Glasfaserverstärkter Kunststoff
Einbautoleranz	Längs ± 0.1 mm

Technical data	
Size	33.8 × 16.5 × 10.8 mm
Cutter	Ø 12 mm or smaller
Drill	Ø 5 mm and Ø 15 mm
Material housing	Fibre-glass reinforced plastic
Installation tolerace	Longitudinal ± 0.1 mm

Festigkeit pro Verbinder ohne Dübel / <i>Technical values without dowel (N)</i>			
in Spanplatte / <i>in particule board</i> 19 mm	Cabineo 12	Cabineo 8	Cabineo 8 M6 HPL
Zugfestigkeit / <i>Tensile strength</i> (F1)	900	500	1700
Scherfestigkeit / <i>Shear strength</i> (F2)	850	550	1000
Scherfestigkeit / <i>Shear strength</i> (F3) [Var.3]	400 [-13%]	400 [-13%]	500
Spannkraft / <i>Clamping force</i> (F4)	900	500	1700

Zugfestigkeit / <i>Tensile strength</i> (N)	
Div. Material / <i>Various materials</i> 12 mm	Cabineo 8
HPL	900
Multiplex	900
CDF	600
MDF	400

10 N ~ 1kg

10 N ~ 1kg

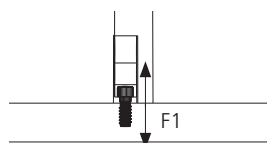

Zugfestigkeit / *Tensile strength*

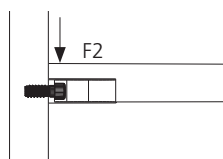

Scherfestigkeit / *Shear strength*

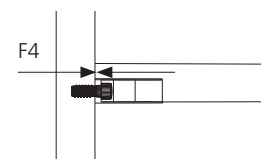
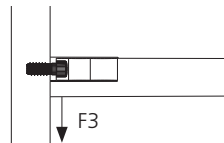

Spannkraft / *Clamping force*

## Artikel / *Articles:*

	Art.Nr.
Cabineo Starterset, Cabineo 8 + 12 (je 40 Stück), inkl. Cabineo Sechskant-Bit und Abdeckkappen (40 Stück) .	<b>186305</b>
Cabineo 8, für Mittelwände, 500 Stück .....	<b>186310</b>
Cabineo 8, für Mittelwände, 2000 Stück .....	<b>186311</b>
Cabineo 12, 500 Stück.....	<b>186320</b>
Cabineo 12, 2000 Stück.....	<b>186321</b>
Cabineo 8 black, für Mittelwände, 500 Stück .....	<b>186340</b>
Cabineo 8 black, für Mittelwände, 2000 Stück .....	<b>186341</b>
Cabineo 12 black, 500 Stück.....	<b>186330</b>
Cabineo 12 black, 2000 Stück.....	<b>186331</b>
Cabineo 8 M6 Starterset mit 80 Stk. Cabineo 8 M6 je 40 Stk. Muffen und Abdeckkappen, 1 Stk Bit.....	<b>186306</b>
Cabineo 8 M6, 500 Stück.....	<b>186315</b>
Cabineo 8 M6, 2000 Stück.....	<b>186316</b>
Cabineo 8 M6 black, 500 Stück.....	<b>186345</b>
Cabineo 8 M6 black, 2000 Stück.....	<b>186346</b>

	Part no.
Cabineo Starter Set, Cabineo 8 + 12, 40 pcs. each, Cabineo hex bit, set of cover caps .....	<b>186305</b>
Cabineo 8, for dividing panels, 500 pcs. ....	<b>186310</b>
Cabineo 8, for dividing panels, 2000 pcs. ....	<b>186311</b>
Cabineo 12, 500 pcs. ....	<b>186320</b>
Cabineo 12, 2000 pcs. ....	<b>186321</b>
Cabineo 8 black, for dividing panels, 500 pcs.....	<b>186340</b>
Cabineo 8 black, for dividing panels, 2000 pcs. ....	<b>186341</b>
Cabineo 12 black, 500 pcs. ....	<b>186330</b>
Cabineo 12 black, 2000 pcs. ....	<b>186331</b>
Cabineo 8 M6 Starterset, Cabineo 8 M6 80 pcs. insert nut and set of cover caps each 40 Stk., 1 hex bit.....	<b>186306</b>
Cabineo 8 M6, 500 pcs .....	<b>186315</b>
Cabineo 8 M6, 2000 pcs .....	<b>186316</b>
Cabineo 8 M6 black, 500 pcs .....	<b>186345</b>
Cabineo 8 M6 black, 2000 pcs .....	<b>186346</b>

## Zubehör / *Accessories:*

Werkzeug	Art.Nr.
Cabineo Werkzeug mit Griff.....	<b>256300</b>
Cabineo Sechskant-Bit .....	<b>276312</b>
Cabineo Sechskant-Bit 1/4" GL 80 mm .....	<b>276306</b>
Cabineo Sechskant-Bit 1/4" GL 80 mm, 100 Stk.....	<b>276307</b>
Cabineo Bohrer Ø 15 mm mit Zentrierspitze 0.8 mm	<b>136312</b>
Cabineo Fräser Ø 10 mm	<b>136310</b>
Cabineo Fräser Ø 12 mm.....	<b>136311</b>
Cabineo Aggregat-Bohrer Set 3 Stk. Ø15mm (RL/LL/RL) HW	<b>136313</b>
Cabineo Muffe M6x12.3, 100 Stk., Mat. 14-16mm	<b>186370</b>
Cabineo Muffe M6x12.3, 500 Stk., Mat. 14-16mm .....	<b>186371</b>
Cabineo Muffe M6x15.3, 100 Stk., Mat. 17-25mm .....	<b>186375</b>
Cabineo Muffe M6x15.3, 500 Stk., Mat. 17-25mm	<b>186376</b>
Cabineo Einschlaghilfe für Muffe	<b>276310</b>

Tool	Part no.
Cabineo tool with handle .....	<b>256300</b>
Cabineo hex bit.....	<b>276312</b>
Cabineo hex bit 1/4" GL 80 mm.....	<b>276306</b>
Cabineo hex bit 1/4" GL 80 mm, 100 pieces.....	<b>276307</b>
Cabineo drill Ø 15 mm with short centering point 0.8 mm	<b>136312</b>
Cabineo cutter Ø 10 mm.....	<b>136310</b>
Cabineo cutter Ø 12 mm.....	<b>136311</b>
Cabineo drills for aggregate, set with 3pcs Ø15 mm (RL/LL/RL) carbide tippec	<b>136313</b>
Cabineo Muffe M6x12.3, 100 Stk., Mat. 14-16mm .....	<b>186370</b>
Cabineo Muffe M6x12.3, 500 Stk., Mat. 14-16mm .....	<b>186371</b>
Cabineo Muffe M6x15.3, 100 Stk., Mat. 17-25mm .....	<b>186375</b>
Cabineo Muffe M6x15.3, 500 Stk., Mat. 17-25mm .....	<b>186376</b>
Cabineo tapping aid for insert nut	<b>276310</b>