

ART. CLICK TOP WITH TABLE

MONTAGGIO - MOUNTING

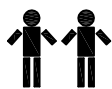

Assicuratevi di aver fissato il vostro mobile alla parete contro il ribaltamento, poichè le pareti sono di materiali diversi il fissaggio alla parete non è incluso

Make sure to fix your cabinet to the wall.

As wall materials vary, plates and screws for fixing to wall are not included.

1

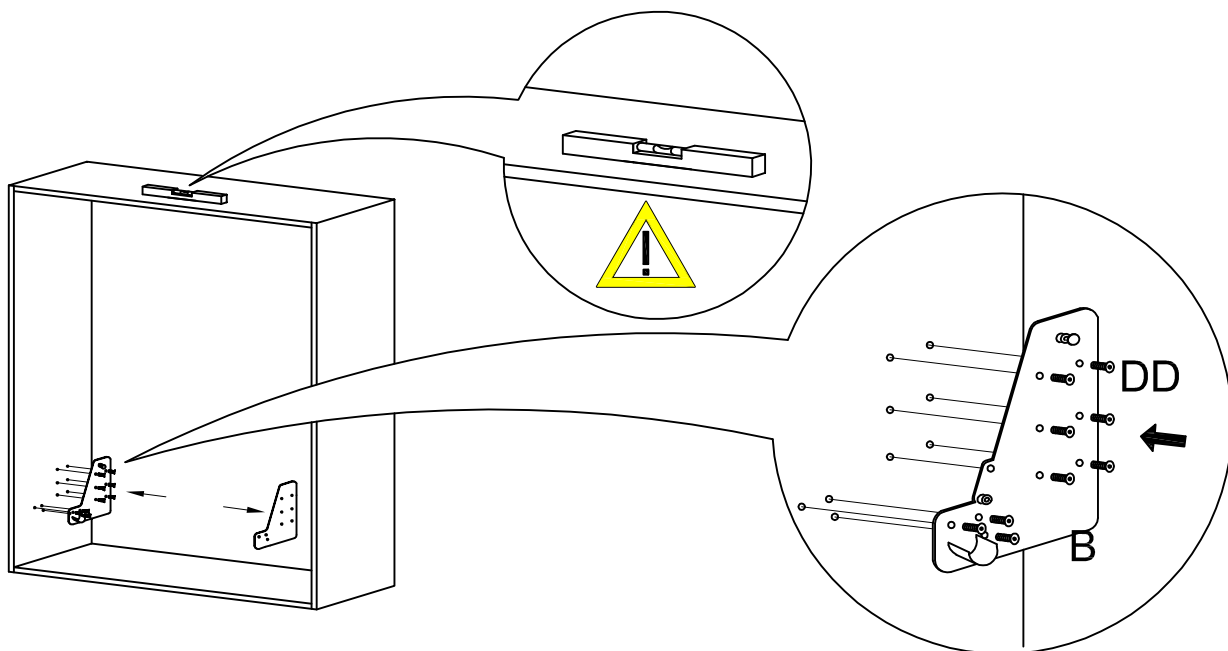

2

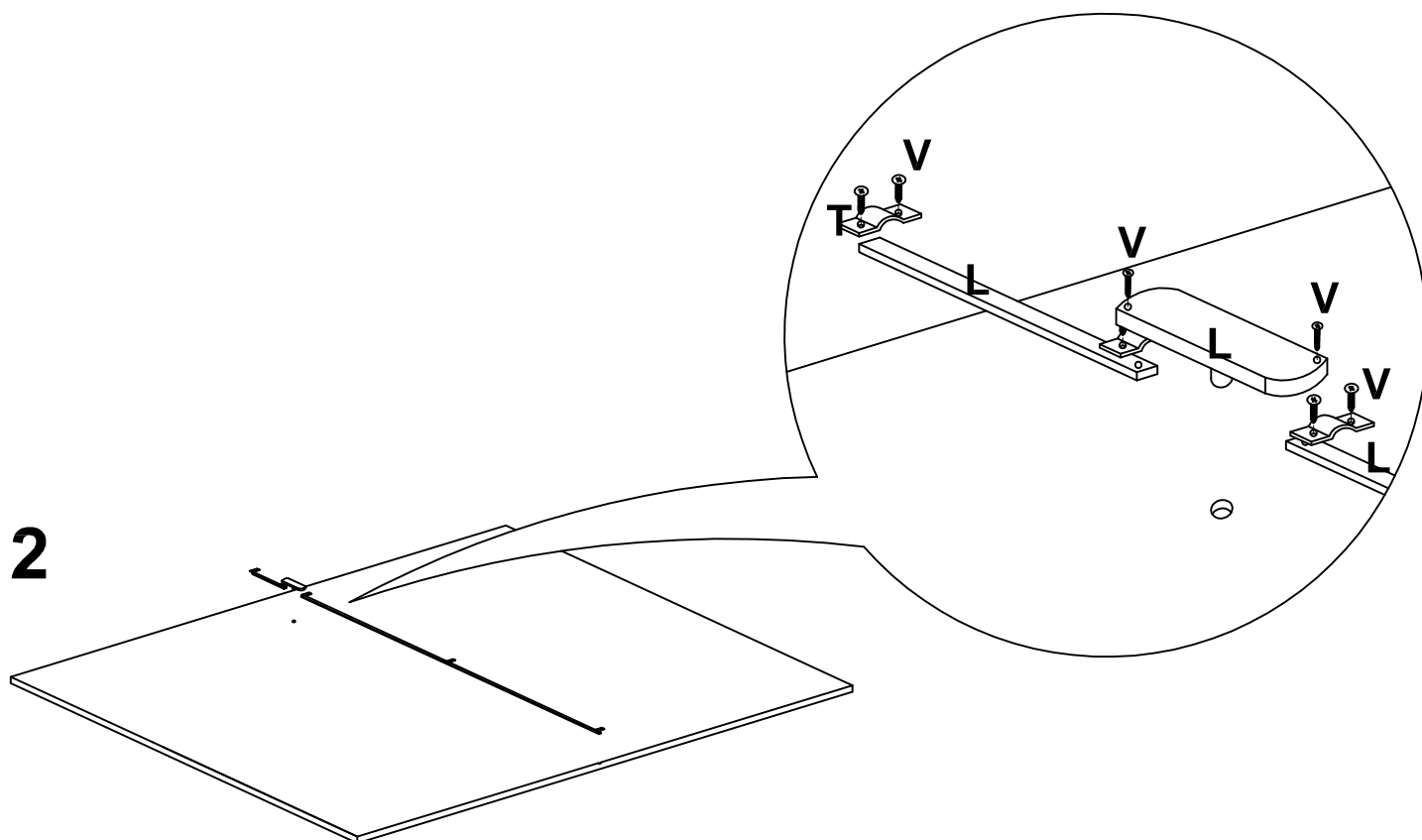

3

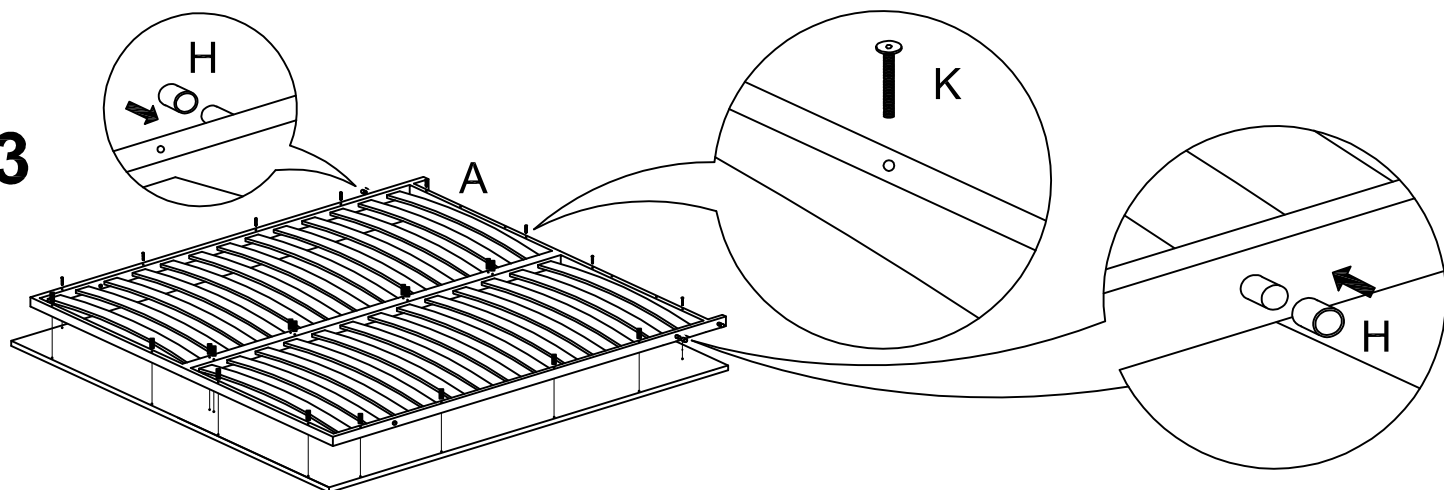

4

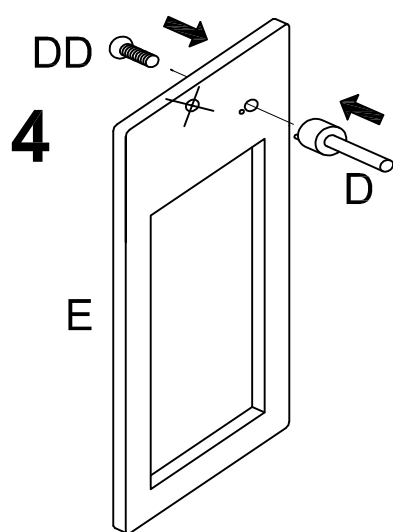

5

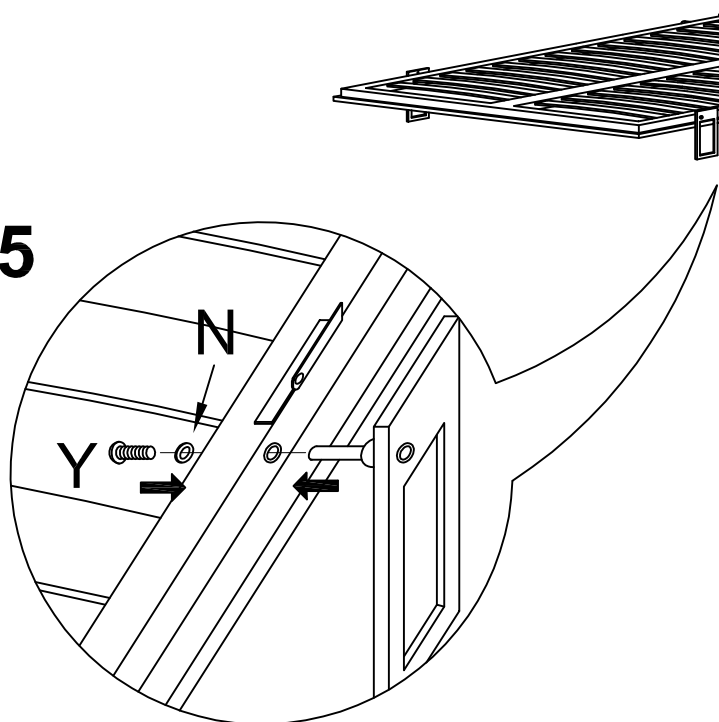

6

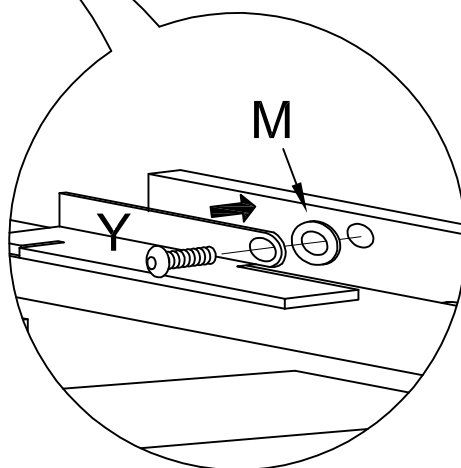

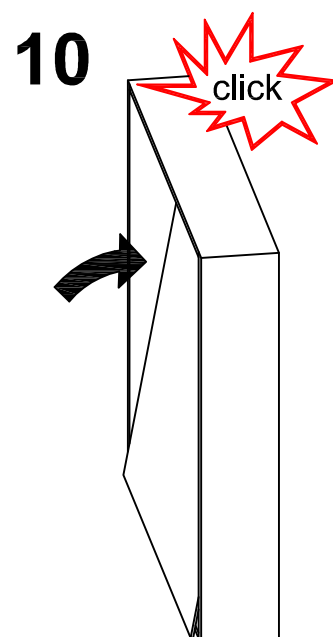
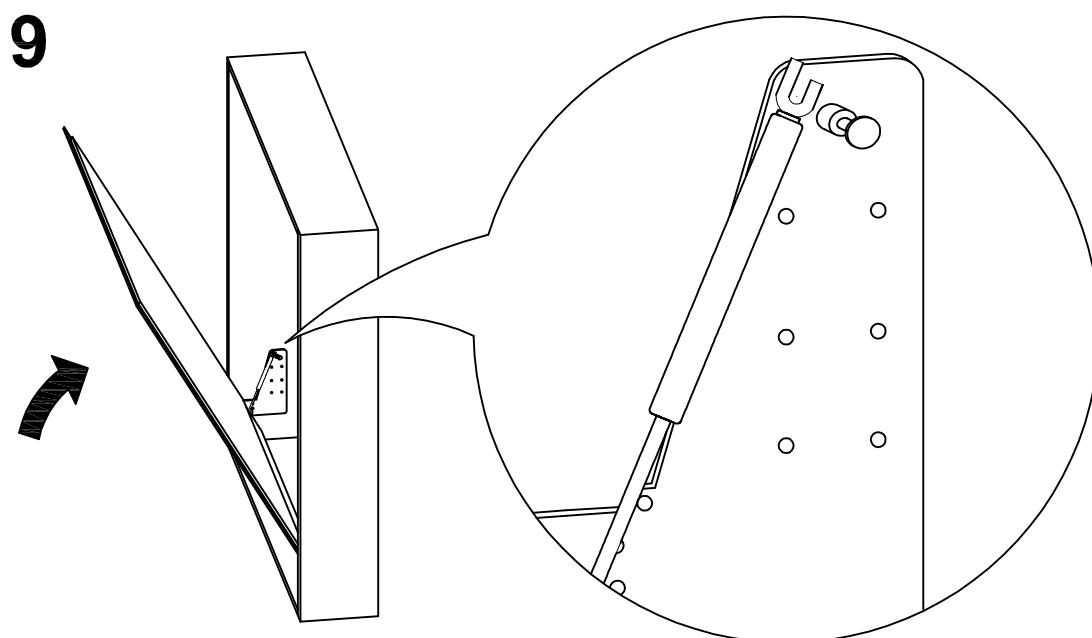
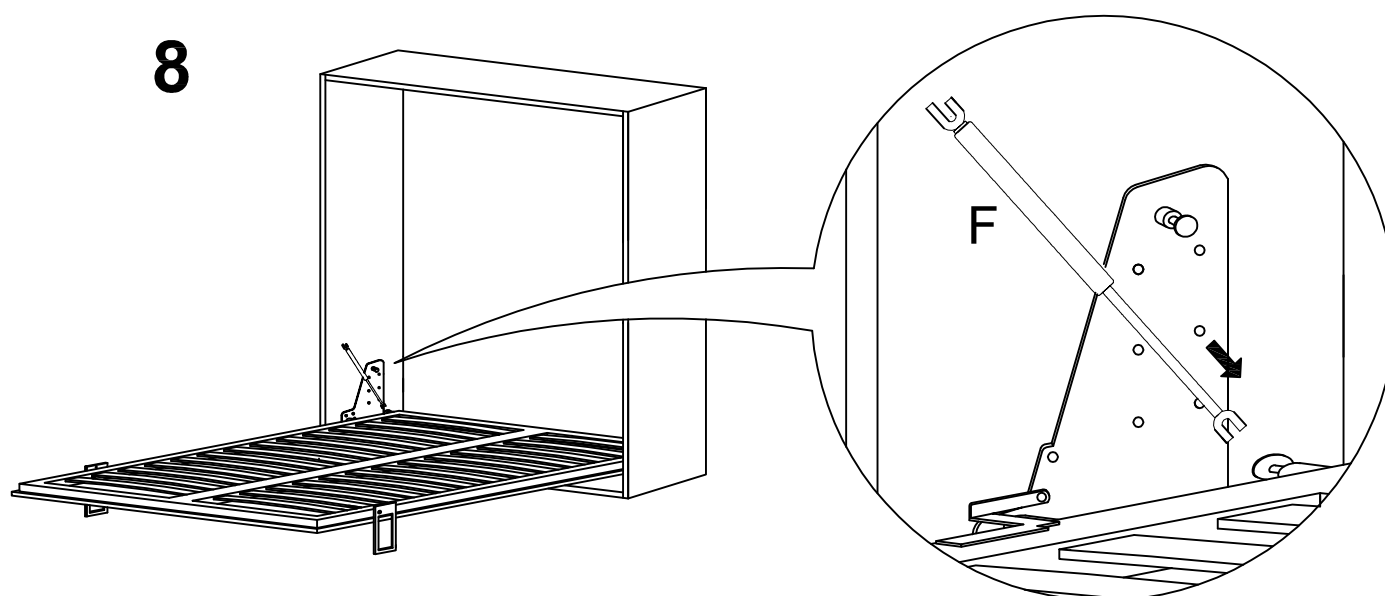
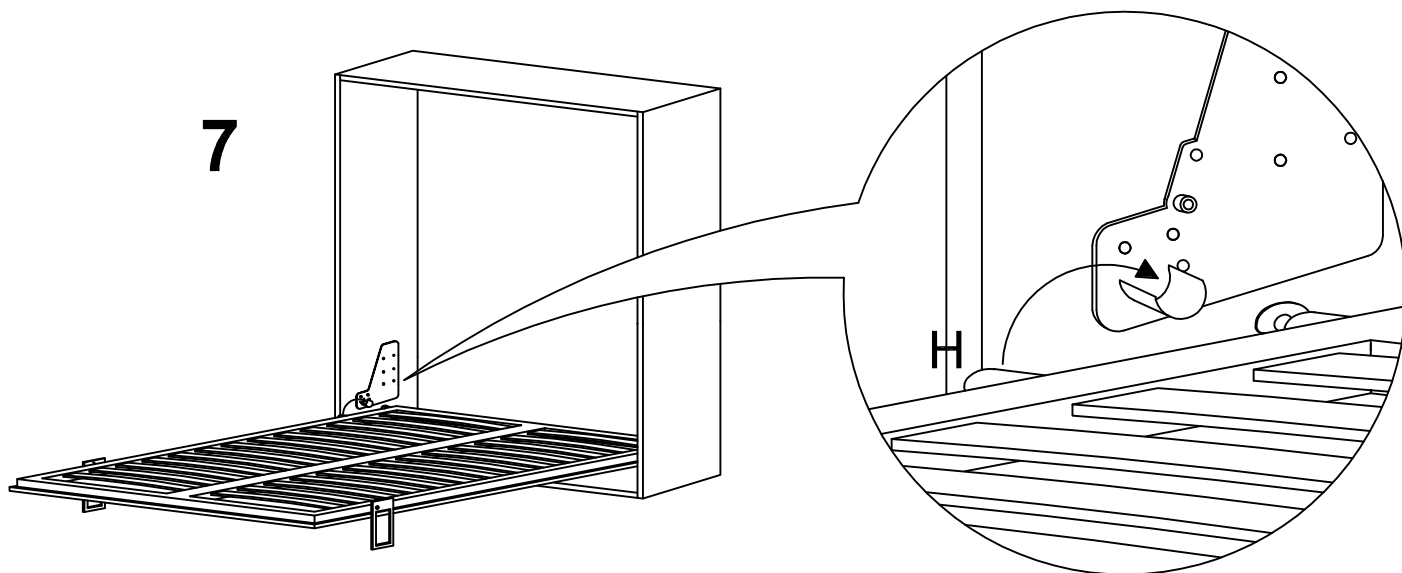

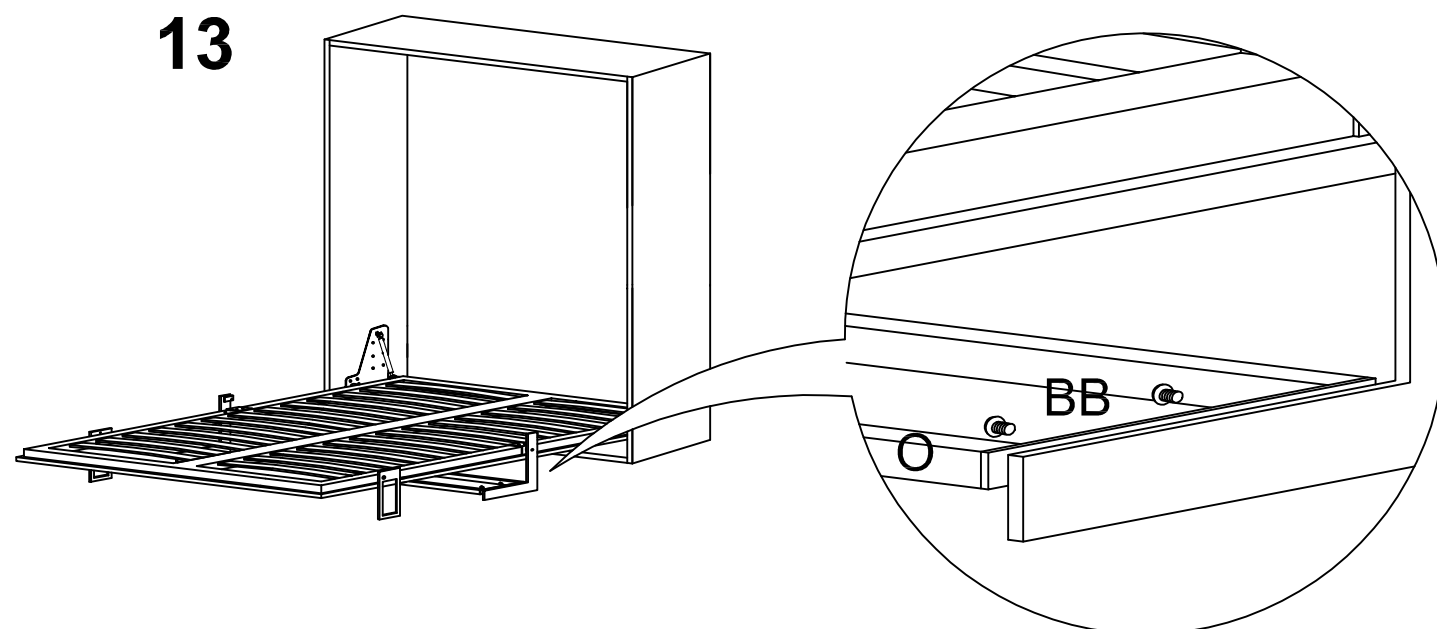
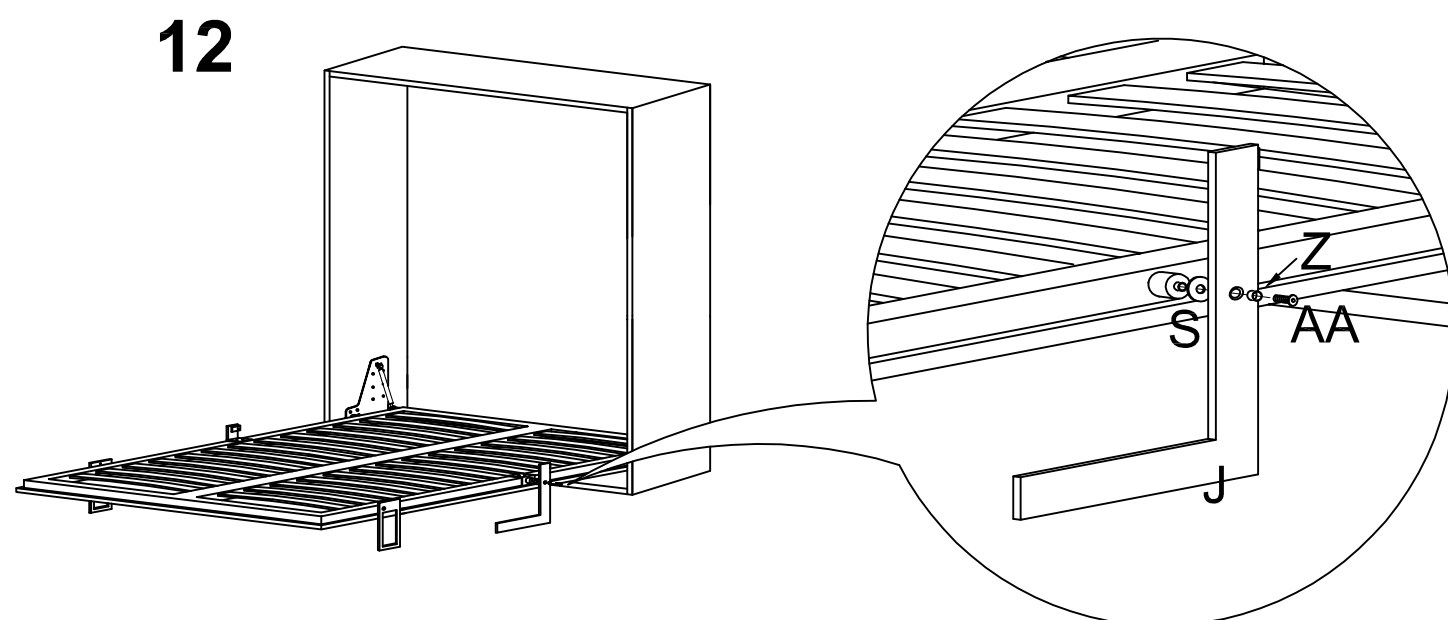
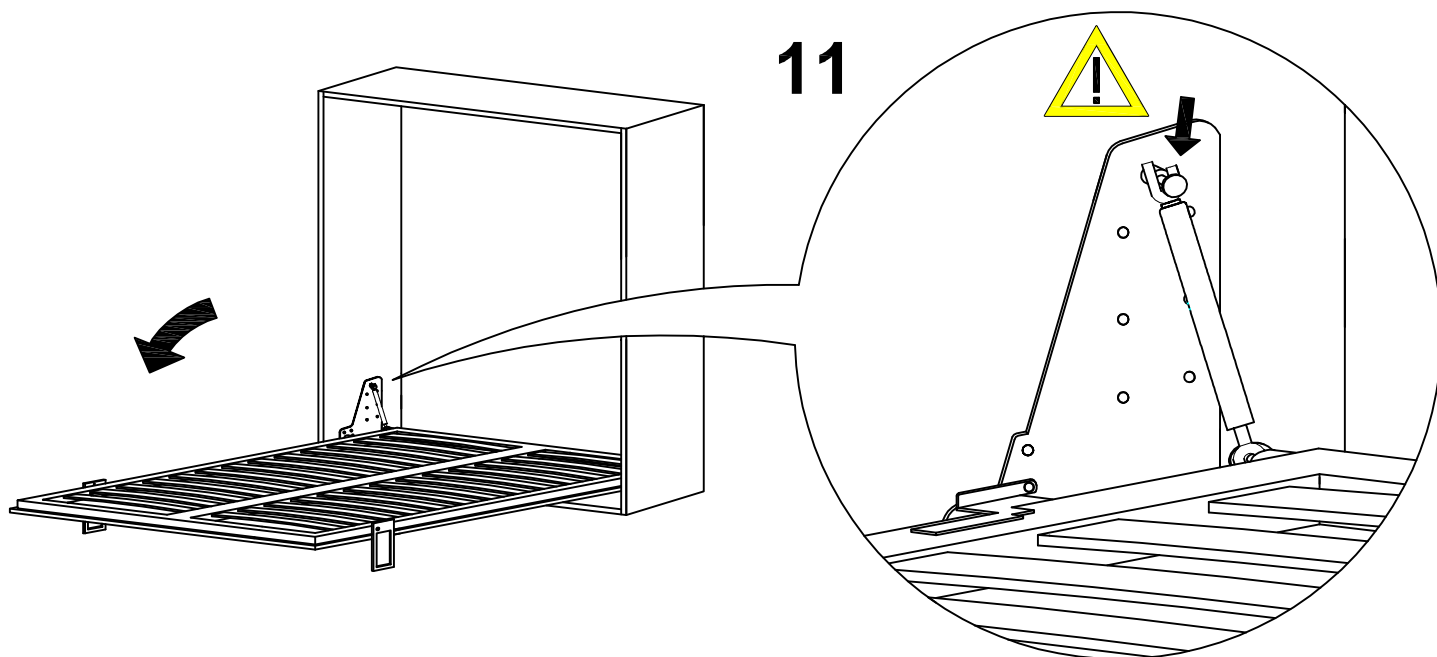

14

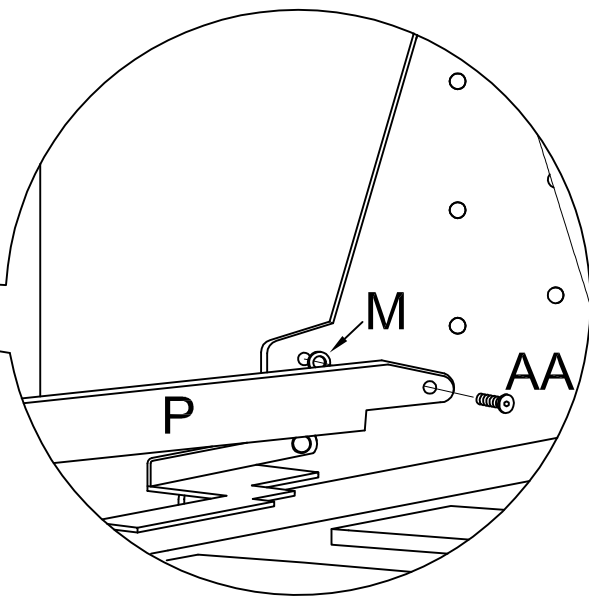
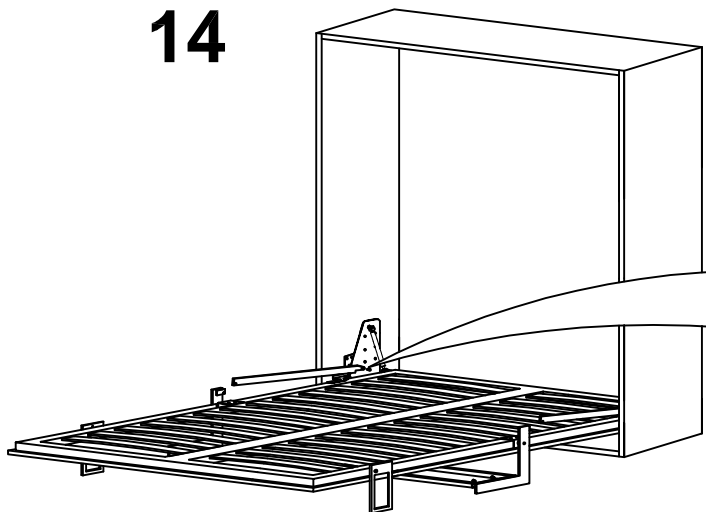

15

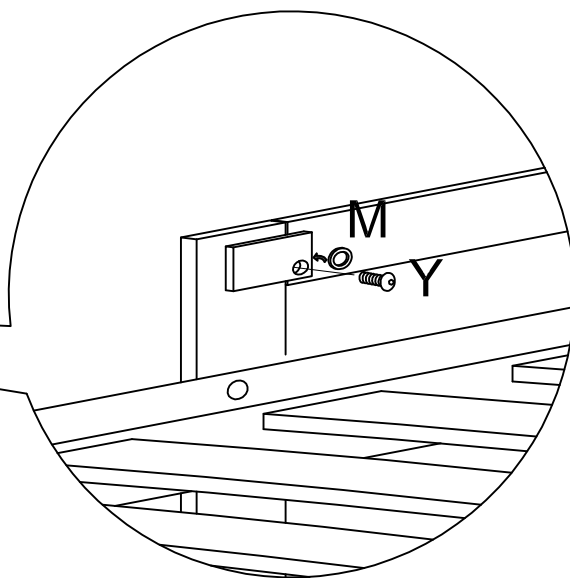
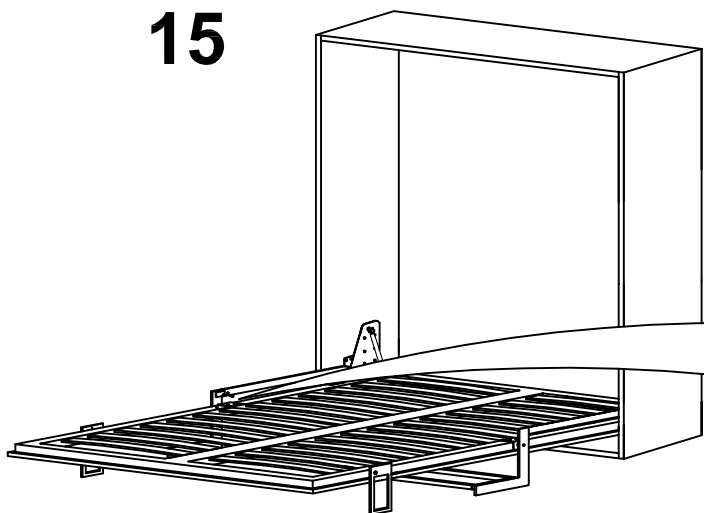

16

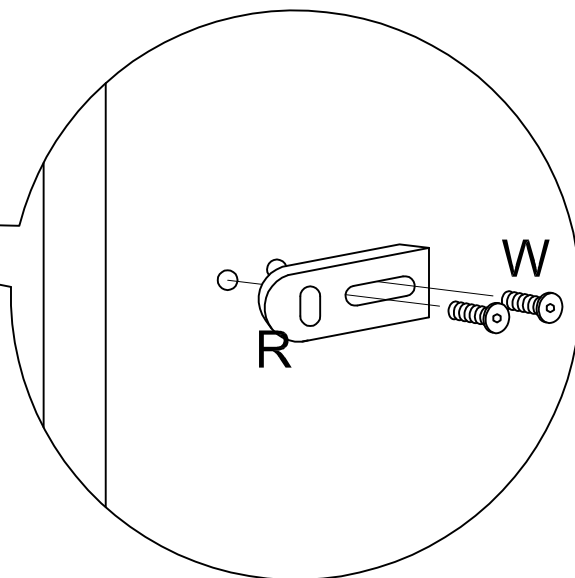
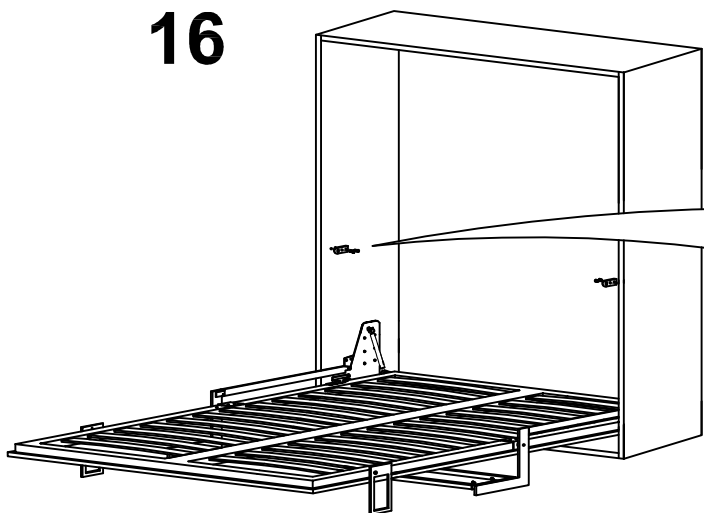

17

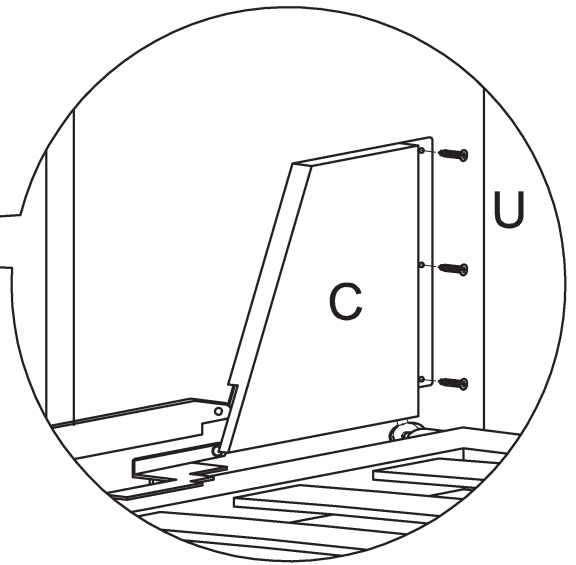
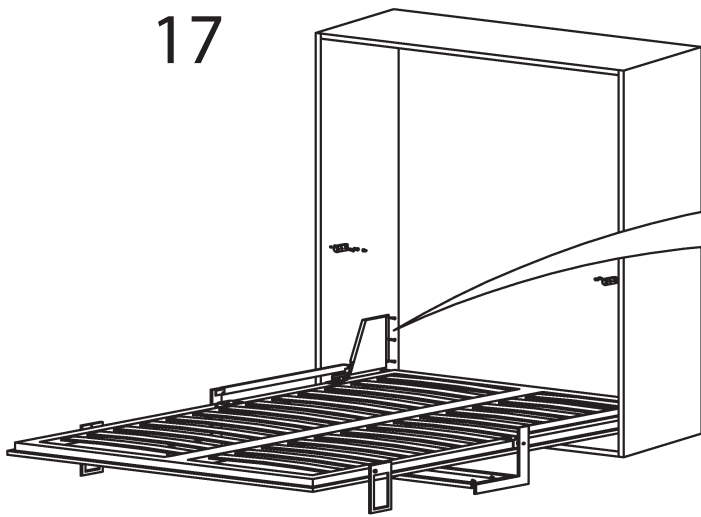

18

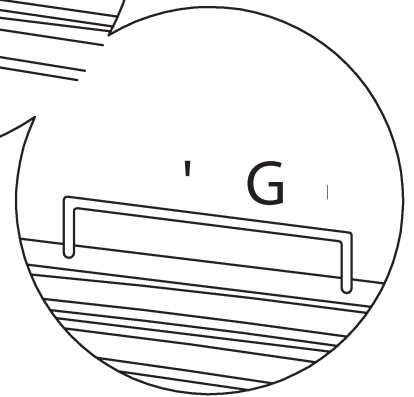
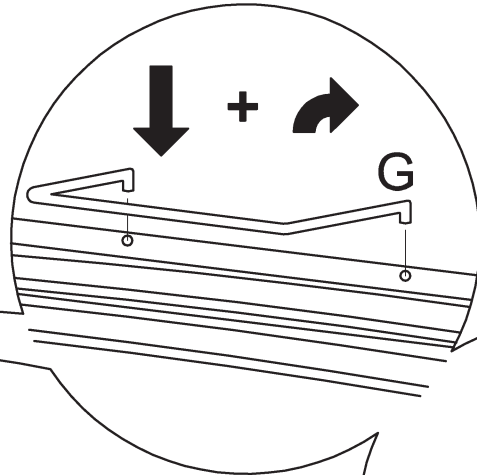
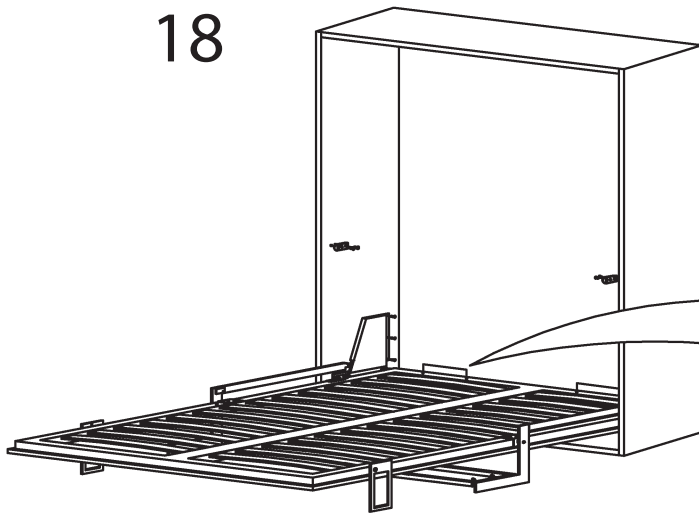

19

730 mm
20 mm

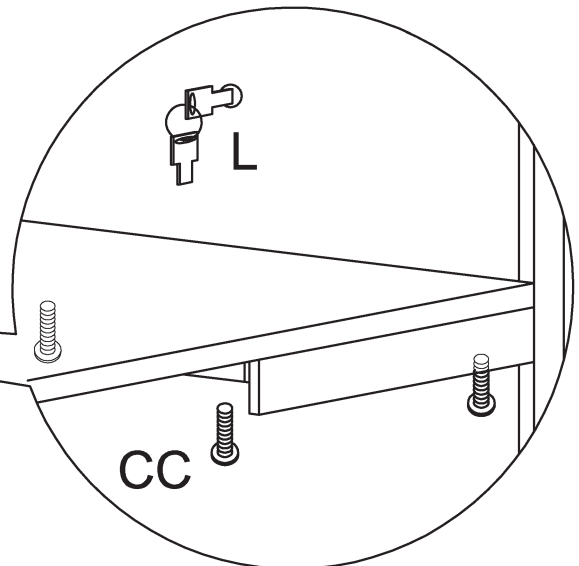
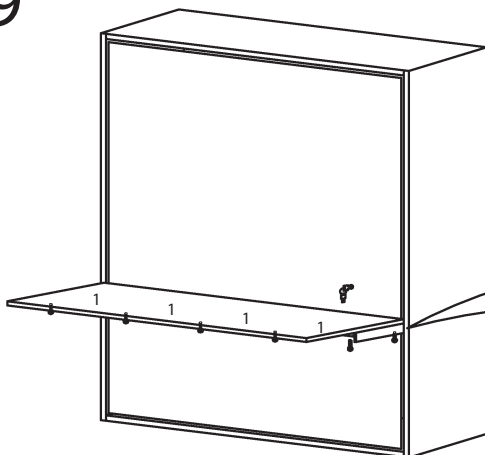

20

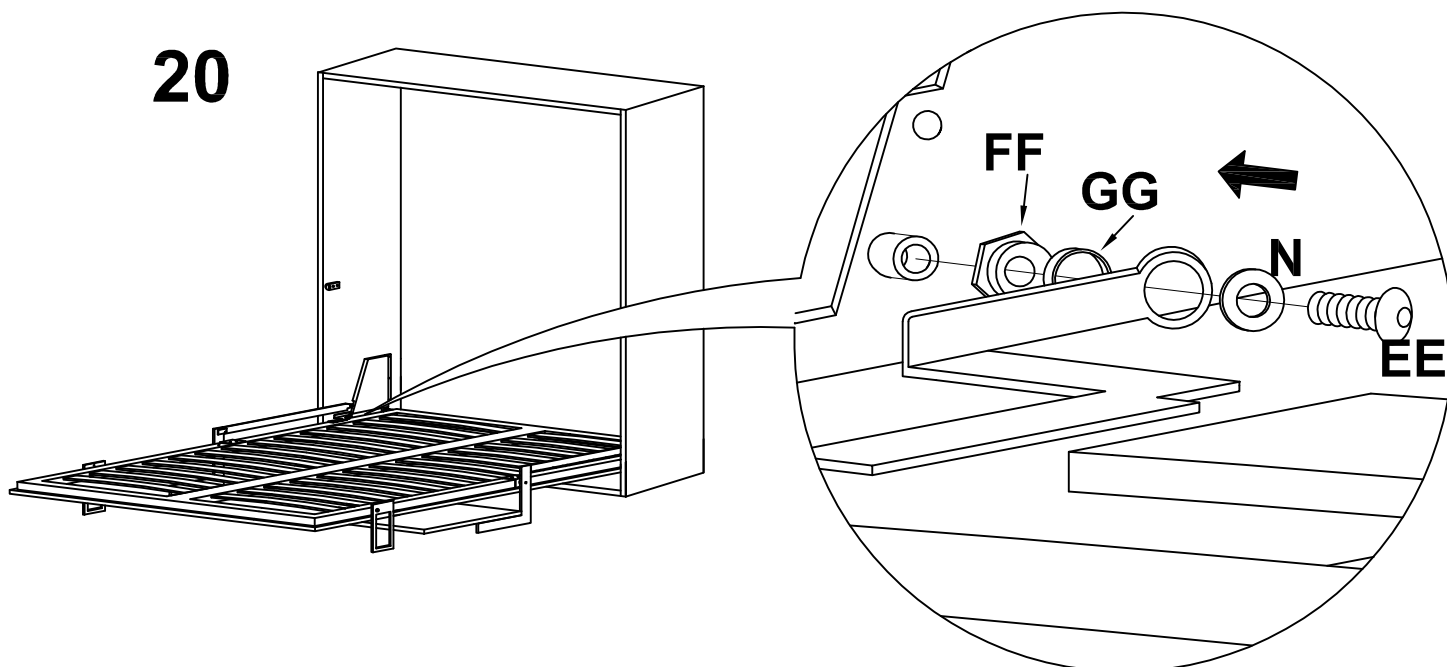

CORRETTA REGOLAZIONE
CORRECT ADJUSTMENT

- 1 APRIRE IL LETTO
OPEN THE BED
- 2 APPOGGIARE I PIEDI A TERRA
*PUT THE FEET PARALLEL TO
THE FLOOR*
- 3 AVVITARE LA VITE (EE)
SET THE SCREW (EE)

A45 - PLATE FOR STOPPING DOOR PANEL

THREADED BUSH 6MA

