

Unico
by ambigence

Meccanismo di apertura con cerniera integrata
Opening mechanism with integrated hinge

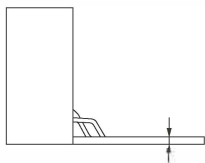

Montaggio esterno con cover
External mounting with cover



Spessore anta da 18 a 20 mm
Door's thickness from 18 to 20 mm

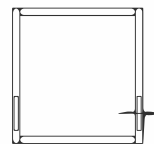

Spessore meccanismo ridotto
Narrow mechanism's thickness

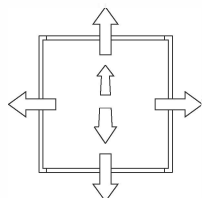

Regolazione 3D posizione anta
Door's position 3D adjustment

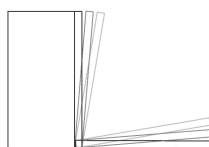

Damper in apertura e chiusura
Soft opening and soft closing



Regolazione forza della molla
Spring's force adjustment

Tipologie meccanismo Mechanisms types

Spessori standard Standard thickness

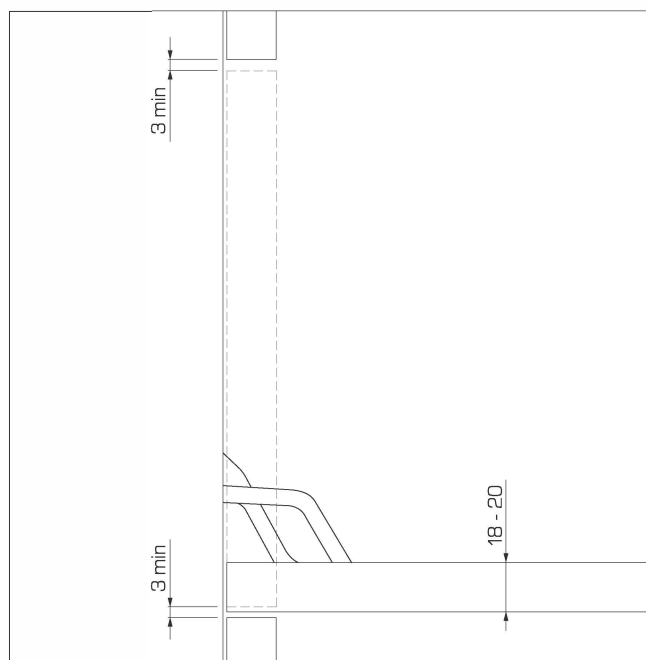

ATTENZIONE - WARNING

Lo spessore dell'anta e della base influiscono sulla scelta del meccanismo
The thickness of the door and base panel influence the choice of the mechanism

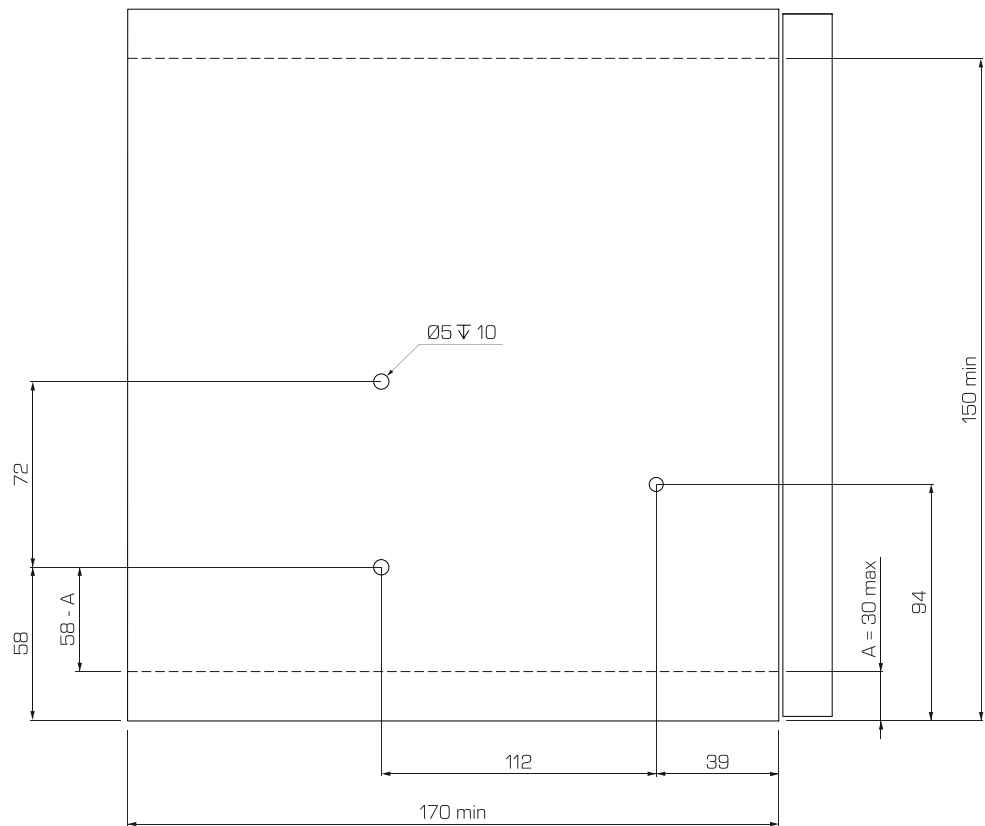

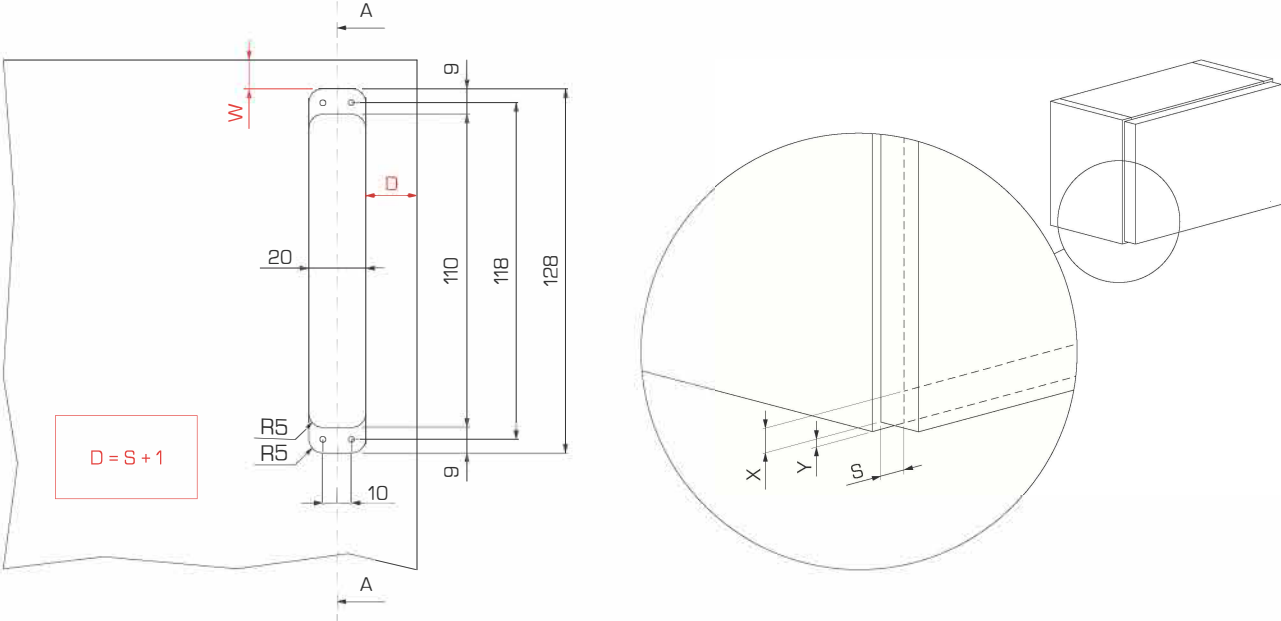

Spessori standard
Standard thickness

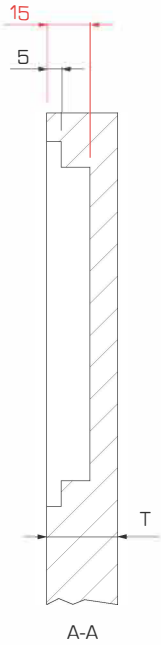

Y	W
1	11
1,5	10,5
2	10
2,5	9,5
3	9
4	8
5	7

Montaggio esterno con cover
External mounting with cover

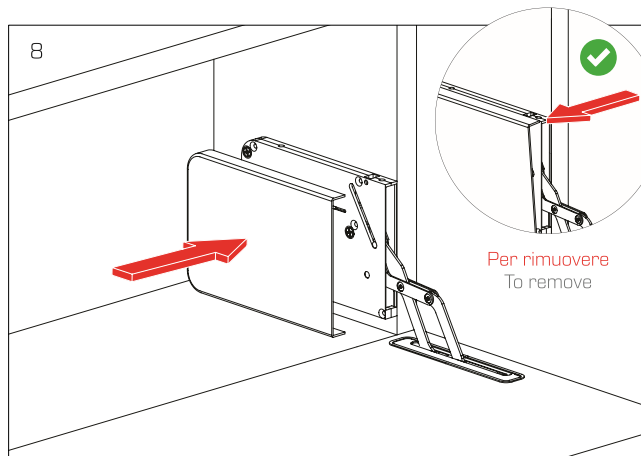
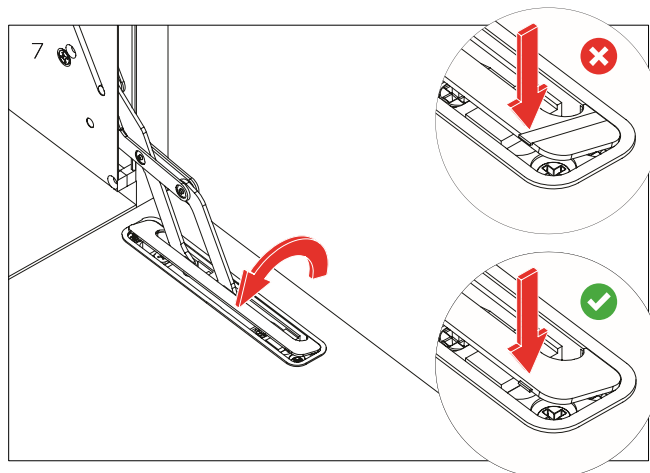
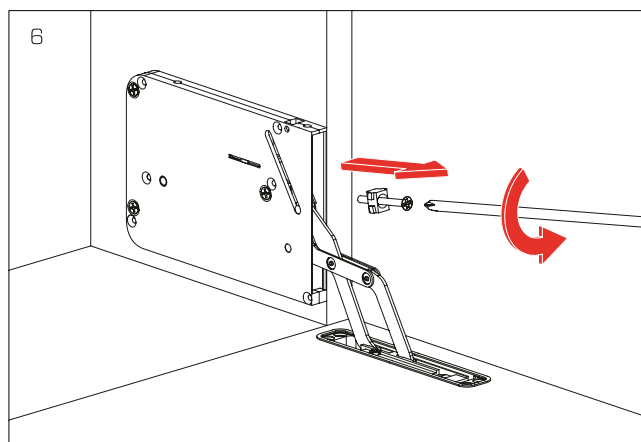
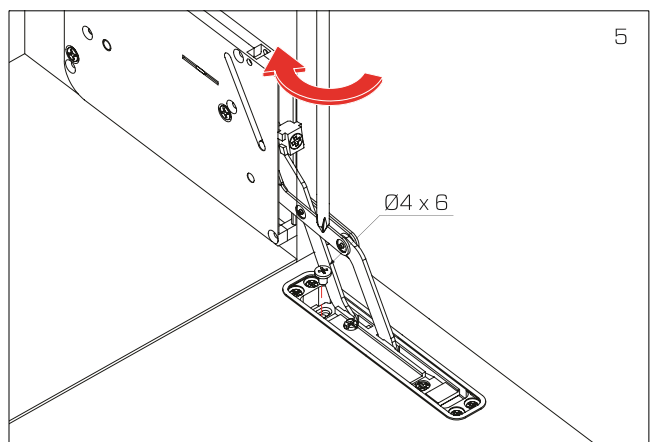
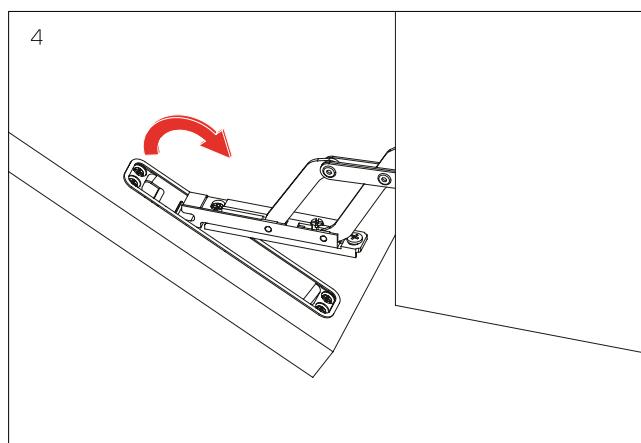
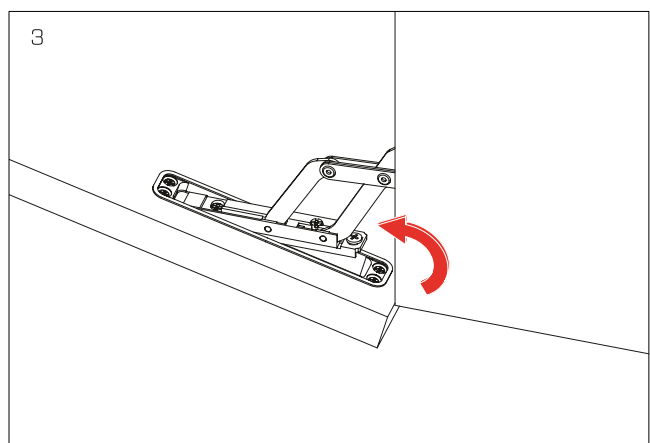
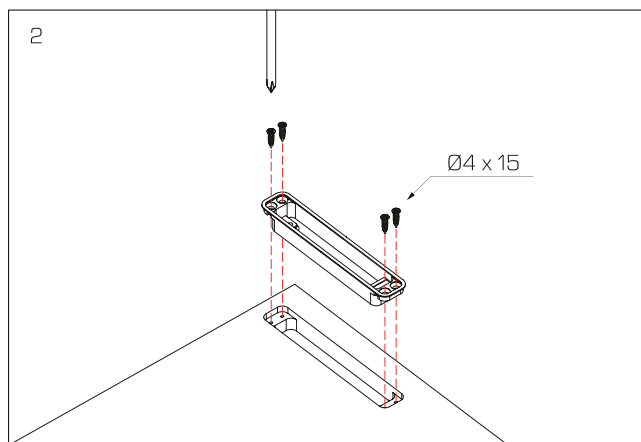
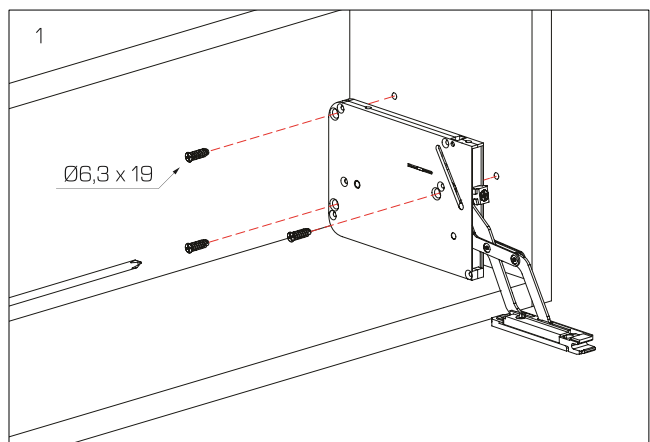



Tabelle pesi anta (kg)
Door weight tables (kg)



Hp	Mod. S	Mod. M
180 - 230	4,8 - 6,7	6,8 - 8,5
230 - 270	3,8 - 5,5	5,6 - 7,5
270 - 330	3,5 - 4,9	5,0 - 6,4
330 - 380	2,9 - 4,2	4,3 - 5,5
380 - 430	2,5 - 3,6	3,7 - 4,7
430 - 480	2,0 - 2,9	3,0 - 4,0

Finiture meccanismo
Mechanism's finishing

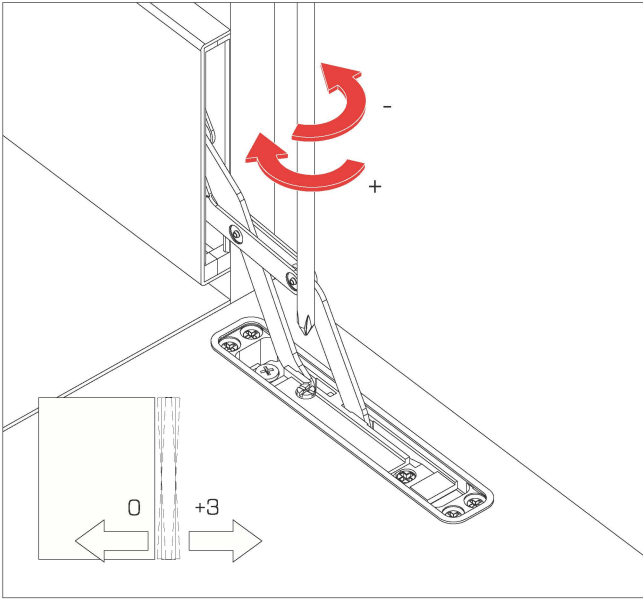
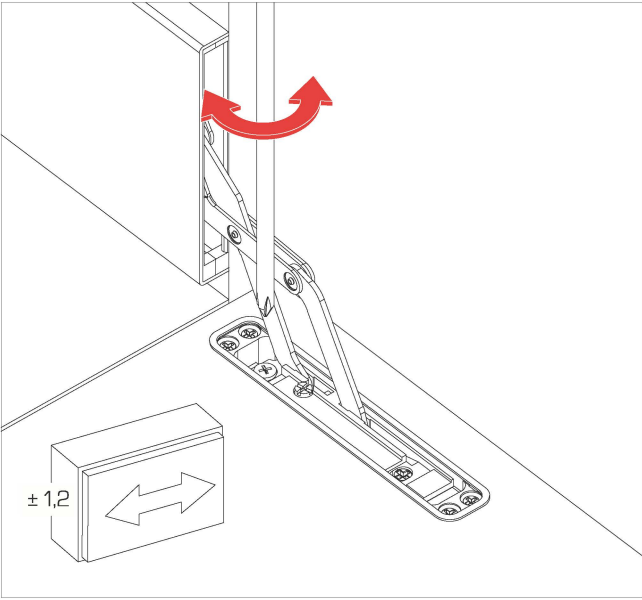
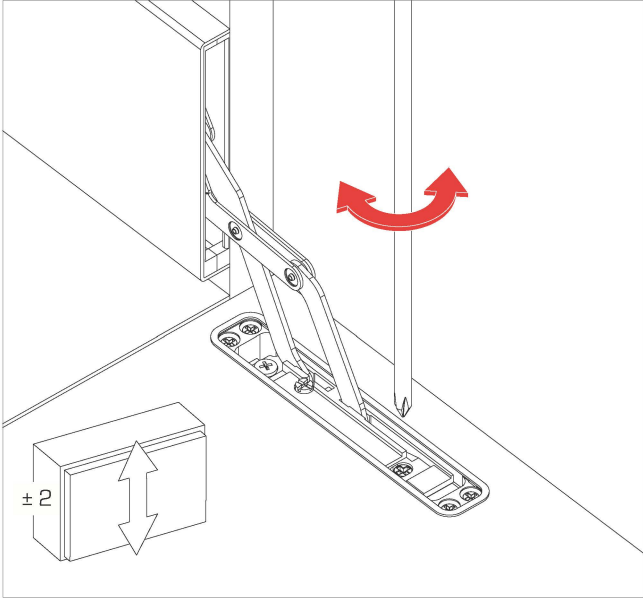
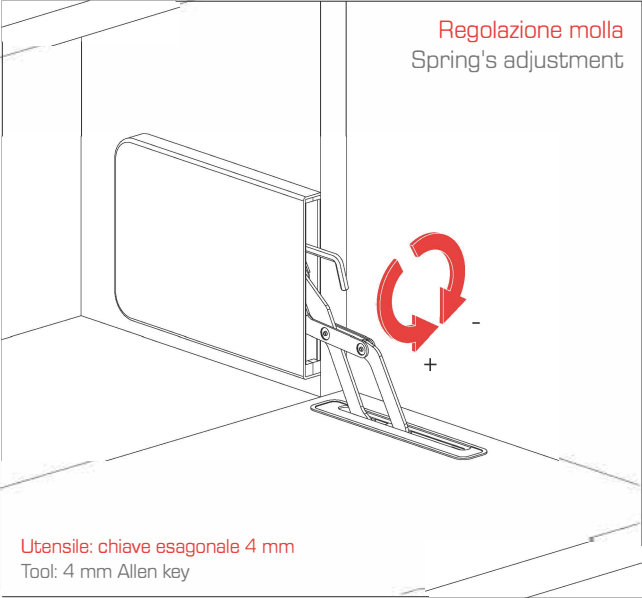
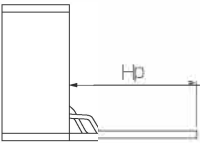

Nichelata
Nickel plated

Colori standard cover
Cover's standard colors



Bianco
White



Nero
Black

Imballaggio
Packaging

Contiene 1 SET di meccanismi (dx+sx)
Contains 1 SET of mechanisms (left+right)

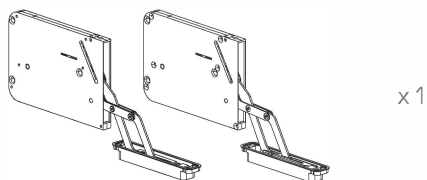

Contiene 1 SET di cover (per meccanismi e attacchi anta)
Contain 1 SET of covers (for mechanisms and door connections)

