

# IN.00.432 MANUAL DE INSTRUÇÕES

# SLIM INSTRUCTIONS MANUAL

# MANUAL DE INSTRUCCIONES



1 Furação na porta/  
Door drill/  
Taladro en la puerta

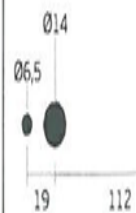

2

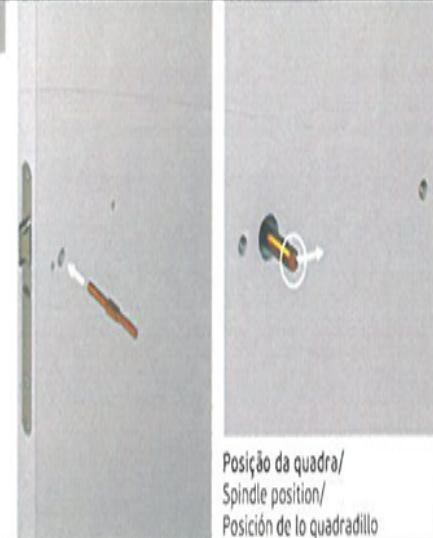

Posição da quadra/  
Spindle position/  
Posición de lo cuadradillo

3

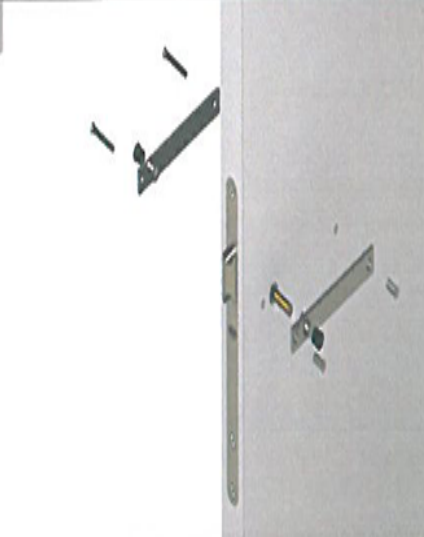

4



5



6

1- Inserir parafuso 913.BK - M6x6mm/  
1- Insert 913.BK screw - M6x6mm/  
1- Inserir tornillo 913.BK - M6x6mm



2- Inserir parafuso DIN916 - M6x6/  
2- Insert DIN916 screw - M6x6mm/  
2- Inserir tornillo DIN916 - M6x6mm



7

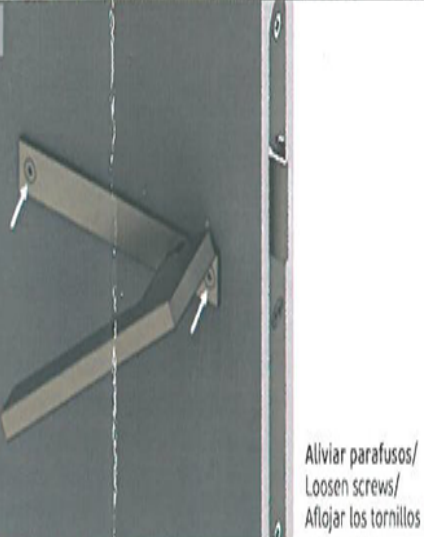

Aliviar parafusos/  
Loosen screws/  
Aflojar los tornillos

8



Alinhar placa com puxador e dar aperto final/  
Align plate with handle and give the final screw tightening/  
Alinear placa con manilla y dar lo aperto final

- 2x Puxadores / Lever handles / Manillas
- 2x Placas / Plates / Placas
- 1x Quadra / Spindle / Cuadradillo
- 1x Chave Allen / Allen key / Llave Allen - 2,5mm
- 1x Chave Allen / Allen key / Llave Allen - 3mm
- 2x Parafusos / Screws / Tornillos - DIN7991 M4x40mm
- 2x Plin / Plin / Plin
- 2x Parafusos / Screws / Tornillos - 913.BK M6x6mm
- 2x Parafusos / Screws / Tornillos - DIN916 M6x6mm